

ILLUSTRATED
SPARE PARTS

of

“Scott”

MOTOR
CYCLES



The
SCOTT
MOTOR CYCLE
COMPANY LTD.
SALTAIRE
YORKS.

BARNSTORMERS.CO.NZ

Scott

MOTOR CYCLES

ILLUSTRATIONS OF SPARE PARTS

TO BE USED IN CONJUNCTION WITH
CURRENT PRICE LIST
PUBLISHED SEPARATELY.

1926.



The Scott Motor Cycle Co. Ltd.

SALTAIRE - SHIPLEY - YORKSHIRE.

Telegrams: "TWIN SHIPLEY." Telephone: Shipley 337.

London Depot:

SCOTT MOTORS (LONDON) Ltd.,
78 CHARLOTTE STREET, W.1.

Manchester Depot:

SCOTT MOTORS (MANCHESTER) Ltd.,
11 LIVERPOOL ROAD, DEANS GATE.

Telegrams "Nonvalve Wesdo London"

Telephone Museum 6521.

Telegrams "Nonvalve Manchester."

Telephone City 5992.

BARNSTORMERS.CO.UK

INTRODUCTION.

Please read this carefully.

In producing our 1926 Illustrated Spare Parts List, it has been our aim to include particulars concerning all models for which we can supply Spare Parts. The illustrations are not necessarily in every case, binding in detail, as certain parts have been modified or improved since the photographs were taken, but they will be found of great assistance in ascertaining the List Number of the part required, after which, reference should be made to the Price List for further particulars. If any part is not illustrated and it cannot easily be recognised from the Price List, we shall be pleased to quote upon receipt of details.

Line drawings of sections of various components will be found in our other publication, "*The Book of the Scott*" (supplied free with new machines — extra copies 1/-), and these should further assist customers to satisfy themselves that they are ordering the correct part. These drawings will also prove very instructive in the assembly of machines.

How to Order Parts.

1. **Always quote Engine Number and type of machine.** The Engine Number will be found on the side of the crankcase, near to the name "Scott."
2. **Describe each part exactly as in the Price List, in addition to giving the List Number.** This provides a check against accidental error.
3. It is also useful to give the date of the machine, and, if possible, the name of the Agent through whom it was bought.
4. With older models, it is advisable, wherever possible, to send us the old parts which require replacement, owing to the fact that many such machines have been modernised by riders.

Payment.

All prices of spare and replacement parts are subject to revision or modification at our discretion without notice, and we reserve the right to charge up goods at prices ruling on day of despatch.

Our terms are strictly nett cash with order, or cash against pro-forma invoice. Charges for repairs and sundries cannot be booked unless a Deposit Account is opened.

Prices do not include cost of carriage or postage, so if you wish to receive the parts without delay, kindly remit an excess amount, any balance of which will be refunded.

Stamps cannot be accepted for items of over 1/-

Cheques and Postal Orders should be made payable to The Scott Motor Cycle Co. Ltd.; cheques should be crossed "& Co."

If payment is made by Telegraph Money Order, the name and address of the sender must be written on a Post Office Requisition Form for a private message from remitter to payee, as otherwise we do not know from whom it has been sent.

Deposit Account.

To save delay, and to ensure delivery by return of parts from stock, we shall be pleased to open a Deposit Account with customers for £2/0/0 or over. On the deposit becoming exhausted, it can be renewed to keep the account open. It should be distinctly stated when remitting any such amount, that it is for Deposit Account.

Repairs and Overhauls.

Any part or complete Motor Cycle sent for repair, should be consigned "Carriage Paid" and the sender's name and address should be given in full on all labels. Parts sent to us "Carriage Forward" are liable to be refused and to lie with the Carriers at sender's risk and expense.

When forwarding Motor Cycles for repair, it is advisable to remove all accessories and easily detachable fittings, such as Lamp, Horn, Tools, etc., as we cannot accept any responsibility for loss or damage to any such parts. Besides facilitating the work of repair, it will also prevent any loss during transit.

Full instructions regarding the necessary repairs to be done, with advice as to the mode of despatch of the machine (or part) should be posted the same day.

Such instructions and all other letters respecting a machine or parts forwarded to us, must state clearly, the name and address of sender which appears on the label attached to the parts. Frequently, we have parts returned to us by a customer, whilst the instructions for repair are sent by an Agent. Unless the customer's name and address are mentioned in the Agent's letter, it is extremely difficult to trace the parts concerned. When forwarding a complete Motor Cycle or complete Component, such as engine, gearbox, carburetter, magneto, etc., with the request that we overhaul it, we understand from the term "overhaul" that it is to be entirely dismantled, thoroughly renovated, any worn parts renewed, and put in perfect working order. In case a customer desires only certain parts attending to, full instructions should be given to that effect; otherwise, the cost may be in excess of that anticipated.

Estimates and Quotations.

When customers send complete machines, or parts thereof to us for repair, we are always prepared to furnish estimates before proceeding with the necessary work, but it must be distinctly understood that we can give only approximate quotations. Frequently, when the actual work is in progress, it is found necessary to replace parts other than those specified in the estimate, as we make a practice of including in such estimates, only those items and parts which at the time we consider really essential to put the machine (or parts) in a thoroughly satisfactory condition.

If any estimate prepared in this way, is not accepted, we reserve the right to make a nominal charge for taking down and re-assembling any parts necessary in its preparation.

We prefer not to undertake a repair or overhaul (nor do we accept any responsibility) if our estimate should be curtailed by the owner.

We cannot hold ourselves responsible for loss of, or damage to, any parts lying here for repairs, unless instructions to proceed with the work are given within 7 days of our estimate for the said repairs having been rendered.

All Acetylene-welded repairs to Crankcases and other aluminium parts are carried out with extreme care, but we cannot give any guarantee with, nor accept any responsibility for, any parts so treated.

**This edition cancels all previous Illustrated Lists of Spare
and Replacement Parts**

THE SCOTT MOTOR CYCLE CO. LTD.,
BARNSTORMERS.CO.UK Shipley, Yorkshire.

MOTOR CYCLE GUARANTEE.

We give the following Guarantee with our motor cycles instead of the Guarantee implied by statute, or otherwise, as to the quality or fitness of such machines for the purpose of motor cycling; any such implied guarantee being in all cases excluded. In the case of machines which have been used for "hiring out" purposes, or from which our trade mark or manufacturing number has been removed no guarantee of any kind is given, or is to be implied.

WE GUARANTEE, subject to the conditions mentioned below, that all precautions which are usual and reasonable have been taken by us to secure excellence of materials and workmanship, but this guarantee is to extend and be in force for three months only from the date of purchase and damages for which we make ourselves responsible under this guarantee, are limited to the replacement of any part which may have proved defective, but not to the cost of any work involved in effecting such replacement. We undertake, subject to the conditions mentioned below, to make good at any time within three months any defects in these respects. As motor cycles are easily liable to derangement by neglect or misuse, this guarantee does not apply to defects caused by wear and tear, misuse or neglect.

The term "misuse" shall include amongst others the following acts:—

1. The attaching of a sidecar to the motor cycle in such a manner as to cause damage, or calculated to render the latter unsafe when ridden.
2. The use of a motor cycle, or of a motor cycle and sidecar combined, when carrying more persons or of a greater weight than that for which the machine was designed by the manufacturers.

Any motor cycle sent to us to be plated, enamelled or repaired, whether the repairs are required for the purpose of making good the defect before referred to or otherwise, will be repaired upon the following conditions:—

i.e., we guarantee that all precautions which are usual and reasonable have been taken by us to secure excellence of material and workmanship, such guarantee to extend and be in force for three months only from the time such work shall have been executed, and this guarantee is in lieu and in exclusion of any common law or statute warranty, and the damages recoverable are limited to the cost of any further work which may be necessary to amend and make good the work found to be defective.

Conditions of Guarantee.

If a defective part should be found in our motor cycles or in any part replaced, it must be sent to us carriage paid, and accompanied by an intimation from the sender that he desires to have it repaired free of charge under our guarantee, and he must also furnish us at the same time with the number of the machine, the name of the agent from whom he purchased, and the date of the purchase or the date when the alleged defective part was replaced, as the case may be. All letters should be addressed to the firm and not to individuals.

Failing compliance with the above, no notice will be taken of anything which may arrive, but such articles will lie here at the risk of the senders, and this guarantee, and any implied guarantee, shall not be enforceable.

We guarantee only those machines which are bought either direct from us, or from one of our duly appointed agents, and under no other conditions.

We do not guarantee the specialities of other firms, such as Tyres, Saddles, Chains, Lamps, etc., or of any component part supplied with other motor cycles. or otherwise.

A post card is enclosed with each new Scott Motor Cycle which, when duly filled in and returned to us, entitles the purchaser to a signed Guarantee for three months. Unless the purchaser is in possession of a numbered and signed Guarantee we do not undertake repairs or supply replacements under our Guarantee.

THE TERM "AGENT" is used in a complimentary sense only, and those firms whom we style our "agents" are not authorised to advertise, incur any debts or transact any business whatsoever on our account, other than the sale of goods which they may purchase from us; nor are they allowed to give any warranty or make any representation on our behalf other than those contained in the above Guarantee.

THE SCOTT MOTOR CYCLE CO., LTD.,
Barnsley, Yorkshire.

TABLES OF POSSIBLE GEAR RATIOS

(A Useful Guide when Ordering Sprockets).

TWO-SPEED.

Number of Teeth in Sprockets					Ratios		Ref
E	H	L	R	D	HG	LG	
20	25	36	66	22	3.75	5.40	<i>a</i>
"	"	"	"	21	3.93	5.66	<i>b</i>
"	"	"	"	20	4.13	5.94	<i>c</i>
"	"	"	"	19	4.34	6.25	<i>d</i>
"	"	"	75	22	4.26	6.14	<i>e</i>
"	"	"	"	21	4.46	6.43	<i>f</i>
"	"	"	"	20	4.69	6.75	<i>g</i>
"	"	"	"	19	4.93	7.11	<i>h</i>
"	"	40	66	22	3.75	6.00	<i>i</i>
"	"	"	"	21	3.93	6.30	<i>j</i>
"	"	"	"	20	4.13	6.60	<i>k</i>
"	"	"	"	19	4.34	6.95	<i>l</i>
"	"	"	75	22	4.26	6.82	<i>m</i>
"	"	"	"	21	4.46	7.14	<i>n</i>
"	"	"	"	20	4.69	7.50	<i>o</i>
"	"	"	"	19	4.93	7.89	<i>p</i>
"	"	47	66	22	3.75	7.06	<i>q</i>
"	"	"	"	21	3.93	7.40	<i>r</i>
"	"	"	"	20	4.13	7.75	<i>s</i>
"	"	"	"	19	4.34	8.16	<i>t</i>
"	"	"	75	22	4.26	8.00	<i>u</i>
"	"	"	"	21	4.46	8.40	<i>v</i>
"	"	"	"	20	4.69	8.81	<i>w</i>
"	"	"	"	19	4.93	9.27	<i>x</i>

E=Engine Sprockets.
H=High Gear Sprocket.
L=Low Gear Sprocket.
R=Rear Wheel Sprocket.
D=Driving Sprocket.
HG=High Gear. LG=Low Gear.

1926 THREE-SPEED.

No. of Teeth in Sprockets				Ratios			Ref
E	G	R	D	HG	MG	LG	
Close Ratio Box							
20	40	50	26	3.84	5.23	7.20	<i>a</i>
"	"	"	25	4.00	5.45	7.45	<i>b</i>
"	"	"	24	4.17	5.67	7.80	<i>c</i>
"	"	"	23	4.34	5.91	8.08	<i>d</i>
"	"	"	22	4.54	6.17	8.44	<i>e</i>
"	"	"	21	4.76	6.47	8.85	<i>f</i>
"	"	"	20	5.00	6.80	9.30	<i>g</i>
Wide Ratio Box							
20	40	50	26	3.84	5.64	10.75	<i>h</i>
"	"	"	25	4.00	5.88	11.20	<i>i</i>
"	"	"	24	4.17	6.13	11.63	<i>j</i>
"	"	"	23	4.34	6.38	12.13	<i>k</i>
"	"	"	22	4.54	6.67	12.74	<i>l</i>
"	"	"	21	4.76	7.00	13.32	<i>m</i>
"	"	"	20	5.00	7.35	14.00	<i>n</i>
"	"	55	26	4.23	6.21	11.83	<i>o</i>
"	"	"	25	4.40	6.47	12.32	<i>p</i>
"	"	"	24	4.60	6.75	12.90	<i>q</i>
"	"	"	23	4.80	7.05	13.45	<i>r</i>
"	"	"	22	5.00	7.35	14.00	<i>s</i>
"	"	"	21	5.23	7.68	14.64	<i>t</i>
"	"	"	20	5.50	8.10	15.45	<i>u</i>

E=Engine Sprocket.
G=Gear Box Sprocket.
R=Rear Wheel Sprocket.
D=Driving Sprocket.
HG=High Gear.
MG=Middle Gear. LG=Low Gear.

Recommended Two-Speed Ratios.

	Solo	Sidecar
486 cc. Squirrel	<i>j</i>	<i>t, x</i>
498 cc. Super Squirrel	<i>j</i>	<i>t, x</i>
596 cc. Super Squirrel	<i>i, j</i>	<i>t</i>
498 cc. Flying Squirrel	<i>j</i>	<i>t</i>
596 cc. Flying Squirrel	<i>i, j</i>	<i>t</i>
532 cc. Standard	<i>u</i>	<i>x</i>
596 cc. Standard	<i>u</i>	<i>x</i>

Recommended Three-Speed Ratios.

	Solo	Sidecar
498 cc. Super Squirrel	<i>k</i>	<i>n</i>
596 cc. Super Squirrel	<i>h</i>	<i>m</i>
498 cc. Flying Squirrel	<i>k</i>	<i>n</i>
596 cc. Flying Squirrel	<i>h</i>	<i>m</i>
596 cc. Standard	<i>o</i>	<i>s</i>
498 cc. (Close Ratio Box)	<i>d</i>	<i>g</i>
596 cc. (Close Ratio Box)	<i>a</i>	<i>f</i>

Note.—The Two-Speed Ratios advised above are for average conditions. For Solo work in very hilly districts, sidecar ratios can be used with advantage, whilst for very heavy sidecar work the lowest possible ratios should be selected. 36T Low Gear Sprockets are not recommended for ordinary purposes, but provide very close ratios for special requirements.

CHAIN DIMENSIONS—ALL MODELS.

Engine Chain(s), $\frac{1}{2}$ in. \times '205. Driving Chain, $\frac{1}{2}$ in. \times '305. Magneto Chain, $\frac{1}{2}$ in. \times $\frac{1}{8}$ in.
Two-Speed Kickstarter Chains: None but the special type supplied should be used.

SPECIAL NOTES ON ORDERING SPARES.

Always quote Engine Number and Type of Machine.

Engine.

Oversize engine Rollers not supplied.

All Engines and Parts prior to 1912 have been discarded and cannot now be supplied.

We have deleted from the list—Crankcase cups (No. 3) and Main bearing and big end bushes on Cranks (Nos. 1034 and 1035).

In all cases where new cups are required for crankcases, or cranks or connecting rods need re-bushing, we intend to carry out the work ourselves and under no circumstances will the above-mentioned parts be supplied as spares (except in cases of foreign and colonial orders where great delay and transit expense would be incurred, and then only if we are satisfied that accurate grinding facilities are available).

Pistons.

When ordering pistons, state whether cast iron or aluminium, and type of gudgeon pin fixing. When ordering piston rings, state depth or send pattern.

Lubrication.

Present pattern oil tank and sight feeds can be fitted to all machines irrespective of date. Mechanical pump should not be fitted unless the crank shaft glands are replaced with the necessary special type.

Two speed Gear.

Half hubs for Gears for machines supplied prior to 1912 are not now supplied.

Chains.

State length of chain required (by the number of links). Light pattern chains are not now supplied.

Sprockets.

When ordering low gear sprocket (two-speed), driving sprocket or rear wheel sprocket state number of teeth. See Table of Gear Ratios on page 5.

Three-Speed Gear Box.

When requiring parts state Gear Box Number as well as Engine Number.

Brakes.

Present pattern brakes cannot be fitted to old machines without alteration to the frame.

Back Wheel.

When ordering parts for Back Wheels with adjustable bearings, please specify diameter of balls or send patterns.

Frame.

Always specify whether two or three-speed type.

Forks.

When ordering Forks or Parts state whether front brake is stirrup pattern or expanding type, and if the latter state also width between fork members.

Petrol Tanks.

When ordering a tank state type, overall length and capacity required ; also whether clearance is necessary for a Magdyno. When ordering petrol pipes state type of carburetter and type of petrol tap.

Magneto.

In ordering parts for magnetos please specify make.

Carburetter.

When requiring carburetter parts please state type and date of instrument.

Controls.

In ordering wires and casings, type of carburetter or magneto must be stated. For other controls specify whether levers are inverted or otherwise.

Saddles.

Framework or under-frames for saddles prior to 1919 cannot be supplied. When ordering springs state make of saddle.

Sidecars.

When ordering sidecar parts please quote Catalogue Number of the Sidecar. For Wheel bearing parts of old sidecars, patterns and dimensions should be sent.

Important.

If machines have been fitted at any time with up-to-date parts it is advisable to specify this on orders for replacements.

All letters should be addressed to the firm and not to individuals.

ENGINE.

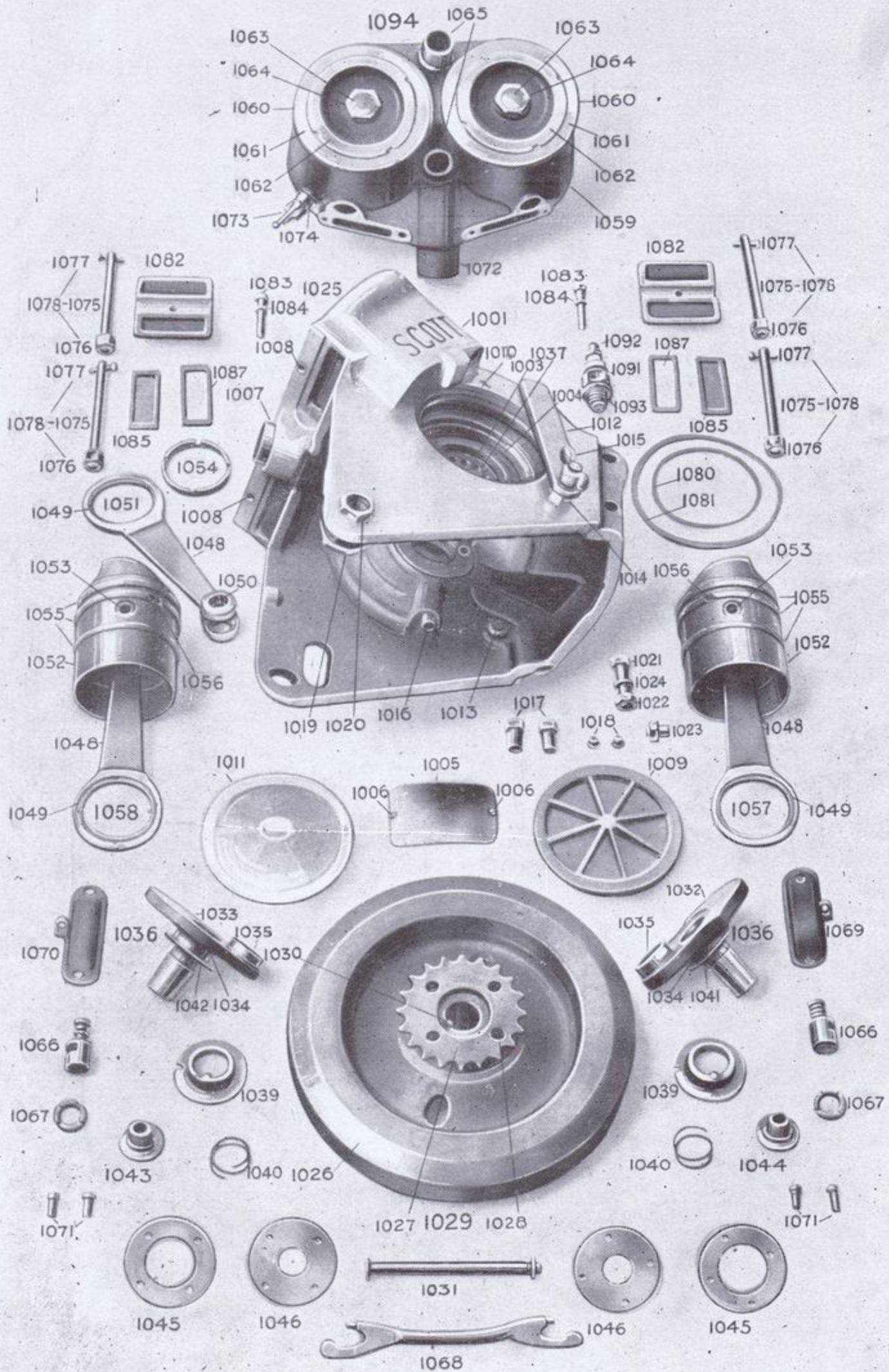

When ordering crank shaft glands state if mechanical pump is fitted or not.

Always quote Engine No. and Type of Machine.

Barnstormers.co.nz

TWO-SPEED GEAR.

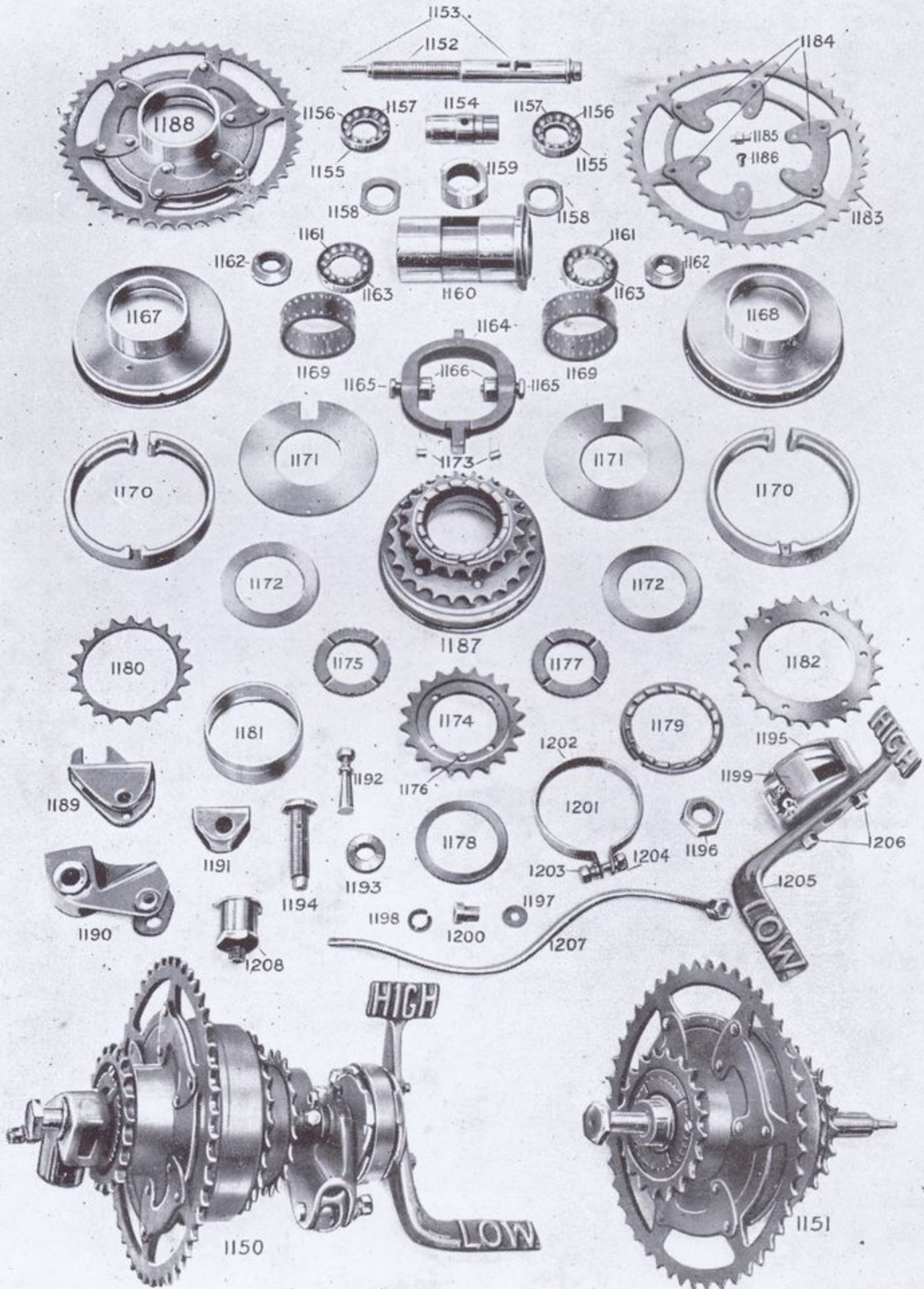

The Gear Lugs shown are old type. New type may be substituted if ordered complete. If frame has provision for screw adjustors, specify this when ordering lugs.

Always quote Engine No. and Type of Machine.

TWO SPEED KICKSTARTER, OIL PUMP, etc.

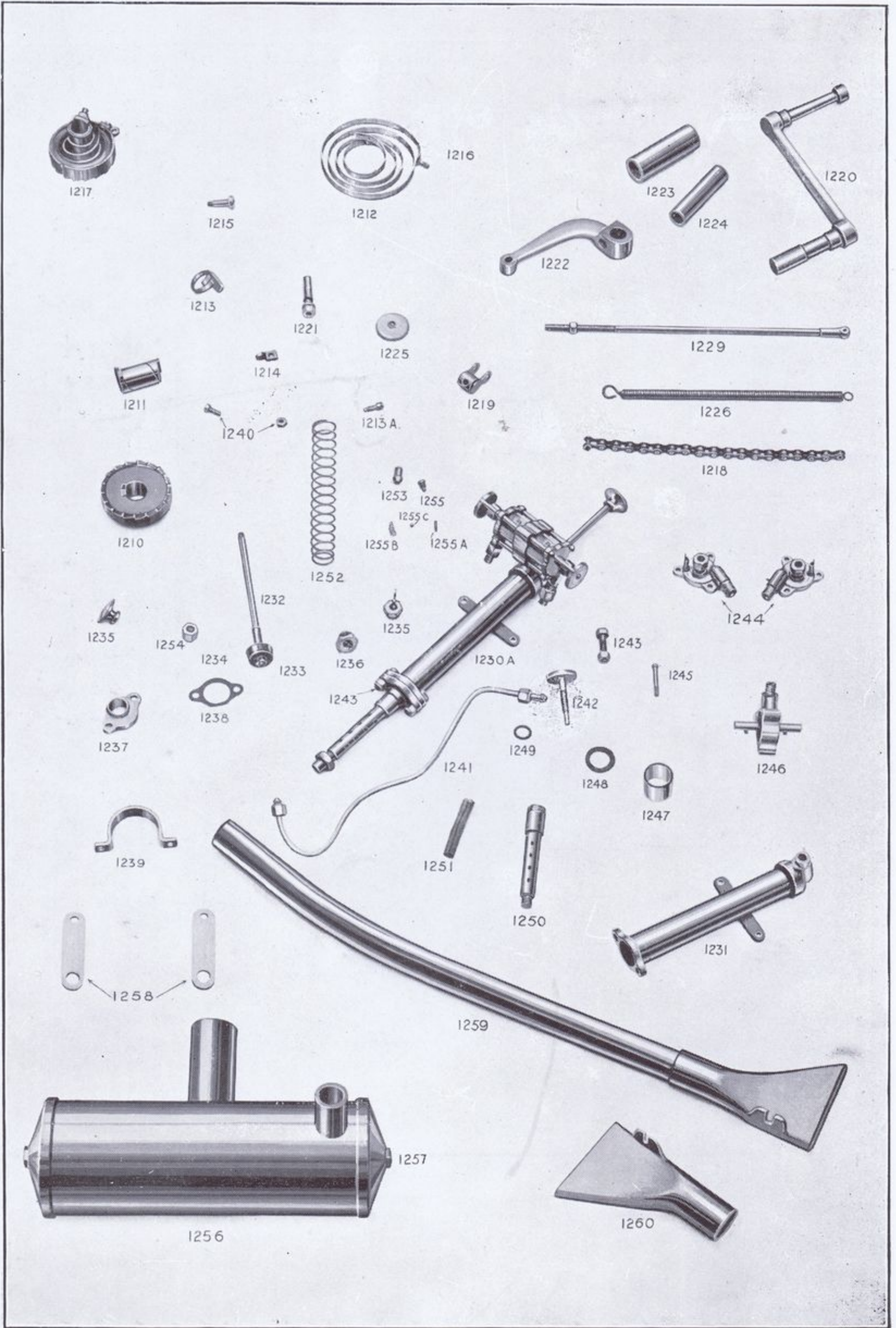

Above illustration shows horizontal drip feeds, which are now discontinued. Vertical drip feeds can be supplied as fitted to 1921 and later models. See page 18. Single coil Kickstarter Spring is now superseded by triple coil type. New Kickstarter return spring is as shown on page 18.

Always quote Engine No. and Type of Machine.

FRAME, MUDGUARDS, CHAINS, etc.

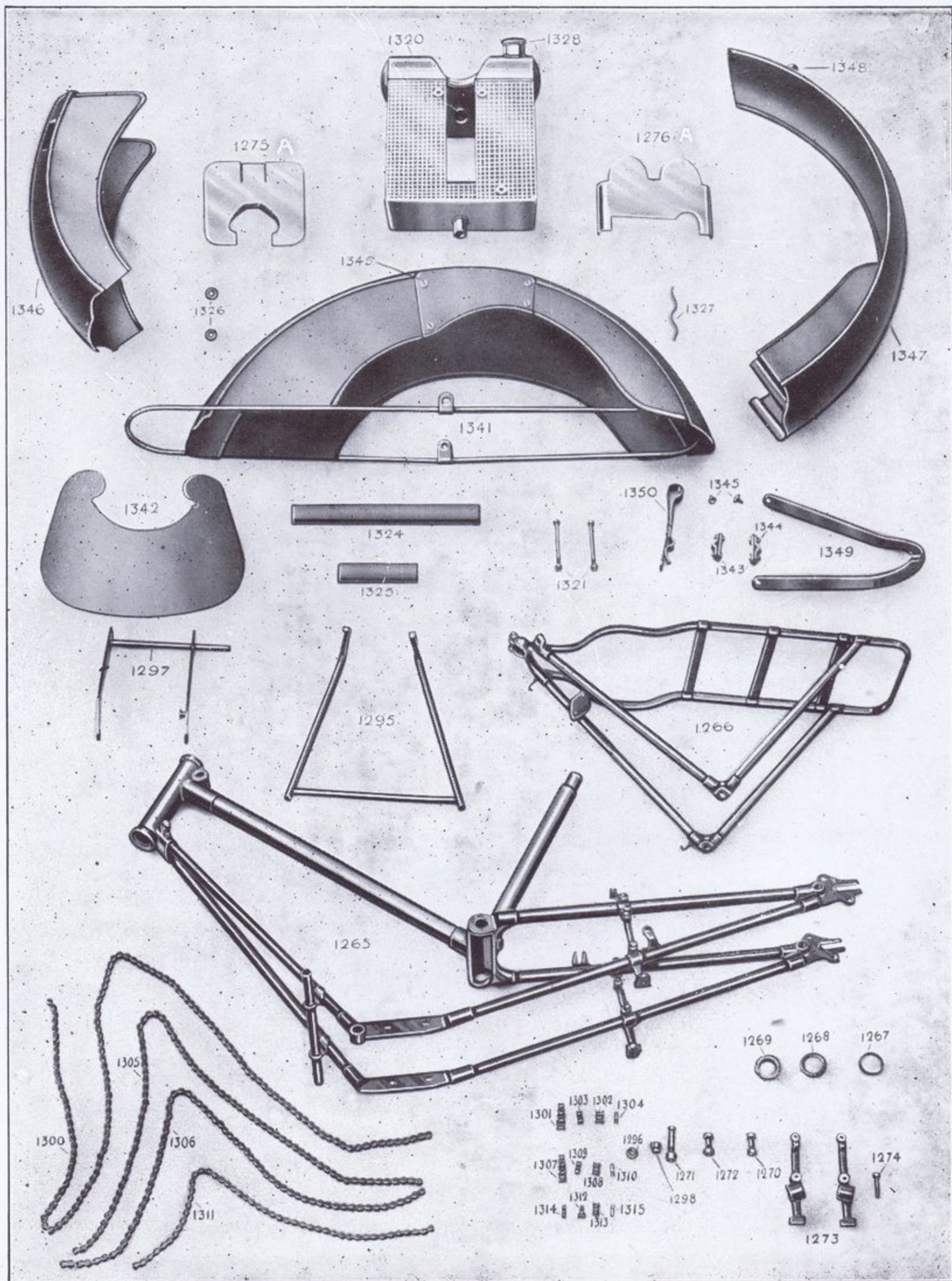

When ordering frame parts state whether for two or three-speed models. When ordering complete frame state overall length of petrol tank.

Always quote Engine No. and Type of Machine.

BARNSTORMERS.CO.NZ

FRONT FORKS.

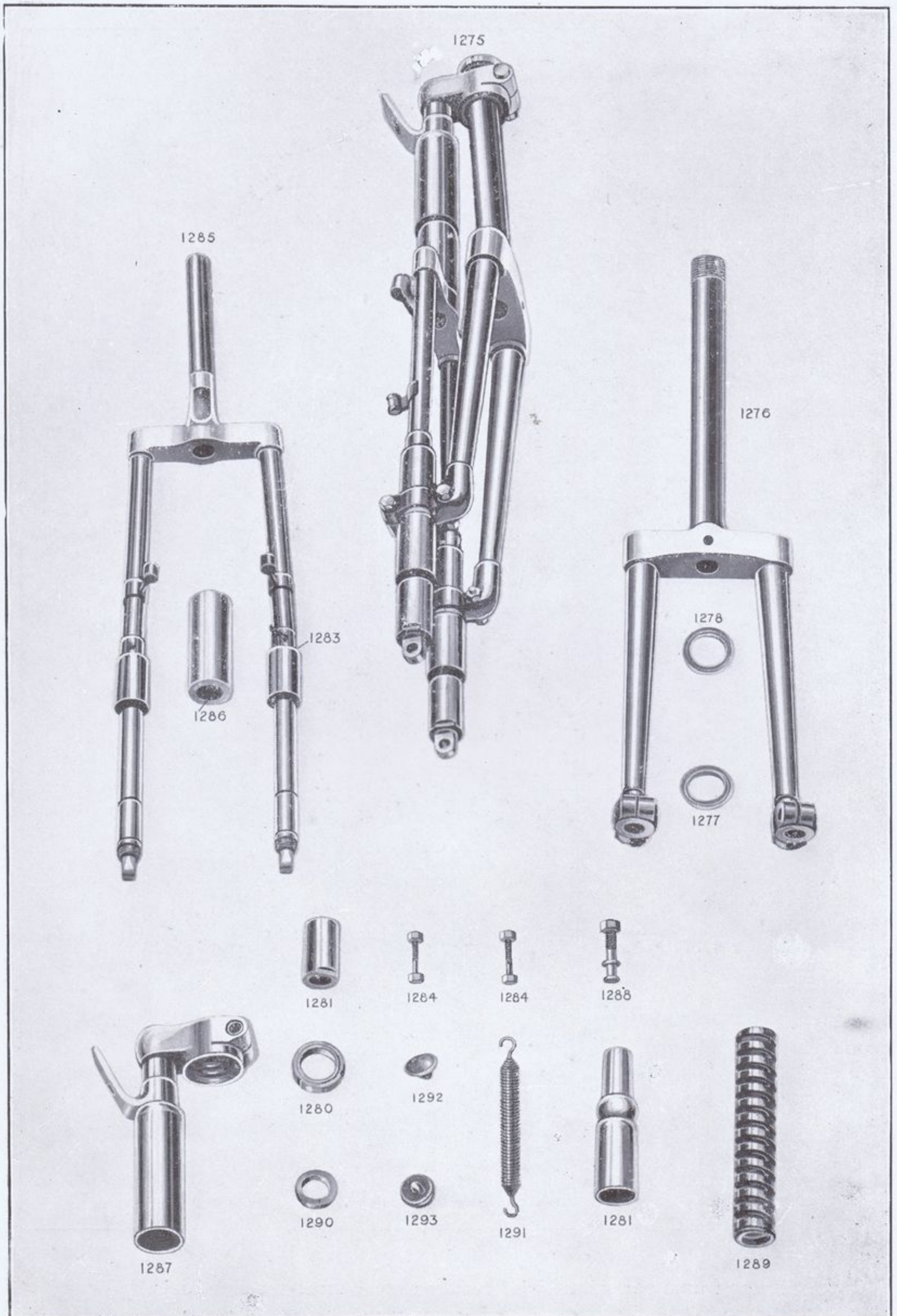

Specify when ordering whether stirrup pattern or expanding brake is fitted.

Always quote Engine No. and Type of Machine.

BACK WHEEL.

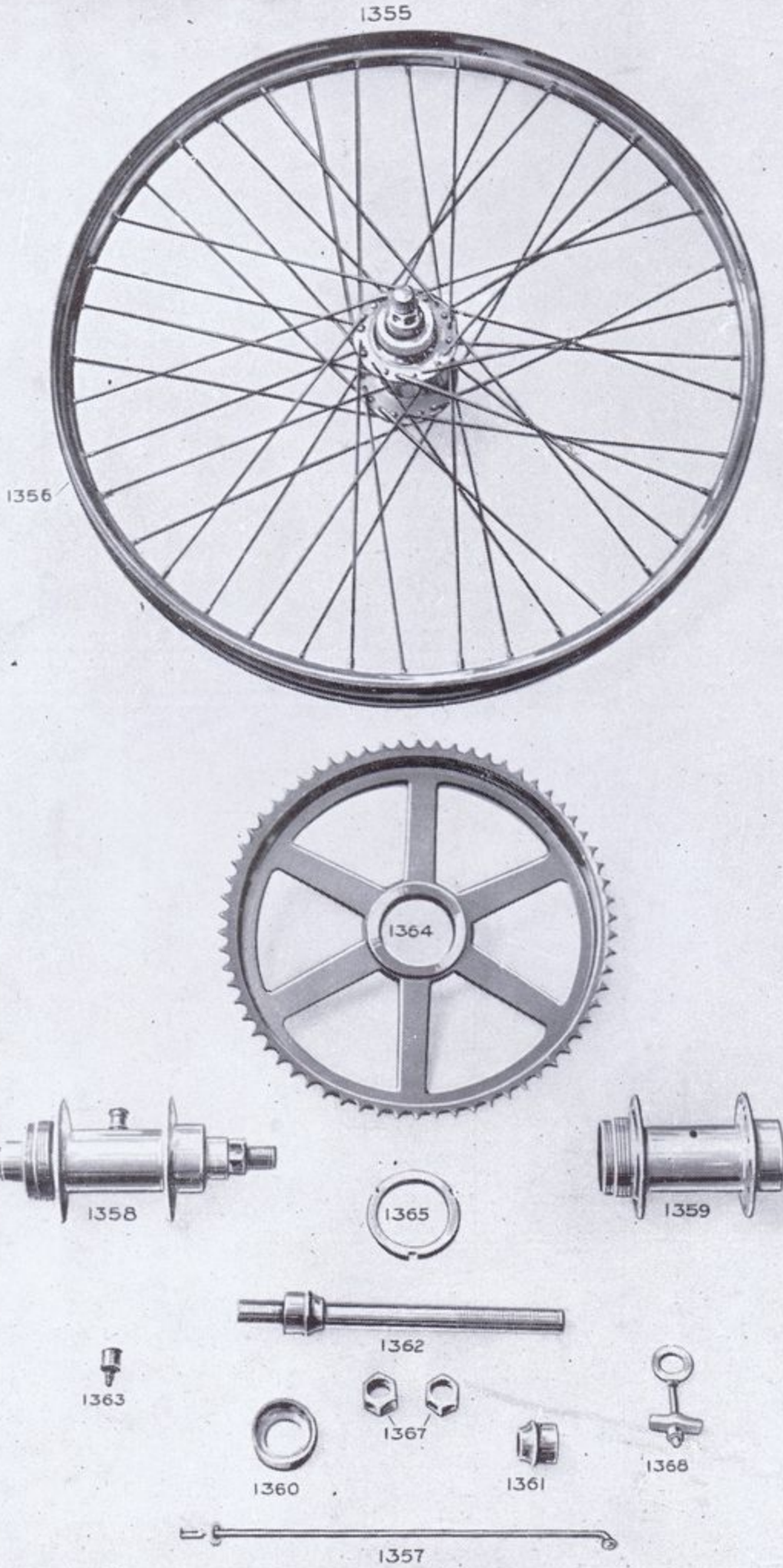

The above illustration applies to two-speed models supplied 1923 and prior.
See page 23 for later types.

Always quote Engine No. and Type of Machine.

FRONT WHEEL.

1370

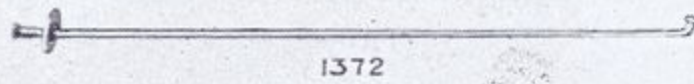
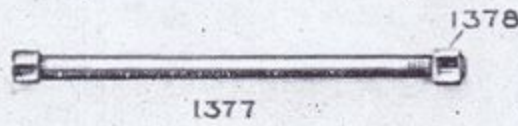
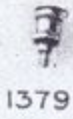
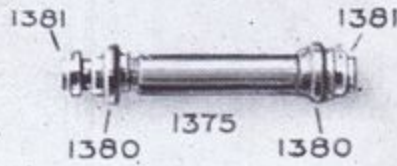
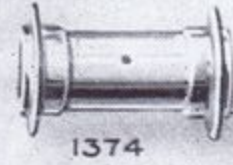
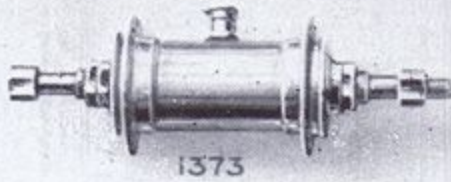

The above illustration applies to models supplied 1922 and prior. For later type see "The Book of the Scott" (1926), page 63.

Always quote Engine No. and Type of Machine.

BARNSTONMERS.CO.UK

BRAKES.

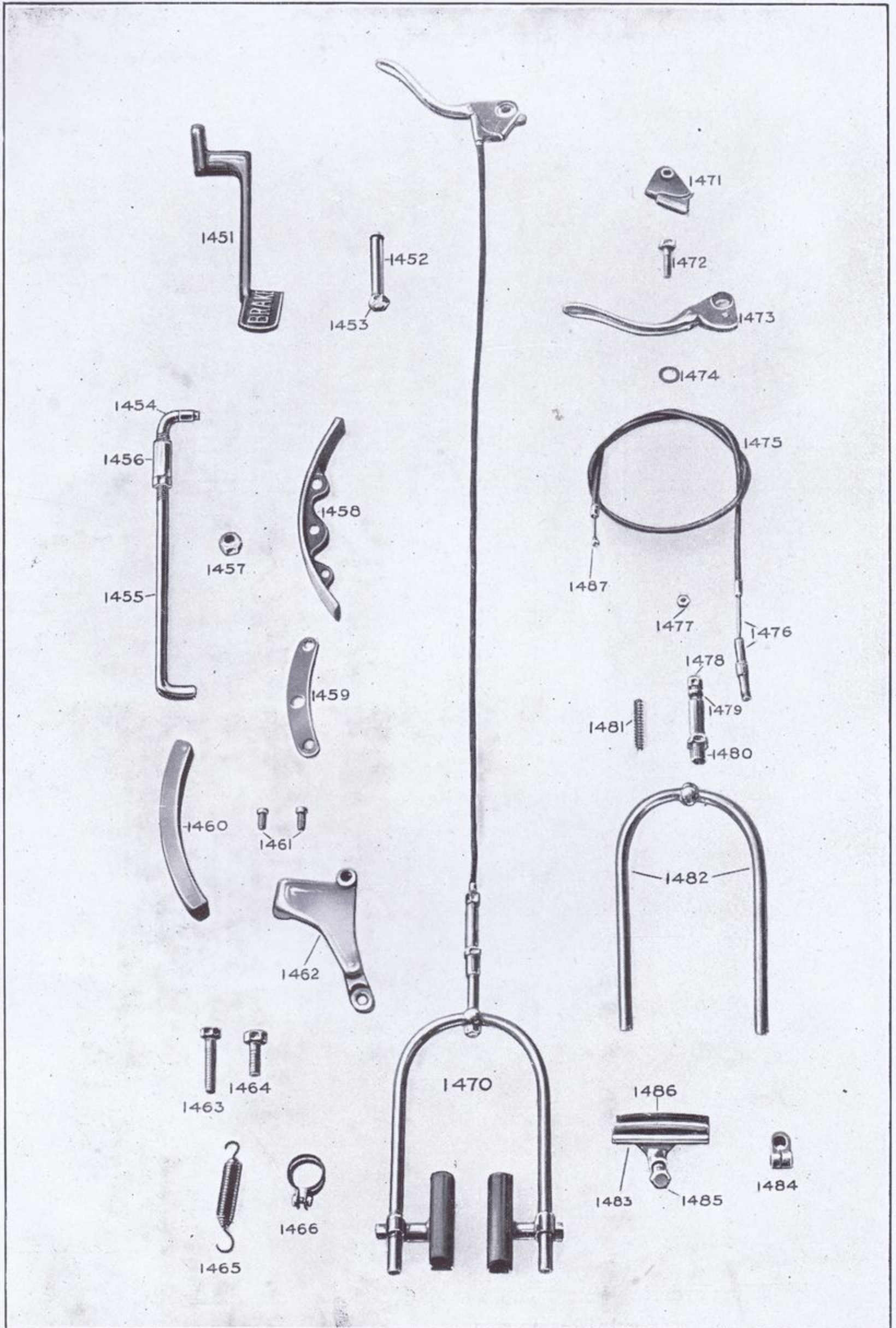

The above front brake parts are for models supplied 1922 and prior. For later types see "The Book of the Scott" (1926), page 63. The rear brake parts shown are for 1923 and prior; for later types see pages 22 and 23.

Always quote Engine No. and Type of Machine.

PETROL TANK, FOOTBOARDS, ETC.

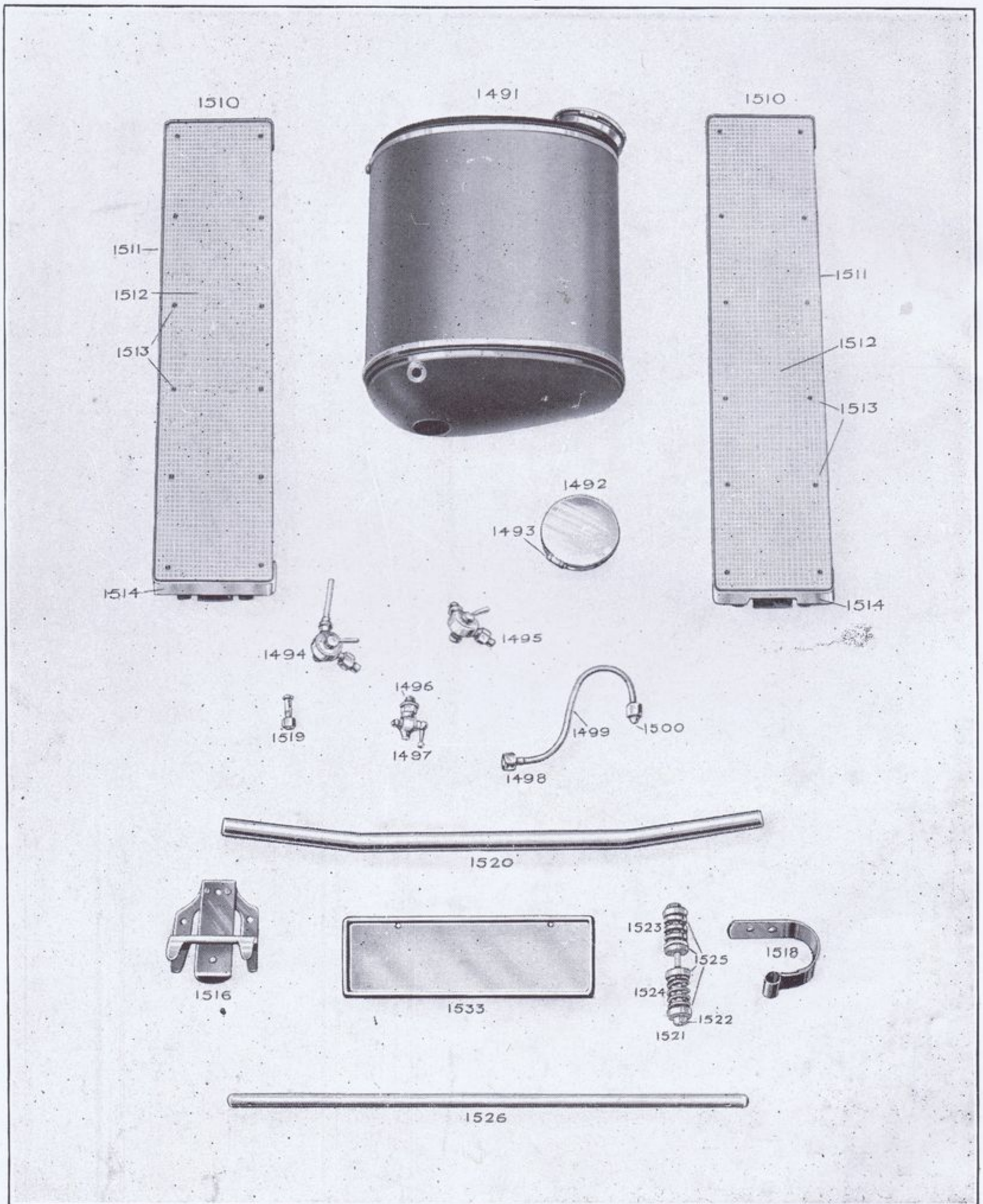

When ordering Petrol Tanks state overall length and capacity.
 Part No. 1518 is now superseded by flat leaf spring.

Always quote Engine No. and Type of Machine.

BARNSCORPERS.CO.UK

WIND SHIELDS AND GEAR SHIELDS.

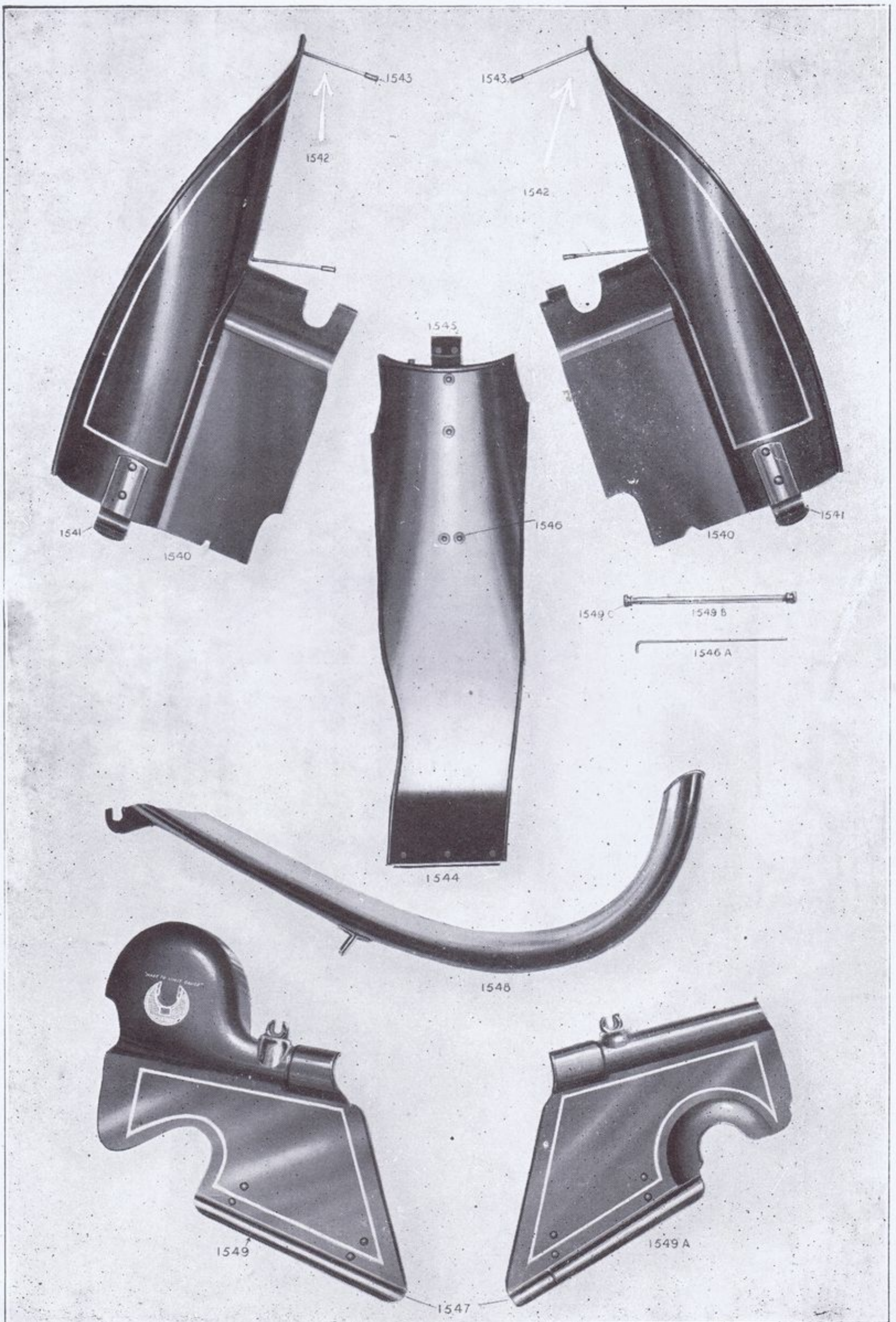

The above Wind Shields and Undershield are for Touring Models.
If Squirrel Type is required specify when ordering.

Always quote Engine No. and Type of Machine.

SUNDRIES.

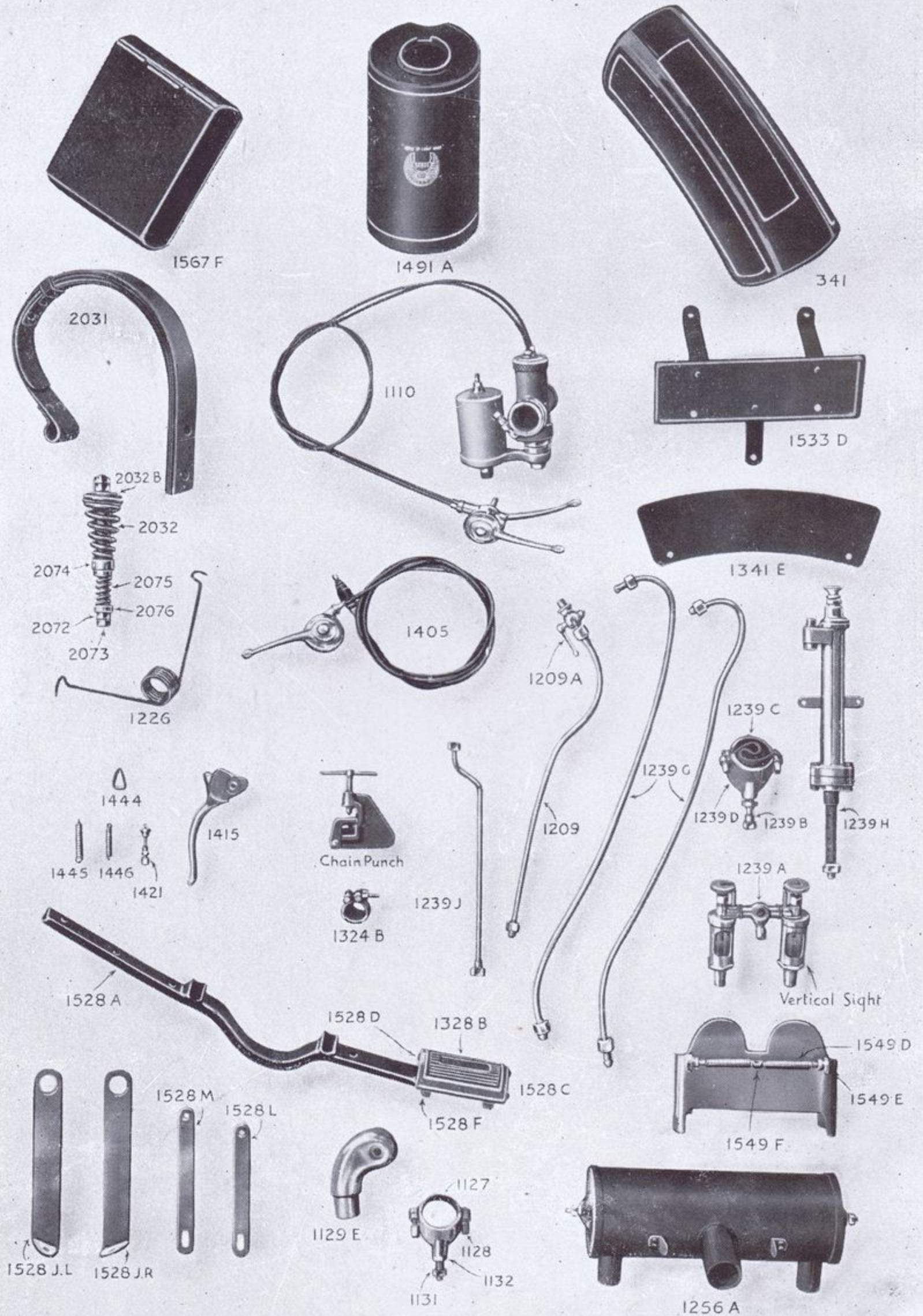

Tool Box 1567F has now been discarded and is superseded by Tool Box 1567M as shown on page 21. C Spring 2031 has now been superseded by V type Spring.

When ordering Silencers state diameter of inlet and outlet(s).

Always quote Engine No. and Type of Machine.

THREE-SPEED GEAR BOX.

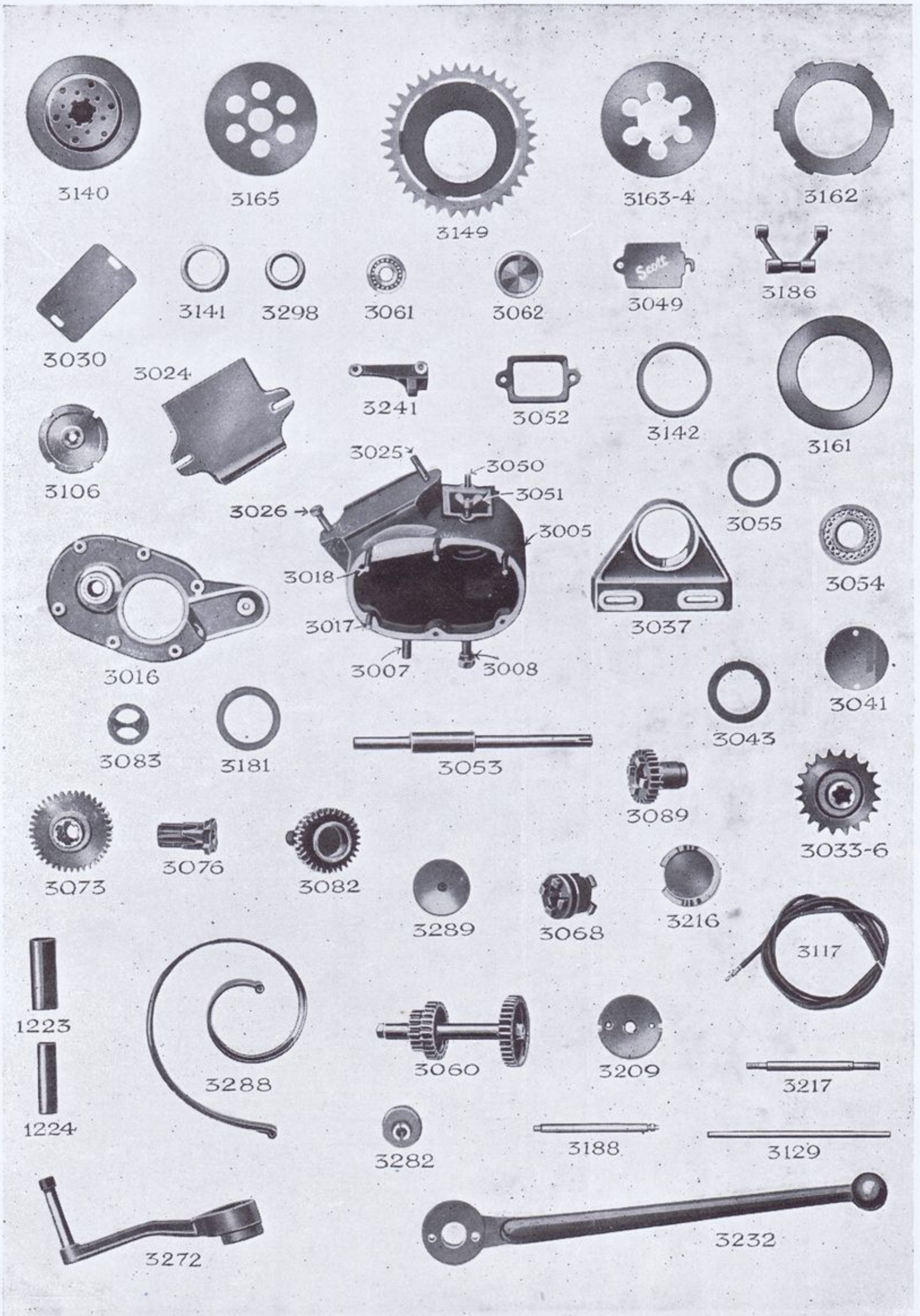

The above illustrations are for Gear Boxes of the 1923 to 1925 type.
 For latest type Gear Box see "The Book of the Scott" (1926), page 61.

When ordering replacements state Gear Box No. as well as Engine No.

THREE-SPEED GEAR BOX.

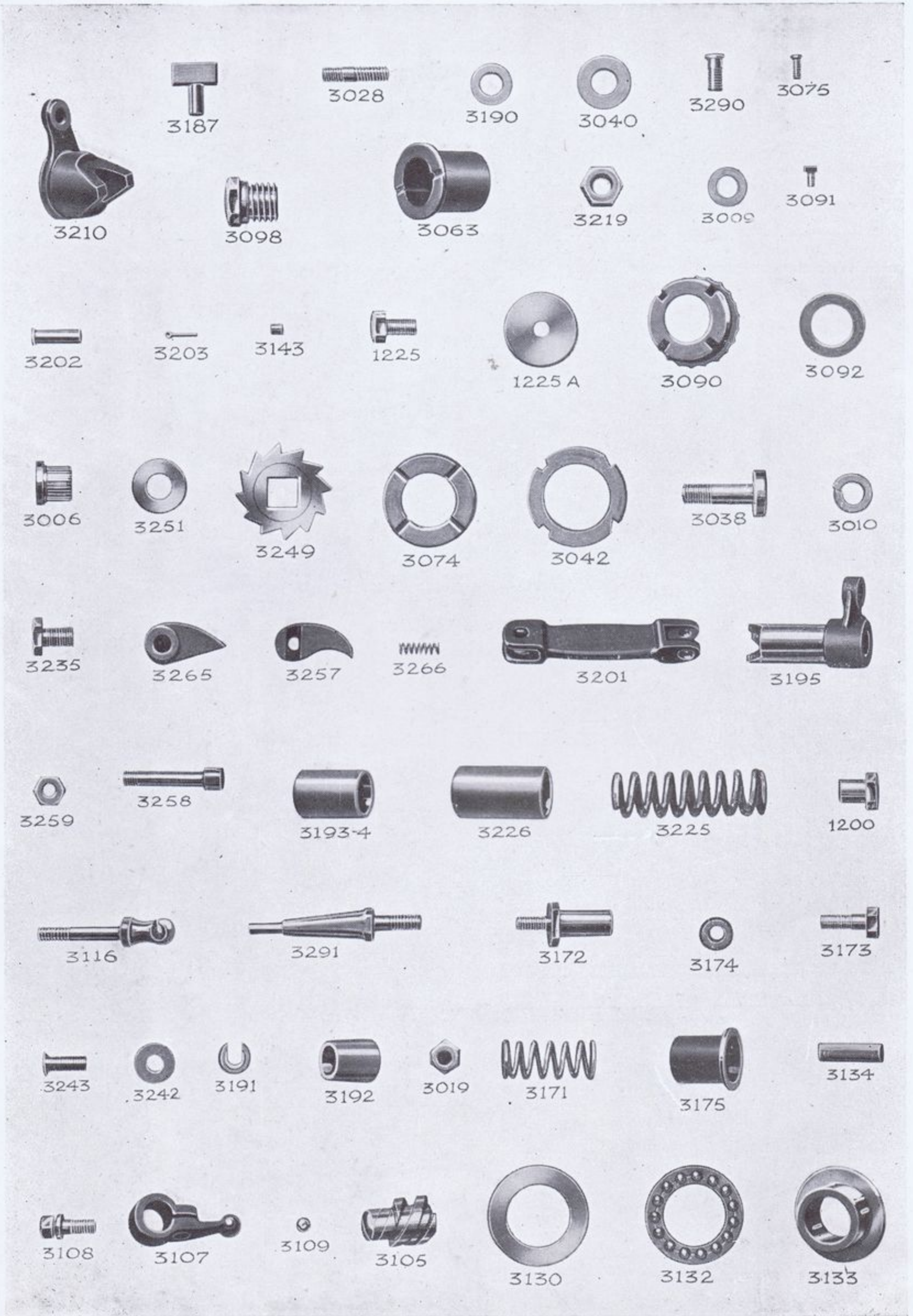

The above illustrations are for Gear Boxes of the 1923 to 1925 type.
For latest type Gear Box see "The Book of the Scott" (1926), page 61.

When ordering replacements state Gear Box No. as well as Engine No.

THREE-SPEED MODELS.

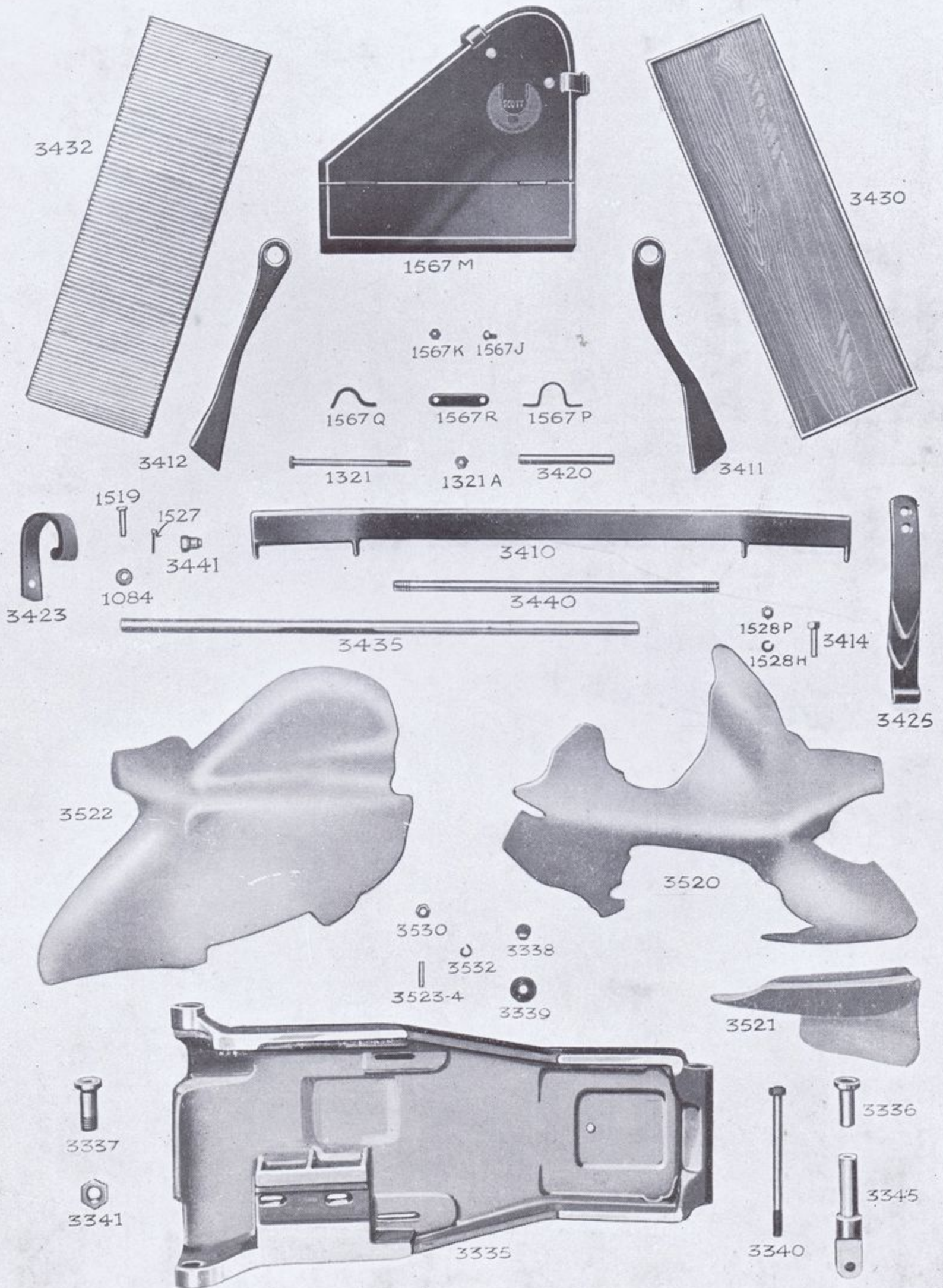

The above illustrations of Parts Nos. 3335, 3411, 3412, and 3520 to 3522 are for 1923 to 1925 models.

When ordering these state Gear Box No. as well as Engine No.

BACK WHEEL & BRAKE FOR THREE-SPEED MODELS.

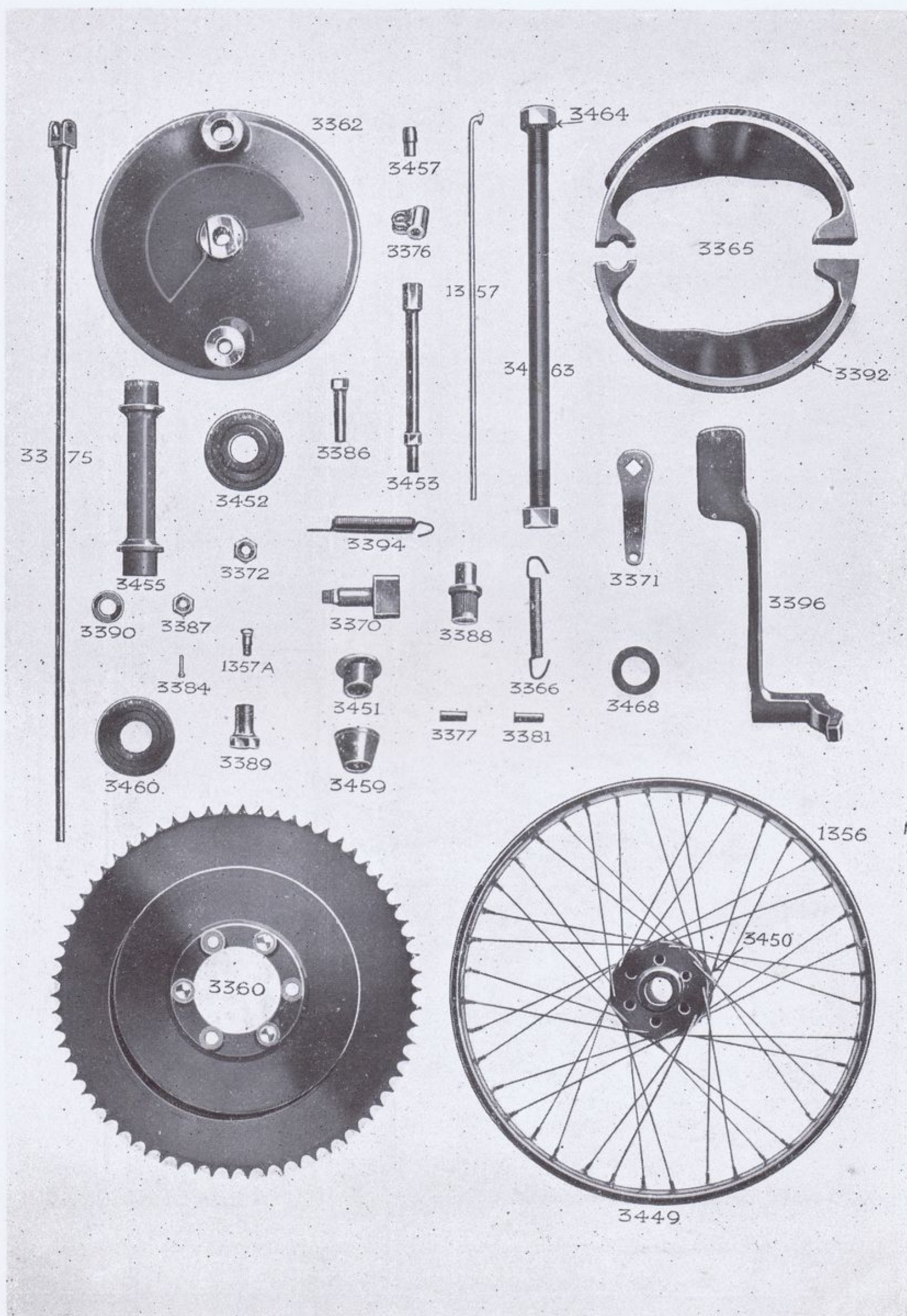

The above parts are for all Three-Speed Models irrespective of date.

Always quote Engine No. and Type of Machine.

Barnstormers.com

BACK WHEEL & BRAKE FOR TWO-SPEED MODELS.

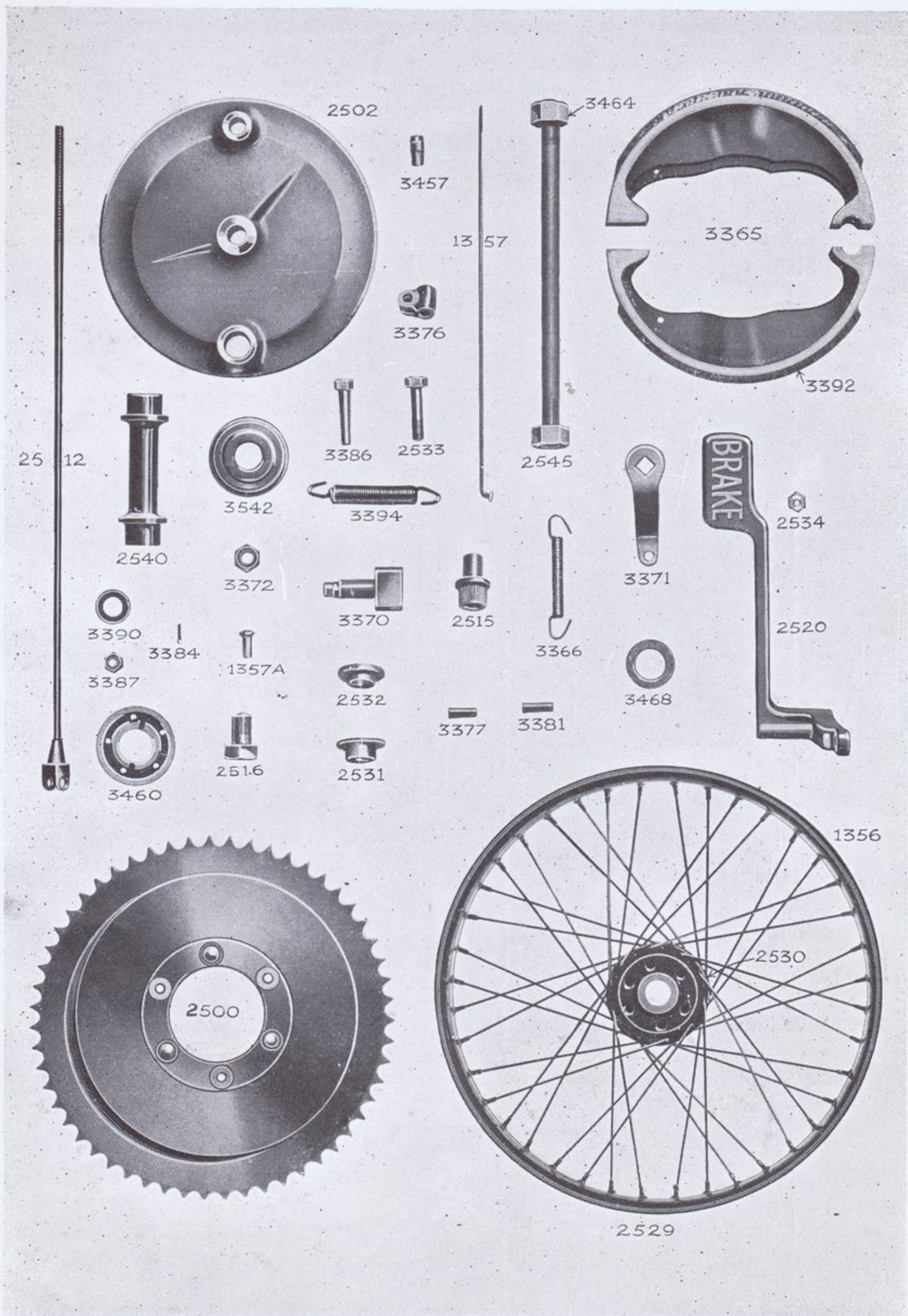

The above parts are for Two-Speed Models of 1924 and later.

Always quote Engine No. and Type of Machine.

Barnstormers.co.nz

SIDECAR.

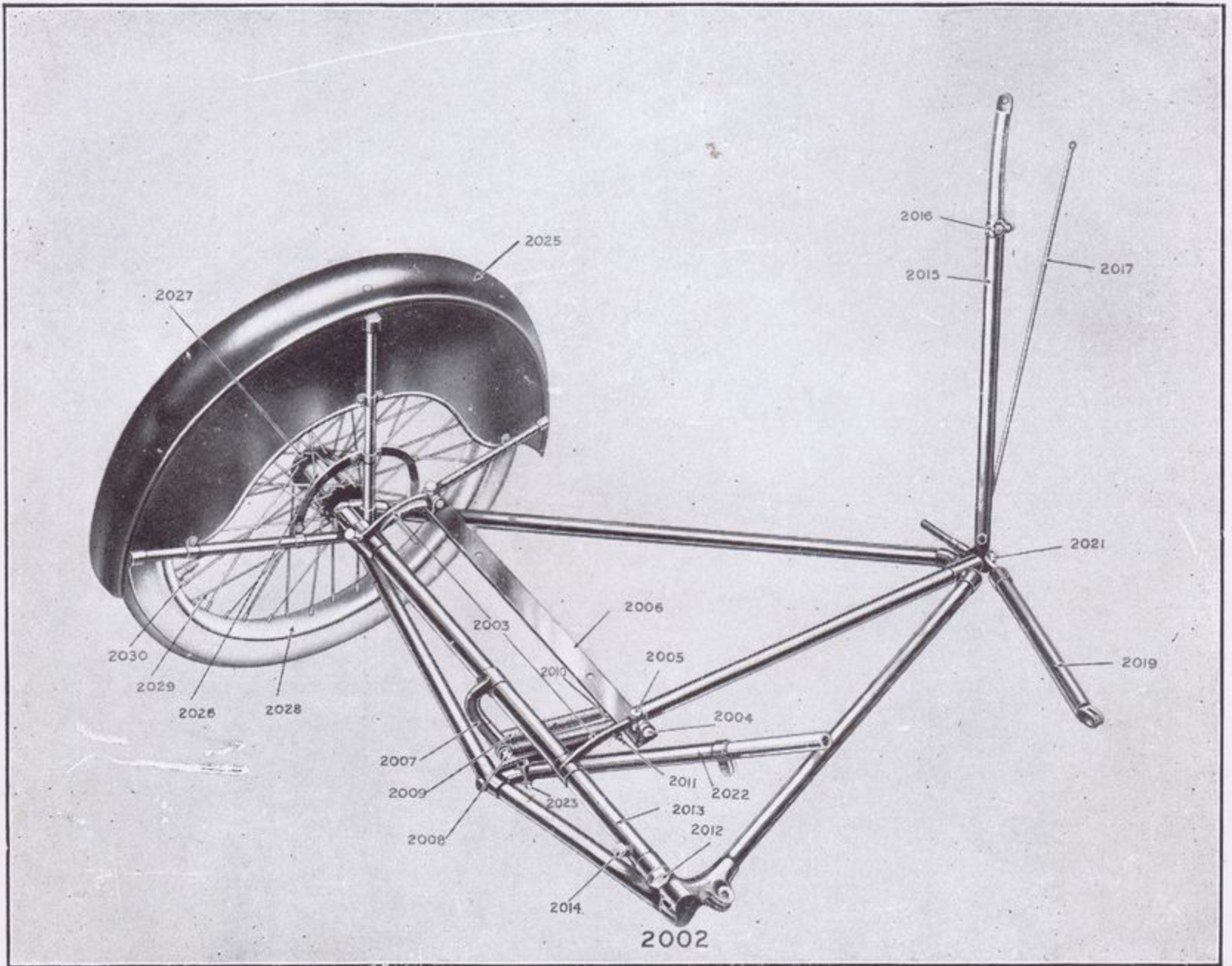

The above illustration is of the Type S Chassis. Stay No. 2015 is shown Telescopic ; this has been discarded and a plain stay substituted. When ordering state length.

For Body Springs see page 18.

When ordering Frame connections state whether for Two or Three-speed Machines.

For old type Wheel Bearings send pattern.

BARNSTORMERS.CO.NZ

ERNEST CUMMINS, BRADFORD.

