

BARNSTORMERS.CO.NZ

SERIES "B"

# Catalogue

**GARTON & DAY**  
CYCLE & MOTORCYCLE DEALERS  
PHONE 2521.  
39 BANK ST. WHANGAREI

of



for

# **BSA**

## **Winged Wheel**

### **Model W1**



When ordering replacement parts, the part number should always be quoted thus ensuring that the correct component is supplied.

Plate Ref. No	Part Number	Description.	No. per set	Price
—	62-316	Wheel with hub and spokes only (26"x1½")	1	£ 2 16 0
—	62-330	Wheel with hub and spokes only (28"x1½")	1	2 17 0
1	1-5991	Cable clip (rubber) ... ..	3	2
2	62-345	Combined spanner ... ..	1	1 8
3	32-9310	Spanner ( $\frac{5}{16}$ "x $\frac{3}{8}$ ") ... ..	1	1 6
4	62-458	B.S.A. badge ... ..	1	1 6
5	62-469	Badge retaining screw ... ..	4	6d. doz.
6	62-296	Crankcase inner cover oil seal ... ..	1	2 6
7	62-303	Crankcase inner cover ... ..	1	1 6 0
8	86-1256	Clutch shaft bearing ... ..	1	P.O.A.
9	62-164	Grit protection washer ... ..	1	3
10	62-176	Clutch operating plate ... ..	1	2
11	62-163	Clutch shaft ... ..	1	5 6
12	62-181	Clutch spring housing ... ..	10	2/6 doz.
13	62-180	Clutch spring ... ..	10	2
14	62-179	Clutch spring back plate ... ..	1	1 6
15	62-175	Clutch spring plate ... ..	1	1 3
16 18	62-173	Clutch driving plate complete with inserts .	2	2 3
17	62-172	Clutch driven plate (outer) ... ..	1	1 0
19	62-171	Clutch driven plate (inner) ... ..	1	1 0
20	62-193	Crankcase inner cover joint washer... ..	1	1
21	62-168	Clutch gear wheel complete with bush and inserts ... ..	1	12 0
22	62-166	Clutch driven back plate ... ..	1	9
23, 25	62-362	Grit protection washer ... ..	2	3
24	62-165	Clutch bearing circlip ... ..	1	2
26	86-1256	Clutch shaft bearing ... ..	1	P.O.A.
27	62-178	Clutch operating rod seal ... ..	1	1
28	62-177	Clutch operating rod ... ..	1	3
29	62-142	Magneto complete (Wico-Pacy) ... ..	1	P.O.A.
—	62-486	Magneto complete (Miller) ... ..	1	P.O.A.
30	21-5103	Magneto fixing nut ... ..	1	4
31	62-307	Drain screw ... ..	1	2
32	36-382	Magneto fixing nut washer (shakeproof) ...	1	6d. doz.
*33	62-120	Crankcase outer cover... ..	1	8 3
34	62-388	Crankcase outer cover oil seal ... ..	1	1 6
35	62-358	Roller outer race ... ..	1	3 0
36	62-138	Crankcase roller ... ..	13	P.O.A.
37	62-359	Spacing collar ... ..	1	1 0
38	62-138	Crankcase roller ... ..	13	P.O.A.
39	62-143	Crankshaft key ... ..	2	4
40	62-123	Flywheel and connecting rod assembly ...	1	1 10 0
41	62-107	Crankcase outer cover fixing stud (short)...	2	2/6 doz.
42	62-115	Crankcase outer cover fixing stud dowel bush	1	2/6 doz.
43	62-117	Oil filler bracket joint washer ... ..	1	3d. doz.
44	62-116	Oil filler bracket ... ..	1	1 6
45	62-118	Oil filler bracket stud ... ..	2	1/9 doz.
46	29-3319	Oil filler bracket stud washer (shakeproof)	2	6d. doz.
47	21-5161	Oil filler bracket stud nut ... ..	2	9d. doz.
48	62-452	Ball cage with balls ... ..	1	5

\* If 62-120 Crankcase outer cover is required, the Crankcase 62-102 should be returned for matching and selection of suitable spacing collar 62-359.



Plate Ref. No	Part Number	Description	No. per set	Price
49	62-184	Hub dust cap (large) (no longer fitted) ...	1	£ s. d. 3
50	28-43	Crankcase oil filler plug ... ..	1	6
51	62-138	Crankcase roller ... ..	13	P.O.A.
52	62-111	Roller outer race ... ..	1	2 3
53	62-388	Crankcase oil seal ... ..	1	1 6
54	62-139	Crankshaft pinion ... ..	1	1 9
55	62-242	Clutch release lever pivot ... ..	1	6
56	35-701	Clutch release lever split pin ... ..	2	4d. doz.
57	8-1359	Retaining pin washer (steel and alloy shoe)	2	6d. doz.
58	62-240	Retaining pin spring (steel shoe only) ...	2	3
59	2-1096	Retaining pin washer (steel shoe only) ...	2	4d. doz.
—	62 563	Retaining pin washer (spring)(alloy shoe only)	2	9d. doz.
60	35-701	Retaining pin washer split pin (steel shoe only)	2	4d. doz.
—	62-561	Retaining pin nut (self-locking)(alloy shoe only)	2	1
61	62-236	Brake shoe return spring (steel shoe only) .	1	8
—	62-479	Brake shoe return spring (alloy shoe only).	1	4
62	62-235	Brake shoe lining (steel and alloy shoe) ...	2	P.O.A.
63	62-224	Brake shoe lining rivet (steel shoe only) ...	10	3d. doz.
—	62-551	Brake shoe lining rivet (alloy shoe only) ...	8	3d. doz.
64	35-702	Anchor plate split pin (steel and alloy shoe)	2	4d. doz.
65	62-451	Anchor plate washer (steel and alloy shoe).	2	2
66	21-5204	Crankshaft pinion nut... ..	1	4
67	62-140	Pinion tab washer ... ..	1	9d. doz.
68	62-290	Hub spindle ... ..	1	3 9
69	62-313	Hub spindle oil seal ... ..	1	6
70	62-456	Hub shell and driven gear ... ..	1	P.O.A.
71	29-925	Hub centre key ... ..	1	4
72	62-299	Crankcase inner cover bush (not sold separately)	1	1 3
73	62-110	Crankcase inner cover fixing stud ... ..	9	1/6 doz.
74	62-115	Crankcase inner cover dowel bush ... ..	2	2/6 doz.
75	29-541	Crankcase inner cover fixing stud washer (shakeproof) ... ..	9	6d. doz.
76	21-5102	Crankcase inner cover fixing stud nut ...	9	2
77	62-365	Rear wheel spoke (for use with 26"x1½" wheel) (12 gauge) ... ..	36	5/9 grs.
—	62-332	Rear wheel spoke (for use with 28"x1½" wheel) (12 gauge) ... ..	36	5/9 grs.
78	62-317	Rear wheel rim (26"x1½") ... ..	1	18 0
—	62-331	Rear wheel rim (28"x1½") ... ..	1	19 0
79	62-351	Roller retainer drive spring ... ..	1	2
80	14-3596	Driving piece circlip ... ..	1	3d. doz.
81	62-291	Roller retainer driver ... ..	1	1 6
82	14-3575	Ball cage with balls ... ..	1	7
83	14-3593	Driving piece ... ..	1	4 6
84	62-540	Hub nut lockwasher ... ..	1	3
85	62-297	Hub shell nut ... ..	1	1 6
86	62-367	Spoke nipple (12 gauge) ... ..	36	7/9 grs.
87	62-295	Dust cover ... ..	1	3
88	62-374	Sprocket (18T) ... ..	1	1 9
89	1-1797	Locking ring ... ..	1	8
90	1-4675	¼" diameter steel ball ... ..	10	P.O.A.
91	62-350	Fixed cone ... ..	1	9
92	14-3614	Oil seal assembly complete ... ..	1	5
93	62-376	Cone locking washer ... ..	1	5



# BSA Winged Wheel

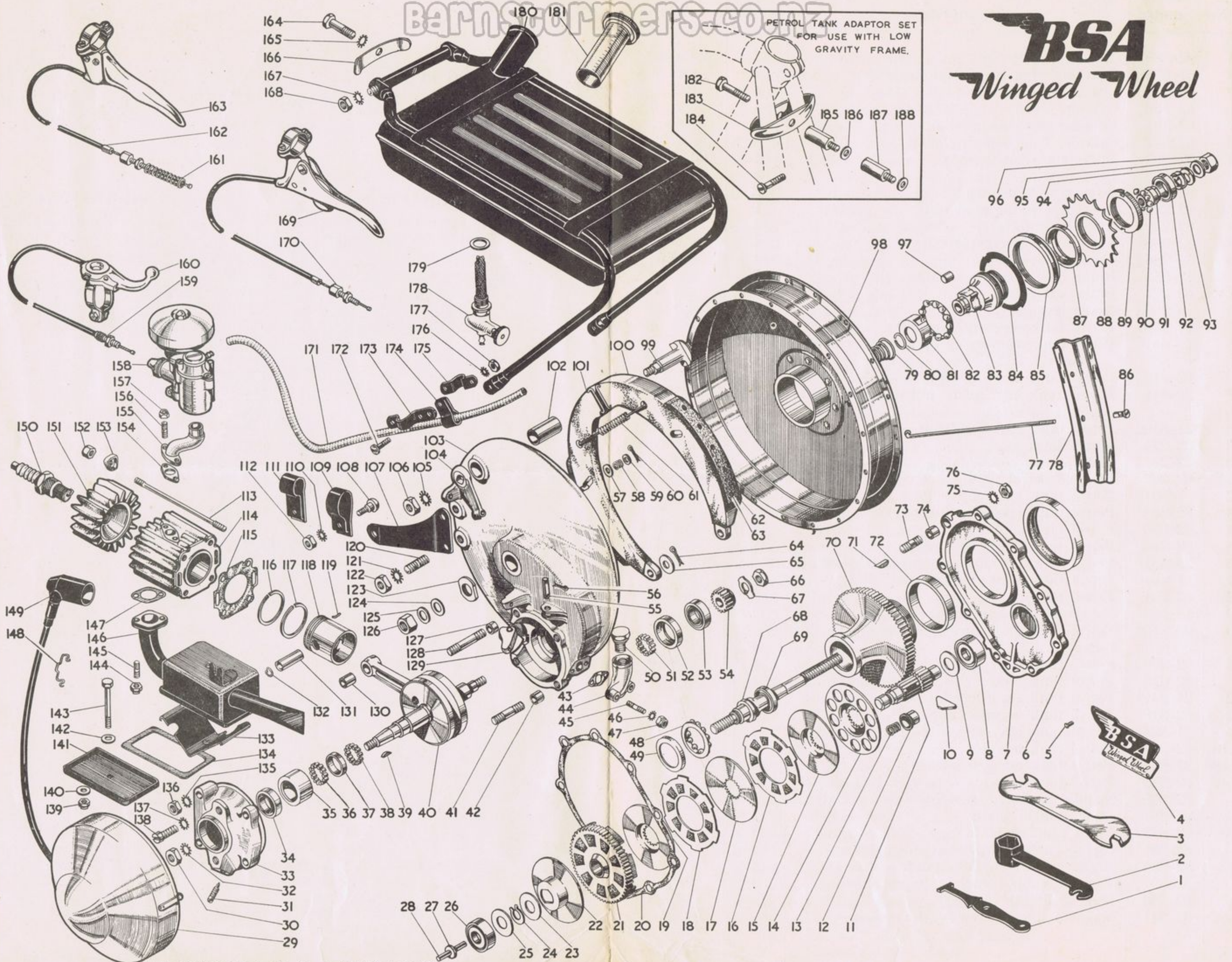



Plate Ref. No	Part Number	Description	No. per set	Price
94, 95	1-1804	Rear hub spindle washer ... ..	2	£ s. d. 1
96	11-3038	Rear hub spindle nut ... ..	1	3
97	14-3594	Driving piece roller ... ..	5	2
98	62-198	Rear hub complete ... ..	1	1 10 0
99	62-314	Brake cam complete ... ..	1	4 0
100, 101	62-228	Brake shoes complete (steel)... ..	2	15/6 pr.
—	62-474	Brake shoes complete (alloy) ... ..	2	15/6 pr.
102	62-113	Brake cam bush ... ..	1	9
103	62-102	Crankcase complete with outer cover and fittings ... ..	1	3 8 1
104	62-238	Brake cam lever ... ..	1	2 0
105	36-382	Brake cam washer (shakeproof) ... ..	1	6d. doz.
106	21-5103	Brake cam nut ... ..	1	4
107	62-309	Torque link ... ..	1	5
108	14-3579	Torque clip bolt ... ..	1	1/9 doz.
109	62-246	Torque clip (Roadster) with nut and bolt... ..	1	9
110	1-5954	Torque clip bolt washer (plain) ... ..	1	3d doz.
111	62-321	Torque clip (Sports) with nut and bolt ... ..	1	9
112	1-8417	Torque clip bolt nut ... ..	1	1
113	62-106	Cylinder fixing stud ... ..	4	6
114	62-146	Cylinder barrel ... ..	1	17 6
115	62-145	Cylinder barrel and crankcase joint washer... ..	1	3d. doz.
116, 117	62-153	Piston compression ring ... ..	2	2/- ea.
118	62-151	Piston complete with gudgeon pin, rings, circlips and pegs ... ..	1	13 0
119	62-156	Piston ring retaining peg ... ..	2	3d. doz.
120	35-4341	Torque link stud ... ..	2	4
121	36-382	Torque link washer (shakeproof) ... ..	2	6d. doz.
122	21-5103	Torque link nut ... ..	2	4
123	62-385	Rear hub spindle locknut ... ..	1	8
124, 125	1-1804	Rear hub spindle washer ... ..	2	1
126	11-3038	Rear hub spindle nut ... ..	1	3
127	62-115	Crankcase outer cover fixing stud dowel bush ... ..	1	2/6 doz.
128	62-108	Crankcase outer cover fixing stud (long) ... ..	2	3
129	62-302	Clutch release lever ... ..	1	1 0
130	62-126	Small end bush ... ..	1	9
131	62-154	Gudgeon pin ... ..	1	1 0
132	62-155	Gudgeon pin circlip ... ..	1	3
133	62-219	Silencer baffle ... ..	1	6
134	62-227	Silencer body cover washer ... ..	1	2
135	29-541	Crankcase outer cover fixing nut washer (shakeproof) ... ..	4	6d. doz.
136	21-5102	Crankcase outer cover fixing nut ... ..	4	2
137	29-541	Magneto fixing screw washer (shakeproof)... ..	2	6d. doz.
138	65-2158	Magneto fixing screw ... ..	2	4
139	62-221	Silencer bolt locknut ... ..	1	1
140	2-1865	Silencer bolt washer ... ..	1	4d. doz.
141	62-470	Silencer body cover ... ..	1	6
142	2-1865	Silencer bolt washer ... ..	1	4d. doz.
143	21-5364	Silencer body cover bolt ... ..	1	4
144	62-221	Exhaust pipe stud nut ... ..	2	1
145	62-148	Exhaust pipe stud ... ..	2	1/3 doz.
146	62-215	Exhaust assembly complete ... ..	1	9 0
147	62-226	Exhaust flange washer ... ..	1	6d. doz.



Plate Ref. No	Part Number	Description	No. per set	Price
148	62-369	Magneto cable clip ... ..	1	2/6 doz.
149	67-985	Sparking plug cover and suppressor ...	1	P.O.A.
150	62-338	Sparking plug (14mm.) ... ..	1	P.O.A.
151	62-158	Cylinder head ... ..	1	7 0
152	62-161	Cylinder head securing nut ... ..	4	1
153	62-542	Cylinder head securing plate ... ..	4	2
154	62-207	Inlet pipe joint washer ... ..	1	6d. doz.
155	62-206	Inlet pipe ... ..	1	2 6
156	62-148	Inlet pipe fixing stud ... ..	2	1/3 doz.
157	62-221	Inlet pipe fixing stud nut ... ..	2	1
158	62-209	Amal carburetter ... ..	1	P.O.A.
159	62-283	Throttle cable complete ... ..	1	P.O.A.
160	62-286	Throttle lever ... ..	1	P.O.A.
161	62-353	Brake cable tension spring ... ..	1	3
162	62-277	Brake cable complete ... ..	1	4 0
163	8-2048	Brake lever ... ..	1	5 6
164	21-5407	Petrol tank securing clip bolt ... ..	1	4
165	29-541	Petrol tank securing clip bolt washer (shakeproof) ... ..	1	6d. doz.
166	62-319	Petrol tank securing clip ... ..	1	6
167	29-541	Petrol tank bar fixing nut washer (shakeproof) ... ..	1	6d. doz.
168	21-5102	Petrol tank bar fixing nut ... ..	1	2
169	62-274	Clutch lever ... ..	1	P.O.A.
170	62-271	Clutch cable complete ... ..	1	4 0
171	62-262	Flexible petrol pipe ... ..	1	10
172	1-6019	Petrol tank stay clip bolt ... ..	6	1
173	62-265	Petrol tank stay clip (outside) ... ..	2	3
174	62-370	Petrol pipe clip ... ..	1	3
175	62-266	Petrol tank stay clip (inside) ... ..	2	3
176	29-3319	Petrol tank stay clip bolt washer (shakeproof)	6	6d. doz.
177	1-4616	Petrol tank stay clip bolt nut ... ..	6	1
178	62-261	Petrol tap ... ..	1	4 0
179	15-792	Petrol tap washer (fibre) ... ..	1	2
180	62-250	Petrol tank and carrier complete (less filler cap) ... ..	1	1 12 6
181	62-259	Petrol tank filler cap and measure ... ..	1	5 0
—	62-378	Petrol tank adaptor set, comprising ...	1	} 3/3 per set
182	21-5411	Petrol tank securing clip bolt ... ..	1	
183	62-319	Petrol tank securing clip ... ..	1	
184	1-3241	Petrol tank stay clip bolt ... ..	4	
185, 187	62-384	Petrol tank adaptor ... ..	2	
186, 188	27-8560	Petrol tank adaptor washer ... ..	2	
—	62-263	Petrol pipe securing clip with bolt and nut	2	6
—	62-375	Spindle packing washer (crankcase end) ...	1	1
—	62-381	Rear number plate ... ..	1	4 6
—	62-383	Front number plate ... ..	1	2 9
—	62-391	Clutch cable complete (tandem fitting) ...	1	6 0
—	62-394	Brake cable complete (tandem fitting) ...	1	6 0
—	62-397	Throttle cable complete (tandem fitting) ...	1	4 0
—	62-538	Hub shell ring (rubber) ... ..	1	5
—	62-541	Magneto fixing screw washer (plain) ...	2	3d. doz.



# BARNSTORMERS.CO.NZ

## SPARKING PLUG (N.7)

Champion Sparking Plugs Ltd.,  
Feltham, Middlesex.

## MAGNETO (MIGEMAG, S90)

Messrs. Wico-Pacy, Denbigh Road,  
Bletchley, Bucks.

## CARBURETTER (335/1)

Messrs. Amalgamated Carburetters  
Ltd., Perry Barr, Birmingham.

## MAGNETO (Type BS9)

Messrs. H. Miller & Co. Ltd.,  
Aston Brook Street, Birmingham



**B.S.A. CYCLES LTD., WAVERLEY WORKS**  
**BIRMINGHAM, 10**

*Directors:*

SIR BERNARD DOCKER, K.B.E. (*Chairman*).  
J. LEEK C.B.E.    J. A. T. DICKINSON, O.B.E.    S. F. DIGBY.  
T. P. WHITTINGTON.

*Telephone:* BIRMINGHAM, VICTORIA 3711 (6 lines).  
*Telegrams and Cables:* "SELCYC, BIRMINGHAM."