

LIST of SPARE PARTS

FOR

ROYAL ENFIELD
MADE LIKE A GUN

2.25 h.p.

MOTOR CYCLES

MODELS A & B

R. G. McBURNEY,
Motor Engineer & Cycle Agent,
BRIDGE STREET,
BALLYMENA.

Issued January 1st, 1930.

PRICE 1/-



January 1st, 1930.

£15

A LIST of
Spare and Replacement Parts
for

ROYAL ENFIELD

2.25 h.p. MOTOR CYCLES.
MODELS A & B.

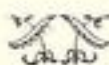

Compiled and Published by
THE ENFIELD CYCLE CO. LTD.
REDDITCH.

Telegrams: "Cycles, Phone, Redditch."

Telephone: Redditch 121 (5 lines).

LONDON SHOWROOMS:
48 HOLBORN VIADUCT, E.C.1.

Telegrams: "Jigger, Cent. London."

Telephone: 5822 and 5823 Holborn.

LONDON SERVICE DEPOT:
5, 7, 9, HATTON WALL, HATTON GARDEN, E.C. 1.
Telephone: 2508 Holborn.

Contractors to H.M. Government, the French and Belgian Governments,
and the former Russian Imperial Military Authorities.

All prices of Spare and Replacement Parts are subject to revision or modification, at our discretion, without notice.

Our terms are STRICTLY NET CASH WITH ORDER, or cash on receipt of PRO-FORMA INVOICE. Repairs and sundries items cannot be booked. Prices do not include cost of carriage or postage.

Any part or complete motor cycle sent for repair should be consigned CARRIAGE PAID, and the sender's name and address should be given in full on the address tally. Parts sent to us Carriage Forward are liable to be refused, and to lie with the carriers at sender's risk and expense.

Full instructions regarding the necessary repairs to be done, with advice as to the mode of despatch of the machine (or part), should be posted the same day.

When forwarding motor cycles for repair it is advisable to remove all accessories and easily detached fittings, such as lamp, horn, toolbags, etc. Besides facilitating the work of repair, it will also prevent any loss during transit.

Order all parts by the name of the article and the NUMBER PRECEDING IT, also state the number of the engine or machine for which they are intended. The engine number will be found stamped on the crank case and the machine number on the lug through which the front sidecar coupling bolt passes.

GUARANTEE.

We respectfully refer customers to the terms of our guarantee, which appears on page 32 of this list.

When forwarding a complete motor cycle, engine, carburetter or magneto with the request that we overhaul the same, we understand by the term "overhaul" that it is to be entirely dismantled, thoroughly renovated, any worn parts renewed, and put in perfect working order. In case a customer desires only certain parts attended to, full instructions should be given us to that effect, otherwise the cost may be in excess of that anticipated.

ESTIMATES AND QUOTATIONS.

When customers send complete motor cycles or parts thereof to us for repairs, we are always prepared to furnish estimates before proceeding with the necessary work. At the same time, it must be distinctly understood that we can only give approximate quotations. Frequently, when the actual work is in progress, it is found necessary to replace parts other than those specified in the estimate, as we make a practice of including in such estimates only those items and parts which at the time we consider really essential to put the machine (or parts) in a thoroughly satisfactory condition.

If any estimate prepared in this way is not accepted, we reserve the right to make a nominal charge for taking down and re-assembling any parts necessary in preparing it.

We cannot hold ourselves responsible for loss of, or damage to, any parts lying at our works for repairs, unless instructions to proceed with same are given within twenty-one days of our estimate for the said repairs having been rendered.

All acetylene-welded repairs to crank cases and other aluminium parts are carried out with extreme care, but we cannot give any guarantee with, or accept responsibility for, any parts so treated.

ROYAL ENFIELD 2.25 H.P. MOTOR CYCLES.

ENGINE.—MODEL A.30

Illustration No.	Quote this No. and name of part when ordering.	Description.	Price.		
			£	s.	d.
1	600F	Crankcase with main bearing races	1	15	0
2	2F	" main bearing race	0	3	6
3	3F	" drain plug	0	0	3
4	4F	" " washer	0	0	1
5	6F	" stud (long)	0	0	4
6	7F	" " (short)	0	0	3
7	349D	" nut...	0	0	2
8	350D	" washer	0	0	1
9	13553	" distance piece	0	0	2
10	14029	Crankshaft (flywheel side)	1	0	0
11	11F	" (driving side)	0	17	6
12	5D	" bearing roller (each)	0	0	3
13	13F	" " cage	0	2	6
14	14F	" " washer	0	0	3
15	15F	" sleeve	0	1	6
16	16F	" " corrugated washer	0	0	3
17	17F	" " fibre washer	0	0	4
18	18F	Crank pin	0	3	6
19	19F	" " nut	0	0	9
20	20F	Connecting rod with small end bush	0	12	6
21	21F	" " small end bush	0	1	6
	5D	" " big end roller (each) (as illus. 12)	0	0	3
	13F	" " " cage (as illus. 13)	0	2	6
22	24F	" " " washer	0	0	4
23	14178	Flywheel	0	15	0
24	14182	" nut	0	1	6
25	27F	" washer	0	0	4
26	14181	" extractor nut	0	1	6
	601F	Oil pump complete	1	10	0
27	14031	" " body	0	15	0
28	123E	" " " screw	0	0	2
29	105D	" " " joint	0	0	3
30	94D	" " " cover	0	1	0
31	95D	" " " screw	0	0	2
32	883D	" " spindle	0	2	6
33	99D	" " disc	0	5	0
34	100D	" " spring	0	0	2
35	102D	" " plunger	0	2	0
36	14032	" " regulator spindle	0	2	0
37	14034	" " " knob	0	0	9
38	888C	" " " nut	0	0	1
39	10480	" " " washer	0	0	1
40	14033	" " " plunger	0	0	2
41	884C	" " " spring	0	0	1
42	14295	" " " locknut	0	0	1
43	885C	" " " gland washer	0	0	1
44	14320	" " " spring washer	0	0	2
45	47F	" " " steel washer	0	0	1
46	14028	" " connection pin	0	0	9
47	14D	" " union	0	0	9
48	104D	" " " washer	0	0	1

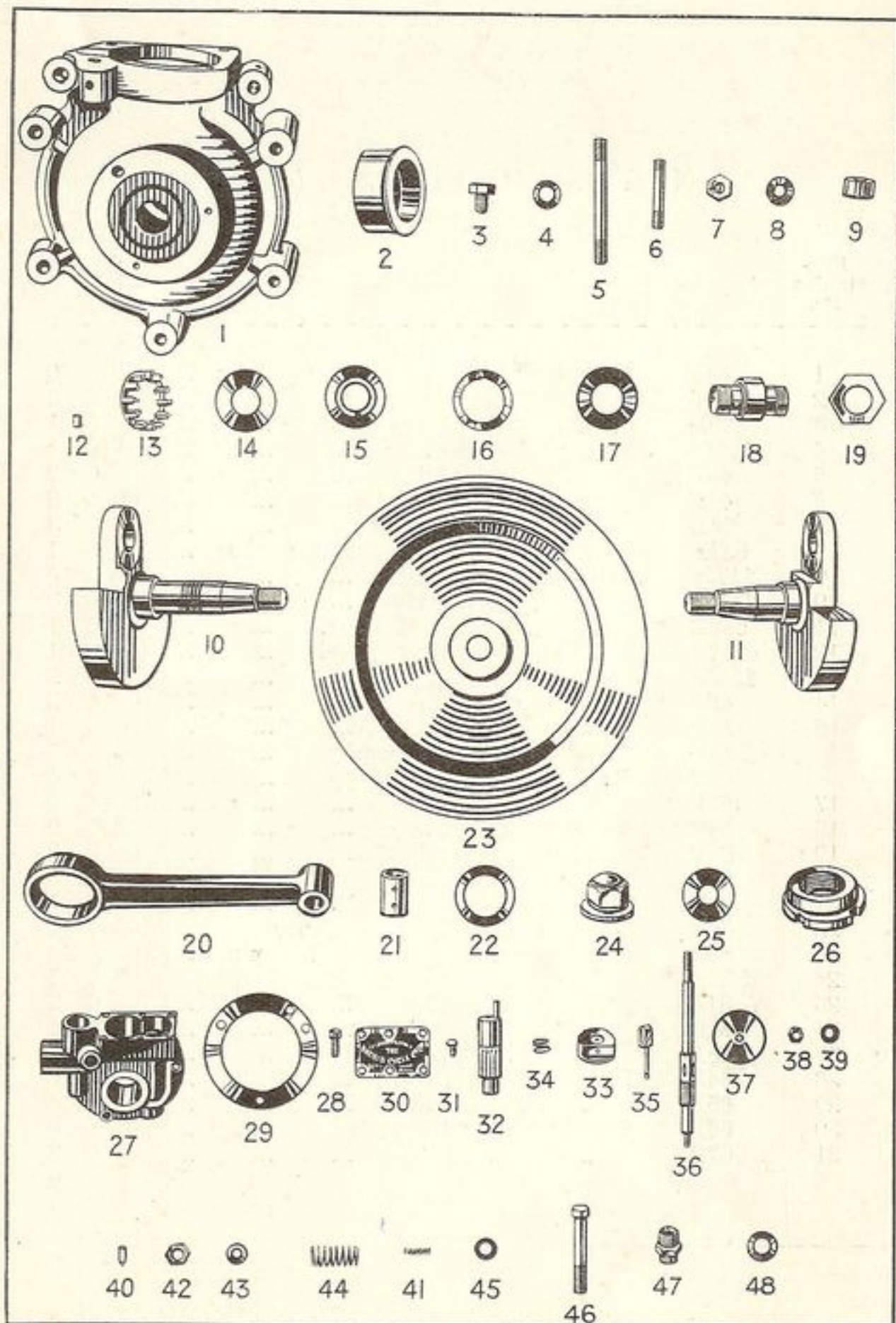

See opposite page for description and price.

ROYAL ENFIELD 2.25 H.P. MOTOR CYCLES.

ENGINE.—MODEL A.30—(continued).

Illustration No.	Quote this No. and name of part when ordering.	Description.	Price.		
			£	s.	d.
1	35F	Cylinder head	0	15	0
2	13555	" " pin	0	0	3
3	392D	" " " washer	0	0	1
4	13556	" barrel	1	10	0
5	40F	" " joint	0	0	2
6	41F	" " stud	0	0	2
7	10D	" " " nut	0	0	3
8	631D	" " " spring washer	0	0	1
9	11729	Inlet port cover	0	3	6
10	14606	" " " stud	0	0	3
11	580E	" " " " nut... ..	0	0	1
12	47F	" " " " washer	0	0	1
13	13554	" " " joint	0	0	2
14	49F	Exhaust pipe stud	0	0	2
15	13D	" " " nut... ..	0	0	1
16	200D	" " " washer	0	0	1
	52F	Release valve complete	0	7	6
17	53F	" " body	0	4	0
18	54F	" " "	0	0	9
19	55F	" " spring	0	0	2
20	56F	" " " collar	0	0	3
21	57F	" " " cotter	0	0	1
22	58F	" " bell crank lever	0	1	0
23	59F	" " " " " pin	0	0	4
24	525D	" " " " " cotter	0	0	1
25	61F	" " stud	0	0	2
26	698D	" " " nut... ..	0	0	1
27	149F	" " " washer	0	0	1
28	64F	Piston with gudgeon pin and rings	0	15	0
29	65F	" ring	0	1	6
30	66F	Gudgeon pin with pads	0	2	6
31	67F	" " pad	0	0	3



1

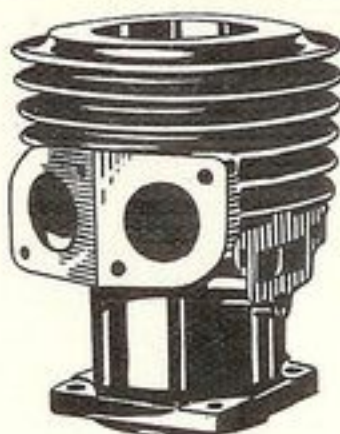

4



5



2



3



6



7



8



9



10



11



12



13



14



15



16



17



18



19



20



21



22



23



25



24



26



27



28



29



30



31

See opposite page for description and price.

ENGINE.—MODEL B.30.

Illustration No.	Quote this No. and name of part when ordering.	Description.	Price.		
			£	s.	d.
1	1G	Crankcase (timing side) without bushes
2	2G	(driving side)	1	10	0
3	3G	" bearing bush (timing side)	0	2	6
4	4G	" roller race (driving side)	0	5	0
	75D	" bearing roller	0	0	3
5	6G	" " cage	0	2	0
6	196C	" " thrust washer (driving side)	0	0	3
7	8G	" " " (timing side)	0	0	6
8	16D	" drain plug	0	0	6
9	17D	" " washer	0	0	1
	11G	" release valve centre	0	0	9
	12G	" " " body	0	1	0
	483E	" " " disc	0	0	1
	104D	" " " fibre washer	0	0	1
10	650G	" " " pipe	0	1	0
11	14D	" oil pipe union	0	0	9
12	15D	" " " washer	0	0	1
13	18G	" bush for camshaft	0	0	9
14	9D	" cylinder stud	0	0	3
15	10D	" " " nut	0	0	3
16	21G	" timing cover stud	0	0	2
17	12757	" " " " nut	0	0	1
18	149F	" " " " washer	0	0	1
19	24G	Tappet guide (inlet)	0	2	0
20	25G	" " (exhaust)	0	2	6
21	26G	" (inlet)	0	4	6
22	27G	" (exhaust)	0	4	6
23	28G	" head	0	0	3
24	29G	" " locknut (inlet)	0	0	3
25	30G	" " " (exhaust)	0	0	3
26	31G	" guide clamp	0	2	0
27	32G	" " " stud	0	0	3
28	703D	" " " " nut	0	0	1
29	34G	" " " " washer	0	0	1
30	35G	Camshaft (inlet)	0	10	6
31	36G	" (exhaust)	0	8	0
32	18417	Timing cover (less bushes)	0	10	0
33	38G	" " bush (inlet camshaft)	0	0	9
34	39G	" " " (exhaust camshaft)	0	0	9
35	40G	" " screw	0	0	1
36	18418	Magneto chain cover	0	7	6
37	18550	" " " screw (long)	0	0	2
38	18549	" " " " (medium)	0	0	2
39	18548	" " " " (short)	0	0	2
40	44G	" " " cap	0	0	6
41	45G	" " " " spring clip	0	0	3
42	46G	" " " " " screw	0	0	1
43	565F	" driving sprocket	0	1	9
44	40E	" " " " nut	0	0	2
45	49G	Exhaust lifter lever	0	1	6
46	50G	" " " spindle	0	0	6
47	51G	" " " operating lever	0	1	6
48	46E	" " " taper pin	0	0	2
49	53G	" " " cable roller	0	0	3

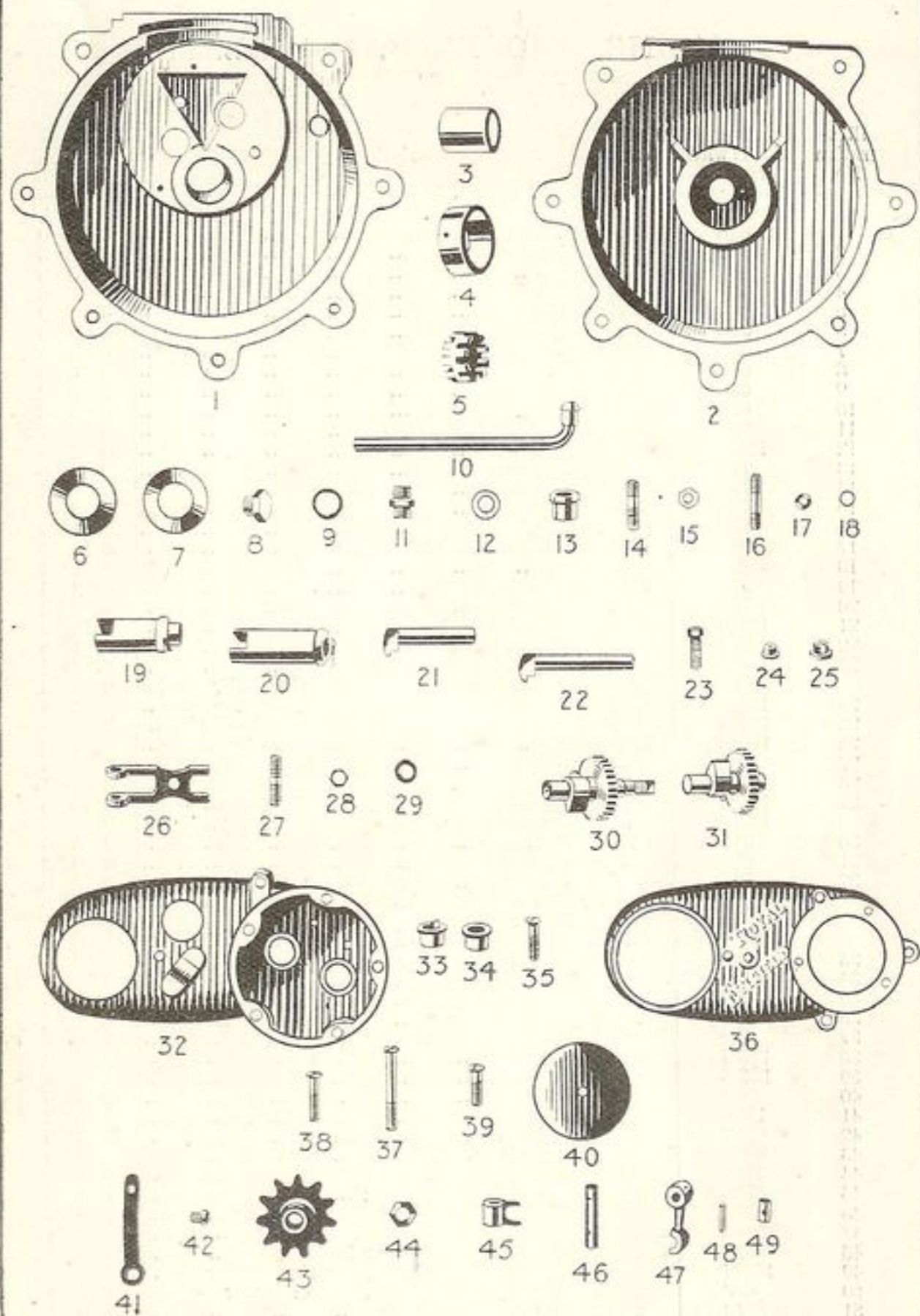

See opposite page for description and price.

ROYAL ENFIELD 2.25 H.P. MOTOR CYCLES.

ENGINE.—MODEL B.30—(continued).

Illustration No.	Quote this No. and name of part when ordering.	Description.	Price.		
			£	s.	d.
1	60G	Cylinder with valve guides	3	0	0
2	61G	" joint washer	0	0	3
3	62G	Valve	0	4	0
4	63G	" guide	0	1	6
5	64G	" spring	0	0	9
6	65G	" " cup (top)	0	0	3
7	66G	" " (bottom)	0	0	6
8	67G	" split collar	0	0	6
9	68G	" stem cup	0	0	2
10	69G	" " " spring	0	0	2
11	65D	" " " felt washer	0	0	1
12	12673	" cap (inlet)	0	2	6
13	71G	" " (exhaust)	0	2	6
14	72G	" " washer	0	0	2
15	73G	Induction pipe	0	0	9
16	53D	" " nut	0	1	0
17	12892	Piston with gudgeon pin and rings	0	15	0
18	12893	" ring	0	1	3
19	77G	Gudgeon pin with pads	0	2	3
20	78G	" pad	0	0	3
21	12720	Connecting rod with bushes	0	15	0
22	80G	" " small end bush	0	1	6
23	12719	" " big end roller race	0	3	6
	5D	" " " bearing roller (each)	0	0	3
24	12721	" " " " cage	0	2	6
25	12915	" " " " washer	0	0	6
26	12718	Crank pin	0	4	6
27	86G	" " nut	0	0	6
28	80D	" " keeper screw	0	0	1
29	12728	Flywheel (timing side)	0	10	0
	12729	" (driving ")	0	10	0
30	91G	Driving shaft	0	4	0
31	87D	" " key	0	0	2
32	93G	Timing shaft	0	4	0
	86G	Nut for shafts	0	0	6
	80D	" " keeper screw (as illust. 28)	0	0	1
	651G	Oil pump complete	1	10	0
33	13173	" " body	0	12	0
34	123E	" " " screw	0	0	2
35	105D	" " " joint	0	0	3
36	94D	" " " cover	0	1	0
37	95D	" " " " screw	0	0	2
38	12537	" " worm	0	1	0
39	13025	" " spindle	0	2	6
40	99D	" " disc	0	5	0
41	100D	" " " spring	0	0	2
42	884D	" " plunger	0	2	0
43	880C	" " regulator spindle	0	0	6
44	881C	" " " " knob	0	1	0
45	882C	" " " " disc	0	0	3
46	883C	" " " " plunger	0	0	3
47	884C	" " " " " spring	0	0	1
48	885C	" " " " gland washer	0	0	1
49	13887	" " " " " spring washer	0	0	1
50	47F	" " " " " steel washer	0	0	1
51	887C	" " " " stop	0	0	1
52	888C	" " " " nut	0	0	1
53	212D	" " " " washer	0	0	1
54	14D	" " union	0	0	9
	104D	" " " washer	0	0	1

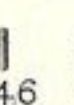
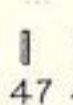
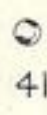
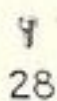
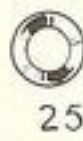
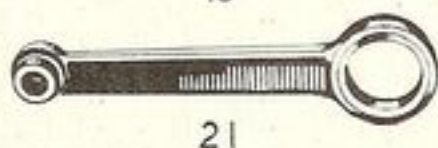
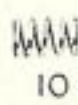

See opposite page for description and price.

SILENCERS, FOOTRESTS, FOOTBOARDS AND LEGSHIELDS.

Illustration No.	Quote this No. and name of part when ordering.	Description.	Price.
1	619F	Silencer	£ 0 s. 12 d. 6
2	1244B	" tail pipe	0 3 6
3	77F	" " " clip (large)	0 0 3
4	78F	" " " " (small)	0 0 3
5	79F	" " " " bolt	0 0 2
6	80F	" " " " nut	0 0 1
7	81F	" " " " washer	0 0 1
8	620F	Exhaust pipe	0 3 0
9	84F	" " flange	0 1 0
10	85F	" " " washer	0 0 6
11	590G	Silencer	0 15 0
12	656G	" tail pipe with fish tail	0 7 6
13	892C	" clip	0 1 0
14	893C	" " pin	0 0 2
15	894C	" " " nut	0 0 3
16	165D	" rear attachment pin	0 0 2
17	502D	" " " spring washer	0 0 1
18	597G	Exhaust pipe	0 12 6
	892C	" " clip (as illust. 13)	0 1 0
	893C	" " " pin (as illust. 14)	0 0 2
	894C	" " " " (as illust. 15)	0 0 3
19	606G	Footrest supporting stud	0 0 9
20	170D	" " " nut	0 0 3
21	194D	" " " washer	0 0 1
22	622F	" " " distance tube, $4\frac{1}{2}$ in. x $\frac{3}{8}$ in.	0 0 9
23	109F	" " " " " $2\frac{1}{2}$ in. x $\frac{1}{8}$ in.	0 0 6
24	890D	" " " arm	0 1 0
25	1295E	" " " locking collar	0 1 6
26	18729	" spindle	0 0 6
27	2009C	" rubber (per pair)	0 2 6
28	118F	Footboard	0 6 6
29	188D	" rubber stud	0 0 2
	170D	" supporting stud nut (as illust. 20)	0 0 3
	194D	" " " washer (as illust. 21)	0 0 1
	109F	" " " distance tube $2\frac{1}{2}$ in. x $\frac{1}{8}$ in. (as illust. 23)	0 0 6
30	124F	" " " (front) $17\frac{1}{2}$ in. x $\frac{1}{2}$ in.	0 1 0
31	13552	" " " (rear) $15\frac{1}{2}$ in. x $\frac{1}{2}$ in.	0 1 0
32	14636	" " " $2\frac{1}{2}$ in. x $\frac{1}{2}$ in.	0 0 6
33	127F	" " " tube (front) $6\frac{1}{8}$ in. x $\frac{3}{8}$ in.	0 1 0
34	623F	" " " (rear) $5\frac{1}{8}$ in. x $\frac{3}{8}$ in.	0 1 0
35	152C	" " " arm	0 1 0
36	12880	" " " stud $17\frac{1}{2}$ in. x $\frac{1}{2}$ in.	0 0 9
37	624F	" " " tube $6\frac{1}{8}$ in. x $\frac{3}{8}$ in.	0 1 0
38	12897	" " " plate	0 0 6
	134F	Legshield, R.H. } Model A30	0 3 6
	135F	" L.H. }	0 3 6
	13006	" " } Model B30	0 4 6
39	206D	" pin	0 0 2
40	212D	" " washer	0 0 1

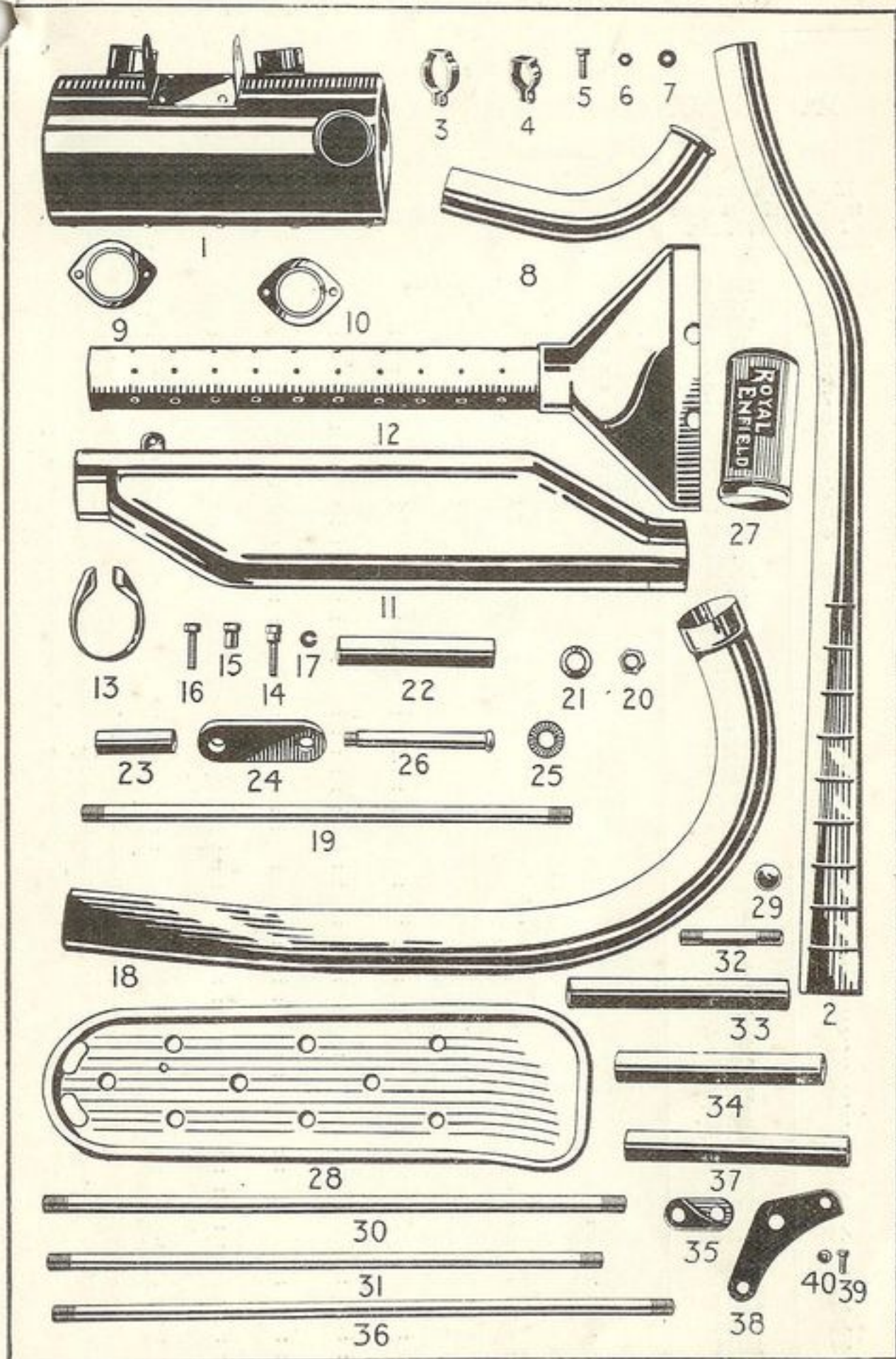

See opposite page for description and price.

ROYAL ENFIELD 2.25 H.P. MOTOR CYCLES.

ROYAL ENFIELD THREE-SPEED GEAR BOX.

Illustration No.	Quote this No. and name of part when ordering.	Description.	Price.		
			£	s.	d.
1	13314	Gearbox case (not studded or bushed) ...	1	5	0
2	146F	" cover only (not bushed) ...	0	9	0
3	12603	" " washer ...	0	0	1
4	147F	" " stud ...	0	0	2
5	698D	" " " nut ...	0	0	1
6	149F	" " " washer ...	0	0	1
7	908C	" oil filler plug ...	0	0	8
8	151F	" " " washer ...	0	0	1
9	152F	" attachment stud ...	0	0	6
10	190D	" " " nut ...	0	0	2
11	191D	" " " washer ...	0	0	1
12	125G	Mainshaft ...	0	10	0
13	156F	" bearing race (large) ...	0	3	6
14	157F	" " roller cage ...	0	2	6
	75D	" " " ...	0	0	3
15	12329	" " thrust washer ...	0	0	9
16	159F	" " felt washer ...	0	0	3
17	160F	" " washer... ...	0	0	2
18	161F	" " race (small) ...	0	1	6
19	162F	" " " end washer ...	0	0	3
20	163F	" " thrust washer ...	0	0	9
21	164F	" " " peg ...	0	0	3
	5D	" " roller ...	0	0	3
22	166F	" " cage ...	0	1	3
23	137G	" 25 tooth gear ...	0	10	0
24	168F	" 21 " " ...	0	5	0
25	169F	" 14 " " ...	0	2	0
26	140G	Layshaft ...	0	8	0
	161F	" bearing race (as illust. 18) ...	0	1	6
	162F	" end washer (as illust. 19) ...	0	0	3
27	14755	" thrust washer ...	0	0	6
	5D	" roller ...	0	0	3
	166F	" cage (as illust. 22) ...	0	1	3
28	175F	" 17 tooth gear ...	0	2	6
29	12625	" 21 " " ...	0	7	6
30	177F	" 28 " " and kickstarter wheel ...	0	7	6
31	178F	" bearing bush ...	0	1	6
32	179F	Countershaft sprocket (Model A30) ...	0	5	0
33	149G	" " (Model B30) ...	0	5	0
34	180F	" " key ...	0	0	3
35	181F	" " nut ...	0	0	6
36	152G	" felt washer ...	0	0	6
37	153G	Kickstarter spindle with layshaft bearing bush ...	0	10	0
38	186F	" " bearing bush ...	0	4	6
39	187F	" " pawl ...	0	1	6
40	188F	" " rivet ...	0	0	2
41	229C	" " plunger ...	0	0	2
42	230C	" " " spring ...	0	0	2
43	231C	" crank ...	0	7	6
44	233C	" cotter pin ...	0	0	6
		" " nut ...			
		" " spring washer ...			
45	12406	" return spring ...	0	1	0
46	236C	" " cover ...	0	0	9
47	14754	" distance tube 1½ in. x 2 ½ in. ...	0	0	3
48	13476	" stop ...	0	0	6
49	13181	" leaf ...	0	0	6
50	217G	" pin ...	0	0	1

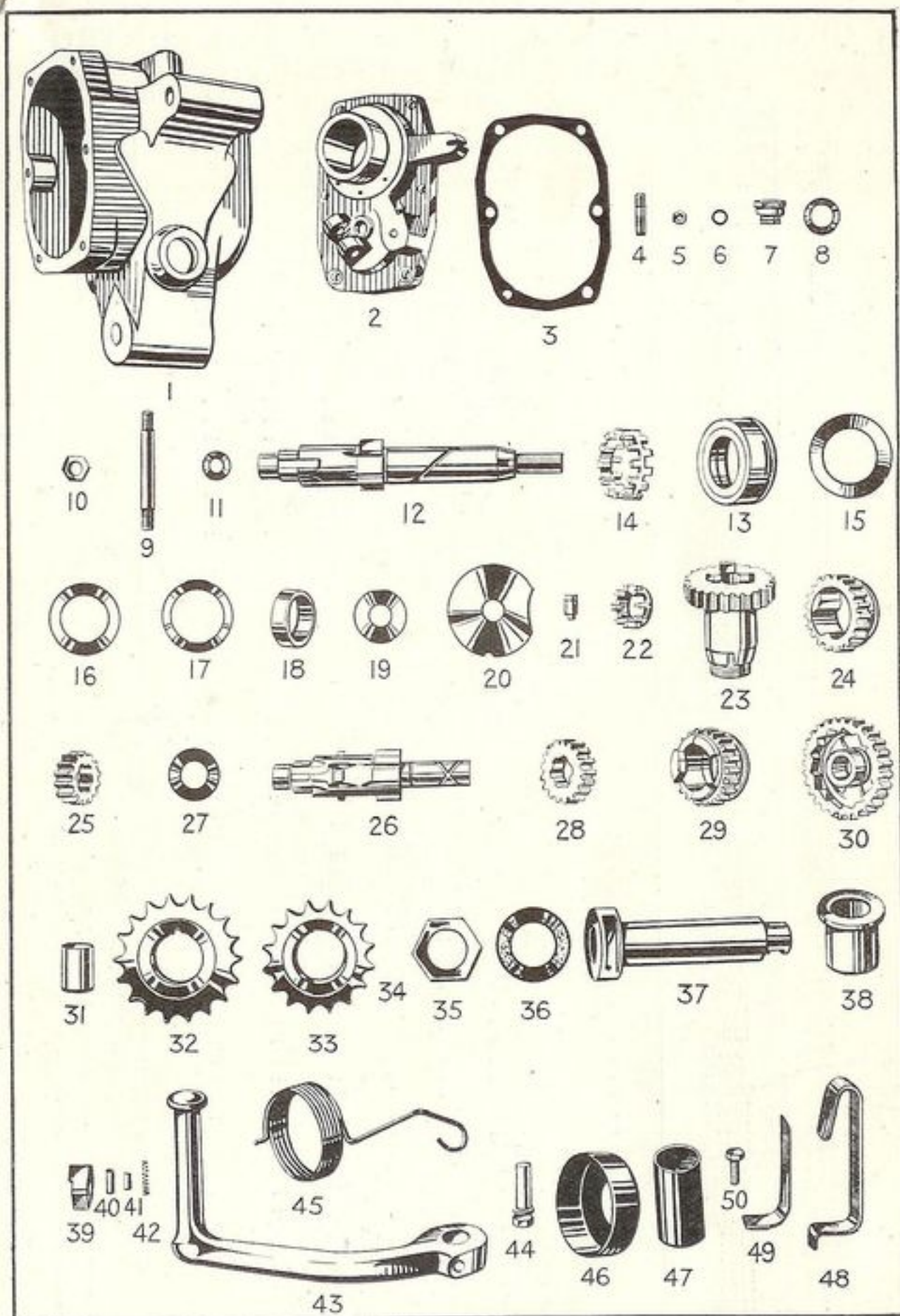

See opposite page for description and price.

ROYAL ENFIELD 2.25 H.P. MOTOR CYCLES.

GEAR BOX (continued), CLUTCH, CLUTCH CONTROL AND GEAR CONTROL.

Illustration No.	Quote this No. and name of part when ordering.	Description.	Price.		
			£	s.	d.
1	12732	Gear operating rocker arm	0	7	6
2	211F	" " " " spindle	0	0	6
3	212F	" " " " " bush (large)	0	1	6
4	213F	" " " " " bush (small)	0	1	6
5	9714	" " " " plunger	0	0	6
6	9715	" " " " " bush	0	0	6
7	13020	" " " " " spring	0	0	1
8	9717	" " " " " grub screw	0	0	1
9	214F	" " yoke plate	0	2	0
10	13328	" " lever	0	3	6
11	349D	" " nut	0	0	2
12	225F	Clutch sprocket with roller race and cork inserts	0	15	0
13	9667	" " cork insert (large) per doz.	0	0	6
14	9670	" " " (small) " "	0	0	6
15	228F	" " roller cage and rollers complete	0	5	0
16	229F	" centre	0	10	6
17	230F	" back plate	0	1	6
18	231F	" front plate	0	2	0
19	177G	" spring	0	1	0
20	233F	" " cup	0	2	6
21	234F	" " collar	0	0	2
22	180G	" " nut	0	0	6
23	236F	" end cap	0	1	0
24	237F	" attachment nut	0	0	3
25	238F	" " washer	0	0	1
26	198F	" operating lever	0	2	6
27	199F	" " lever pivot pin	0	0	3
	350D	" " " " washer	0	0	1
	201F	" " " " split pin	0	0	1
28	244C	" " " adjusting screw... ..	0	0	1
29	245C	" " " " locknut	0	0	1
30	53G	" " " cable roller	0	0	3
31	191G	" " rod (long)	0	1	0
32	206F	" " " (short)	0	0	3
	272C	" " " 1/2 in. dia. ball	0	0	1
33	208F	" " " bush	0	0	3
34	209F	" " pad	0	0	6
35	13188	Gear control lever complete less knob	0	5	0
36	687D	" " " knob	0	0	9
37	688D	" " " ferrule	0	0	3
38	689D	" " " collar	0	0	1
39	13189	" " " distance piece	0	0	6
40	13072	" " " spindle	0	0	6
41	606D	" " " spring washer	0	0	1
42	190D	" " " nut	0	0	2
43	2036C	" " " spring washer	0	0	1
44	13209	" " gate	0	2	6
45	14774	" " pin	0	0	1
46	13329	" " rod	0	0	6
47	701D	" " " connection	0	1	0
48	703D	" " " locknut	0	0	1
49	704D	" " " pin	0	0	2
	525D	" " " split pin	0	0	1
	1184C	" " ball joint complete	0	3	0
50	1185C	" " " body	0	1	3
51	1186C	" " " cup (fixed)	0	0	6
52	1187C	" " " (adjustable)	0	0	9
	1188C	" " " split pin	0	0	1
53	1189C	" " " ball	0	0	9
54	13D	" " " nut	0	0	1
55	502D	" " " spring washer	0	0	1

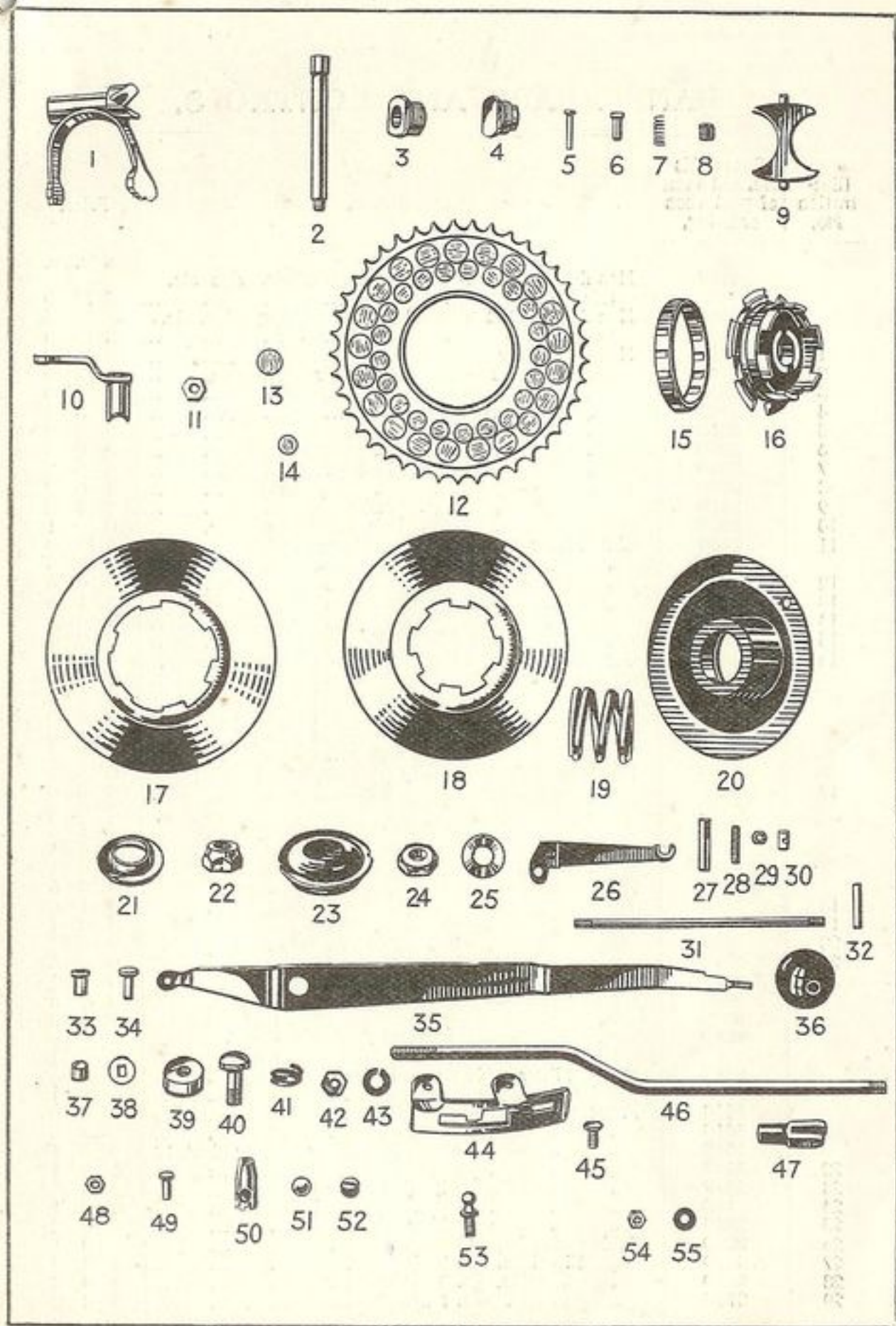

See opposite page for description and price.

HANDLEBARS AND CONTROLS.

Illustration No.	Quote this No. and name of part when ordering.	Description.	Price.
	602F	Handlebar fitted with all levers, controls, grips etc. (Model A30)	£ s. d. 2 15 0
	603F	Handlebar fitted with all levers, controls, grips, etc. (Model B30)	2 15 0
1	231G	Handlebar only	0 10 0
2	224D	" grips (Standard) per pair	0 2 0
3	225D	" (Sports)	0 3 0
4	226D	" inverted lever	0 3 4
5	227D	" " " pocket	0 0 9
6	228D	" " " cap	0 0 6
7	229D	" " " pivot screw	0 0 2
8	230D	" " " " nut	0 0 2
9	231D	" " " roller	0 0 2
10	232D	" " " lock screw	0 0 1
11	240G	Clutch lever complete with cable and casing	0 12 0
	234D	" " " less " " "	0 7 6
12	242G	" cable	0 0 6
13	243G	" " casing	0 1 6
14	53G	" " nipple	0 0 3
15	378E	" " screwed ferrule	0 0 1
16	243D	Carburettor control less cable and casing	0 6 6
	280F	" " cable ... } Model	0 0 6
	281F	" " " casing } A30	0 1 0
	248G	" " " " } Model	0 0 6
	249G	" " " casing } B30	0 1 0
	932C	" " " nipple	0 0 1
17	251G	Magneto control complete with cable and casing	0 8 0
	248D	" " " less " " "	0 5 0
	253G	" " cable	0 0 6
	254G	" " " casing	0 1 6
	937C	" " " nipple (control end)	0 0 1
	938C	" " " (magneto end)	0 0 1
18	283F	Release valve cable	0 0 6
19	284F	" " " casing...	0 1 0
20	254D	" " " nipple...	0 0 1
21	286F	" " " ball nipple	0 0 1
	293F	" " " adjusting screw	0 0 6
	182D	" " " " locknut	0 0 1
	256G	Exhaust lifter cable	0 0 6
	257G	" " " casing	0 1 0
	254D	" " " screwed nipple	0 0 1
	378E	(as illust. 18) Exhaust lifter cable screwed ferrule	0 0 1
	260G	(as illust. 15) Front brake cable	0 0 6
	261G	" " " casing	0 1 0
22	254D	" " " nipple (handlebar end) (as illust. 18)	0 0 1
23	292F	" " " (hub end)	0 0 1
24	293F	" " " adjusting screw	0 0 6
25	13D	" " " " locknut	0 0 1
26	266G	" " " rubber tube	0 0 2
27	266D	Cable casing ferrule	0 0 1
28	267D	" clip (1 1/2 in. dia. 1 wire)	0 0 2
29	269D	" " (1 1/2 in. dia. 3 wire)	0 0 2
	270D	" " (3/4 in. dia. 1 wire)	0 0 2

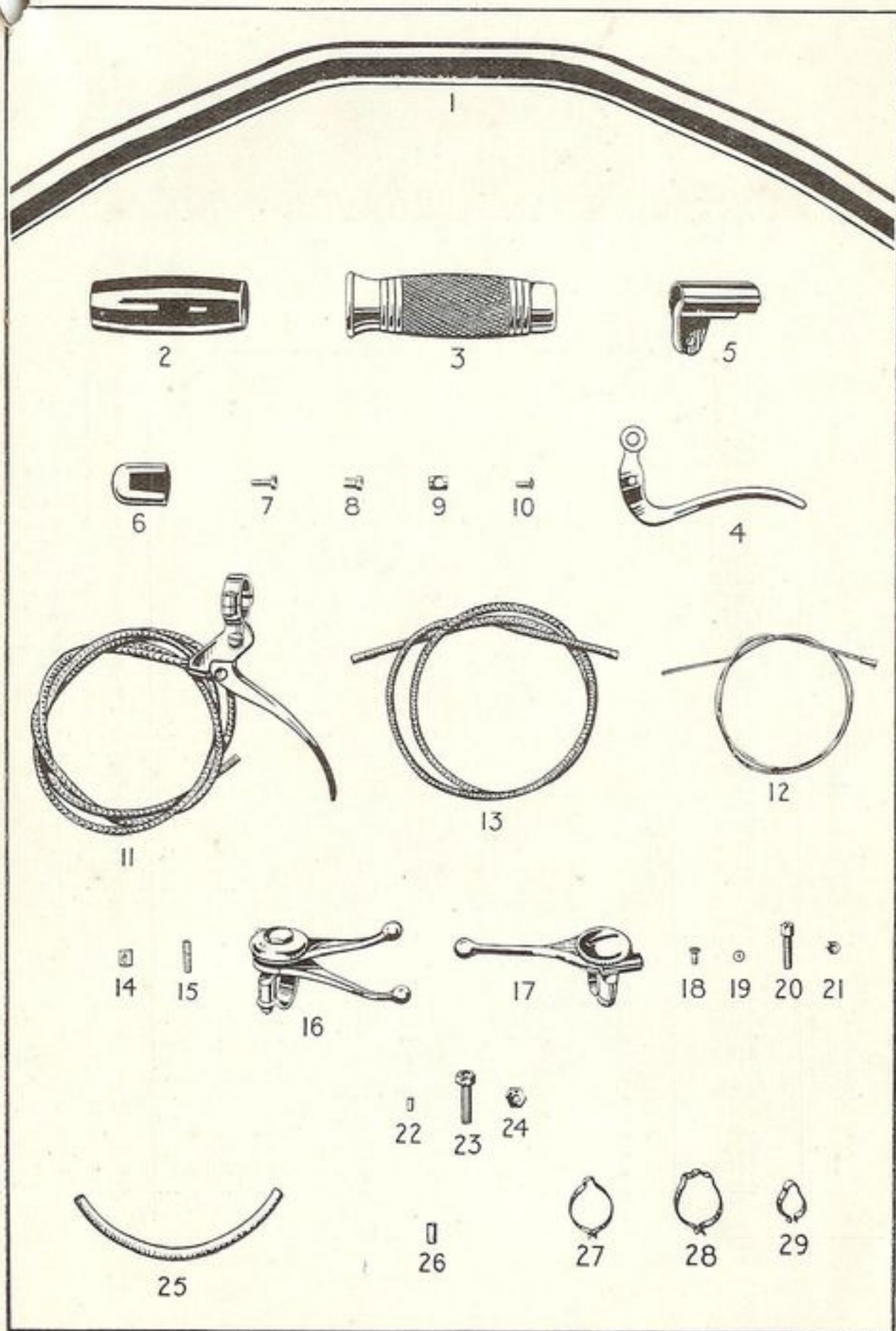

See opposite page for description and price.

FRONT FORK AND FRONT MUDGUARD.

Illustration No.	Quote this No. and name of part when ordering.	Description.	Price.		
			£	s.	d.
1	608F	Front fork	2	15	0
2	12421	" " spring with pins	0	3	0
3	349D	" " " pin nut	0	0	2
4	350D	" " " washer	0	0	1
5	969C	" " " distance piece	0	0	3
6	334G	" " top link (R.H. thread)	0	2	3
	335G	" " " (L.H. ")	0	2	3
7	9664	" " crown link (R.H. thread)	0	3	0
	9665	" " " (L.H. ")	0	3	0
8	365D	" " " fibre washer	0	0	3
9	367D	" " " " spring	0	0	9
10	366D	" " " steel washer	0	0	6
11	13158	" " swivel pin (top)	0	1	0
12	241G	" " " (bottom)	0	1	0
13	363D	" " " nut (R.H. thread)	0	0	2
	364D	" " " " (L.H. ")	0	0	2
14	13433	" " steering stem	0	10	6
15	345G	" " " ball race	0	1	0
16	372D	" " ball head clip (top)	0	10	0
17	328F	" " " " (bottom)	0	2	0
18	374D	" " " " bolt	0	0	6
19	190D	" " " " nut	0	0	2
20	376D	" " " " washer	0	0	1
21	329F	" " " " ball race	0	1	0
	378D	" " " " 3/4 in. balls (per doz.)	0	0	2
22	334F	" " " " locknut (Model A)	0	1	0
23	379D	" " " " (" B ¹)	0	1	0
24	123D	" " grease nipple	0	0	3
25	383D	" " handlebar pin	0	0	3
26	384D	" " " " washer	0	0	1
	13449	" " mudguard complete with stays	0	15	0
27	637D	" " pin	0	0	2
	397D	" " number plate complete with licence holder	0	2	6
28	398D	" " " only	0	1	3
29	400D	" " " clip	0	0	6
30	212D	" " " " washer	0	0	1
31	402D	" " " " screw	0	0	2
32	403D	" " " " licence holder flange	0	0	6
	404D	" " " " " glass	0	0	1
33	405D	" " " " " back	0	0	2
34	406D	" " " " " rubber washer	0	0	1
	381D	" " " " " screws (per doz.)	0	0	6
	408D	" " " " " screw nut... ..	0	0	1

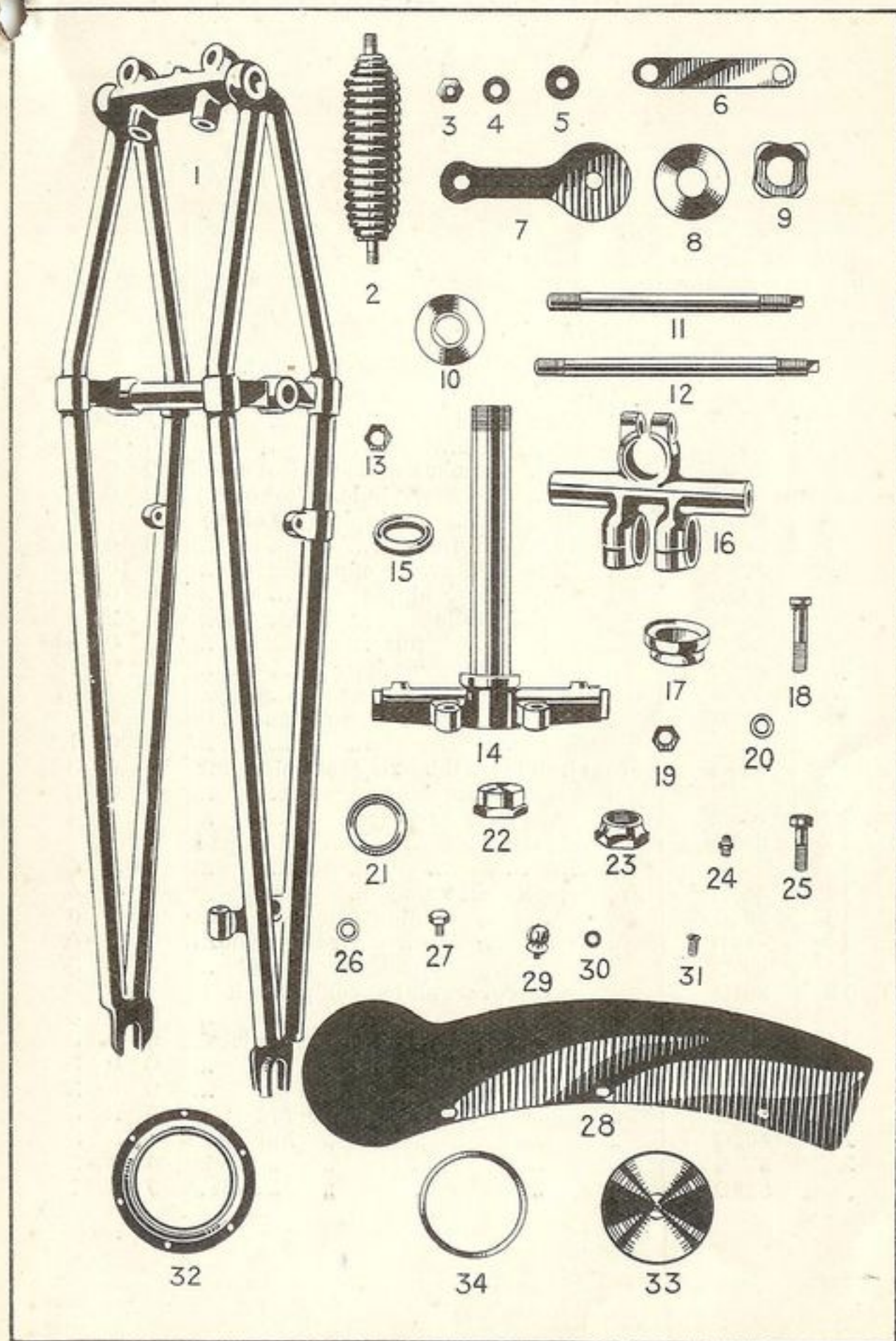

See opposite page for description and price.

FRONT WHEEL AND FRONT BRAKE.

Illustration No.	Quote this No. and name of part when ordering.	Description.	Price.		
			£	s.	d.
	375G	Front wheel complete with brake less tyre	2	15	0
	376G	Front wheel only	1	10	0
	377G	" " rim	0	8	6
	378G	" " spokes 8in. long (set of 20)	0	0	9
	379G	" " " 9in. long (set of 20)	0	0	9
	380G	" " " nipples (set of 40)	0	1	6
1	381G	" brake drum	0	6	0
2	382G	" hub with grease nipple	0	10	6
	123D	" " grease nipple	0	0	3
3	384G	" " spindle	0	2	6
4	383F	" " " nut	0	0	6
5	841D	" " " washer	0	0	1
6	387G	" " journal bearing	0	4	6
7	388G	" " " " distance washer	0	0	1
8	389G	Front hub journal bearing retaining nut	0	0	3
9	421F	" " oil retainer	0	0	2
10	420F	" " dust excluder	0	0	4
11	392G	" brake shoe with lining and pad (each)	0	3	6
12	444D	Front brake shoe pad	0	0	6
13	394G	" " " lining (each)	0	1	0
14	446D	" " " " rivet (per doz.)	0	0	6
15	396G	" " " spring	0	0	3
16	397G	" " cover plate, complete less shoes	0	3	6
17	398G	Front brake cover plate distance piece	0	0	3
18	399G	" " anchor pin	0	0	3
19	613D	" " " " nut	0	0	2
20	401G	" " operating lever and cam.	0	2	3
21	402G	" " " " knuckle	0	0	3
22	395F	" " " " " pin	0	0	2
	525D	" " " " " split "	0	0	1

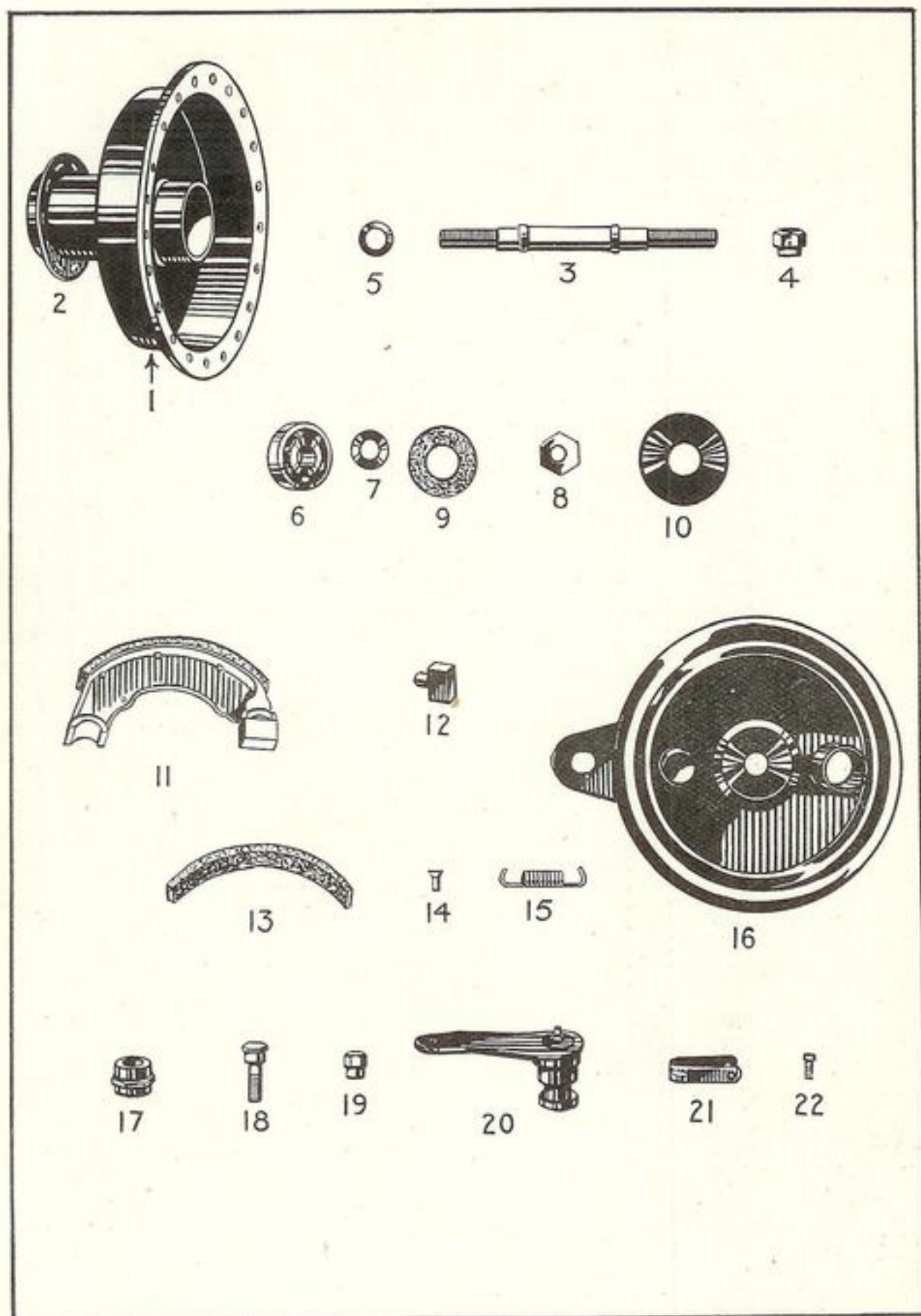

See opposite page for description and price.

ROYAL ENFIELD 2.25 H.P. MOTOR CYCLES.

REAR WHEEL AND REAR BRAKE.

Illustration No.	Quote this No. and name of part when ordering.	Description.	Price.
			£ s. d.
	609F	Rear wheel with cush drive and brake, less tyre, Model A30	4 0 0
	430G	Rear wheel with cush drive and brake, less tyre, Model B30	4 0 0
	431G	Rear wheel only	1 15 0
	377G	" " rim	0 8 6
	433G	" " spokes 8½ in. long (set of 20)	0 0 9
	434G	" " " 8½ in. " (" 20)	0 0 9
	435G	" " " nipples (set of 40)	0 1 6
1	381G	" hub brake drum	0 6 0
2	437G	" " with grease nipple	0 15 6
3	123D	" " grease nipple	0 0 3
4	439G	" " spindle	0 4 6
5	429F	" " " nut	0 0 6
6	430F	" " " washer	0 0 2
7	387G	" " journal bearing	0 4 6
8	388G	" " " distance washer	0 0 1
9	389G	" " " retaining nut	0 0 3
10	421F	" " oil retainer	0 0 2
11	420F	" " dust excluder	0 0 4
12	13534	" " driving sprocket (Model A30)	0 12 6
13	447G	" " " " (" B30)	0 12 6
14	423F	" " " " lockring	0 1 0
15	425F	" " " " " pin	0 0 2
16	460D	" " " " " nut...	0 0 1
17	502D	" " " " " spring washer	0 0 1
18	424F	Rear wheel driving sprocket cush rubber	0 0 3
19	392G	" brake shoe with lining and pad (each)	0 3 6
20	444D	" " " pad	0 0 6
21	394G	" " " lining (each)	0 1 0
22	446D	" " " rivet (per doz.)	0 0 6
23	396G	" " " spring	0 0 3
24	458G	" " cover plate complete less shoes	0 3 6
25	398G	" " " distance piece	0 0 3
26	530C	" " anchor pin	0 0 3
27	190D	" " " nut	0 0 1
28	191D	" " " washer	0 0 1
29	401G	" " operating cam and lever	0 2 3
30	464G	" " " rod (R.H. thread)	0 0 6
	465G	" " " " (L.H. ")	0 0 6
31	450F	" " " " adjusting nut	0 1 0
32	182D	" " " " " locknut (R.H. thread)	0 0 1
	452F	Rear brake operating rod adjusting nut locknut (L.H. thread)	0 0 1
33	212D	" " " " " washer	0 0 1
	453F	" " " " " split pin	0 0 1
34	471G	" " foot pedal	0 4 6
35	472G	" " " spindle	0 0 6
36	170D	" " " " nut	0 0 3
37	194D	" " " " washer	0 0 1
38	694D	" " " " " (large)	0 0 1
39	476G	" " " " distance tube	0 0 6
40	999D	Rear brake foot pedal spindle distance tube, 2½ in. x ½ in.	0 0 6
41	453D	Rear brake foot pedal stop nut	0 0 2

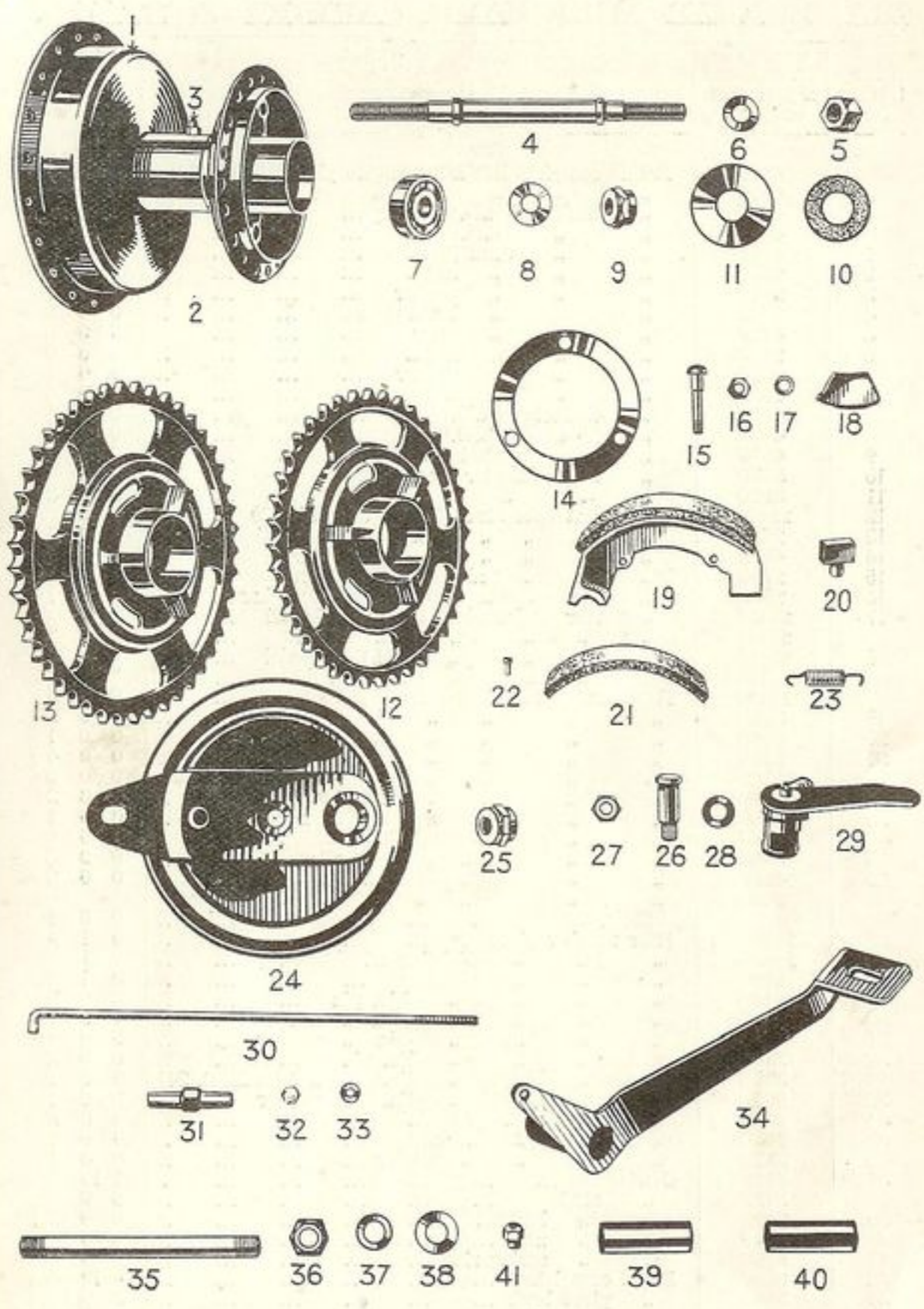

See opposite page for description and price.

ROYAL ENFIELD 2.25 H.P. MOTOR CYCLES.

FRAME, REAR MUDGUARD, CARRIER & STAND.

Illustration No.	Quote this No. and name of part when ordering.	Description.	Price.
			£ s. d.
	610F	Frame complete less front engine plate (Model A30)...	6 0 0
	655G	" " " " " (Model B30)...	6 0 0
	486G	" backstay (R.H.) ...	0 10 0
	487G	" " (L.H.) ...	0 10 0
1	474F	" " stud (bottom) ...	0 0 2
2	190D	" " " nut... ..	0 0 2
3	191D	" " " washer ...	0 0 1
4	7345	" " " locknut ...	0 0 2
5	471F	" " " (top) ...	0 0 6
6	122D	" " " nut... ..	0 0 3
7	566D	" " " washer ...	0 0 1
8	478F	" " " distance piece ...	0 0 6
	496G	" chainstay (R.H.) ...	0 12 6
	497G	" " (L.H.) ...	0 10 6
	498G	" " stud ...	0 0 6
9	567D	" chain adjuster screw ...	0 0 4
10	568D	" " locknut ...	0 0 3
11	11451	" seat tube " stud (bottom), Model A30 ...	0 0 6
12	123F	" " " " Model A30 (Lighting Set) ...	0 0 6
13	499G	" " " " Model B 30 ...	0 0 3
14	171D	" " " and chainstay stud nut ...	0 0 3
15	194D	" " " " washer ...	0 0 1
16	13454	" rear engine plate (R.H.) } Model	
	13455	" " (L.H.) } A30	0 3 0
17	13315	" " (R.H.) } Model	
	13316	" " (L.H.) } B30	0 3 0
	13446	Rear mudguard (fixed half) ...	0 5 0
19	389D	" " " " pin ...	0 0 2
20	502D	" " " " " spring washer ...	0 0 1
21	506G	" " " " " strap ...	0 0 6
22	154D	" " " " " clip ...	0 0 6
23	580D	" " " " " pin ...	0 0 2
24	395D	" " " " " nut ...	0 0 1
	13447	" " (detachable half) ...	0 5 0
25	598D	" " " " " clip ...	0 0 3
26	497F	" " " " " pin ...	0 0 2
	395D	" " " " " nut (as	
		illust. 24) ...	0 0 1
27	1049C	Rear number plate ...	0 1 6
	1051C	" " " (lighting set) ...	0 1 9
28	516G	" " " strap ...	0 1 0
29	612D	" " " " $\frac{1}{8}$ in. pin ...	0 0 2
30	613D	" " " " $\frac{1}{8}$ in. " nut ...	0 0 2
31	392D	" " " " $\frac{1}{8}$ in. " washer ...	0 0 1
32	394D	" " " " $\frac{1}{8}$ in. pin ...	0 0 2
	395D	" " " " $\frac{1}{8}$ in. " nut (as illust. 24) ...	0 0 1
33	200D	" " " " $\frac{1}{8}$ in. " washer ...	0 0 1
34	204D	" " " " pin ...	0 0 2
35	182D	" " " " nut ...	0 0 1
36	212D	" " " " washer ...	0 0 1
37	611F	Carrier ...	1 10 0
38	572D	" stud ...	0 0 6
39	349D	" " locknut ...	0 0 2
40	465D	" " nut ...	0 0 4
41	575D	" " spring ring ...	0 0 1
42	612F	Stand complete ...	0 12 6
43	529G	" pivot bush ...	0 0 2
44	530G	" " pin ...	0 0 3
	465D	" " nut (as illust. 40) ...	0 0 4
	392D	" " washer (as illust. 31) ...	0 0 1
45	606D	" spring washer ...	0 0 1
46	13330	" spring ...	0 1 0
47	533G	" " pin ...	0 0 2
	182D	" " nut (as illust. 35) ...	0 0 1

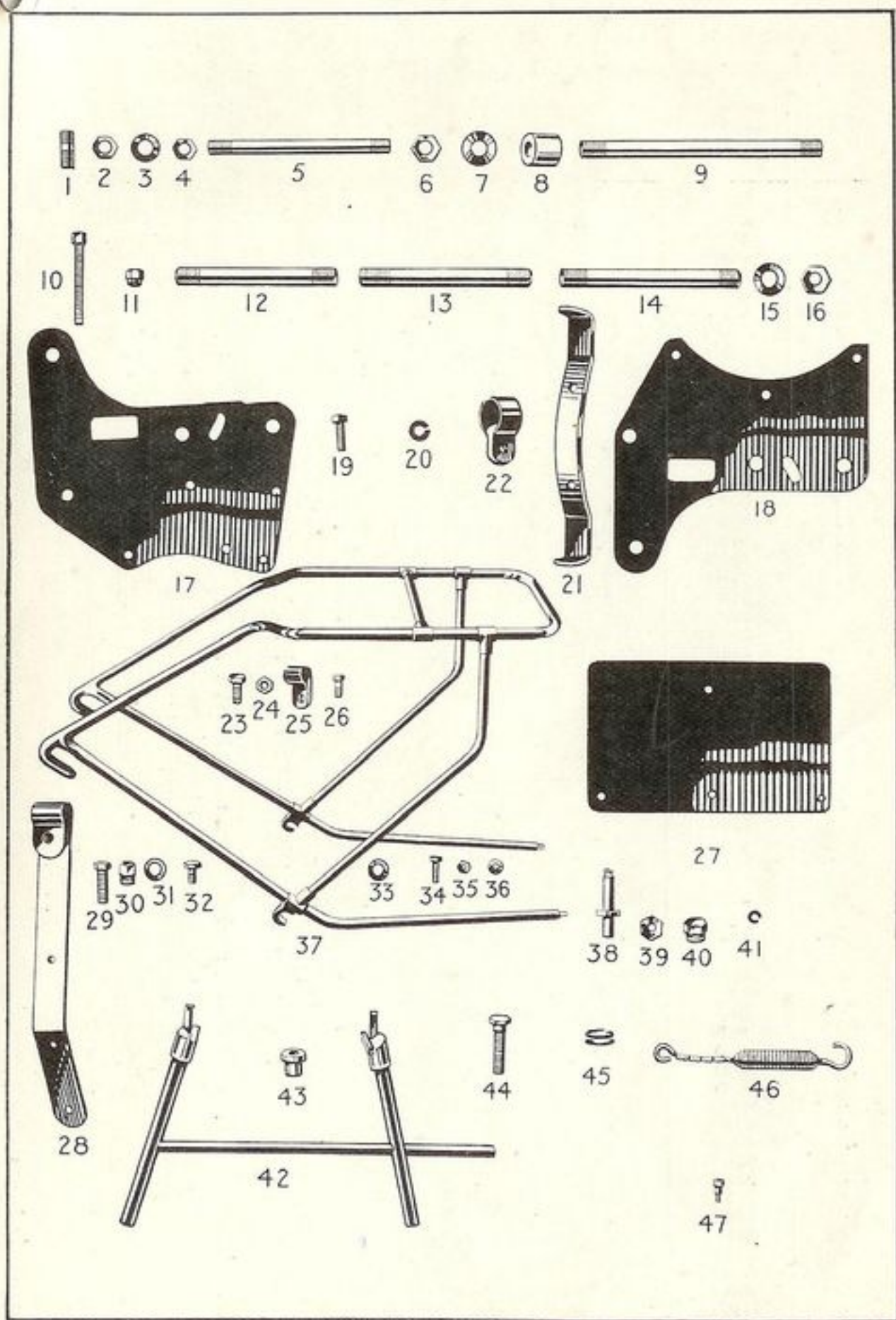

See opposite page for description and price.

ROYAL ENFIELD 2.25 H.P. MOTOR CYCLES.

CHAIN COVERS, CHAINS AND ENGINE ATTACHMENTS.

Illustration No.	Quote this No. and name of part when ordering.	Description.	Price.
1	13533	Chain cover complete (Model A30)	£ 0 15 0
	540G	" " " (Model B30)	0 15 0
	541G	" " " Lighting Set (Model B30)	1 0 0
2	619C	" " rear clip	0 0 6
3	620C	" " " " pin	0 0 2
4	631D	" " " " " spring washer	0 0 1
5	12324	" " front stud $\frac{6}{16}$ in. x $\frac{1}{16}$ in.	0 0 3
6	821D	" " " " " nut	0 0 2
7	350D	" " " " " washer	0 0 1
8	618F	" " " " " distance tube, $2\frac{1}{8}$ in. x $\frac{3}{16}$ in.	0 0 6
9	614F	" " " " " distance tube, $2\frac{1}{8}$ in. x $\frac{3}{16}$ in.	0 0 6
10	549G	Dynamo chain cover	0 3 6
11	550G	" " " pin	0 0 2
12	551G	" strap	0 2 0
13	552G	" " hinge pin	0 0 6
14	553G	" " pin (long)	0 0 3
15	554G	" " " (short)	0 0 3
16	555G	" " stud	0 0 3
17	453D	" " " nut	0 0 2
18	557G	" sprocket	0 2 6
19	558G	Engine and dynamo sprocket	0 5 0
	559G	Gear chain	0 8 0
	560G	Driving chain	0 12 6
	615F	Magneto " (Model A30)	0 1 6
	562G	" " (Model B30)	0 1 6
20	13475	" base plate (standard) Model A30	0 3 0
	14657	" " " (Lighting Set) Model A30	0 3 6
21	563G	" " " Model B30	0 3 0
22	13541	" " " stud (standard)	0 0 2
23	14661	" " " " (Lighting Set)	0 0 3
24	349D	" " " " nut	0 0 2
25	392D	" " " " washer	0 0 1
	615F	" " " " distance tube	0 0 6
26	617F	Magnet: base plate stud distance tube, $2\frac{1}{8}$ in. x $\frac{3}{16}$ in. (as illust. 9)	0 0 3
27	618F	Magneto base plate stud distance tube, $2\frac{1}{8}$ in. x $\frac{3}{16}$ in.	0 0 3
28	568G	Magneto base plate distance tube $1\frac{3}{4}$ in. x $\frac{3}{16}$ in., Model B30	0 0 6
29	569G	Magneto base plate distance tube, $1\frac{3}{4}$ in. x $\frac{3}{16}$ in., Model B30	0 0 6
30	564G	Magneto screw (standard)	0 0 6
31	14660	" " (Lighting Set) Model A30	0 0 1
32	565F	" sprocket (Models B30 and A30 Standard)	0 1 9
33	566F	" " Lighting Set (Model A30)	0 1 9
34	13532	Engine and magneto sprocket	0 6 0
35	13539	" " " " nut	0 0 6
36	571G	" sprocket	0 4 0
37	556F	" " nut	0 0 6
38	657D	" " key	0 0 3
39	954D	Sparkling plug with waterproof cap	0 6 6
40	7F	Crankcase stud $2\frac{1}{8}$ in. x $\frac{1}{16}$ in.	0 0 3
41	576G	" " $3\frac{1}{8}$ in. x $\frac{1}{16}$ in.	0 0 4
42	577G	" " $4\frac{1}{8}$ in. x $\frac{1}{16}$ in.	0 0 4
43	578G	" " $6\frac{1}{8}$ in. x $\frac{1}{16}$ in.	0 0 6
	821D	" " nut (as illust. 6)	0 0 2
	350D	" " washer (as illust. 7)	0 0 1
44	13453	Front engine plate, Model A30	0 1 0
45	13105	" " " (Standard) Model B30	0 1 0
46	581G	" " " (Lighting Set) Model B30	0 1 6
47	582G	" " " $\frac{1}{2}$ in. stud	0 0 6
48	171D	" " " " nut	0 0 3
49	194D	" " " " washer	0 0 3

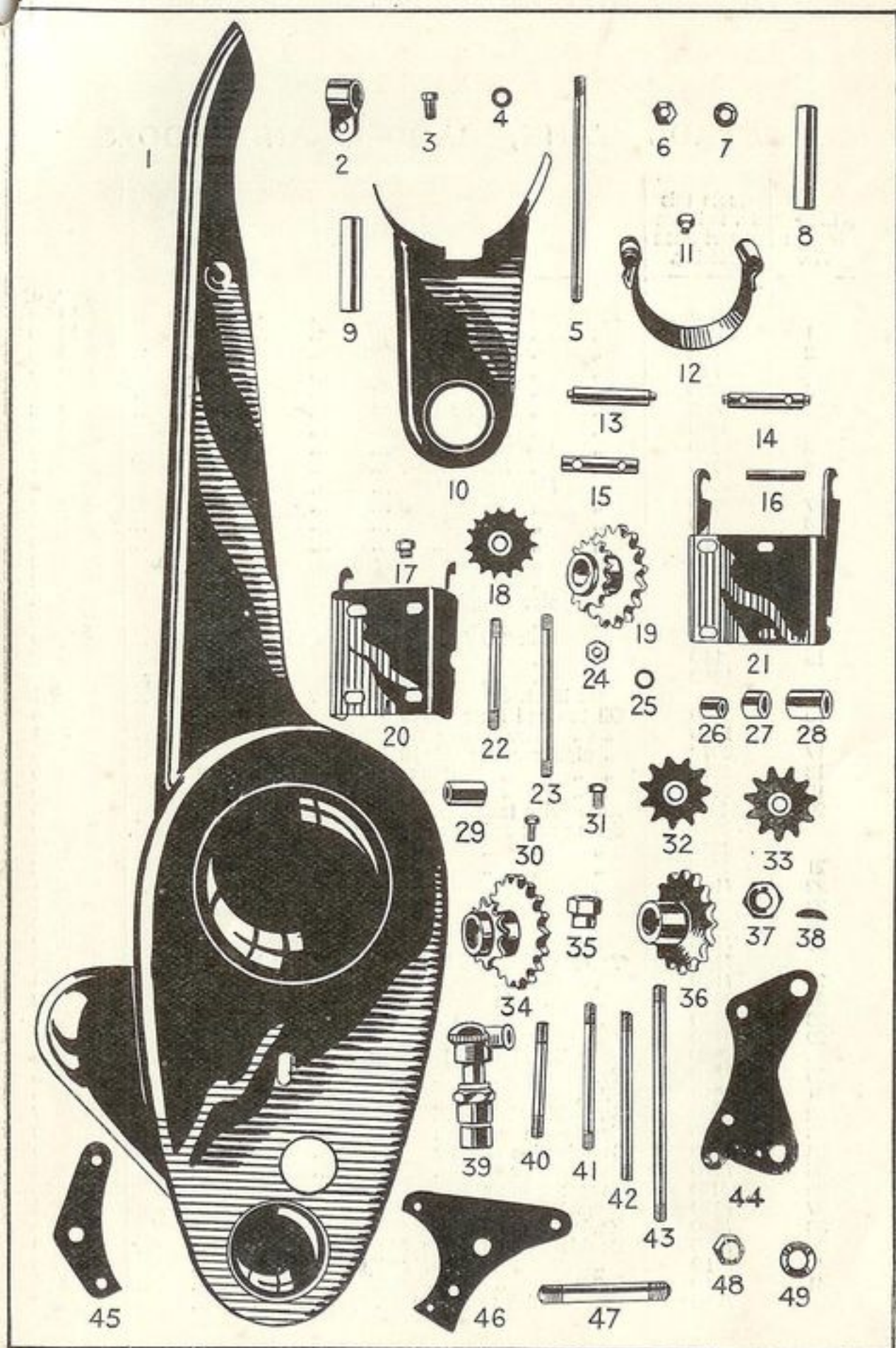

See opposite page for description and price.

ROYAL ENFIELD 2.25 H.P. MOTOR CYCLES.

PETROL TANK, SADDLE AND TOOLS.

Illustration No.	Quote this No. and name of part when ordering.	Description.	Price.
			£ s. d.
1	604F	Petrol tank assembled complete...	4 10 0
2	13186	" " only ...	3 15 0
	977D	" " filler cap (petrol) ...	0 2 6
	978D	" " " " (oil) ...	0 2 6
3	985D	" " attachment pin ...	0 0 1
4	10032	" " rubber packing ...	0 0 2
	952C	" " felt packing ...	0 0 6
5	302D	" tap ...	0 2 6
6	104D	" " fibre washer ...	0 0 1
	304D	" filter complete ...	0 3 6
7	305D	" " body ...	0 2 0
8	306D	" " " cap ...	0 1 0
9	307D	" " gauze ...	0 0 6
10	309D	" " leather washer (large) ...	0 0 2
11	308D	" " " (small) ...	0 0 2
12	305F	" pipe complete (Model A30) ...	0 2 6
13	652G	" " (Model B30) ...	0 2 6
14	606F	" tank "U" connection pipe complete ...	0 2 0
15	14D	" " " " " union ...	0 0 9
	104D	" " " " " fibre washer (as illust. 6) ...	0 0 1
16	334D	Oil tap and filter gauze ...	0 3 0
	104D	" " fibre washer (as illust. 6) ...	0 0 1
17	607F	" pipe complete (Model A30) ...	0 2 6
18	653G	" " (tank to pump) ...	0 2 6
19	654G	" " (pump to engine) } Model B30 ...	0 1 6
20	14419	Knee grips (each) ...	0 2 6
	625F	Spring seat saddle complete with springs ...	1 10 0
	626F	" " " rear spring ...	0 1 6
21	546F	" " " " " bolt ...	0 0 2
22	710D	" " " " " nut ...	0 0 1
23	681D	" " " " " spring washer ...	0 0 1
24	628G	" " " " " front pivot pin ...	0 0 3
25	713D	" " " " " nut... ...	0 0 2
	714D	Toolbag complete tools and with clips less toolroll ...	0 7 6
26	716D	" clip ...	0 0 4
27	204D	" " pin ...	0 0 2
28	182D	" " " nut... ...	0 0 1
29	212D	" " " washer ...	0 0 1
	720D	Toolroll and strap less tools ...	0 2 6
30	722D	Tyre lever ...	0 0 6
31	723D	File ...	0 1 6
32	724D	Screwdriver ...	0 0 7
33	736D	Grease gun ...	0 6 0
34	725D	Combination spanner ...	0 1 9
35	727D	Box spanner ...	0 2 4
36	13129	Tappet spanner ...	0 0 6
37	735D	Magneto spanner ...	0 0 4
38	733D	Engine spanner ...	0 1 6
39	726D	Double ended spanner ('437in. x '601in. hex.) ...	0 1 0
40	731D	" " ('525in. x '820in. ") ...	0 1 0
41	737D	Inflator ...	0 3 6
	738D	" clips (per pair) ...	0 0 9

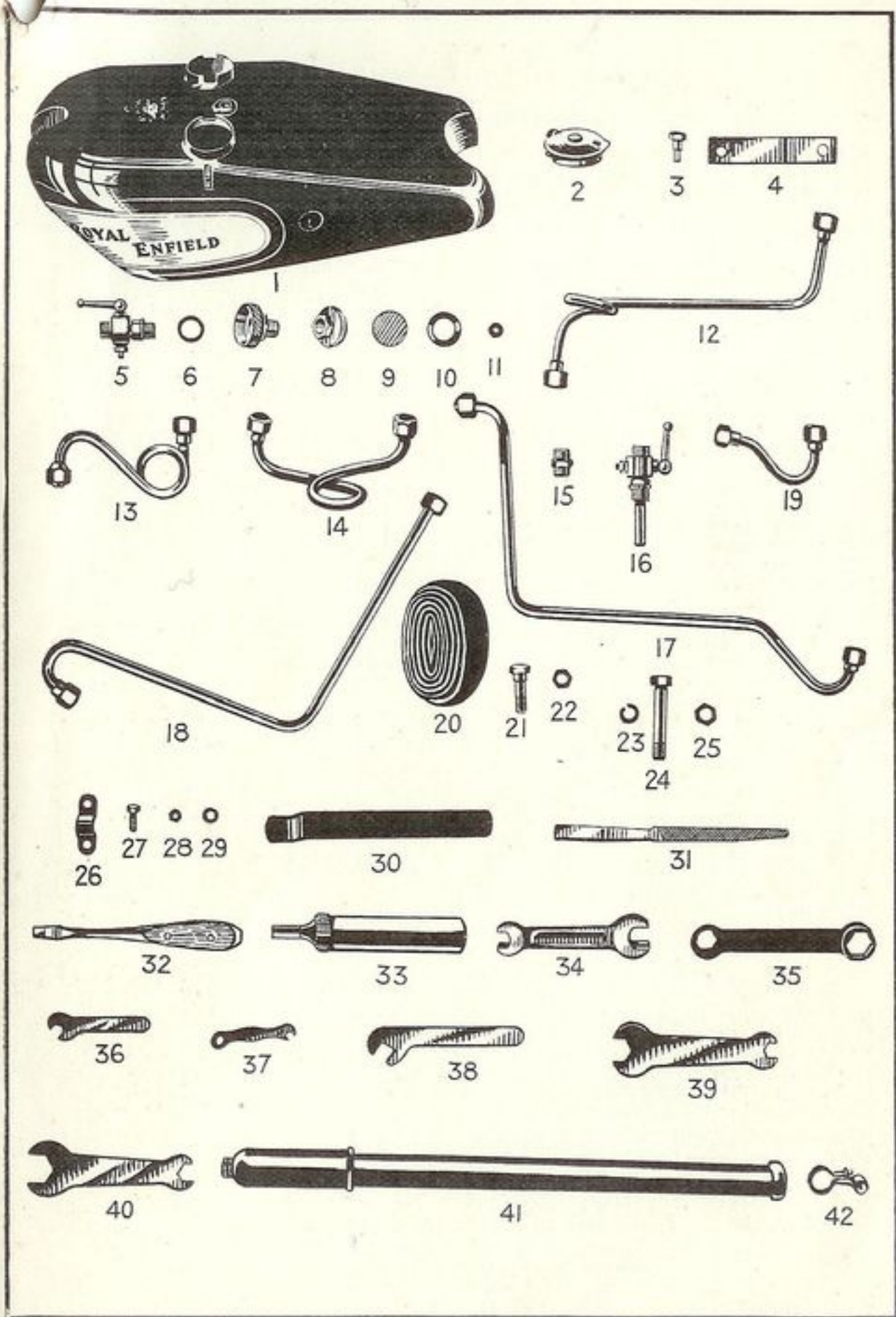

See opposite page for description and price.

MOTOR CYCLE GUARANTEE.

Reprinted from our current Motor Cycle Catalogue.

We give the following Guarantee with our Motor Cycles, Motor Cycle Combinations and Sidecars, which is given in place of any implied conditions, warranties or liabilities whatsoever, statutory or otherwise, all such implied conditions, warranties and liabilities being in all cases excluded. Any statement, description, condition or representation contained in any catalogue, advertisement, leaflet or other publication, shall not be construed as enlarging, varying or over-riding this guarantee.

In the case of machines (a) which have been used for "hiring out" purposes or (b) any motor cycle and/or sidecar used for any dirt track, cinder track, or grass track racing or competitions or any competition of any kind within an enclosure for which a charge is made for admission to take part in or view the competition or (c) machines from which the trade mark, name or manufacturing number has been removed, no guarantee of any kind is given or is to be implied.

WE GUARANTEE, subject to the conditions mentioned below, that all precautions which are usual and reasonable have been taken by us to secure excellence of materials and workmanship, but this guarantee is to extend and be in force for six months only from the date of purchase, and damages for which we make ourselves responsible under this guarantee are limited to the free supply of a new part in exchange for the part of the motor cycle, motor cycle combination or sidecar which may have proved defective. We do not undertake to replace or refix, or bear the cost of replacing or refixing, such new part in the motor cycle, motor cycle combination or sidecar. We undertake, subject to the conditions mentioned below, to make good at any time within six months any defects in these respects. As motor cycles, motor cycle combinations and sidecars are easily liable to derangement by neglect or misuse this guarantee does not apply to defects caused by wear and tear, misuse or neglect. The term "misuse" shall include amongst others the following acts:—

1. The attaching of a sidecar to the motor cycle in such a manner as to cause damage or calculated to render the latter unsafe when ridden.
2. The use of a motor cycle or of a motor cycle and sidecar combined, when carrying more persons or a greater weight than that for which the machine was designed by the manufacturers
3. The attaching of a sidecar to a motor cycle by any form of attachment not provided, supplied or approved by the manufacturers or to a motor cycle which is not designed for such use.

Any motor cycle or motor cycle combination or sidecar sent to us to be plated, enamelled or repaired will be repaired upon the following conditions, *i.e.*, we guarantee that all precautions which are usual and reasonable have been taken by us to secure excellence of materials and workmanship, such guarantee to extend and be in force for three months only from the time such work shall have been executed or until the expiration of the six months above referred to, and this guarantee is in lieu and in exclusion of any common law or statute warranty or condition and the damages recoverable are limited to the cost of any further work which may be necessary to amend and make good the work found to be defective.

CONDITIONS OF GUARANTEE.

If a defective part should be found in our motor cycle, motor cycle combinations or sidecars or in any part supplied by way of exchange before referred to, it must be sent to us CARRIAGE PAID, and accompanied by an intimation from the owner that he desires to have it repaired or exchanged free of charge under our guarantee, and he must also furnish us at the same time with the number of the machine, the date of the purchase, or the date when the alleged defective part was exchanged as the case may be.

Failing compliance with the above, such articles will lie here **AT THE RISK OF THE OWNER**, and this guarantee and any implied guarantee, warranty or condition shall not be enforceable.

We do not guarantee specialities such as tyres, saddles, chains, lamps, etc., or any component parts supplied to the order of the purchaser differing from standard specifications supplied with our motor cycles, motor cycle combinations, sidecars or otherwise

NOTICE.

We do not appoint agents for the sale on our behalf of our motor cycles or other goods, but we assign to motor cycle Dealers, areas in which we supply to such Dealers exclusively for re-sale in such areas. No such Dealer is authorised to transact any business, give any warranty, make any representation or incur any liability on our behalf.

