

LIST OF SPARE PARTS

FOR

ROYAL ENFIELD

The logo for Royal Enfield, featuring the brand name in a stylized, outlined font. Behind the text is a circular gear with a sword or dagger positioned horizontally across it.

4.88 h.p. MOTOR CYCLES

A LIST of
Spare and Replacement Parts for

ROYAL ENFIELD
MADE LIKE A GUN

4.88 h.p. MOTOR CYCLES.



Compiled and Published by

THE ENFIELD CYCLE CO., LTD.
REDDITCH.

Telegrams: "Cycles, Redditch."

Telephone No. Redditch 121 (5 lines).

LONDON SHOWROOMS:

48, HOLBORN VIADUCT, E.C. 1.

Telegrams: "Jigger, Cent, London."
Telephone Nos. 5822 and 5823 Holborn.

LONDON SERVICE DEPOT:

5, 7, 9, HATTON WALL, Hatton Garden, E.C. 1.

Telephone No. 2508 Holborn.

Contractors to H.M. Government, the French and Belgian Governments, and the former Russian Imperial Military Authorities.

All prices of Spare and Replacement Parts are subject to revision or modification, at our discretion, without notice.

Our terms are STRICTLY NET CASH WITH ORDER, or cash on receipt of PRO-FORMA INVOICE. Repairs and sundries items cannot be booked. Prices do not include cost of carriage or postage.

Any part or complete motor cycle sent for repair should be consigned CARRIAGE PAID and the sender's name and address should be given in full on the address tally. Parts sent to us carriage forward are liable to be refused, and to lie with the carriers at sender's risk and expense.

Full instructions regarding the necessary repairs to be done, with advice as to the mode of despatch of the machine (or part), should be posted the same day.

When forwarding motor cycles for repair it is advisable to remove all accessories and easily detached fittings, such as lamp, horn, toolbags, etc. Besides facilitating the work of repair, it will also prevent any loss during transit.

Order all parts by the name of the article and the NUMBER PRECEDING IT, also state the number of the engine or machine for which they are intended. The engine number will be found stamped on the crank case and the machine number on the lug through which the front side-car coupling bolt passes.

GUARANTEE.

We respectfully refer customers to the terms of our guarantee, which appears on page 44 of this list.

When forwarding a complete Motor Cycle, Engine, Carburetter or Magneto with the request that we overhaul the same, we understand by the term "Overhaul" that it is to be entirely dismantled, thoroughly renovated, any worn parts renewed, and put in perfect working order. In case a customer desires only certain parts attended to, full instructions should be given us to that effect, otherwise the cost may be in excess of that anticipated.

ESTIMATES AND QUOTATIONS.

When customers send complete Motor Cycles or parts thereof to us for repairs, we are always prepared to furnish estimates before proceeding with the necessary work. At the same time, it must be distinctly understood that we can only give approximate quotations. Frequently, when the actual work is in progress, it is found necessary to replace parts other than those specified in the estimate, as we make a practice of including in such estimates only those items and parts which at the time we consider really essential to put the machine (or parts) in a thoroughly satisfactory condition.

If any estimate prepared in this way is not accepted, we reserve the right to make a nominal charge for taking down and re-assembling any parts necessary in preparing it.

We cannot hold ourselves responsible for loss of, or damage to, any parts lying at our works for repairs, unless instructions to proceed with same are given within twenty-one days of our estimate for the said repairs having been rendered.

All acetylene-welded repairs to crank cases and other aluminium parts are carried out with extreme care, but we cannot give any guarantee with, or accept responsibility for, any parts so treated.

ROYAL ENFIELD ENGINE.

Illustration No.	Quote this No. and name of part when ordering.	Description.	Price.
			£ s. d.
1	1C	Crankcase (timing side)	3 0 0
2	800C	" (driving side)	2 0 0
3	3C	bearing bush (timing side)	0 3 6
4	801C	" race (driving side)	0 7 6
	5D	" roller (per doz)	0 3 0
6	802C	" cage	0 3 0
7	803C	" end washer	0 0 6
8	8C	thrust washer (timing side)	0 0 6
9	804C	" (driving ")	0 0 6
10	18D	breather flange (top)	0 1 0
11	21D	" with oil pipe (bottom)	0 3 0
12	19D	" screw	0 0 2
13	20D	" disc	0 0 2
14	16D	oil drain plug	0 0 6
15	17D	" washer	0 0 1
16	805C	overflow pipe	0 2 0
17	837C	" clip	0 0 2
18	14D	" union	0 0 9
19	15D	" washer	0 0 1
20	662D	" nut	0 0 6
21	21C	bush for camshaft	0 1 6
22	22C	cylinder stud	0 0 6
23	23C	" nut	0 0 2
24	11D	timing cover stud	0 0 3
25	13D	" nut	0 0 1
26	200D	" washer	0 0 1
27	806C	" screw	0 0 1
28	28C	Tappet guide	0 2 6
29	29C	" rod	0 1 0
30	91D	" body	0 1 0
31	89D	" head	0 0 9
32	90D	" locknut	0 0 4
33	807C	Camshaft	0 15 0
34	34C	" wheel	0 5 0
35	35C	Timing pinion	0 4 0
36	32D	" nut	0 0 3
37	33D	" key	0 0 2
38	38C	Valve rocker	0 5 0
39	24D	" spindle	0 1 6
40	25D	" distance piece (long)	0 0 2
41	26D	" (short)	0 0 2
42	808C	Timing gear cover	1 0 0
43	809C	" camshaft bush	0 1 6
44	810C	Magneto driving sprocket (Standard)	0 2 6
	811C	" (M-L, Lighting set)	0 2 6
45	40E	" nut	0 0 2
46	812C	chain cover	0 10 6
47	43G	" screw	0 0 2
48	44G	" cap	0 0 6
49	45G	" spring clip	0 0 3
50	46G	" screw	0 0 1
51	813C	Exhaust lifter lever, cam and connection	0 5 0
52	37D	" guide	0 0 6
53	36D	" spring	0 0 3
54	38D	" tube	0 0 9
55	39D	" nipple	0 0 4
56	40D	" cable body	0 0 6
57	41D	" adjusting screw	0 0 4
	13D	" locknut (as illust. 25)..	0 0 1
58	43D	" " D " washer	0 0 1
59	45D	" leather washer	0 0 1

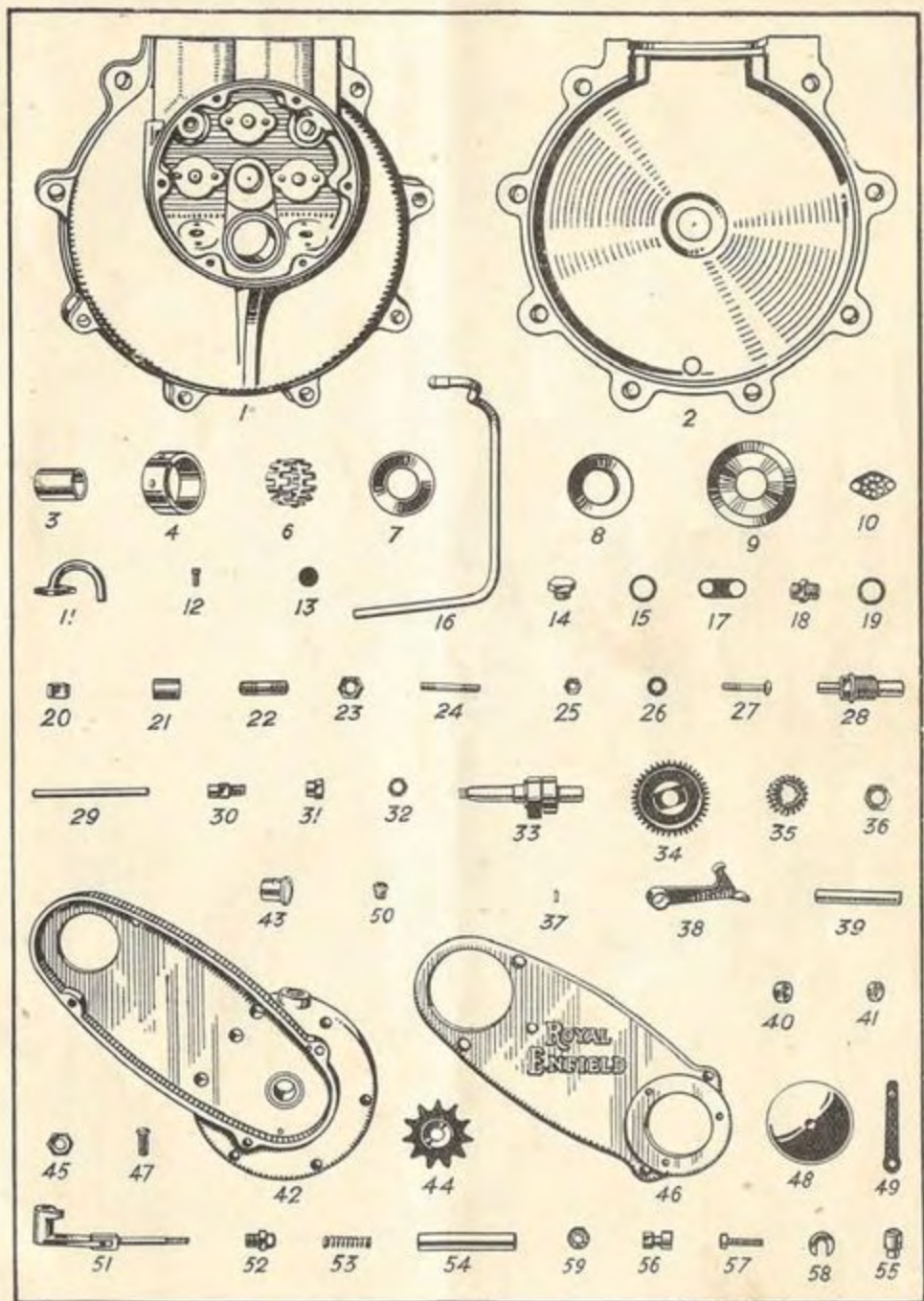

See opposite page for description and price.

ENGINE—Continued.

Illustration No.	Quote this No. and name of part when ordering.	Description.	Price.		
			£	s.	d.
1	814C	Cylinder with valve guides	3	15	0
2	61C	joint washer	0	0	5
3	815C	Valve	0	5	0
4	816C	guide	0	2	6
5	64C	spring	0	1	0
6	817C	collar (top)	0	0	8
7	818C	collar (bottom)	0	0	8
8	819C	split collar	0	0	6
9	68C	cap	0	3	6
10	69C	joint washer	0	0	2
11	131D	cup	0	0	2
12	68E	spring	0	0	3
13	65D	felt washer	0	0	1
14	144D	Induction pipe (Standard)	0	2	6
	70C	(Lighting Set)	0	2	6
15	145D	nut	0	1	0
16	72C	Piston with gudgeon pin and rings complete	1	8	0
17	73C	ring	0	1	6
18	74C	Gudgeon pin and pads	0	5	0
19	75C	pad, each	0	0	6
20	76C	Connecting rod with bushes	1	0	0
21	78C	small end bush	0	2	6
22	77C	big	0	5	6
	5D	bearing roller, each	0	0	3
23	80C	cage	0	2	6
24	81C	washer	0	0	6
25	82C	Crank pin	0	6	0
26	83C	nut	0	0	6
27	84C	locking washer	0	0	2
28	85C	set screw	0	0	2
29	1190C	Flywheel (driving side)	1	5	0
	87C	(timing)	1	5	0
30	820C	Driving shaft	0	6	0
31	103E	nut	0	0	6
32	93C	key	0	0	3
33	89C	Timing shaft	0	6	0
34	82D	nut	0	0	6
35	91C	Locking washer for nuts	0	0	2
	85C	set screw (as illust. 28)	0	0	2
	92D	Oil pump complete (non-adjustable)	1	0	0
	821C	body	0	10	0
36	96D	screw	0	0	2
37	94D	cover	0	1	0
38	95D	screw	0	0	2
39	102D	plunger	0	2	0
40	822C	spindle	0	2	6
41	99D	disc	0	5	0
42	100D	spring	0	0	2
43	823C	worm	0	1	0
44	105D	joint washer	0	0	3
45	14D	union	0	0	9
46	104D	union washer	0	0	1
47					

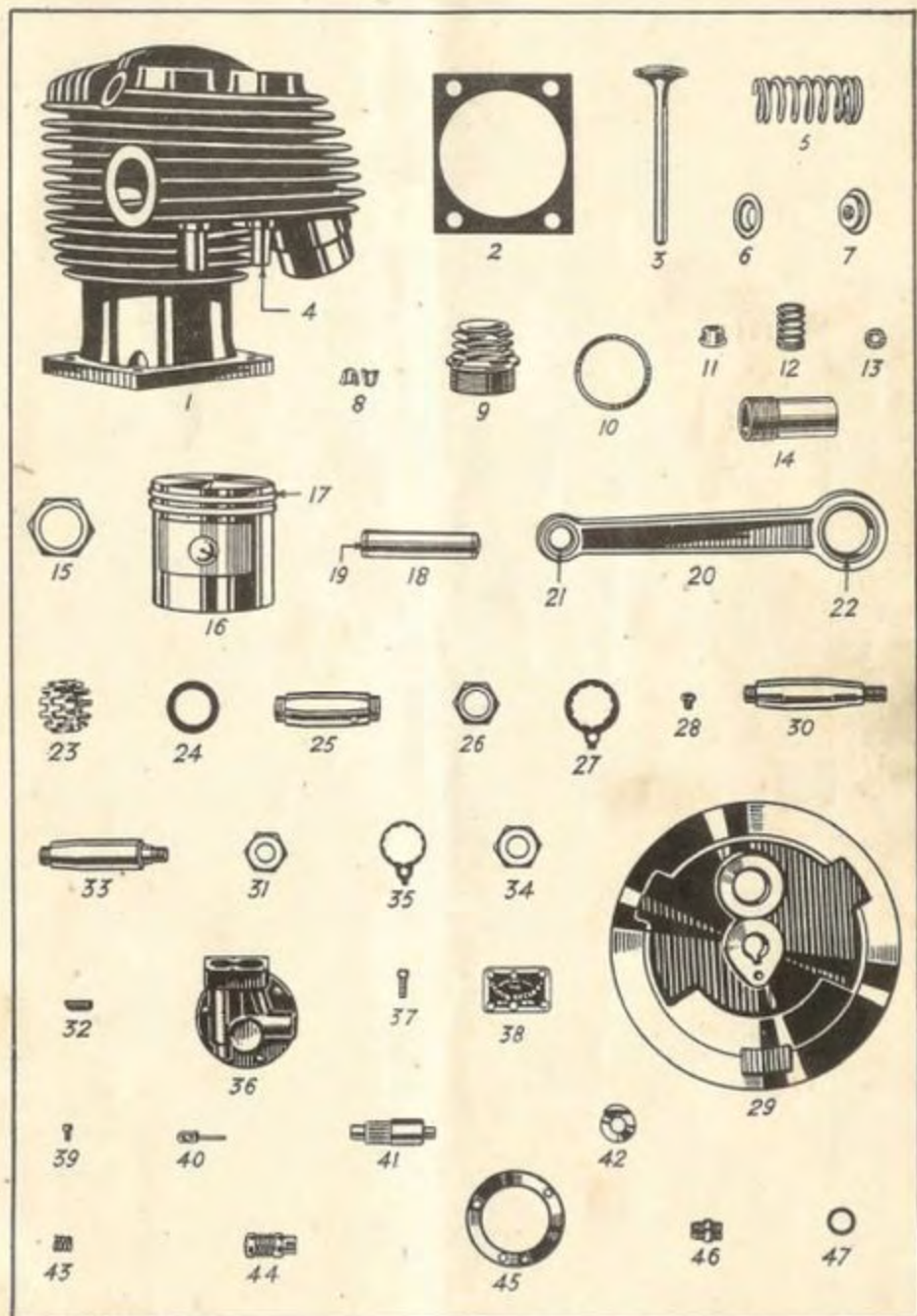

See opposite page for description and price.

4.88 H.P. ROYAL ENFIELD MOTOR CYCLES.

SPECIAL PARTS FOR O.H.V. ENGINES.

Illus. traction No.	Quote this No. and name of part when ordering.	Description.	Price.
1	1191C	Cylinder barrel	£ 2 0 0
2	824C	" " joint	0 0 6
3	825C	" head	2 5 0
4	826C	" " joint	0 1 0
	827C	" " stud	0 0 6
5	828C	Valve guide	0 2 6
6	829C	Rocker housing	1 5 0
7	830C	" " post	0 2 0
8	831C	" " " pin	0 0 3
9	832C	" (inlet) with ball end	0 10 0
10	833C	" (exhaust) " " "	0 10 0
11	834C	" pin	0 3 0
12	835C	" " nut	0 0 6
13	123D	" grease nipple	0 0 3
14	836C	Valve	0 10 0
15	838C	" spring (outer)	0 1 0
16	839C	" " (inner)	0 0 6
17	840C	" " collar (top)	0 0 9
18	841C	" " " (bottom)	0 0 9
19	130D	" stem cap	0 0 6
20	842C	" push rod with ends	0 2 6
21	843C	" " " sleeve with nut (top)	0 2 6
22	844C	" " " " " (bottom)	0 2 6
23	847C	Tappet (inlet)	0 5 0
24	848C	" (exhaust)	0 5 0
25	849C	" guide (inlet)	0 6 0
26	850C	" " (exhaust)	0 6 0
27	851C	" " clamp	0 1 6
28	852C	" " " stud	0 0 3
29	853C	" " " " nut	0 0 2
30	854C	" body	0 0 6
31	855C	" head	0 0 9
32	856C	Piston complete with rings, gudgeon pin and pads	1 5 0
33	857C	" ring	0 1 6
34	858C	Connecting rod with bushes	1 0 0
	859C	" " big end rollers (each)	0 0 3
35	860C	Valve lifter cam	0 2 0
36	861C	" " lever	0 1 6
37	46E	" " " taper pin	0 0 2
38	862C	" " bush	0 1 3
39	48E	" " cable roller	0 0 3

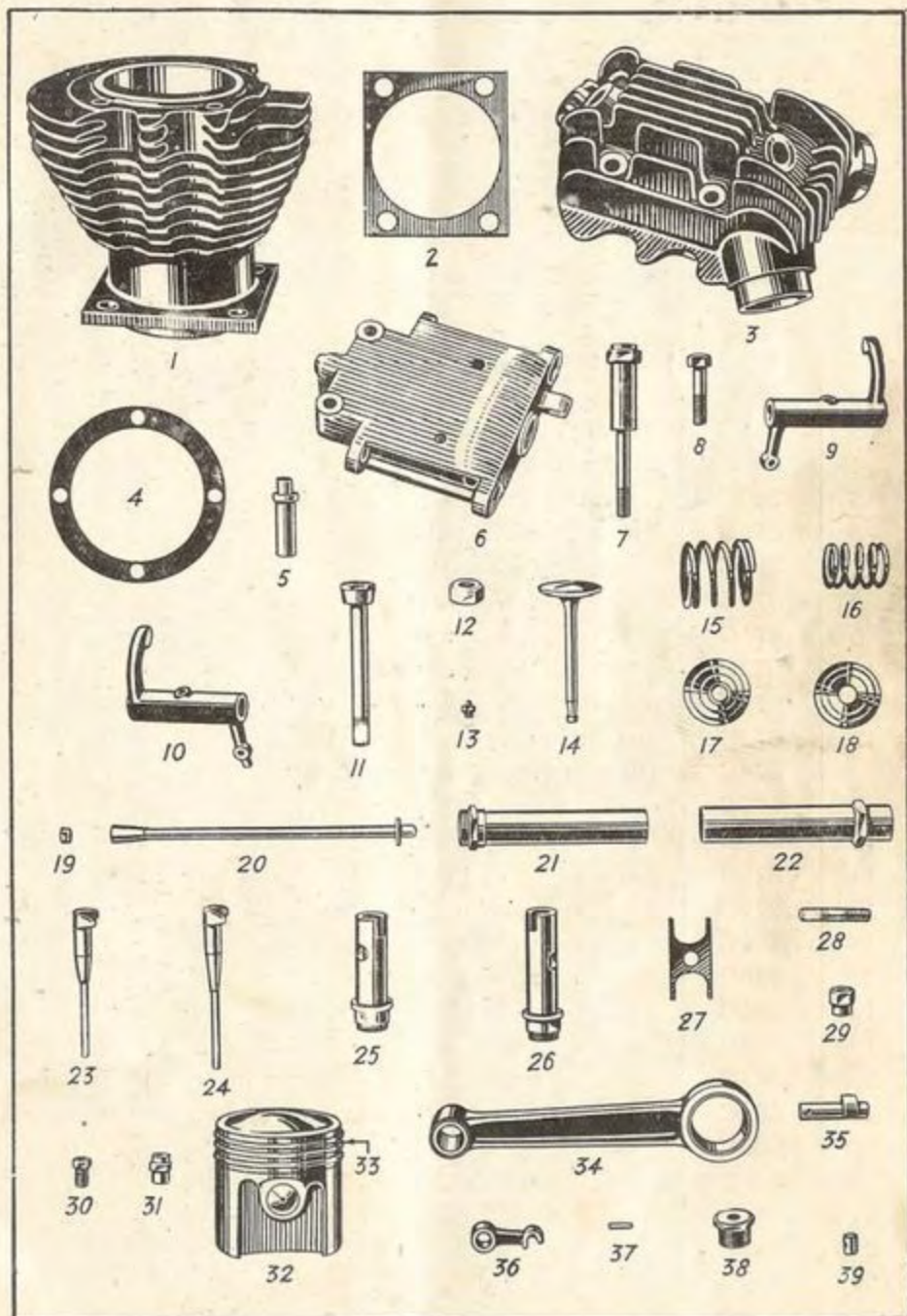

See opposite page for description and price,

SPECIAL PARTS FOR O.H.V. ENGINES—*continued.*

Illustration No.	Quote this No. and name of part when ordering.	Description.	Price.		
			£	s.	d.
1	863C	Crankcase (driving side)	2	0	0
2	864C	" (timing side).... ..	3	0	0
3	865C	Timing gear cover	1	0	0
4	866C	Magneto chain cover	0	10	6
5	867C	Camshaft (inlet)	0	10	0
6	868C	" wheel (inlet)	0	3	6
7	869C	" (exhaust)	0	10	6
8	870C	" wheel (exhaust)	0	3	6
9	871C	" crankcase bush	0	1	0
10	872C	" timing cover bush (short)	0	1	0
11	872C	" " " " (long)	0	1	6
12	873C	Induction pipe	0	1	6
	874C	Oil pump complete (front feed)	1	10	0
	875C	" " " (rear ")	1	10	0
13	877C	" " body (rear feed)	0	12	6
14	878C	" " " (front ")	0	12	6
15	879C	" " spindle	0	2	0
16	106G	" " worm	0	1	0
17	880C	" " regulator spindle	0	0	6
18	881C	" " " " knob	0	1	0
19	882C	" " " " disc	0	0	3
20	883C	" " " " plunger	0	0	3
21	884C	" " " " " spring	0	0	1
22	885C	" " " " gland washer	0	0	1
23	886C	" " " " " spring "	0	0	1
24	47F	" " " " " steel "	0	0	1
25	887C	" " " " stop	0	0	1
26	888C	" " " " nut	0	0	1
27	212D	" " " " washer	0	0	1

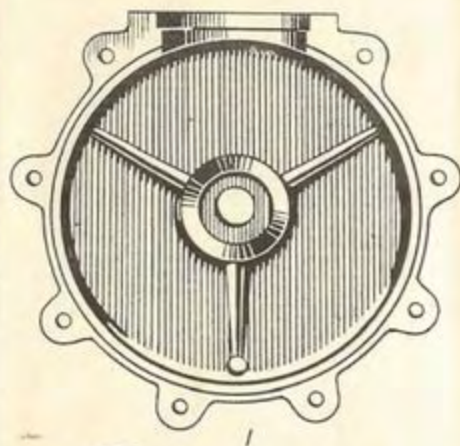

1

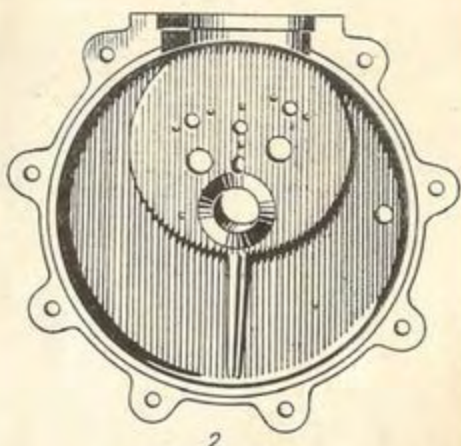

2

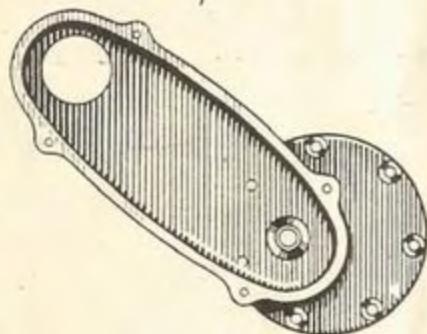

3

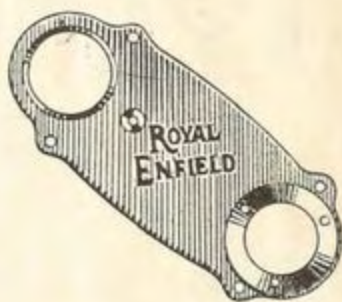

4



5



6

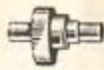

7



8



9



10



11



12



14



15



15



16



17



18



19



20



21



22



23



24



25



26



27

See opposite page for description and price.

SILENCER AND FOOTRESTS.

Illustration No.	Quote this No. and name of part when ordering.	Description.	Price.		
			£	s.	d.
1	889C	Silencer (Model 501 & 505)	0	15	0
	890C	" (Model 505) for L.H. side only	0	15	0
2	620C	" attachment pin	0	0	2
3	631D	" " " " spring washer	0	0	1
4	891C	" tail pipe with fishtail	0	7	6
5	892C	" " " clip	0	1	0
6	893C	" " " " pin	0	0	2
7	894C	" " " " nut	0	0	3
8	895C	Exhaust pipe (Model 501)	0	15	0
	896C	" (Model 505, R.H.)	0	15	0
	897C	" (Model 505, L.H.)	0	15	0
9	164D	" " clip, (top)	0	0	9
10	165D	" " " pin	0	0	2
11	166D	" " " " nut	0	0	2
12	167D	" " " " bush	0	0	2
13	122C	" " " (bottom)	0	0	9
14	204D	" " " pin	0	0	2
15	182D	" " " " nut	0	0	1
16	123C	" " " for footrest tube	0	0	6
	204D	" " " pin (as illust. 14)	0	0	2
	182D	" " " nut (" 15)	0	0	1
17	126C	Footrest supporting stud ($\frac{1}{2}'' \times 14\frac{3}{4}''$)	0	1	0
18	127C	" " " ($\frac{1}{2}'' \times 5\frac{3}{4}''$)	0	0	6
19	170D	" " " nut	0	0	3
20	194D	" " " washer	0	0	1
21	131C	" " " tube ($\frac{3}{4}'' \times 5''$)	0	1	0
22	130C	" " " distance tube ($\frac{11}{16}'' \times 2\frac{1}{2}''$)	0	0	6
23	132C	" supporting arm	0	1	0
24	178D	" rubber	0	1	0
25	179D	" " side plate	0	0	6
26	181D	" " stud	0	0	3
	182D	" " " nut (as illust. 15 15)	0	0	1
27	180D	" " distance tube	0	0	6
28	899C	Legshield, each	0	4	6
29	900C	" supporting bar (top)	0	1	6
30	901C	" " " clip	0	0	6
31	902C	" " " " packing piece	0	0	6
32	389D	" " " " pin	0	0	2
33	12D	" " " " nut	0	0	1
34	200D	" " " " washer	0	0	1
35	903C	" " " tube (bottom)	0	1	6
36	904C	" " " stud	0	0	3
37	203D	" clip	0	0	4
38	229D	" pin	0	0	2
	182D	" " " nut (as illust. 15)	0	0	1
39	212D	" " " washer	0	0	1

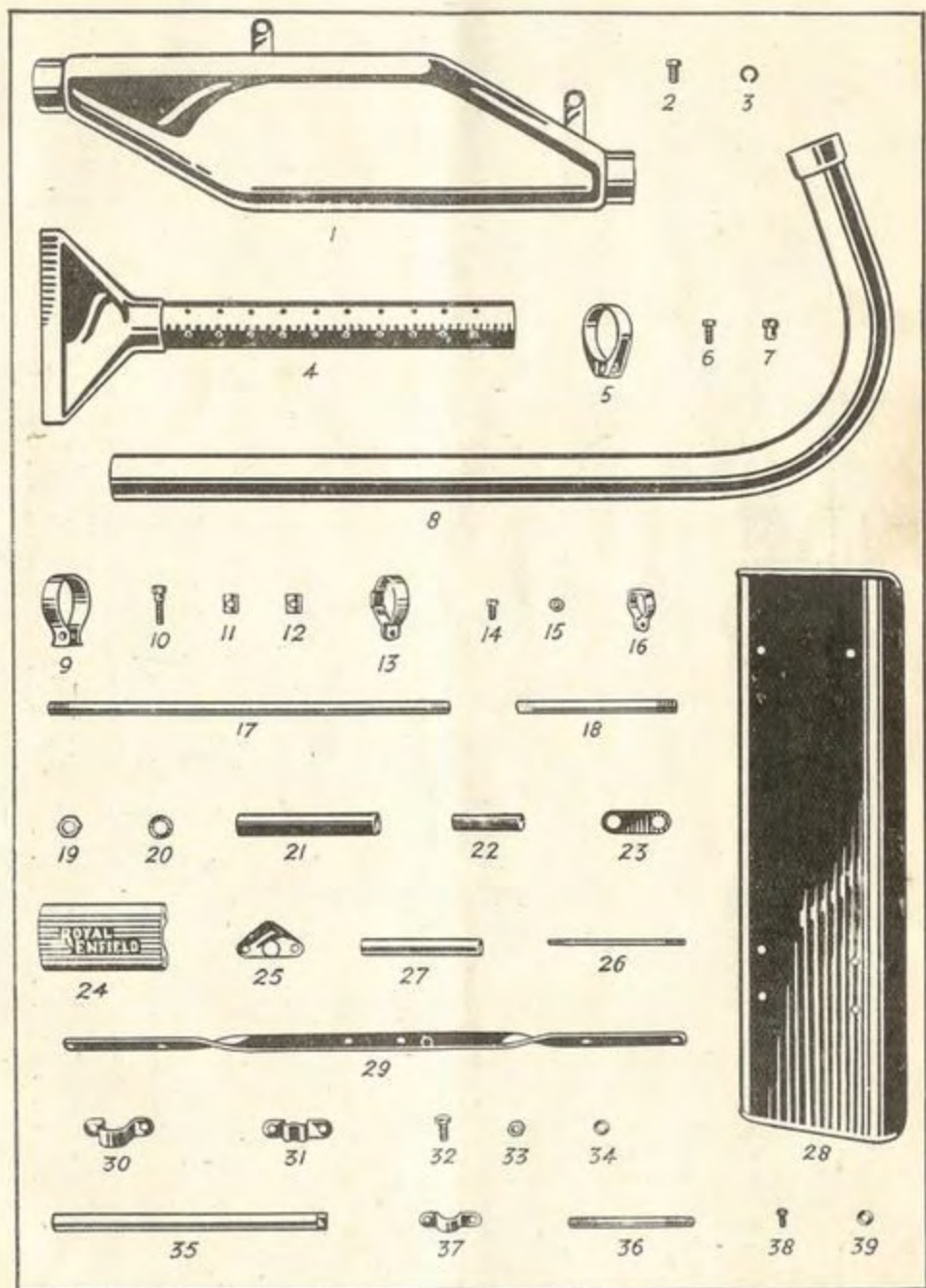

See opposite page for description and price.

ROYAL ENFIELD FOUR-SPEED GEARBOX.

Illustration No.	Quote this No. and name of part when ordering.	Description.	Price.
			£ s. d.
1	905C	Gearbox case	1 10 0
2	906C	" cover	1 2 6
3	172C	" " joint washer	0 0 6
4	173C	" " stud	0 0 2
5	698D	" " " nut	0 0 1
6	175C	" " " washer	0 0 1
7	389D	" " screw	0 0 2
8	177C	" " dowel	0 0 2
9	907C	" operating quadrant cover	0 3 6
10	179C	" " " screw	0 0 2
11	908C	" oil filler plug	0 0 8
12	181C	" " " washer	0 0 1
13	909C	Mainshaft	0 15 0
14	186C	" bearing race (large)	0 3 6
15	187C	" " " washer	0 0 3
16	188C	" " " felt washer	0 0 3
17	189C	" " " thrust washer	0 1 0
18	190C	" " end washer	0 0 2
19	191C	" " oil retaining washer	0 0 2
	75D	" roller, each	0 0 3
20	193C	" " " cage (large)	0 2 6
21	194C	" " " (small)	0 1 3
22	195C	" " race (small)	0 1 6
23	196C	" " " end and thrust washer	0 0 3
	5D	" roller, each	0 0 3
24	199C	" thrust washer	0 0 6
25	200C	" 26 tooth gear	0 15 0
26	201C	" 23 " "	0 10 0
27	202C	" 20 " "	0 10 0
28	203C	" 14 " "	0 2 6
29	204C	Layshaft	0 12 6
30	195C	" bearing race	0 1 6
31	196C	" " " end washer	0 0 3
	5D	" " roller each	0 0 3
	194C	" " " cage (as illust. 21)....	0 1 3
32	209C	" thrust washer....	0 0 6
33	210C	" 18 tooth gear	0 3 0
34	211C	" 21 " "	0 10 0
35	212C	" 24 " "	0 10 0
36	213C	" 30 " " and kickstarter wheel	0 10 0
37	214C	" bearing bush	0 2 0
38	910C	Gearbox countershaft sprocket	0 5 0
39	216C	" " " key	0 0 4
40	217C	" " " nut	0 0 6

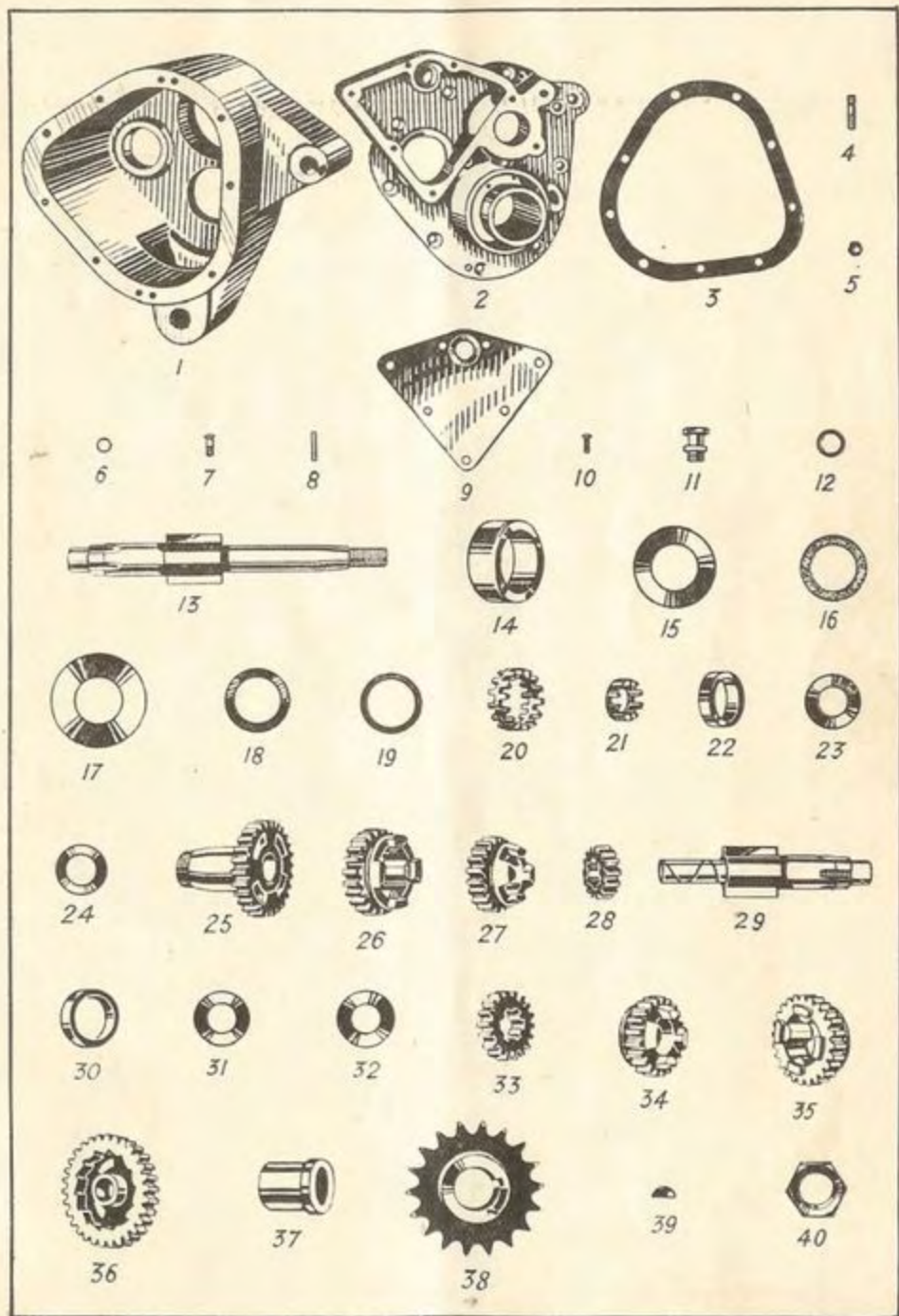

See opposite page for description and price.

KICKSTARTER, CLUTCH AND GEAR OPERATING MECHANISM (FOUR-SPEED).

Illustration No.	Quote this No. and name of part when ordering.	Description.	Price.
1	911C	Kickstarter spindle with layshaft bearing bush	£ 0 s. d. 0 12 0
2	246E	" " bearing bush	0 5 0
3	227C	" " pawl	0 1 6
4	228C	" " rivet	0 0 2
5	229C	" " plunger	0 0 2
6	230C	" " " spring	0 0 2
7	912C	" " " cam	0 0 3
8	913C	" " " rivet	0 0 1
9	231C	" crank	0 7 6
10	232C	" " cotter pin	
11	233C	" " " nut	0 0 6
12	234C	" " " washer	
13	914C	" " return spring	0 1 0
14	236C	" " " cover	0 0 9
15	915C	" " distance tube	0 0 2
	916C	" " stop	0 1 0
16	917C	" " stud	0 0 2
17	13D	" " " nut	0 0 1
18	200D	" " " washer	0 0 1
19	918C	Clutch operating lever	0 2 6
20	261E	" " pin	0 0 2
21	262E	" " worm	0 1 6
22	919C	" " nut	0 2 6
23	264E	" " gland washer	0 0 1
24	266E	" " rod	0 1 0
25	250C	" " pad	0 0 6
26	268E	" " cable stop	0 0 9
27	251C	Gear operating cam	0 12 6
28	252C	" " bearing bush (large)	0 2 0
29	253C	" " " (small)	0 2 0
30	254C	" " arm (top gear)	0 6 0
31	255C	" " (bottom gear)	0 6 0
32	274E	" " tracing roller	0 0 6
33	257C	" " " bush	0 0 9
34	258C	" " " locking washer	0 0 2
35	277E	" " tracing roller spring	0 0 2
36	278E	" " quadrant	0 7 6
37	279E	" " bearing bush	
		" " (long)	0 0 9
38	280E	" " " (short)	0 0 6
	123D	" " grease nipple	0 0 3
39	920C	" " lever	0 2 0
40	282E	" " key	0 0 2
41	283E	" " nut	0 0 3

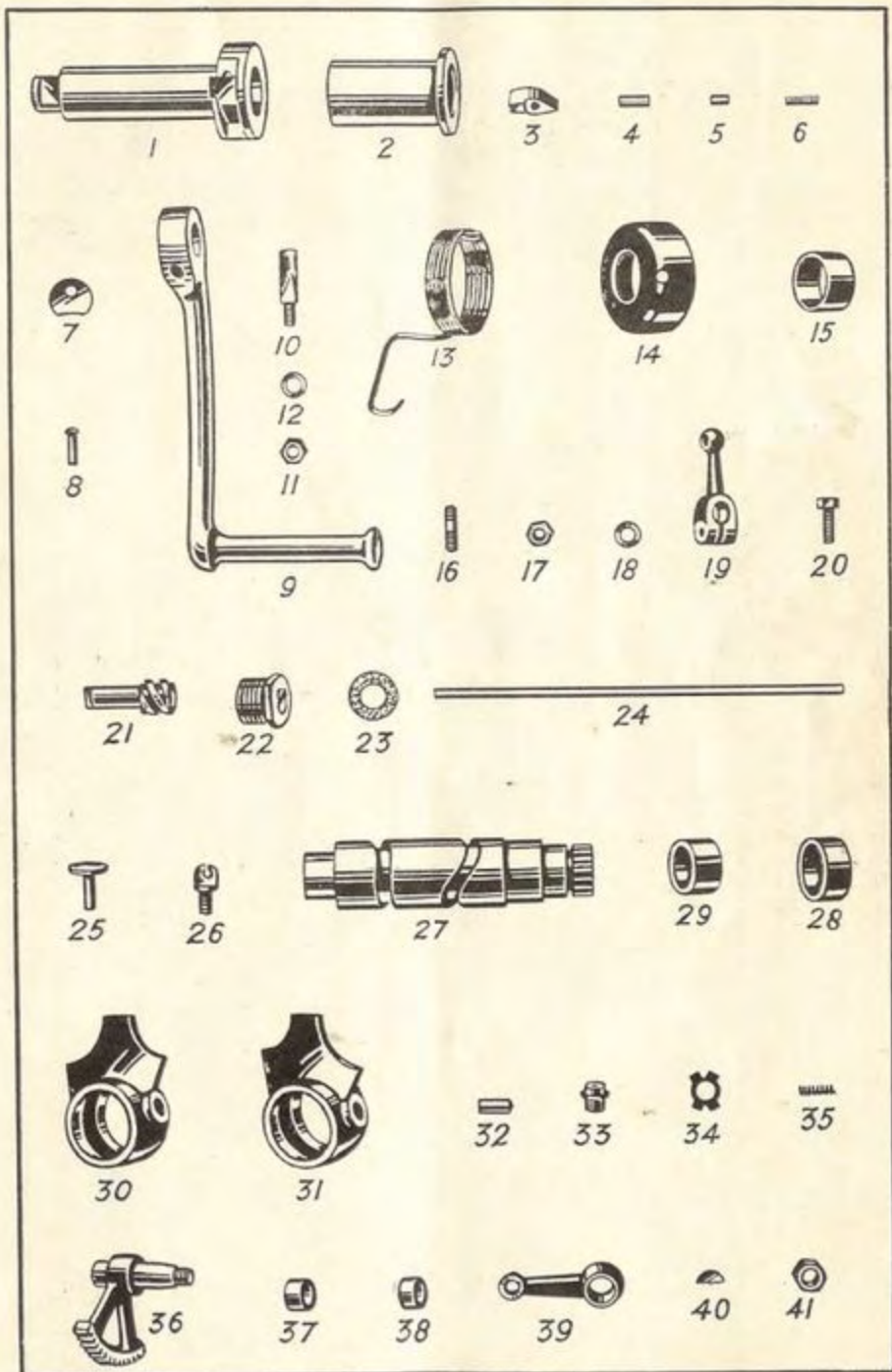

See opposite page for description and price.

**CLUTCH (THREE-SPEED AND FOUR-SPEED);
GEAR CONTROL (FOUR-SPEED).**

Illustration No.	Quote this No. and name of part when ordering.	Description.	Price.
1	290E	Clutch sprocket with roller race, drum and Ferodo pads	£ s. d. 1 5 0
	75D	" " bearing roller, each	0 0 3
	272C	" " ½" dia. ball, per doz.	0 0 5
2	293E	centre " " " " " " " " " " " "	0 12 6
3	294E	back plate " " " " " " " " " " " "	0 2 6
4	295E	" " " " spacing washer " " " " " " " " " "	0 1 0
5	275C	plate (thick) " " " " " " " " " " " "	0 2 6
6	276C	" " (thin) " " " " " " " " " " " "	0 2 0
7	274C	" " " " complete with Ferodo pads " " " " " " " " " "	0 5 0
8	299E	" " " " cork " " " " " " " " " "	0 3 0
9	278C	" " Ferodo pad, large (short) " " " " " " " " " "	0 0 2
10	301E	" " " " " " (long) " " " " " " " " " "	0 0 2
11	279C	" " " " " " small (short) " " " " " " " " " "	0 0 2
12	303E	" " " " " " (long) " " " " " " " " " "	0 0 2
13	304E	" " cork pad " " " " " " " " " " " "	0 0 1
14	280C	" " spring " " " " " " " " " " " "	0 0 3
15	281C	" " cup " " " " " " " " " " " "	0 0 3
16	307E	" " stud " " " " " " " " " " " "	0 0 6
17	308E	" " nut " " " " " " " " " " " "	0 0 2
18	284C	" " adjusting screw " " " " " " " " " " " "	0 0 2
19	285C	" " " " " " washer " " " " " " " " " "	0 0 1
20	311E	" " pressure plate " " " " " " " " " " " "	0 3 0
21	287C	" " nut " " " " " " " " " " " "	0 0 6
22	288C	" " washer " " " " " " " " " " " "	0 0 1
23	921C	Gear control lever and bellcrank " " " " " " " " " " " "	0 3 0
24	687D	" " " " knob " " " " " " " " " " " "	0 0 9
25	688D	" " " " " " ferrule " " " " " " " " " "	0 0 3
26	689D	" " " " " " collar " " " " " " " " " "	0 0 1
27	690D	" " " " " " distance piece " " " " " " " " " "	0 0 3
28	692D	" " " " " " spindle " " " " " " " " " "	0 0 6
29	694D	" " " " " " washer " " " " " " " " " "	0 0 2
30	695D	" " " " " " spring washer " " " " " " " " " "	0 0 2
31	303C	" " gate " " " " " " " " " " " "	0 1 6
32	697D	" " " " screw " " " " " " " " " " " "	0 0 1
33	698D	" " " " " " nut " " " " " " " " " "	0 0 1
34	684D	" " " " " " arm " " " " " " " " " "	0 2 6
35	580D	" " " " " " screw " " " " " " " " " "	0 0 2
36	922C	" " rod " " " " " " " " " " " "	0 0 6
37	701D	" " " " " " connection (top) " " " " " " " " " "	0 1 0
38	702D	" " " " " " " " (bottom) " " " " " " " " " "	0 1 0
39	703D	" " " " " " locknut " " " " " " " " " "	0 0 1
40	704D	" " " " " " pin " " " " " " " " " "	0 0 2
	525D	" " " " " " split pin " " " " " " " " " "	0 0 1

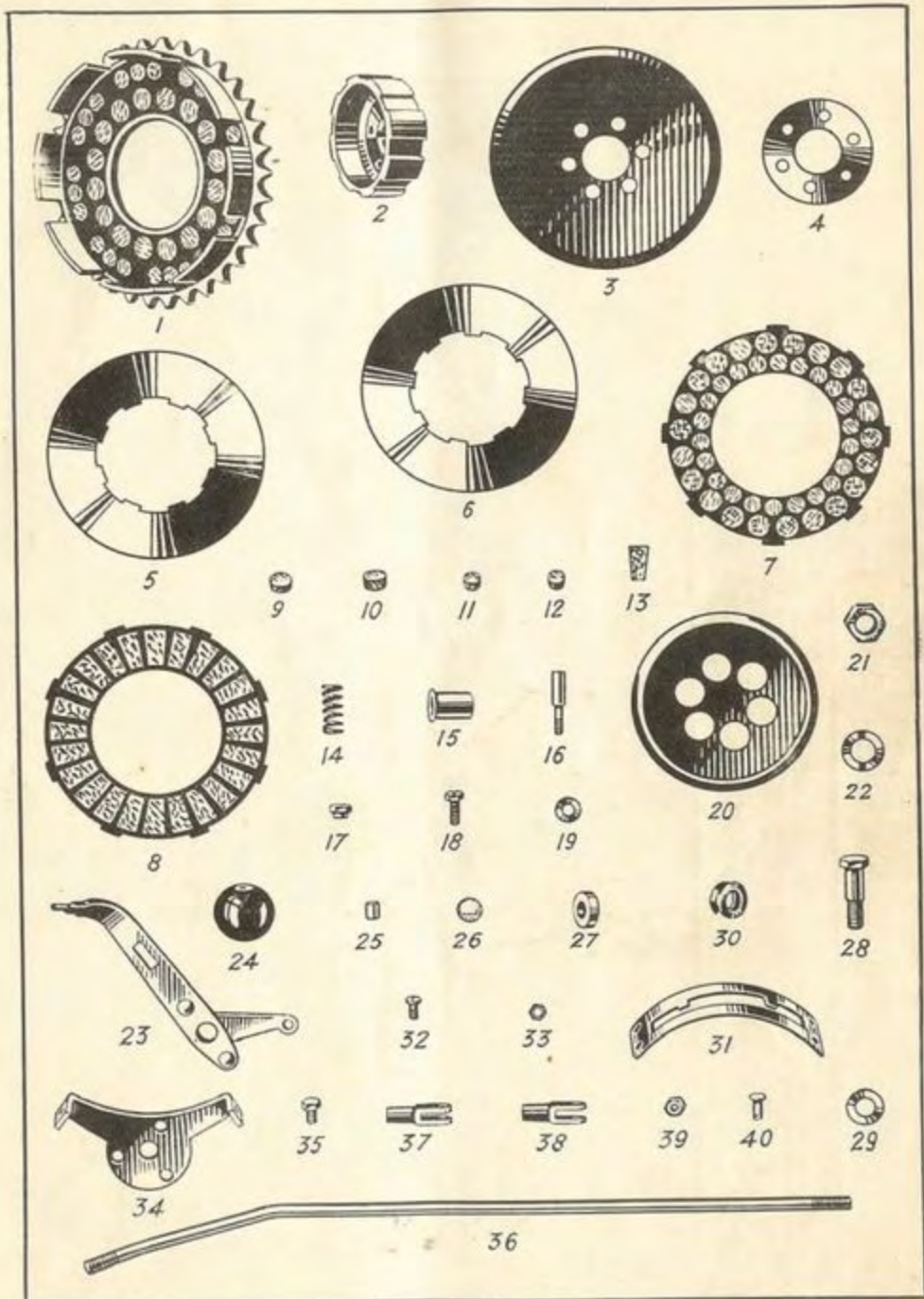

See opposite page for description and price.

STURMEY-ARCHER THREE-SPEED GEARBOX AND GEARS, Etc.

Illustration No.	Quote this No. and name of part when ordering.	Description.	Price.		
			£	s.	d.
1	1106C	Gearbox case	1	16	0
2	1107C	" cover	0	15	0
3	1108C	" " joint	0	0	2
4	1109C	" " stud	0	0	3
5	1110C	" " " nut	0	0	2
6	1112C	" " " spring washer (set of 7) ..	0	0	4
7	1113C	" oil filler plug	0	0	9
8	1117C	Mainshaft	0	13	0
9	1118C	" bearing race	0	5	0
10	1119C	" " " dust cover	0	0	3
11	1120C	" " cone....	0	2	6
12	1121C	" " " adjusting washer	0	0	1
	272C	" " ball ($\frac{1}{4}$ " dia.), per doz.	0	0	5
13	1122C	" 24 tooth gear	0	16	0
14	1123C	" 22 " "	0	8	6
	1190C	" 21 " " (for close ratio)	0	8	6
15	1124C	" 14 " "	0	4	0
	1191C	" 15 " " (for close ratio)	0	4	0
16	1125C	" journal bearing	0	8	9
17	1126C	" " " packing washer... ..	0	0	1
18	1127C	" thrust washer	0	1	6
19	1128C	Layshaft	0	13	6
	1125C	" journal bearing (at illust. 16)	0	8	9
20	1129C	" " " cup	0	0	3
21	1130C	" " " oil retaining washer ..	0	0	2
22	1131C	" 18 tooth gear	0	5	0
23	1132C	" 20 " "	0	10	0
	1192C	" 21 " " (for close ratio)	0	10	0
24	1133C	" 28 " " and kickstarter wheel ..	0	10	0
	1193C	" 27 " " " " " " ..			
		(for close ratio)	0	10	0
25	1135C	Speedometer drive case		2	6
26	1136C	" " " screw	0	0	3
27	1137C	" " " " spring washer ..	0	0	1
28	1138C	" " " wheel	0	2	6
29	1139C	" " " spindle	0	1	3
30	1140C	" " " bush	0	0	8
31	1141C	" " " " retaining bush.	0	1	6
32	1142C	" " " wheel spindle retaining bush set screw ..	0	0	1
33	1143C	* " " drive cover	0	0	3
34	1144C	* " " " screw	0	0	3
	1137C	* " " " " spring washer ..			
		(as illust. 27) ..	0	0	1
35	1145C	Gearbox countershaft sprocket	0	7	6
36	1146C	" " " nut....	0	0	8
37	1147C	" " " " locking	0	0	4
38	1148C	" " " " " screw	0	0	1
39	1149C	" " " " felt washer	0	0	2

*Fitted where speedometer is not used.

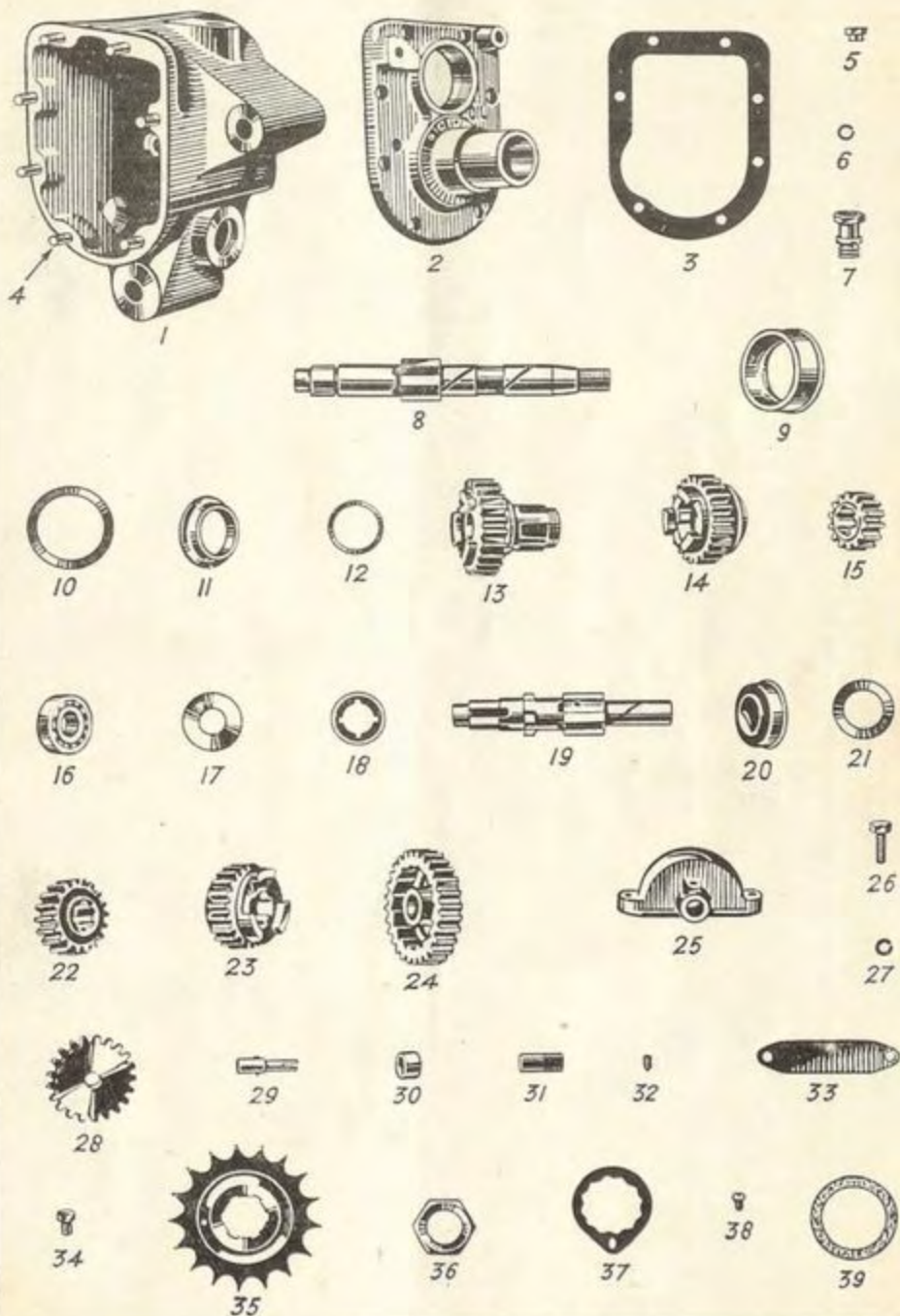

See opposite page for description and price.

KICKSTARTER, CLUTCH OPERATING MECHANISM AND GEAR CONTROL (THREE - SPEED).

Illustration No.	Quote this No. and name of part when ordering.	Description.	Price.
			£ s. d.
1	1150C	Kickstarter spindle with layshaft bearing bush	0 12 6
2	1151C	" " bearing bush	0 1 6
3	1152C	" " pawl	0 1 3
4	1153C	" " pin	0 0 3
5	1154C	" " plunger	0 0 3
6	1155C	" " " spring	0 0 1
7	1156C	" " cam	0 0 3
8	1157C	" stop piece	0 0 4
9	1158C	" " and cam rivet	0 0 1
10	1159C	" crank	0 11 0
11	232C	" cotter pin	0 0 6
12	233C	" " nut	0 0 6
13	234C	" " washer	0 0 6
14	1160C	" return spring	0 1 0
15	1161C	" " cover	0 0 9
16	1162C	" distance tube	0 0 3
17	1163C	Clutch operating lever	0 2 6
18	1164C	" pin	0 0 1
19	1165C	" worm	0 1 9
20	1166C	" nut	0 4 0
21	1167C	" gland nut	0 0 9
22	1168C	" " washer	0 0 2
23	1169C	" cable stop	0 0 9
24	1170C	Gear operating sliding plate	0 2 6
25	1171C	" rocking fork	0 8 0
26	1172C	" " plunger	0 0 8
27	1173C	" " spring	0 0 2
28	1174C	" " plug	0 0 3
29	1175C	" shaft	0 1 3
30	1176C	" bush	0 1 6
31	1177C	" lever	0 10 6
32	1178C	" bush	0 2 0
33	1180C	" lock washer	0 0 3
34	1181C	Gear control lever and bell crank	0 3 0
35	687D	" knob	0 0 9
36	688D	" ferrule	0 0 3
37	689D	" collar	0 0 1
38	690D	" distance piece	0 0 3
39	692D	" spindle	0 0 6
40	694D	" washer	0 0 2
41	695D	" spring washer	0 0 2
42	1182C	" gate	0 1 6
43	697D	" screw	0 0 1
44	698D	" nut	0 0 1
45	684D	" arm	0 2 6
46	580D	" screw	0 0 1
47	1183C	rod	0 0 6
48	701D	" connection	0 1 0
49	703D	" locknut	0 0 1
50	704D	" pin	0 0 2
	525D	" split pin	0 0 1
	1184C	ball joint complete	0 3 0
51	1185C	" body	0 1 3
52	1186C	" cup (fixed)	0 0 6
53	1187C	" (adjustable)	0 0 9
	1188C	" split pin	0 0 1
54	1189C	" ball	0 0 9
55	13D	" nut	0 0 1
56	200D	" washer	0 0 1

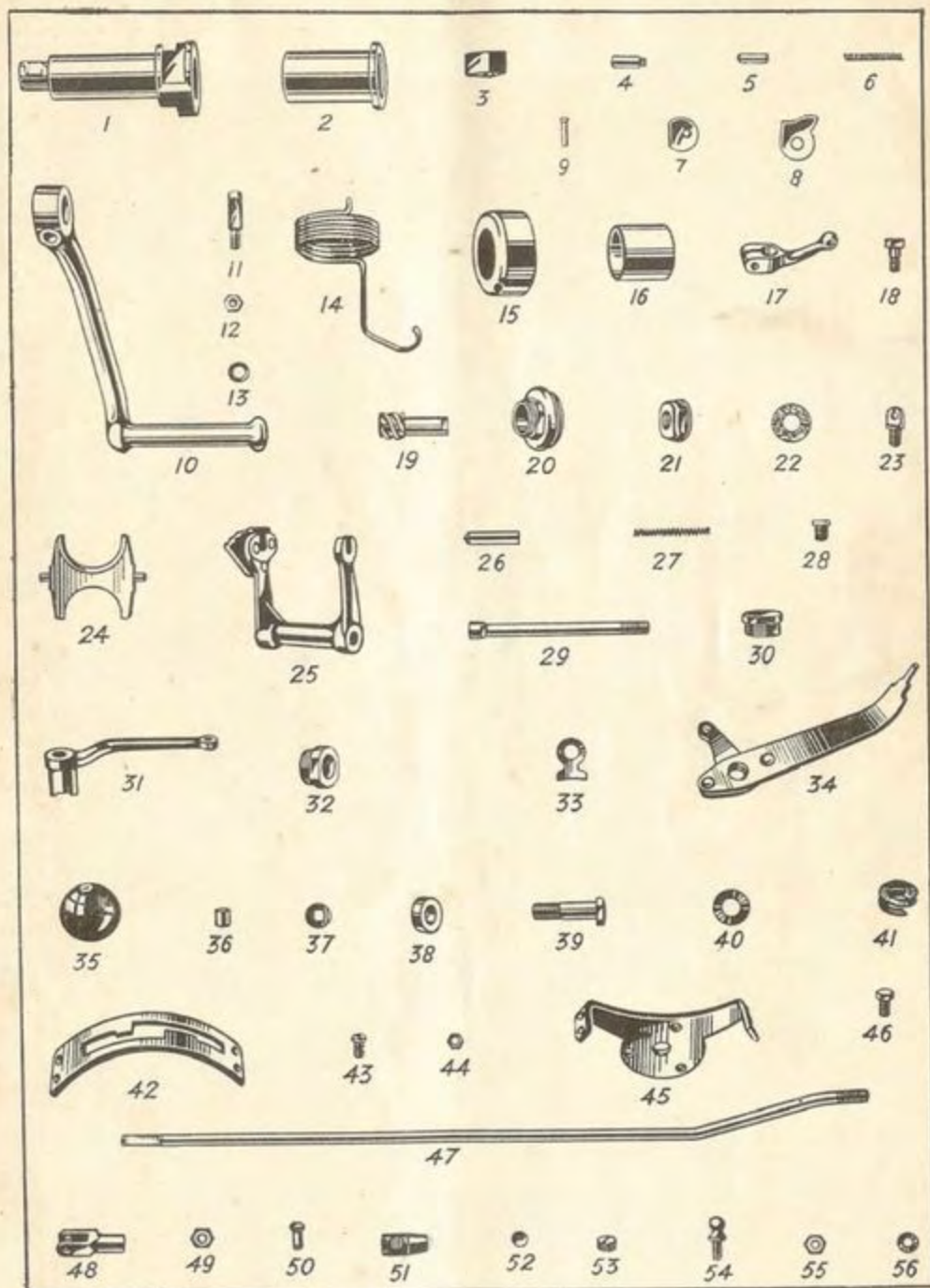

See opposite page for description and price.

HANDLEBAR AND CONTROLS.

Illustration No.	Quote this No. and name of part when ordering.	Description.	Price.		
			£	s.	d.
	923C	Handlebar complete with grips, levers and controls, except hand pump control (Model 501)	2	15	0
	924C	" " " " levers and controls, (Model 505)	2	15	0
	925C	" " " " levers and controls (Sidecar models)	2	15	0
1	223D	" only	0	10	0
2	222D	" (Sidecar models)	0	10	0
3	224D	" grips (Model 501), per pair	0	2	0
4	225D	" (Model 505),	0	3	0
5	226D	" inverted lever	0	3	4
6	227D	" pocket	0	0	9
7	228D	" " cap	0	0	6
8	229D	" " pivot screw	0	0	1
9	230D	" " " nut	0	0	2
10	231D	" " roller	0	0	2
11	232D	" " lock screw	0	0	1
12	926C	Clutch lever complete with cable and casing	0	12	0
13	234D	" " less cable and casing	0	7	6
	927C	" cable	0	0	9
	928C	" casing	0	2	6
14	237D	" nipple	0	0	1
15	238D	" return spring	0	0	3
16	241D	" ball nipple	0	0	2
17	239D	" adjusting screw	0	0	6
18	13D	" locknut	0	0	1
	929C	Carburettor control complete with cables and casings	0	12	0
19	243D	" complete less cables and casings	0	6	6
	930C	" cable	0	0	9
	931C	" casing	0	2	0
	932C	" nipple (control end)	0	0	1
	933C	" (carburettor end)	0	0	1
	934C	Magneto control complete with cables and casings	0	8	0
20	248D	" less cables and casings	0	5	0
	935C	" cable	0	0	6
	936C	" casing	0	2	0
	937C	" nipple (control end)	0	0	1
	938C	" (magneto end)	0	0	1
	939C	Exhaust lifter cable (side valve)	0	0	9
	940C	" (O.H.V.)	0	0	9
	941C	" casing (side valve)	0	2	6
	942C	" (O.H.V.)	0	2	0
	254D	" nipple (small)	0	0	1
	44D	" (large) (side valve)	0	0	2
	378E	" screwed nipple	0	0	1
	943C	Front brake cable	0	0	9
	944C	" casing	0	2	3
	254D	" nipple	0	0	1
21	257D	" connection	0	0	2
22	258D	" operating rod	0	0	3
	259D	" rubber tube	0	0	2
23	945C	Oil pump control lever complete with cable, casing, plunger and spring	0	12	6
	946C	" " " cable	0	0	9
	947C	" " " casing	0	1	9
24	41D	" " " adjusting screw	0	0	6
	13D	" (as illust. 18) locknut	0	0	1
25	266D	Ferrule for casings (large)	0	0	1
26	265D	" (small)	0	0	1
27	267D	Cable clip 1 1/4" dia. 1 wire	0	0	2
28	268D	" " " 2 "	0	0	2
29	269D	" " " 3 "	0	0	2

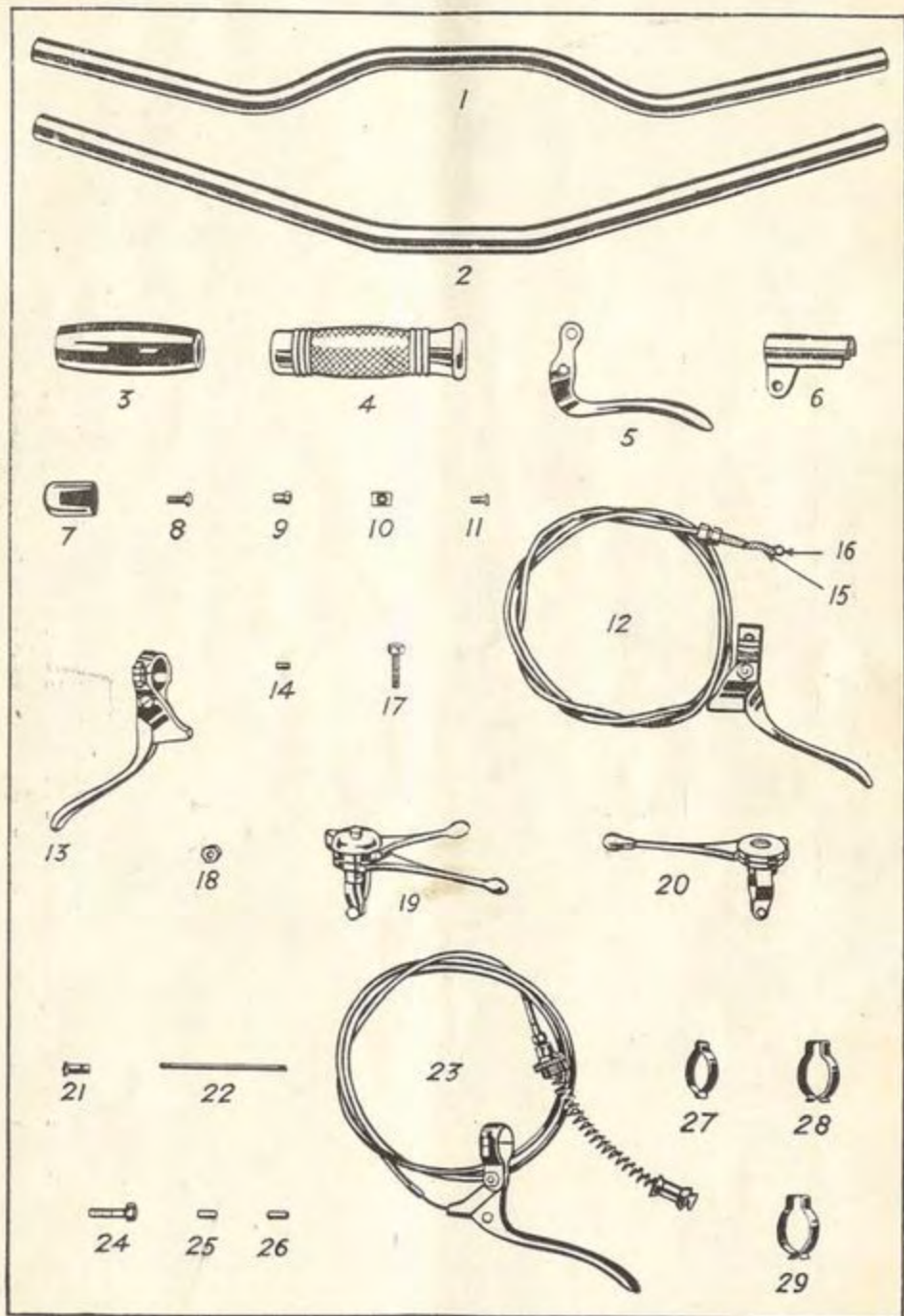

See opposite page for description and price.

PETROL AND OIL TANKS.

Illustration No.	Quote this No. and name of part when ordering.	Description.	Price.
			£ s. d.
1	948C	Petrol tank assembled complete (without oil box)	3 15 0
	949C	" " " " (with oil box)	4 10 0
	950C	" " only (without oil box)	3 5 0
	951C	" " " " (with oil box)	3 15 0
2	296D	" " filler cap (petrol)	0 3 6
3	297D	" " pin	0 0 2
4	298D	" " rubber pad	0 0 2
	952C	" " felt packing	0 0 6
5	302D	" " tap	0 2 6
6	104D	" " fibre washer	0 0 1
7	304D	" filter complete	0 3 6
8	305D	" " body	0 2 0
9	306D	" " cap	0 1 0
10	307D	" " gauze	0 0 6
11	309D	" " leather washer (large)	0 0 2
12	308D	" " " (small)	0 0 2
13	953C	" pipe complete (Model 501)	0 2 6
14	954C	" " (Model 505)	0 2 6
15	955C	Oil tank assembled complete (without hand pump)	1 10 0
	956C	" " " (with " ")	2 0 0
	957C	" " only (without hand pump)	1 0 0
	958C	" " " (with " ")	1 5 0
16	316D	" " filler cap	0 3 6
17	305G	" " rubber packing	0 0 3
18	303G	" " clip	0 0 6
19	319D	" " pin	0 0 3
20	320D	" pump plunger	0 1 0
21	321D	" " guide	0 0 9
22	322D	" " spring	0 0 6
23	323D	" " distance piece	0 0 6
24	324D	" " leather cup washer	0 0 2
25	325D	" " nut	0 0 2
26	200D	" " washer	0 0 1
27	327D	" " cup	0 0 2
		Knee grips 5/6 each	0 2 6
28	328D	Oil pump valve body	0 1 3
29	329D	" " leather washer	0 0 1
30	330D	" " steel	0 0 1
31	331D	" " disc	0 0 1
32	332D	" " tap	0 2 6
	104D	" " fibre washer (as illust. 6)	0 0 1
33	334D	" tap and filter gauze	0 3 0
	104D	" fibre washer (as illust. 6)	0 0 1
34	959C	Oil pipe complete (oil tank to mechanical pump) Separate oil tank with hand pump.	0 2 6
35	960C	Oil pipe complete (hand pump to engine) Separate oil tank with hand pump.	0 2 6
	961C	Oil pipe complete (oil tank to mechanical pump) Separate oil tank without hand pump.	0 2 6
	962C	Oil pipe complete (mechanical pump to engine) Separate oil tank without hand pump.	0 1 6
	963C	Oil pipe complete (oil tank to mechanical pump) Combined petrol and oil tank.	0 2 6
	964C	Oil pipe complete (mechanical pump to engine) Combined petrol and oil tank.	0 1 8

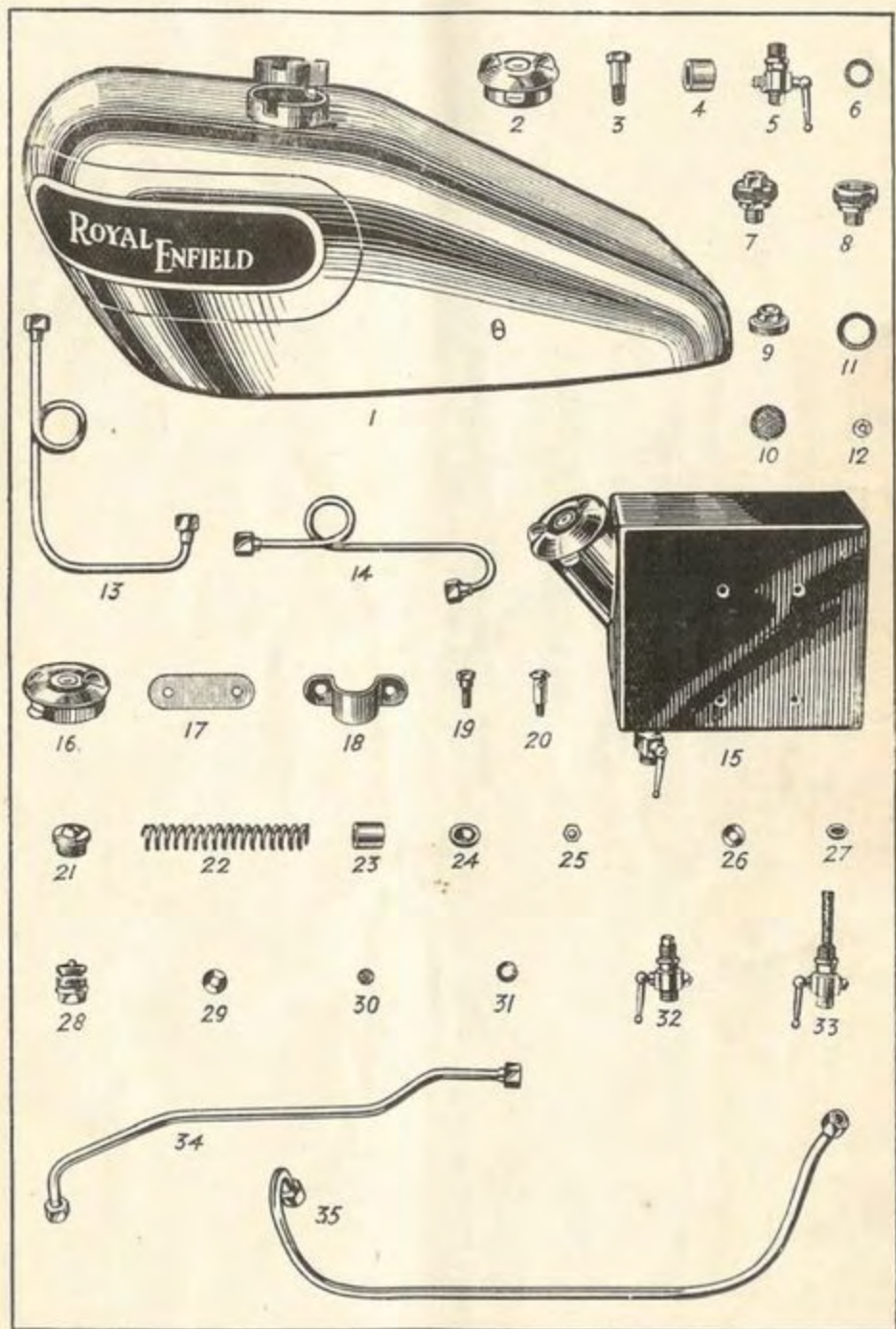

See opposite page for description and price.

FRONT FORK AND FRONT MUDGUARD.

Illustration No.	Quote this No. and name of part when ordering.	Description.	Price.		
			£	s.	d.
1	965C	Front fork (Model 501)	2	10	0
	966C	" " (" 505)	3	0	0
2	967C	" " spring with pins (Model 501)	0	3	0
	968C	" " " " (" 505)	0	3	0
3	349D	" " " nut	0	0	2
4	350D	" " " washer	0	0	1
5	970C	" " crown link (R.H. thread)	0	2	6
6	971C	" " " (L.H. ")	0	2	6
7	972C	" " top " (R.H. ")	0	2	0
8	973C	" " " (L.H. ")	0	2	0
9	974C	" " swivel pin (top)	0	1	0
10	975C	" " " (bottom)	0	1	0
11	365D	" " shock absorber friction disc	0	0	3
12	367D	" " " spring	0	0	9
13	366D	" " " washer	0	0	6
14	976C	" " crown link (R.H. thread)	0	2	0
15	977C	" " " (L.H. ")	0	2	0
	978C	" " top " (R.H. thread)	0	2	0
	979C	" " " (L.H. ")	0	2	0
16	980C	" " swivel pin (top)	0	1	0
17	981C	" " " (bottom)	0	1	6
	982C	" " " (crown)	0	1	6
18	983C	" " nut R.H. (thin)	0	0	2
19	984C	" " " L.H. (thin)	0	0	2
20	985C	" " shock absorber friction disc	0	0	6
21	986C	" " " spring	0	1	0
22	987C	" " " anchor plate	0	1	0
23	988C	" " " nut (R.H.)	0	1	0
24	989C	" " " nut (L.H.)	0	1	0
	990C	" " " fixed disc	0	1	0
25	991C	" " " screw	0	0	1
26	170D	" " swivel pin nut (R.H.)	0	0	3
27	992C	" " " (L.H. ")	0	0	3
28	993C	" " steering stem (Model 501)	0	10	6
	994C	" " " (" 505)	0	10	6
29	370D	" " ball race	0	1	0
30	995C	" " ball head clip (top)	0	10	0
31	373D	" " " (bottom)	0	1	9
32	374D	" " " bolt	0	0	6
33	190D	" " " nut	0	0	2
34	376D	" " " washer	0	0	1
35	377D	" " " ball race	0	1	0
	378D	" " " $\frac{1}{8}$ " dia. ball,	per doz.	0	2
36	379D	" " " locknut	0	1	0
37	123D	" " and ball head grease nipple	0	0	3
38	383D	" " handlebar pin	0	0	3
39	384D	" " " washer	0	0	1
	996C	Front mudguard complete with stays	0	12	6
40	997C	" " " pin	0	0	2
41	631D	" " " spring washer	0	0	1
42	391D	" " " stay pin	0	0	2
43	392D	" " " washer	0	0	1
44	393D	" " stand clip complete	0	2	3
45	394D	" " " pin	0	0	2
46	395D	" " " nut	0	0	1
47	200D	" " " washer	0	0	1
48	397D	" " number plate complete with licence holder	0	2	6
	298D	" " " only (Solo models)	0	1	3
	399D	" " " (Sidecar ")	0	1	0
49	400D	" " " clip	0	0	6
50	212D	" " " washer	0	0	1
51	402D	" " " screw	0	0	2
52	403D	" " licence holder flange	0	0	6
	404D	" " " glass	0	0	1
	405D	" " " back	0	0	2
53	406D	" " " rubber washer	0	0	1
	381D	" " " screw,	per doz.	0	6
	408D	" " " nut	0	0	1

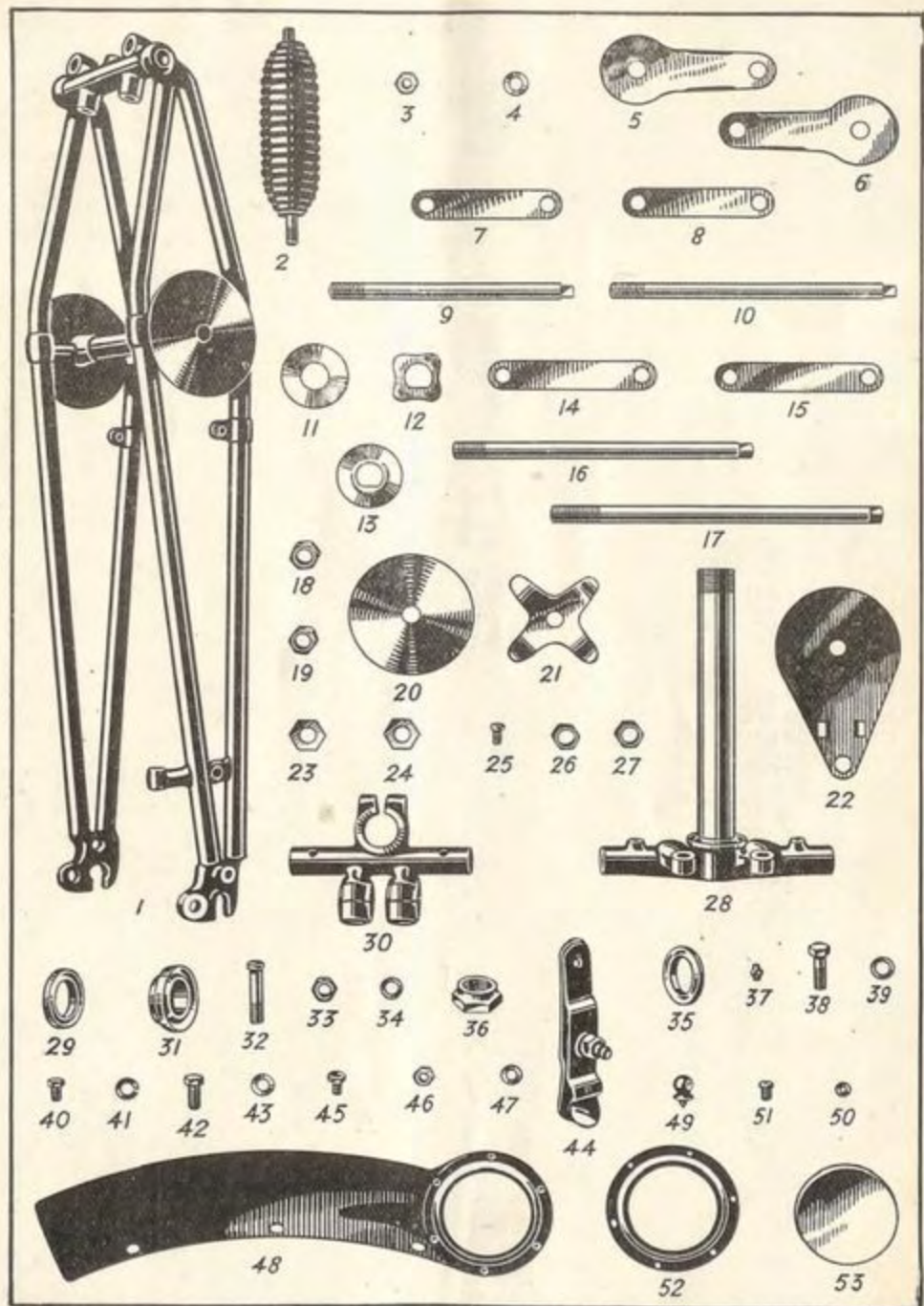

See opposite page for description and price.

FRONT WHEEL, FRONT BRAKE AND
FRONT STAND.

Illustration No.	Quote this No. and name of part when ordering.	Description.	Price.		
			£	s.	d.
	998C	Front wheel complete with brake, less tyre..	3	10	0
1	999C	" " only	2	0	0
2	1000C	" " rim	0	10	0
3	1001C	" " spokes $8\frac{15}{16}$ " long (set of 20)	0	1	0
4	1002C	" " " $7\frac{3}{4}$ " " (set of 20)	0	1	0
5	1003C	" " " nipples (set of 40)	0	2	6
6	1004C	" hub with grease nipples	0	15	0
7	1005C	" " brake drum	0	10	0
8	123D	" " grease nipple	0	0	3
9	469 6 C	" " spindle	0	2	6
10	431D	" " " nut	0	0	9
11	172D	" " " washer	0	0	1
12	438D	" " journal bearing	0	5	0
13	439D	" " " " distance washer..	0	0	3
14	440D	" " " " retaining nut	0	0	6
15	441D	" " oil retainer	0	0	2
16	442D	" " dust excluder	0	0	6
17	477C	" brake shoe with lining and pad (per pair)	0	10	0
18	444D	" " " pad	0	0	6
19	479C	" " " lining, each	0	1	0
	446C	" " " rivet, per doz.	0	0	6
20	481C	" " " spring	0	0	6
21	1006C	" " cover plate complete (without brake shoes)	0	6	0
22	451D	" " cover plate distance piece	0	0	3
23	452D	" " anchor pin	0	0	3
24	453D	" " " " nut	0	0	2
25	200D	" " " " washer	0	0	1
26	1007C	" " operating cam and lever	0	2	6
27	123D	" " " " " grease nipple	0	0	3
28	458D	" " " rod draw bolt	0	0	3
29	459D	" " " " " sleeve	0	0	3
30	460D	" " " " " nut	0	0	2
31	20D	" " " " " washer...	0	0	1
	430C	" stand complete	0	10	6
	463D	" " bush	0	0	3
	464D	" " pin	0	0	4
	465D	" " " nut	0	0	4
	392D	" " " washer	0	0	1

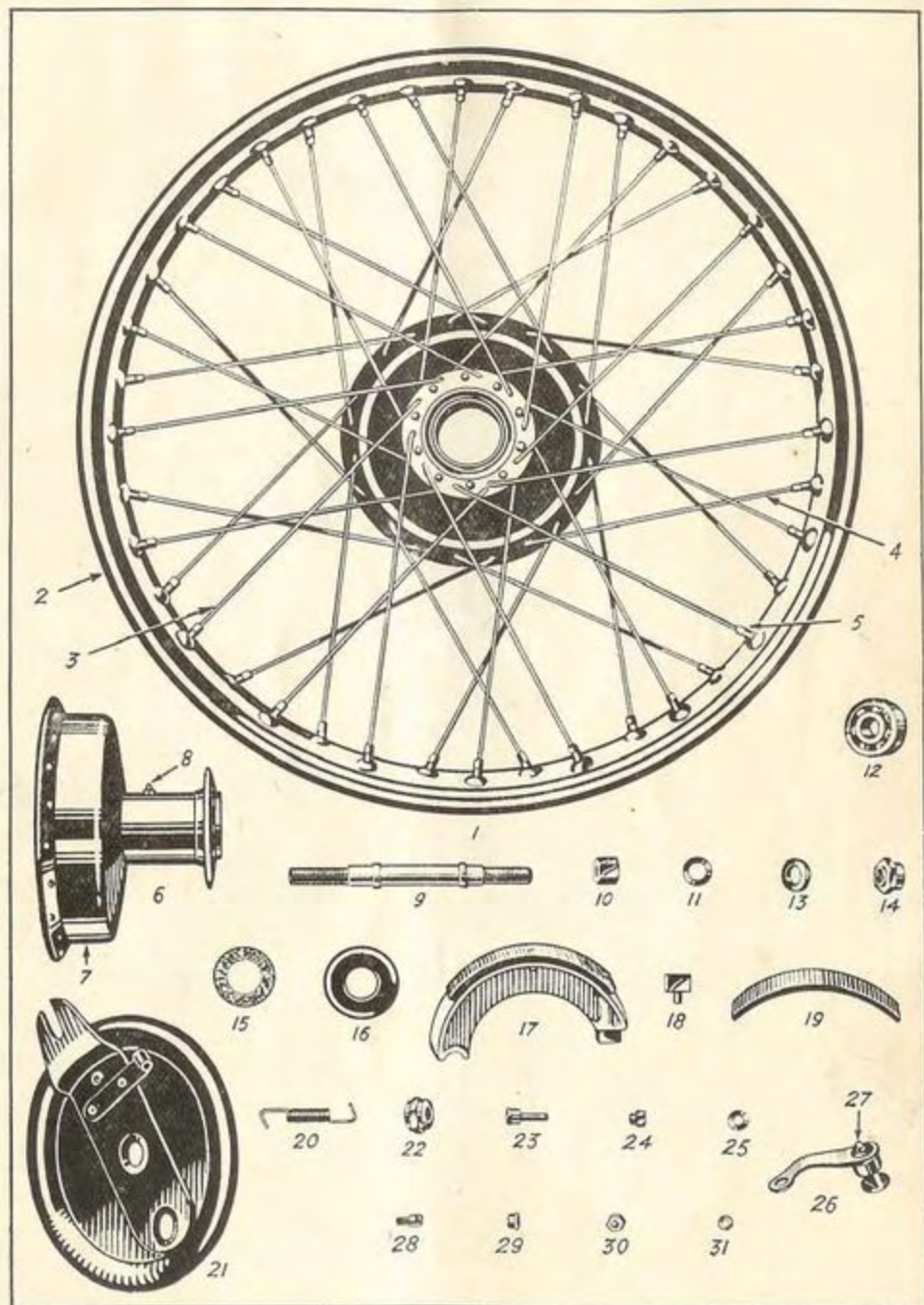

See opposite page for description and price.

REAR WHEEL AND REAR BRAKE.

Illustration No.	Quote this No. and name of part when ordering.	Description.	Price.
	1008C	Rear wheel complete with cush drive and brake, less tyre.	£ 5 0 0
	1009C	" " only	2 10 0
	1010C	" " rim	0 10 0
	1011C	" " spokes 8" long (set of 40)	0 2 0
	1003C	" " nipples (set of 40)	0 2 6
1	1013C	hub with grease nipple	1 0 0
2	1005C	" " brake drum	0 10 0
3	123D	" " grease nipple	0 0 3
4	509C	" " spindle	0 5 0
5	1014C	" " nut	0 0 9
6	1015C	" " sleeve	0 0 6
7	438D	" " journal bearing	0 5 0
8	1016C	" " distance washer	0 0 3
9	514C	" " retaining nut	0 0 6
10	497D	" " dust excluder	0 0 9
11	441D	" " oil retainer (thin)	0 0 2
	1017C	" " (thick)	0 0 2
12	594E	" " driving sprocket	0 18 0
13	595E	" " lockring	0 2 0
14	596E	" " pin	0 0 4
15	821D	" " nut	0 0 2
16	631D	" " spring washer	0 0 1
17	599E	" " cush rubber (set of 6)	0 6 0
18	477C	" " brake shoes with linings and pad, per pair	0 10 0
19	444D	" " pad	0 0 6
20	479C	" " lining, each	0 1 0
	446D	" " rivet, per doz.	0 0 6
21	481C	" " spring	0 0 6
22	1018C	" " cover plate complete (without brake shoes)	0 6 0
23	529C	" " distance piece	0 0 6
24	530C	" " anchor pin	0 0 3
25	514D	" " nut	0 0 2
26	191D	" " washer	0 0 1
27	1019C	" " operating cam and lever complete with trunion	0 3 0
28	123D	" " grease nipple	0 0 3
29	1020C	" " rod	0 1 0
30	392D	" " washer	0 0 1
	525D	" " split pin	0 0 1
31	615E	" " adjusting nut	0 1 0
32	1021C	" " foot pedal	0 5 0
33	474E	" " grease nipple	0 0 6
34	1022C	" " stud	0 0 6
35	171D	" " nut	0 0 3
36	1023C	" " washer	0 0 2
37	1024C	" " distance piece	0 0 6
38	1025C	" " locking collar	0 0 6
39	459E	" " washer	0 0 2
40	546C	" " adjusting pin	0 0 3
41	460D	" " locknut	0 0 1
42	1026C	" " stop pin	0 0 2

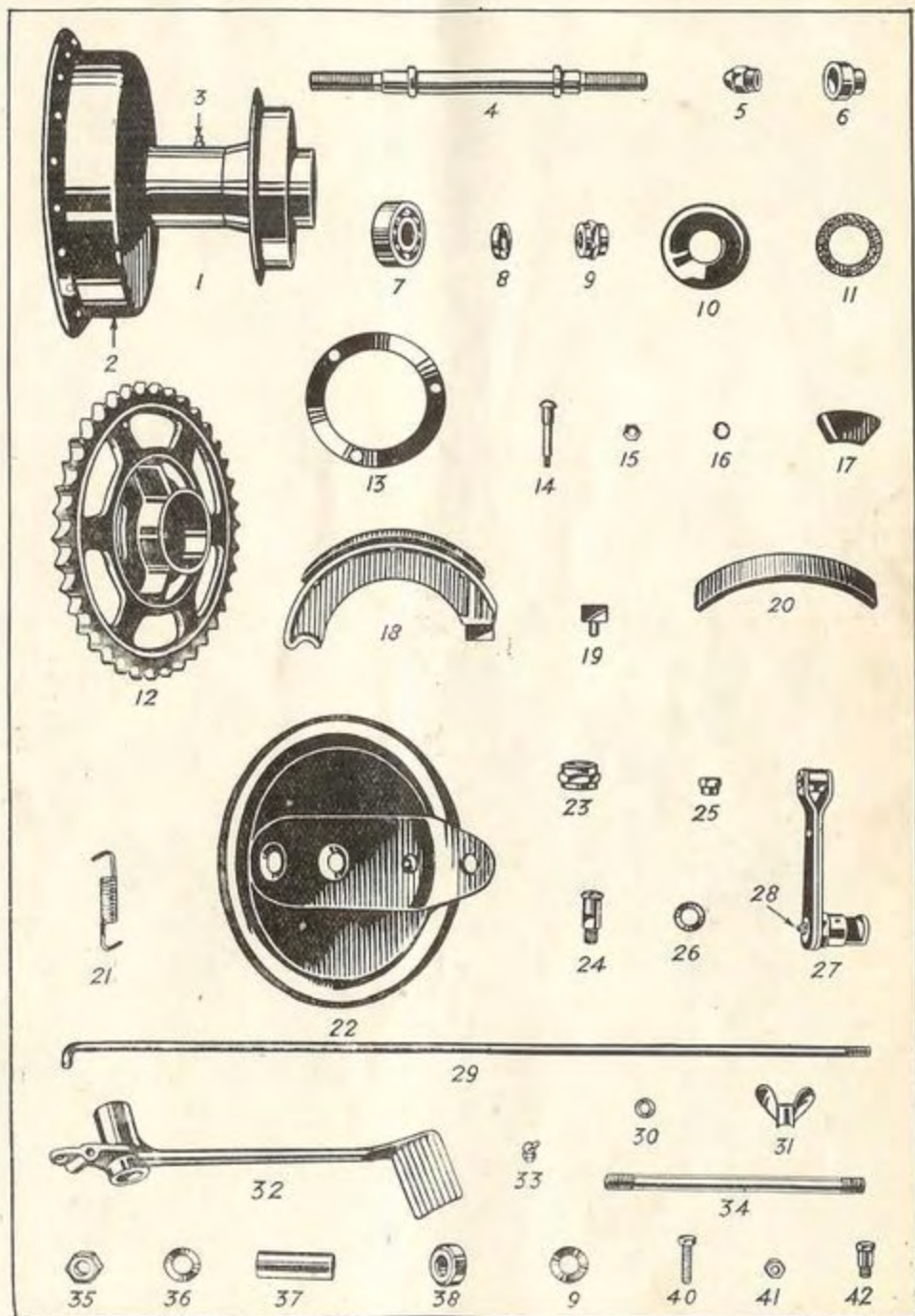

See opposite page for description and price.

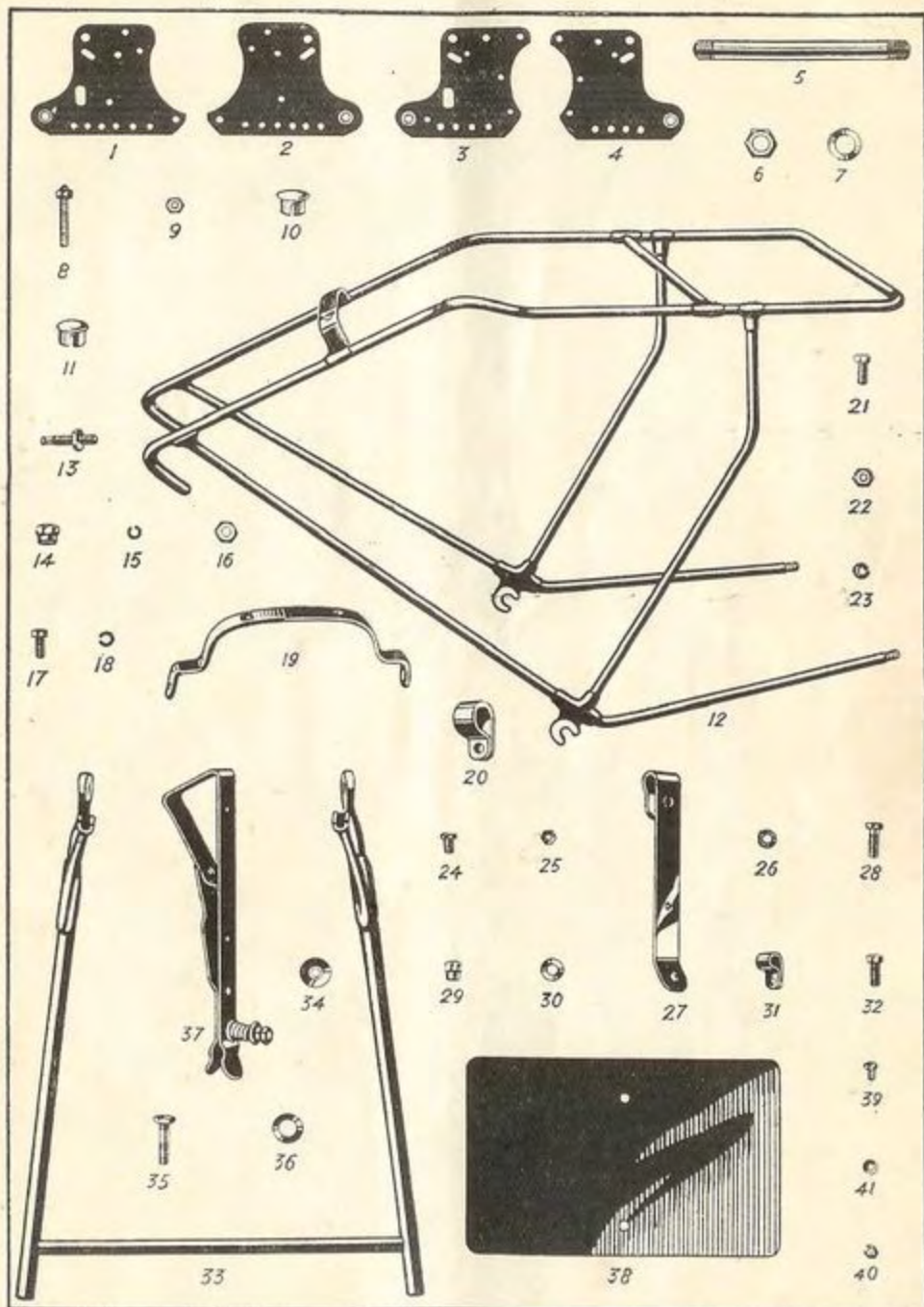

See opposite page for description and price.

CHAIN COVERS, CHAINS, Etc.

Illustration No.	Quote this No. and name of part when ordering.	Description.	Price.
1	1053C	Front chain cover	£ 1 s. 5 d.
2	1054C	inspection cap	0 0 3
3	1055C	" " " " spring	0 0 3
	389D	" " " " pin	0 0 2
4	1056C	front clip	0 1 6
5	580D	" " " " pin	0 0 2
6	13D	" " " " nut	0 0 1
7	1057C	attachment pin	0 0 1
8	710D	" " " " nut	0 0 1
9	1058C	attachment stud (long)	0 0 3
10	1059C	" " " " (short)	0 0 3
11	190D	" " " " nut (thick)	0 0 2
12	713D	" " " " (thin)	0 0 2
13	191D	" " " " washer	0 0 1
14	1060C	distance tube $1\frac{1}{4}'' \times \frac{11}{16}''$	0 0 6
15	1061C	" " " " $2\frac{1}{2}'' \times \frac{11}{16}''$	0 0 6
16	1062C	Driving chain cover	0 5 0
17	46G	" " " " pin	0 0 1
18	1063C	Gear chain cover	2 0 0
19	1065C	" " " " pin	0 0 1
20	1066C	" " " " bolt	0 0 2
	13D	" " " " nut (as illust. 6)	0 0 1
21	200D	" " " " washer	0 0 1
22	1067C	" " " " oil plug	0 0 6
23	1068C	" " " " washer	0 0 1
24	1054C	inspection cap (as illust. 2)	0 0 3
	45G	" " " " spring	0 0 3
	46G	" " " " pin	0 0 1
25	1069C	front attachment pin	0 0 3
26	350D	" " " " washer	0 0 1
27	1070C	attachment stud	0 0 4
	190D	" " " " nut (as illust. 11)	0 0 2
	191D	" " " " washer (as illust. 13)	0 0 1
28	1071C	Front chain cover distance tube $1\frac{1}{4}'' \times \frac{3}{8}''$	0 0 2
29	1072C	" " " " $2\frac{1}{2}'' \times \frac{3}{8}''$	0 0 3
	1073C	Driving chain cover	0 5 0
	1074C	" " " " pin	0 0 1
	200D	" " " " washer (as illust. 21)	0 0 1
30	618C	" " " " clip	0 0 6
31	391D	" " " " pin	0 0 2
	1075C	Front chain	0 11 3
	1076C	Rear	0 16 7
	692E	Cranked link unit for chains	0 1 0
	1077C	Magneto chain (Standard and Lucas lighting sets)	0 1 2
	1078C	" " (M-I, lighting set)	0 4 6
32	1079C	Platform (Standard)	0 2 6
	1080C	" " (Lucas lighting set)	0 4 6
	1081C	" " (M-I, lighting set)	0 2 6
33	1082C	distance tube $1\frac{3}{8}'' \times \frac{1}{2}''$	0 0 3
34	1083C	" " " " $1\frac{1}{8}'' \times \frac{1}{2}''$	0 0 3
35	1084C	" " " " $2\frac{1}{2}'' \times \frac{1}{2}''$	0 0 3
36	1085C	stud	0 0 3
37	349D	" " " " nut	0 0 2
	350D	" " " " washer (as illust. 26)	0 0 1
38	633C	fixing screw	0 0 2
	1052C	M-I, Maglita fixing screw	0 0 2
	526B	Lucas Magdyno fixing screw	0 0 2
39	502D	Magneto fixing screw spring washer	0 0 1
40	1086C	sprocket (Standard)	0 3 0
	1087C	" " (Lucas lighting set)	0 3 6
41	1088C	" " (M-I, " ")	0 3 0
42	1089C	" " " " nut	0 0 6
43	1090C	Engine sprocket 18 teeth (Solo machines)	0 7 6
	1091C	" " " " 16 " (Sidecar " ")	0 7 6
44	701E	" " " " nut	0 0 6
	657D	" " " " key	0 0 3
	1092C	Sparking plug with waterproof cap	0 5 0

Model
501

Models
502
and
505.

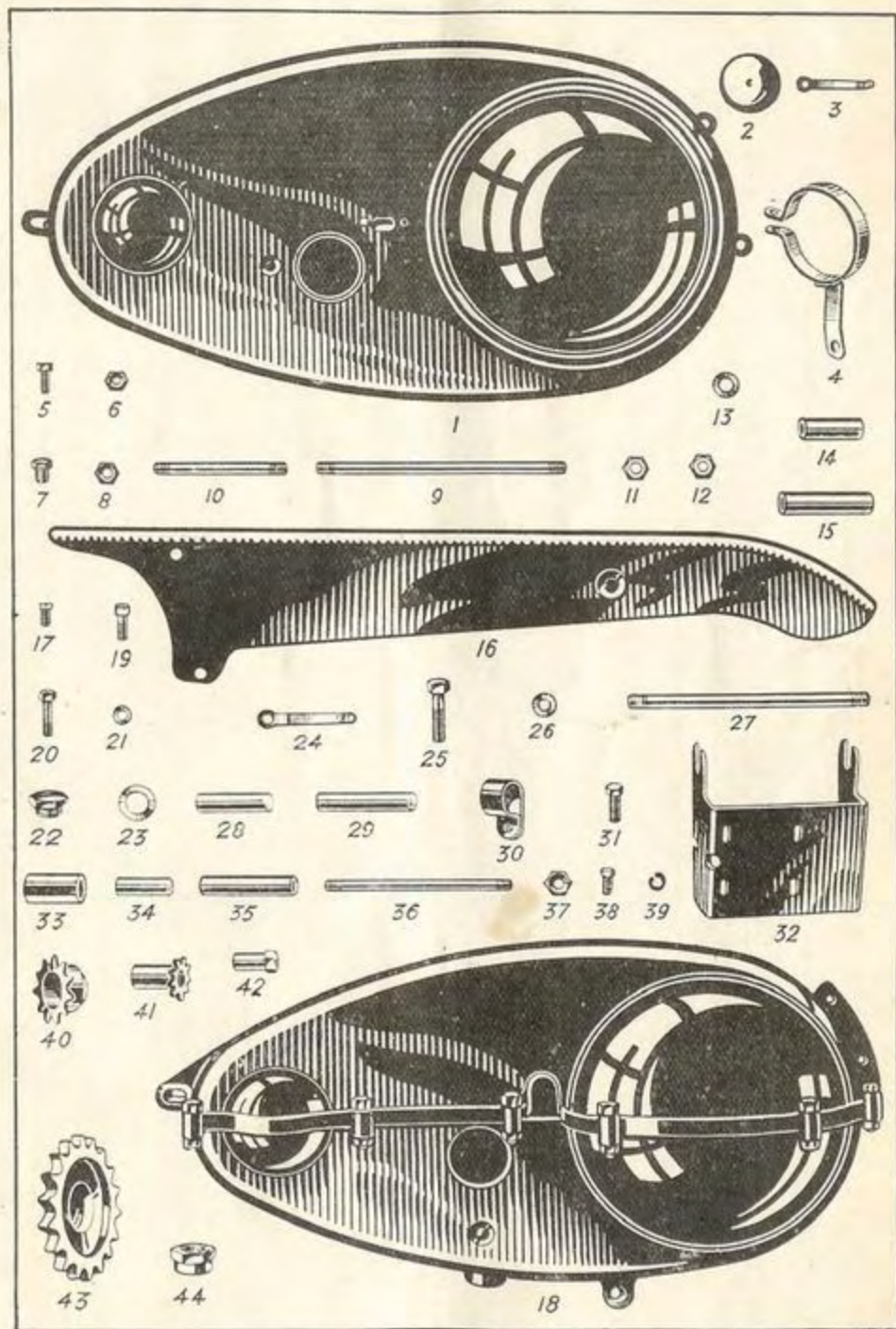

See opposite page for description and price.

SADDLE, TOOLS, ENGINE ATTACHMENTS AND STEERING DAMPER.

Illustration No.	Quote this No. and name of part when ordering.	Description.	Price.
			£ s. d.
	1093D	Saddle complete	1 10 0
1	714D	Toolbag complete with clips, less tools and roll (carrier models)	0 7 6
	715D	" complete with clips, less tools and roll (models without carriers)	0 7 6
2	716D	" clip	0 0 4
3	204D	" " pin	0 0 2
4	182D	" " " nut	0 0 1
5	212D	" " " washer	0 0 1
6	720D	Toolroll and strap without tools	0 2 6
7	721D	Pliers	0 2 0
8	722D	Tyre lever	0 0 6
9	723D	File	0 1 6
10	724D	Screw driver	0 0 7
11	735D	Grease gun	0 6 0
12	725D	Combination spanner	0 1 9
13	727D	Box spanner	0 2 4
14	675C	Valve cap-spanner	0 2 0
15	735D	Magneto spanner	0 0 4
16	729D	Cone spanner	0 1 0
17	730D	" locking spanner	0 1 0
18	732D	Adjustable spanner	0 4 0
19	726D	Double ended spanner (.437" & .601" Hex.)	0 1 0
20	731D	" " (.525" & .820" Hex.)	0 1 0
21	737D	Inflator	0 3 6
22	1094C	" clips, per pair	0 0 9
23	667D	Crankcase stud (long)	0 0 6
24	665D	" (short)	0 0 6
25	190D	" " nut	0 0 2
26	191D	" " washer	0 0 1
27	1095C	Front engine-plate (Model 501)	0 1 0
28	1096C	" " (Model 505)	0 1 0
29	671D	" " stud (large)	0 0 6
30	171D	" " " nut	0 0 3
31	194D	" " " washer	0 0 1
32	1097C	" " " (small)	0 0 2
33	349D	" " " nut	0 0 2
34	1098C	" " " washer	0 0 1
	272D	Steering damper complete	0 15 0
35	273D	" " adjusting knob	0 3 0
36	274D	" " cover	0 0 6
37	275D	" " spring washer	0 0 6
38	276D	" " friction	0 1 6
39	277D	" " disc	0 1 0
40	279D	" " anchor plate	0 2 3
41	280D	" " " pin	0 0 3
42	191D	" " " washer	0 0 1
43	282D	" " sleeve	0 2 0
44	284D	" " bush	0 0 3
45	284D	" " cone	0 0 6
46	285D	" " spindle	0 1 0

SIDECAR CHASSIS AND WHEEL.

Illustration No.	Quote this No. and name of part when ordering.	Description.	Price.		
			£	s.	d.
	690C	Chassis only	7	0	0
1	691C	front attachment stud	0	2	6
2	692C	rear " "	0	2	6
3	693C	attachment stud nut	0	0	10
4	694C	" " washer	0	0	3
5	695C	tie rod (front)	0	6	0
6	1099C	" (rear)	0	7	6
7	779D	" " clip (front)	0	3	0
8	780D	" " " (rear)	0	3	0
9	781D	" " " pin	0	0	4
10	190D	" " " nut	0	0	2
11	191D	" " " washer	0	0	1
12	763D	" " " bolt $\frac{7}{16}$ "	0	0	6
13	751D	" " " nut	0	0	6
14	758D	" " " washer	0	0	1
15	767D	" " " $\frac{3}{8}$ "	0	0	4
16	768D	" " " nut	0	0	3
	191D	" " " washer (as illust. 11)	0	0	1
	759D	" " " split pin	0	0	1
17	709C	" " " eye bolt (front)	0	2	0
	190D	" " " nut (as illust. 10)	0	0	2
	191D	" " " washer (as illust. 11)	0	0	1
18	774D	" " " (rear)	0	2	6
19	122D	" " " nut	0	0	3
20	566D	" " " washer	0	0	1
	1100C	Sidecar wheel complete with hub, less tyre...	2	5	0
	1101C	" only	1	15	0
	1102C	" rim	10	0	
	718C	" spokes 9" long, set of 40	0	2	6
	422D	" " nipples " " "	0	1	6
21	789D	" hub with ball race and grease nipple	0	10	0
22	433D	" ball race	0	1	6
23	123D	" grease nipple	0	0	6
24	792D	" spindle	0	6	0
25	793D	" adjusting cone	0	1	3
26	490D	" " lock nut...	0	0	4
	437D	" $\frac{3}{8}$ " dia. balls, per doz.	0	1	3
27	798D	" dust excluder, large hole.	0	0	6
28	797D	" " small "	0	0	6
29	441D	" oil retaining washer	0	0	3
30	801D	" spindle nut, $\frac{3}{4}$ "	0	1	0
31	802D	" washer	0	0	3
	803D	" split pin	0	0	1
32	800D	" nut, $\frac{1}{2}$ "	0	0	9
33	795D	" lock washer...	0	0	3

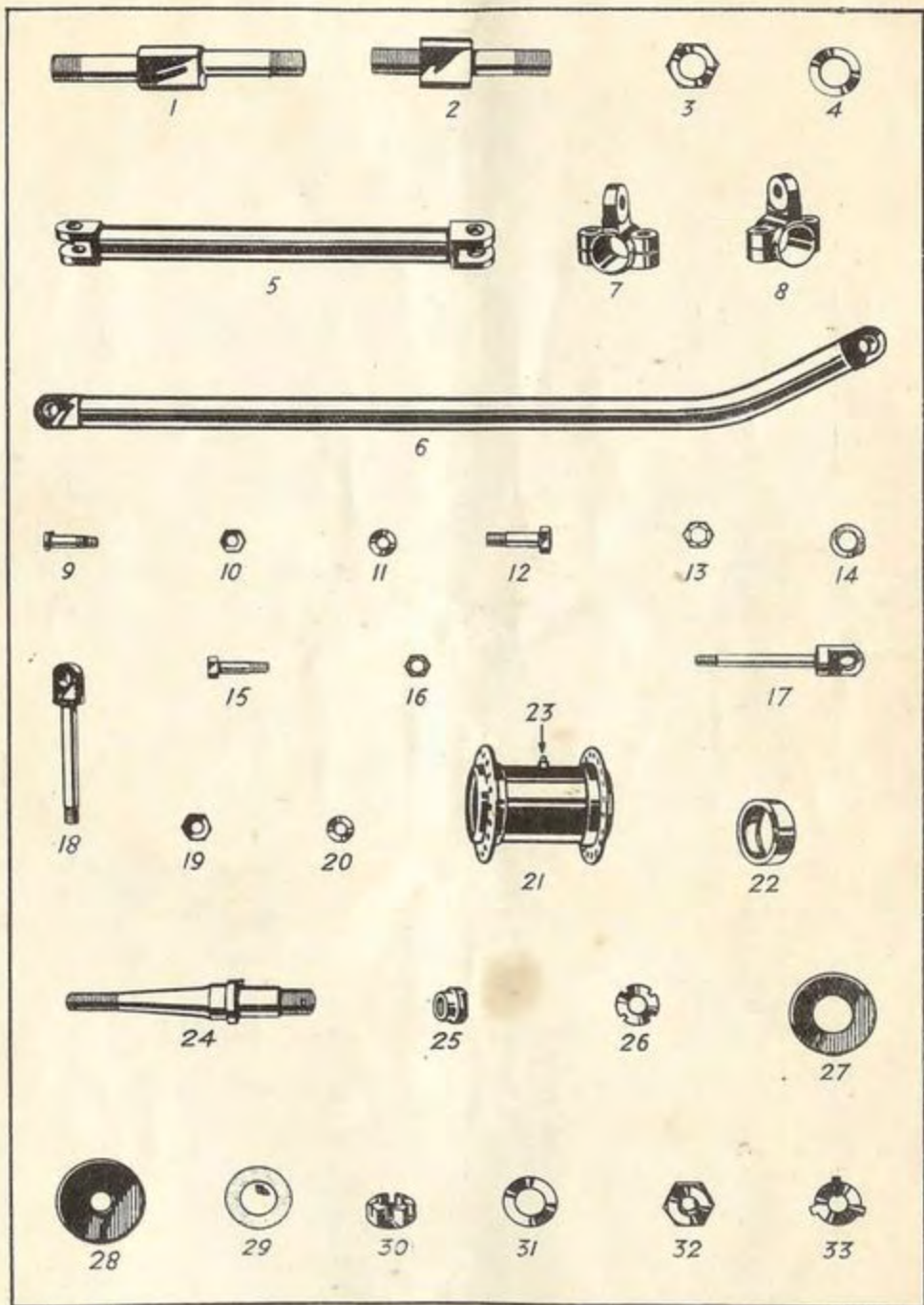

See opposite page for description and price.

SIDECAR BODIES, MUDGUARDS AND SUSPENSION.

Illustration No.	Quote this No. and name of part when ordering.	Description.	Price.
			£ s. d.
	1103C	Sidecar Body	9 0 0
	741C	" Apron } Tourist	0 10 0
	742C	" Cushion }	0 12 0
	743C	" Screen and fittings }	1 10 0
	1104C	" Body	9 0 0
	745C	" Apron } Sports	0 10 0
	746C	" Screen and fittings }	1 10 0
	1105C	delivery box	9 0 0
	748C	body rear spring	0 12 6
1	818D	" clip	0 0 9
2	819D	" " cap	0 0 9
3	821D	" " nut	0 0 2
4	631D	" " $\frac{1}{2}$ " spring washer	0 0 1
5	820D	" " packing piece	0 0 9
6	754C	support strut (rear)	0 4 0
7	190D	" nut	0 0 2
8	756C	bar (rear)	0 2 0
9	757C	" (front)	0 2 0
10	759C	bolt front and rear	0 0 6
11	821D	" nut (as illust. 4)	0 0 2
12	827D	" washer	0 0 1
	631D	" spring washer (as illust. 5)	0 0 1
13	763C	strut (front)	0 2 0
14	764C	front spring	0 5 0
15	765C	pin $\frac{1}{2}$ "	0 0 3
	190D	" nut (as illust. 8)	0 0 2
16	767C	" washer	0 0 2
17	768C	" $\frac{1}{16}$ "	0 0 3
18	831D	" washer	0 0 2
19	770C	attachment bolt (front)	0 0 6
20	771C	" (rear)	0 0 6
	190D	" nut (as illust. 8)	0 0 2
21	556D	" $\frac{1}{2}$ " spring washer	0 0 1
	774C	mudguard (Tourist)	0 15 0
22	775C	stay (rear)	0 1 0
23	776C	" (middle)	0 1 0
24	777C	" (front)	0 1 0
25	778C	distance tube (middle)	0 1 0
26	779C	" (front)	0 1 0
27	780C	" (rear)	0 1 0
28	836D	" flange (deep)	0 0 3
29	845D	" (shallow)	0 0 3
30	847D	stay nut (thin)	0 0 2
31	122D	" (thick)	0 0 3
32	841D	" washer	0 0 1
	833D	(Sports) washer	0 15 0
	787C	stay (front)	0 1 0
	788C	" (rear)	0 1 0
	789C	distance tube (front)	0 1 0
	790C	" (rear)	0 1 0
	836D	" flange (deep)	0 0 3
	845D	" (shallow)	0 0 3
	847D	stay nut (thin)	0 0 2
	122D	" (thick)	0 0 3
	841D	" washer	0 0 1

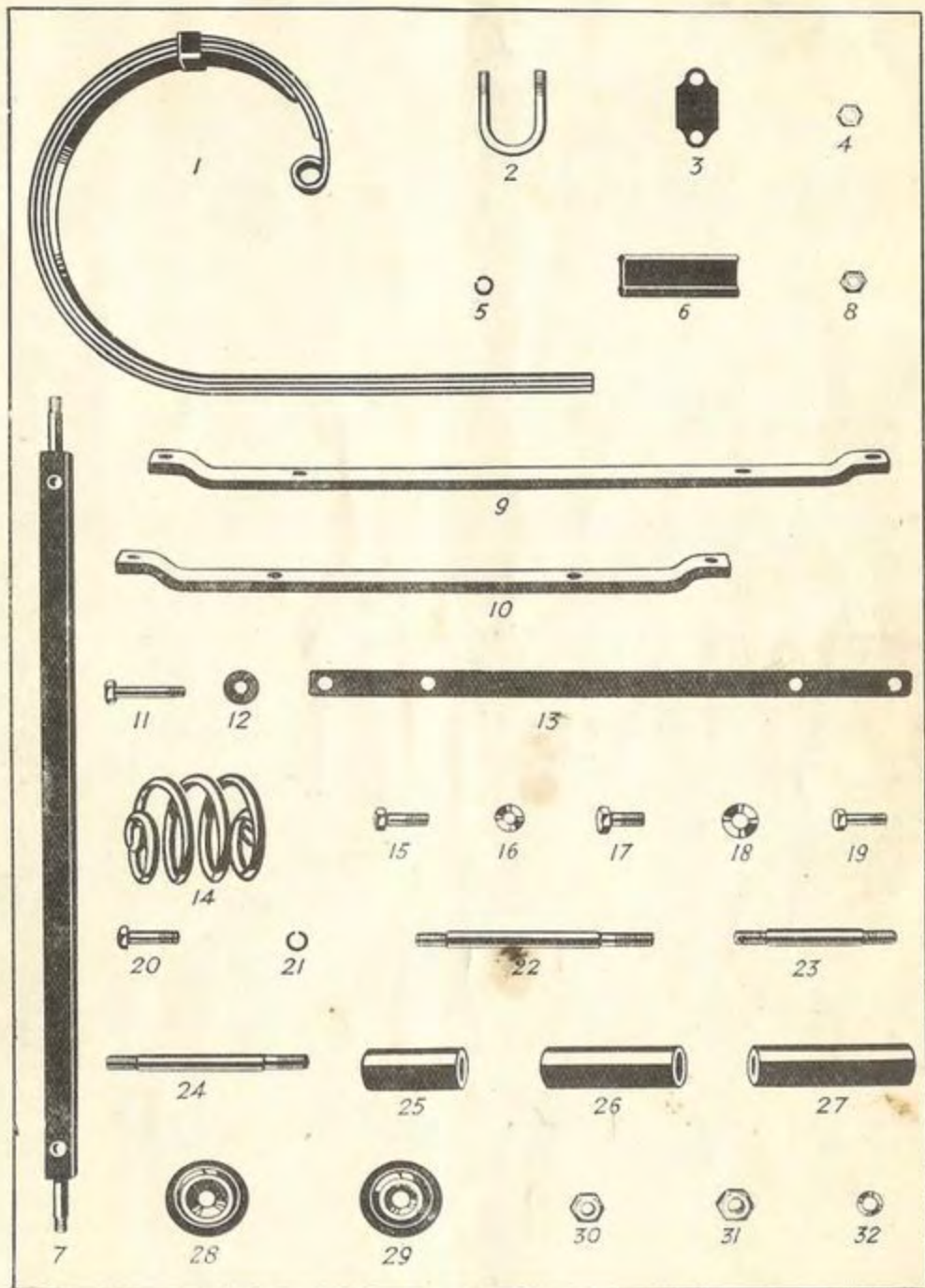

See opposite page for description and price.