

# LIST of SPARE PARTS

FOR THE

**ROYAL ENFIELD**

The logo for Royal Enfield, featuring the brand name in a stylized, outlined font. Behind the text is a circular gear with a sword or dagger positioned diagonally across it.

**9.76 h.p. MOTOR CYCLE**  
with Four-speed Gear.

*Issued December 1st, 1927.*

Barnstormers Co. Nz





A LIST of  
Spare and Replacement Parts for the

**ROYAL ENFIELD**



9.76 h.p. MOTOR CYCLE  
with Four-speed Gear.

---

Compiled and Published by

**THE ENFIELD CYCLE CO., LTD.**  
**REDDITCH.**

*Telegrams: "Cycles, Phone, Redditch."  
Telephone No. Redditch 121 (5 lines).*

**LONDON SHOWROOMS:**

**48, HOLBORN VIADUCT, E.C.1.**

*Telegrams: "Jigger, Cent. London."  
Telephone Nos. 5822 and 5823 Holborn.*

**LONDON SERVICE DEPOT:**

**5, 7, 9, HATTON WALL, Hatton Garden, E.C.1.**

*Telephone No. 2508 Holborn.*

**BIRMINGHAM SHOWROOMS:**

**274a, BROAD STREET.**

*Telephone No. 3532 Midland.*

---

*Contractors to H.M. Government, the French and Belgian  
Governments, and the former Russian Imperial  
Military Authorities.*

## THE 9.76 H.P. ROYAL ENFIELD MOTOR CYCLE

---

All prices of Spare and Replacement Parts are subject to revision or modification, at our discretion, without notice.

Our terms are STRICTLY NET CASH WITH ORDER, or cash on receipt of PRO-FORMA INVOICE. Repairs and sundries items cannot be booked. Prices do not include cost of carriage or postage.

Any part or complete motor cycle sent for repair should be consigned CARRIAGE PAID and the sender's name and address should be given in full on the address tally. Parts sent to us carriage forward are liable to be refused, and to lie with the carriers at sender's risk and expense.

Full instructions regarding the necessary repairs to be done, with advice as to the mode of despatch of the machine (or part), should be posted the same day.

When forwarding motor cycles for repair it is advisable to remove all accessories and easily detached fittings, such as lamp, horn, toolbags, etc. Besides facilitating the work of repair, it will also prevent any loss during transit.

Order all parts by the name of the article and the NUMBER PRECEDING IT, also state the number of the engine or machine for which they are intended. The engine number will be found stamped on the crank case and the machine number on the lug through which the front side-car coupling bolt passes.

### GUARANTEE.

We respectfully refer customers to the terms of our guarantee, which appears on page 40 of this list.



When forwarding a complete Motor Cycle, Engine, Carburetter or Magneto with the request that we overhaul the same, we understand by the term "Overhaul" that it is to be entirely dismantled, thoroughly renovated, any worn parts renewed, and put in perfect working order. In case a customer desires only certain parts attended to, full instructions should be given us to that effect, otherwise the cost may be in excess of that anticipated.

### ESTIMATES AND QUOTATIONS.

When customers send complete Motor Cycles or parts thereof to us for repairs, we are always prepared to furnish estimates before proceeding with the necessary work. At the same time, it must be distinctly understood that we can only give approximate quotations. Frequently, when the actual work is in progress, it is found necessary to replace parts other than those specified in the estimate, as we make a practice of including in such estimates only those items and parts which at the time we consider really essential to put the machine (or parts) in a thoroughly satisfactory condition.

If any estimate prepared in this way is not accepted, we reserve the right to make a nominal charge for taking down and re-assembling any parts necessary in preparing it.

We cannot hold ourselves responsible for loss of, or damage to, any parts lying at our works for repairs, unless instructions to proceed with same are given within twenty-one days of our estimate for the said repairs having been rendered.

All acetylene-welded repairs to crank cases and other aluminium parts are carried out with extreme care, but we cannot give any guarantee with, or accept responsibility for, any parts so treated.

THE 9.76 H.P. ROYAL ENFIELD MOTOR CYCLE

ROYAL ENFIELD TWIN ENGINE.

Quote this No. and name of part when ordering.	Description.	Price.
1E	Crankcase (timing side) ... ..	£ 3 s. 12 d. 6
2E	" (driving side) ... ..	2 12 6
3E	" bearing race (timing side) ... ..	0 10 0
4E	" " " (driving side) ... ..	0 12 6
5E	" " " screw ... ..	0 0 2
6E	" " " " nut ... ..	0 0 2
7E	" bush for camshaft ... ..	0 1 6
8E	" " " exhaust lifter ... ..	0 0 9
9E	" apex stud ... ..	0 0 3
10E	" " " nut ... ..	0 0 1
11E	" " " washer ... ..	0 0 1
12E	" oil drain plug ... ..	0 0 6
13E	" " " washer ... ..	0 0 1
14E	" breather flange (top) ... ..	0 1 0
15E	" " " (btm), with oil pipe ... ..	0 3 0
16E	" " " screw ... ..	0 0 2
17E	" " " disc ... ..	0 0 1
18E	" cylinder stud ... ..	0 0 6
19E	" " " nut ... ..	0 0 2
20E	" overflow pipe ... ..	0 2 0
21E	" " " union ... ..	0 0 9
22E	" " " " nut... ..	0 0 6
23E	" " " " washer ... ..	0 0 1
24E	" " " " clip ... ..	0 0 2
25E	" oil union (as 21E) ... ..	0 0 9
26E	" " " washer (as 23E) ... ..	0 0 1
27E	Camshaft ... ..	0 15 0
28E	" timing wheel ... ..	0 6 0
29E	Timing pinion... ..	0 5 0
30E	" " key ... ..	0 0 4
31E	" " nut ... ..	0 0 6
32E	" " split pin ... ..	0 0 1
33E	Inlet rocker, front cylinder... ..	0 6 0
34E	" " rear " ... ..	0 6 0
35E	Exhaust " front " ... ..	0 6 6
36E	" " rear " ... ..	0 6 6
37E	Inlet " distance piece (long)... ..	0 0 3
38E	" " " " (short) ... ..	0 0 2
39E	Rocker spindle ... ..	0 2 0
40E	" " nut ... ..	0 0 2
41E	" " washer ... ..	0 0 1
42E	Valve lifter rocker ... ..	0 6 0
43E	" " " spring ... ..	0 0 3
44E	" " " " pin ... ..	0 0 3
45E	" " operating lever ... ..	0 1 6
46E	" " " " taper pin ... ..	0 0 2
47E	" " " spindle ... ..	0 1 6
48E	" " " roller ... ..	0 0 3
49E	" " control spring ... ..	0 0 3



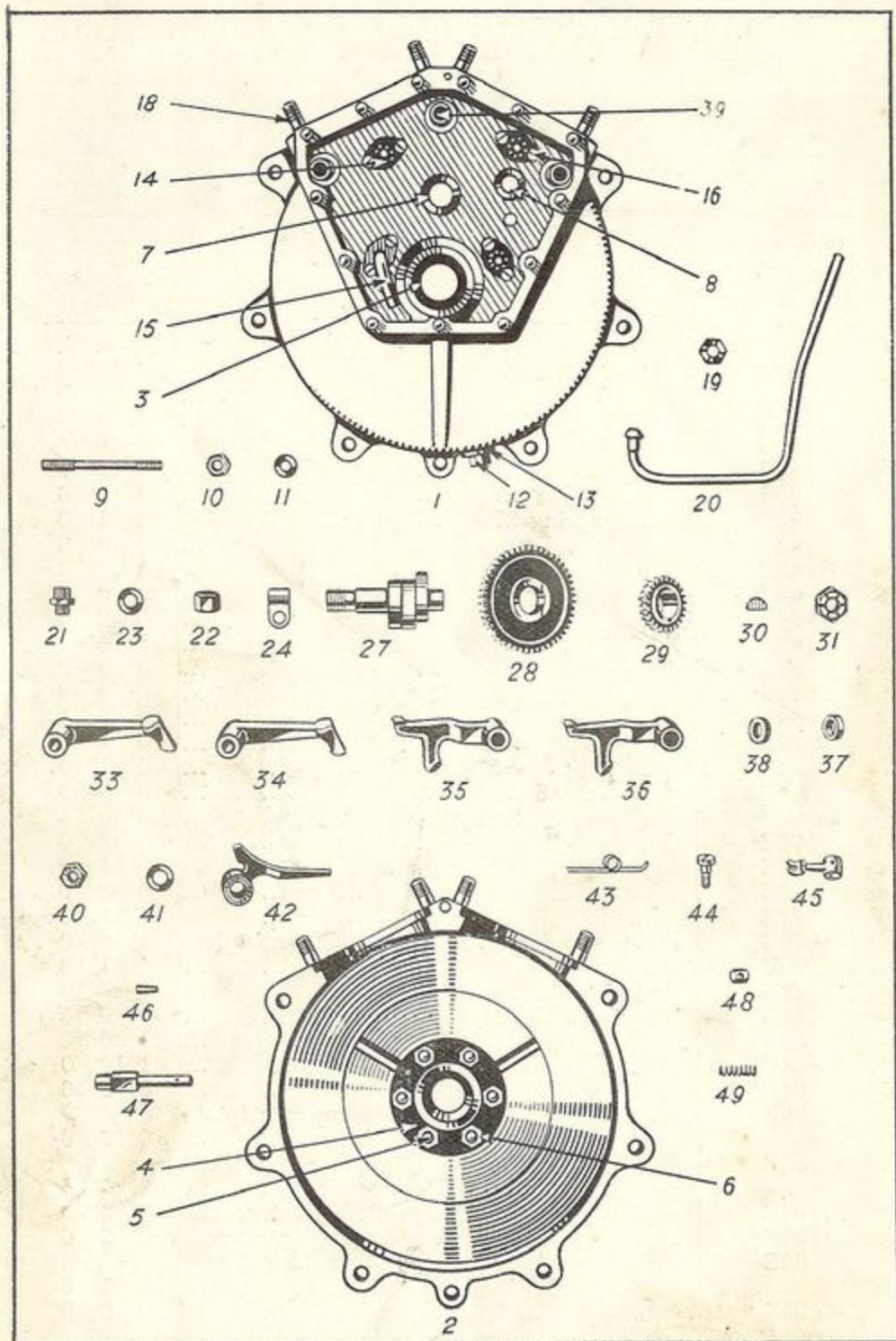

See opposite page for description and price.  
 Order by number with initial "E" added, as shown opposite.

THE 9.76 H.P. ROYAL ENFIELD MOTOR CYCLE

ENGINE—continued.

Quote this No. and name of part when ordering.	Description.	Price.
		£ s. d.
55E	Cylinder with valve guides (front) ...	3 15 0
56E	" " " " (rear) ...	3 15 0
57E	" joint ...	0 0 5
58E	" oil baffle (front) ...	0 0 6
59E	Valve ...	0 5 0
60E	" guide ...	0 2 6
61E	" spring ...	0 1 0
62E	" " cup ...	0 0 8
63E	" " collar ...	0 0 8
64E	" " cotter ...	0 0 2
65E	" cap ...	0 3 6
66E	" " joint washer ...	0 0 2
67E	" guide cup ...	0 0 2
68E	" " " spring ...	0 0 3
69E	" " " felt washer ...	0 0 1
70E	Tappet rod ...	0 1 0
71E	" body ...	0 1 0
72E	" head ...	0 0 9
73E	" " lock nut ...	0 0 4
74E	" guide ...	0 3 0
75E	Induction pipe ...	0 4 0
76E	" " nut ...	0 2 6
77E	" " collar ...	0 1 3
78E	Piston with gudgeon pin and rings complete	1 8 0
79E	" ring ...	0 1 8
80E	Gudgeon pin with pads ...	0 5 0
81E	" " pad ...	0 0 6
82E	Connecting rod with bushes (plain) ...	1 0 0
83E	" " " " (forked) ...	1 10 0
84E	" " small end bush ...	0 2 6
85E	" " big end bearing race (plain rod) ...	0 5 6
86E	" " big end bearing race (forked rod), per pair ...	0 5 6
87E	" " bearing roller, per doz. ...	0 3 0
88E	" " " " cage (plain rod) ...	0 2 6
89E	" " " " " (forked rod) each ...	0 1 6
90E	" " " washer ...	0 0 6



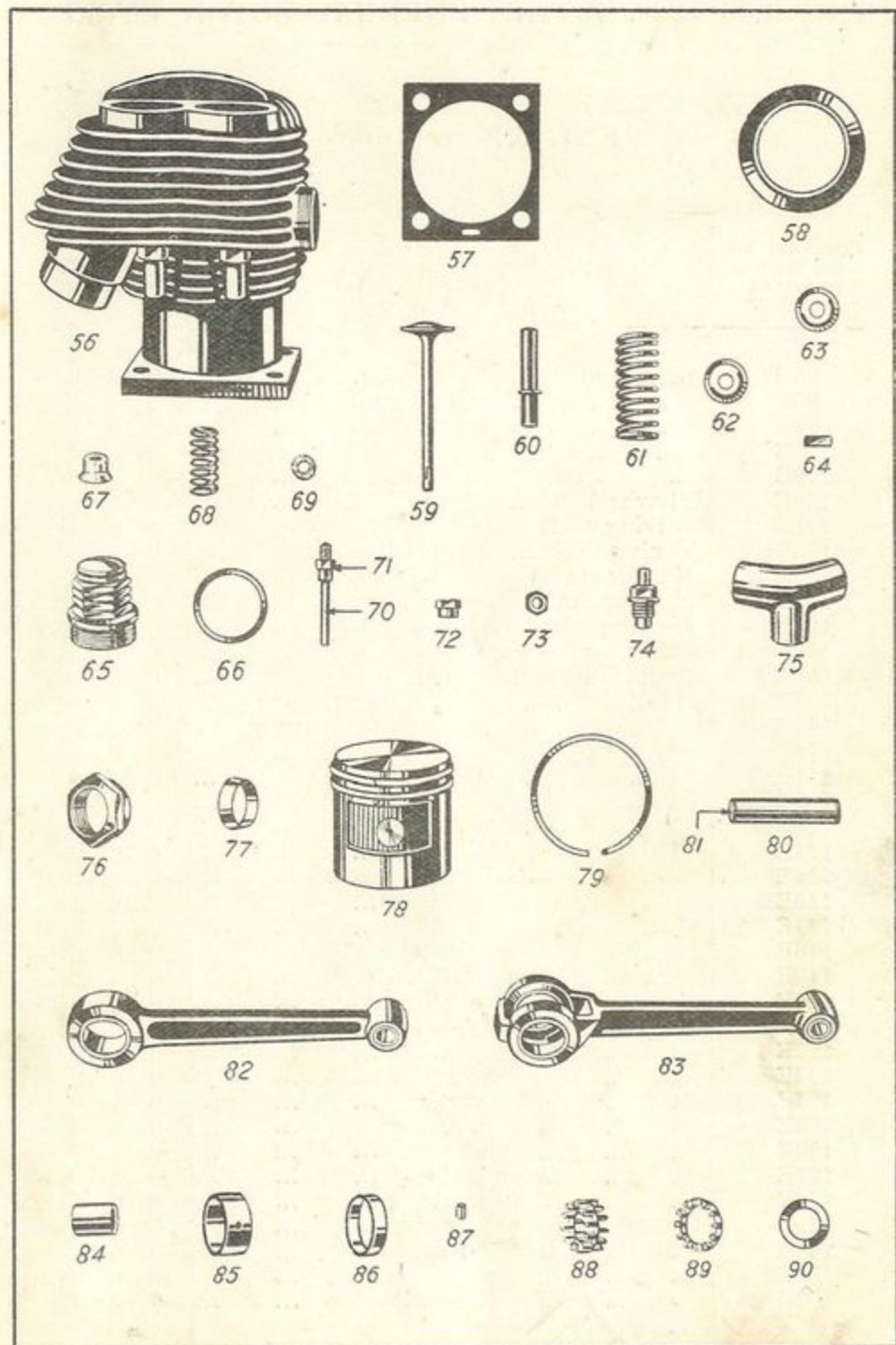

See opposite page for description and price.  
 Order by number with initial "E" added, as shown opposite.

THE 9.76 H.P. ROYAL ENFIELD MOTOR CYCLE

ENGINE—continued.

Quote this No. and name of part when ordering.	Description	Price.		
		£	s.	d.
95E	Crank pin ... ..	0	8	0
96E	" " nut... ..	0	0	6
97E	" " " locking washer ... ..	0	0	2
98E	" " " " " set screw ... ..	0	0	2
99E	" " key ... ..	0	0	5
100E	Flywheel ... ..	1	5	0
101E	Driving shaft ... ..	0	8	0
102E	Timing shaft ... ..	0	7	6
103E	Nut for shafts ... ..	0	0	6
104E	Key for shaft ... ..	0	0	5
105E	Locking washer ... ..	0	0	2
106E	Screw for locking washer (as 98E) ... ..	0	0	2
107E	Crankcase bearing roller (per doz.)... ..	0	3	0
108E	" " " cage (timing side) ... ..	0	2	6
109E	" " " " (driving side) ... ..	0	2	6
110E	" " washer ... ..	0	0	3
111E	" " thrust washer (thin) ... ..	0	1	0
112E	" " " " (thick) ... ..	0	1	0
113E	" " felt washer ... ..	0	0	3
114E	Timing cover ... ..	0	16	0
115E	" " stud ... ..	0	0	3
116E	" " " nut ... ..	0	0	1
117E	" " " washer ... ..	0	0	1
118E	" " paper washer ... ..	0	0	6
119E	" " camshaft bush ... ..	0	1	6
120E	" " exhaust lifter bush ... ..	0	0	9
121E	Oil pump complete ... ..	1	0	0
122E	" " body ... ..	0	10	0
123E	" " " screw ... ..	0	0	2
124E	" " " cover ... ..	0	1	0
125E	" " " " screw ... ..	0	0	2
126E	" " " plunger ... ..	0	2	0
127E	" " " spindle ... ..	0	2	6
128E	" " " disc ... ..	0	5	0
129E	" " " " spring ... ..	0	0	2
130E	" " " joint washer ... ..	0	0	3
131E	" " " union ... ..	0	0	9
132E	" " " " washer ... ..	0	0	1



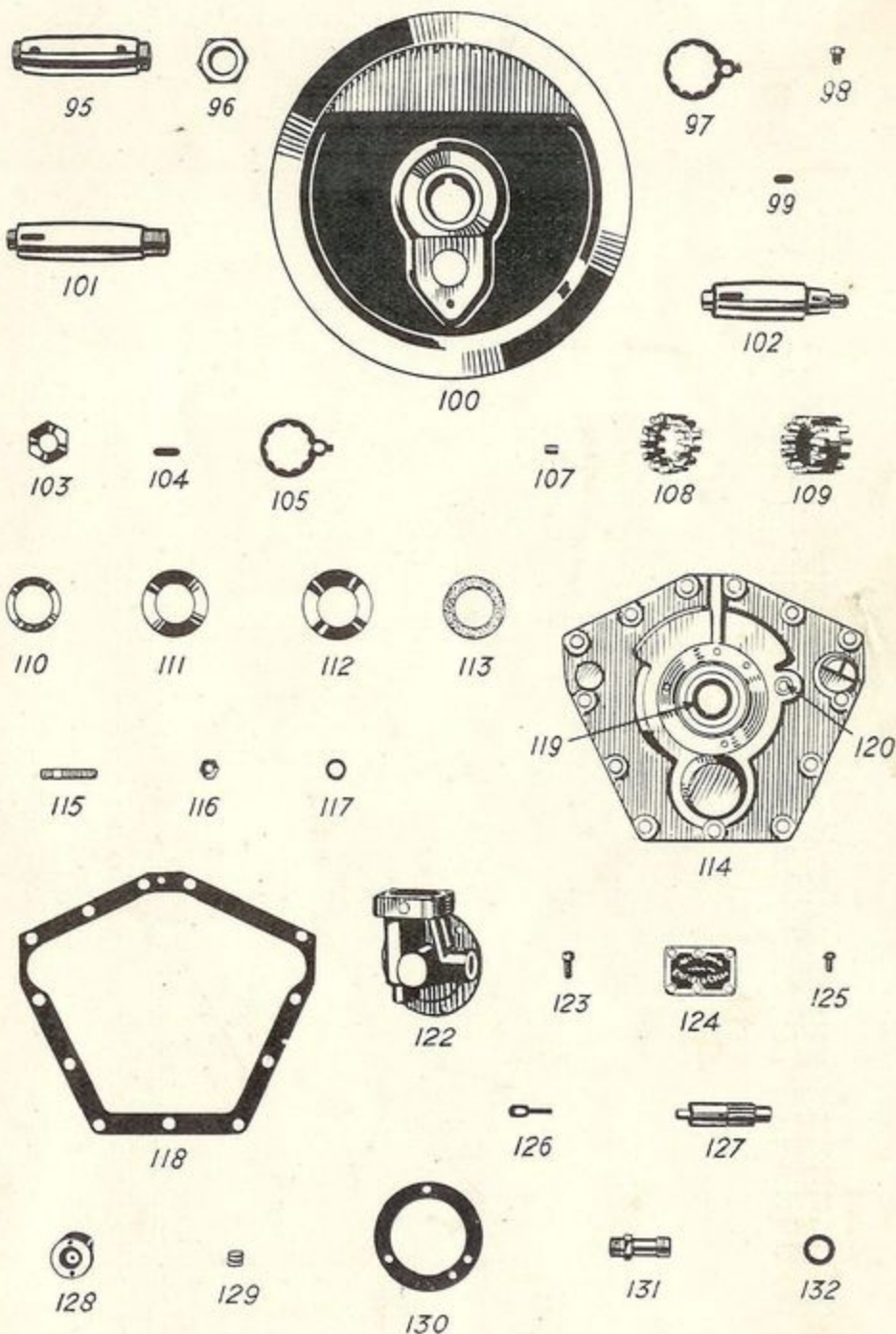

See opposite page for description and price.  
 Order by number with initial "E" added, as shown opposite.

THE 9.76 H.P. ROYAL ENFIELD MOTOR CYCLE

SILENCER, EXHAUST PIPES, FOOTRESTS  
AND FOOTBOARDS.

Quote this No. and name of part when ordering.	Description.	Price.
		£ s. d.
140E	Silencer complete ... ..	1 0 0
141E	" attachment pin ... ..	0 0 2
142E	" " " spring washer ... ..	0 0 1
143E	" tail pipe (top silencer) ... ..	0 7 6
144E	" " " (bottom silencer) ... ..	0 7 6
145E	" " " clip ... ..	0 0 9
146E	" " " " pin ... ..	0 0 2
147E	" " " " nut ... ..	0 0 2
148E	" " " " bush ... ..	0 0 2
149E	Exhaust pipe (front cylinder) ... ..	0 15 0
150E	" " (rear " ) ... ..	0 7 6
151E	" " clip ... ..	0 0 9
152E	" " " pin (as 146E) ... ..	0 0 2
153E	" " " " nut (as 147E) ... ..	0 0 2
154E	" " " " bush (as 148E) ... ..	0 0 2
155E	Footrest supporting arm ... ..	0 0 6
156E	" " stud ... ..	0 0 9
157E	" " " nut ... ..	0 0 3
158E	" " " washer ... ..	0 0 1
159E	" " tube ( $\frac{7}{8} \times 5\frac{1}{4}$ in.) ... ..	0 1 0
160E	" distance tube ( $\frac{11}{16} \times 3\frac{1}{2}$ in.) ... ..	0 0 6
161E	" rubber ... ..	0 1 0
162E	" " spindle ... ..	0 0 6
163E	" " " nut (as 157E) ... ..	0 0 3
164E	" " " washer (as 158E) ..	0 0 1
165E	" " side plate ... ..	0 0 6
166E	" " " stud ... ..	0 0 3
167E	" " " " nut ... ..	0 0 1
168E	" " distance tube ... ..	0 0 6
169E	Footboard ... ..	0 6 6
170E	" rubber stud ... ..	0 0 2
171E	" clip ... ..	0 0 3
172E	" " pin ... ..	0 0 2
173E	" " " nut ... ..	0 0 1
174E	" " " washer ... ..	0 0 1
175E	" supporting arm (as 155E) ... ..	0 0 6
176E	" " tube, rear (as 159E) ... ..	0 1 0
177E	" " " ( $\frac{7}{8} \times 3\frac{1}{4}$ in.) ... ..	0 0 9
178E	" " " front ( $\frac{7}{8} \times 8\frac{13}{16}$ in.) ... ..	0 1 0
179E	" " distance tube ... ..	0 0 6
	(as 160E)	0 0 6
180E	" " stud, rear (long) ... ..	0 1 0
	(as 156E)	0 1 0
181E	" " " (short) ... ..	0 0 6
182E	" " " front ... ..	0 1 0
183E	" " " nut (as 157E) ... ..	0 0 3
184E	" " " washer (as 158E) ... ..	0 0 1



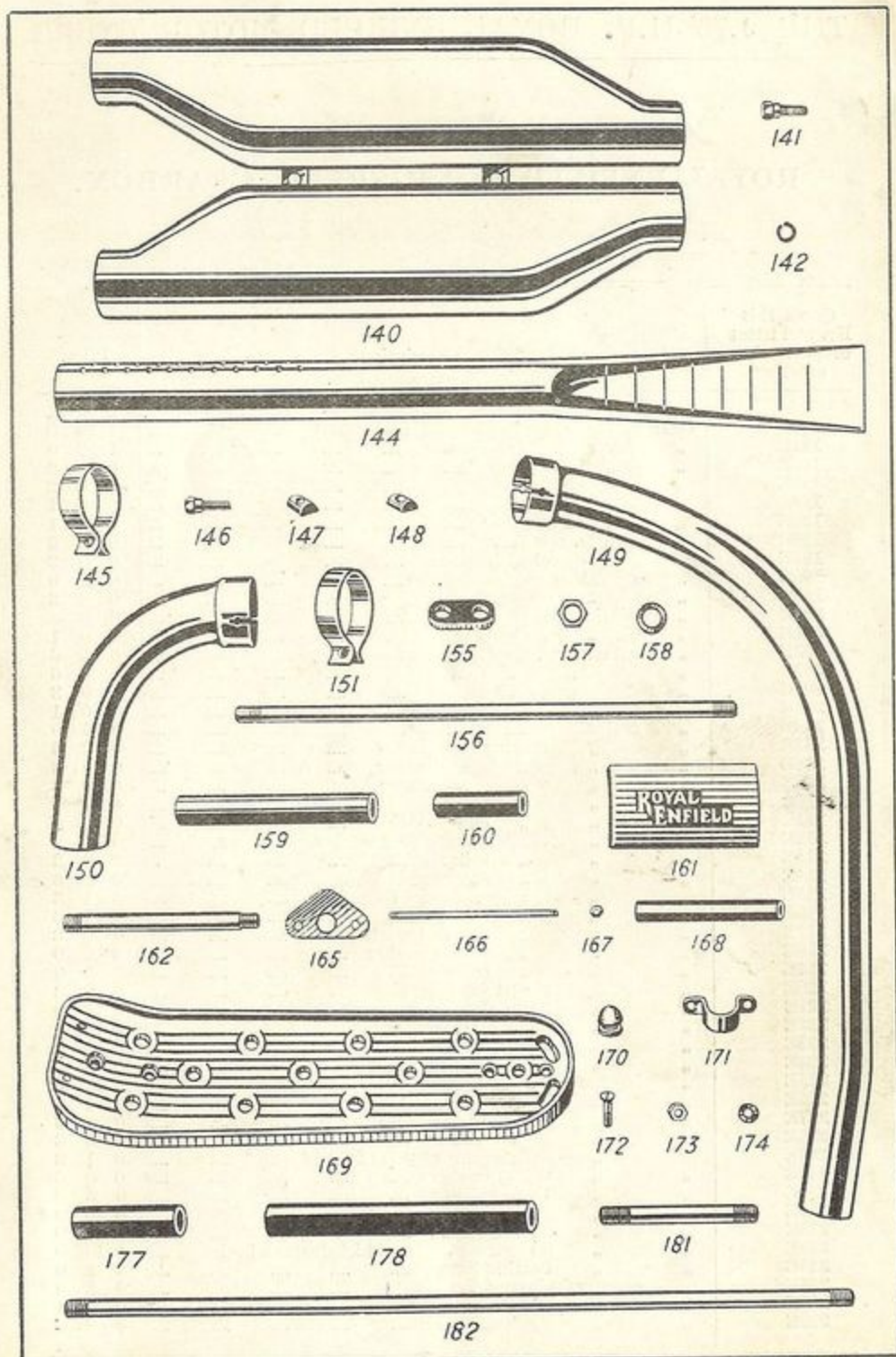

See opposite page for description and price.  
 Order by number with initial "E" added, as shown opposite.

# THE 9.76 H.P. ROYAL ENFIELD MOTOR CYCLE

## ROYAL ENFIELD FOUR-SPEED GEARBOX.

Quote this No. and name of part when ordering.	Description.	Price.
		£ s. d.
190E	Gearbox case only (with studs, no bushes)	1 10 0
191E	" cover " (no bushes)	1 2 6
192E	" " joint washer	0 0 6
193E	" " stud	0 0 2
194E	" " nut	0 0 1
195E	" " washer	0 0 1
196E	" " screw	0 0 2
197E	" " dowel	0 0 2
198E	operating quadrant cover	0 2 0
199E	" " " screw	0 0 2
200E	oil filler plug	0 0 8
201E	" " " washer	0 0 1
202E	attachment stud (top)	0 0 6
203E	" " (bottom)	0 0 6
204E	" " nut	0 0 3
205E	" " washer	0 0 1
206E	mainshaft	0 16 0
207E	" " bearing race (large)	0 3 6
208E	" " " washer	0 0 3
209E	" " " felt washer	0 0 3
210E	" " " thrust washer	0 1 0
211E	" " " end washer	0 0 2
212E	" " " oil retaining washer	0 0 2
213E	" " " roller	0 0 3
214E	" " " cage (large)	0 2 6
215E	" " " (small)	0 1 3
216E	" " " race (small)	0 1 6
217E	" " " end washer	0 0 3
218E	" " " thrust washer	0 0 9
219E	" " " roller	0 0 3
220E	" " " thrust washer	0 0 6
221E	" " " 26 tooth gear	0 15 0
222E	" " " 23 " "	0 10 0
223E	" " " 20 " "	0 10 0
224E	" " " 14 " "	0 2 6
225E	layshaft	0 12 6
226E	" " bearing race	0 1 6
227E	" " " end washer	0 0 3
228E	" " " roller	0 0 3
229E	" " " cage (as 215E)	0 1 3
230E	" " " thrust washer	0 0 6
231E	" " " 18 tooth gear	0 3 0
232E	" " " 21 " "	0 10 0
233E	" " " 24 " "	0 10 0
234E	" " " 30 " " and kickstarter wheel	0 10 0
235E	" " " bearing bush	0 2 0
236E	countershaft sprocket	0 5 0
237E	" " " key	0 0 4
238E	" " " nut	0 0 6



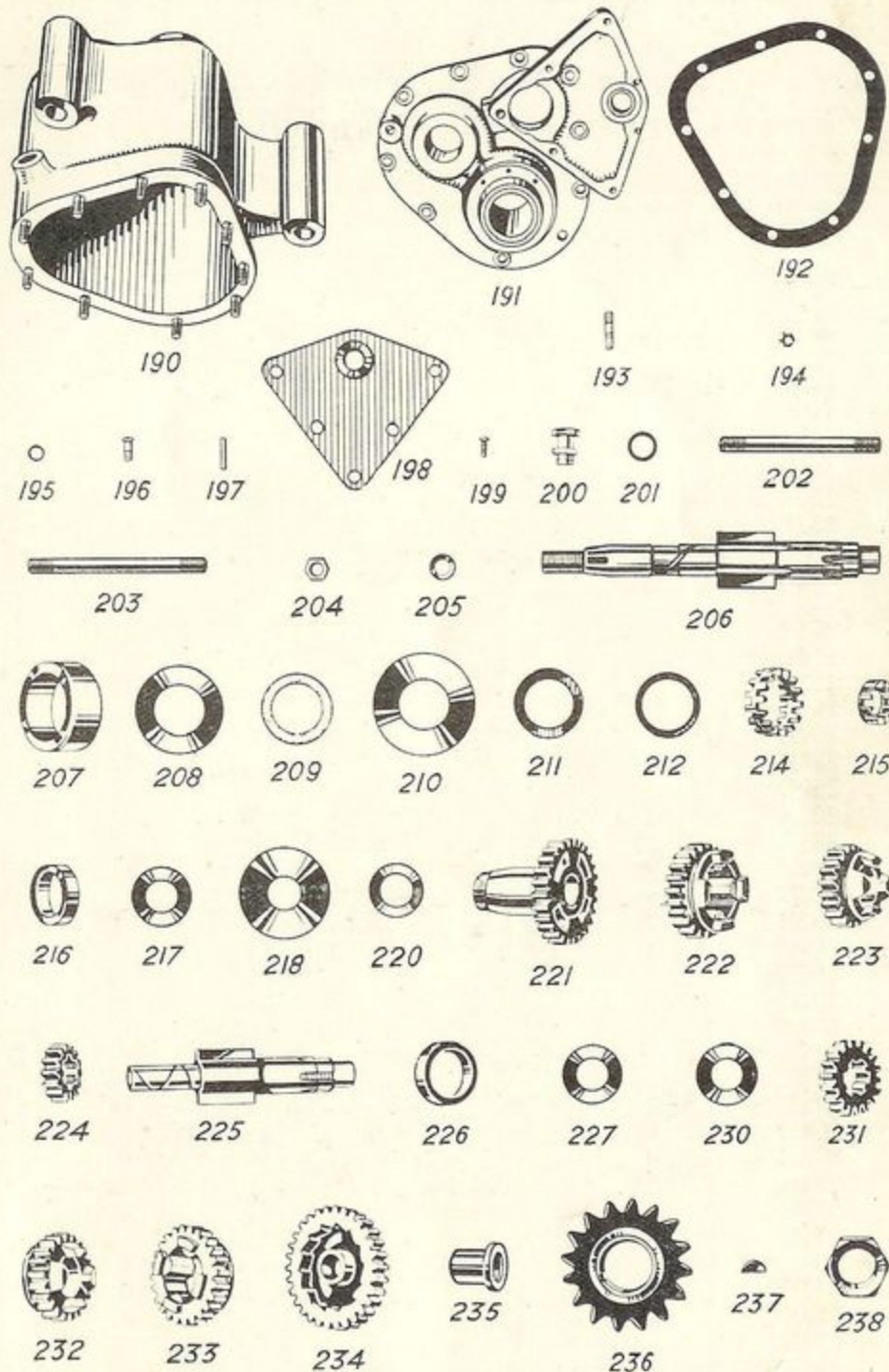

See opposite page for description and price.  
 Order by number with initial "E" added, as shown opposite.

# THE 9.76 H.P. ROYAL ENFIELD MOTOR CYCLE

## KICKSTARTER, CLUTCH AND GEAR OPERATING MECHANISM.

Quote this No. and name of part when ordering.	Description.	Price.
		£ s. d.
245E	Kickstarter spindle with layshaft bearing bush	0 12 0
246E	" " bearing bush ...	0 5 0
247E	" " pawl ...	0 1 6
248E	" " rivet ...	0 0 2
249E	" " plunger ...	0 0 2
250E	" " " " spring ...	0 0 2
251E	" " crank ...	0 7 6
252E	" " cotter pin ...	} 0 0 6
	" " " " nut ...	
	" " " " washer ...	
253E	" " return spring ...	0 1 0
254E	" " " " cover ...	0 0 9
255E	" " distance tube ...	0 0 2
256E	" " stop ...	0 1 0
257E	" " " stud ...	0 0 2
258E	" " " nut ...	0 0 1
259E	" " " washer ...	0 0 1
260E	Clutch operating lever ...	0 2 6
261E	" " " pin ...	0 0 2
262E	" " worm ...	0 1 6
263E	" " " nut ...	0 2 6
264E	" " " gland washer ...	0 0 1
265E	" " " nut ...	0 1 0
266E	" " rod ...	0 1 0
267E	" " pad ...	0 0 6
268E	" " cable stop ...	0 0 9
269E	Gear operating cam ...	0 12 6
270E	" " " bearing bush (large) ...	0 2 0
271E	" " " " (small) ...	0 2 0
272E	" " arm (top gear) ...	0 6 0
273E	" " " (bottom gear) ...	0 6 0
274E	" " tracing roller ...	0 0 6
275E	" " " bush ...	0 0 9
276E	" " " " locking washer	0 0 2
277E	" " " " spring ...	0 0 2
278E	" " quadrant ...	0 7 6
279E	" " " bearing bush (long)	0 0 9
280E	" " " " (short)	0 0 6
281E	" " lever ...	0 2 0
282E	" " key ...	0 0 2
283E	" " nut ...	0 0 3



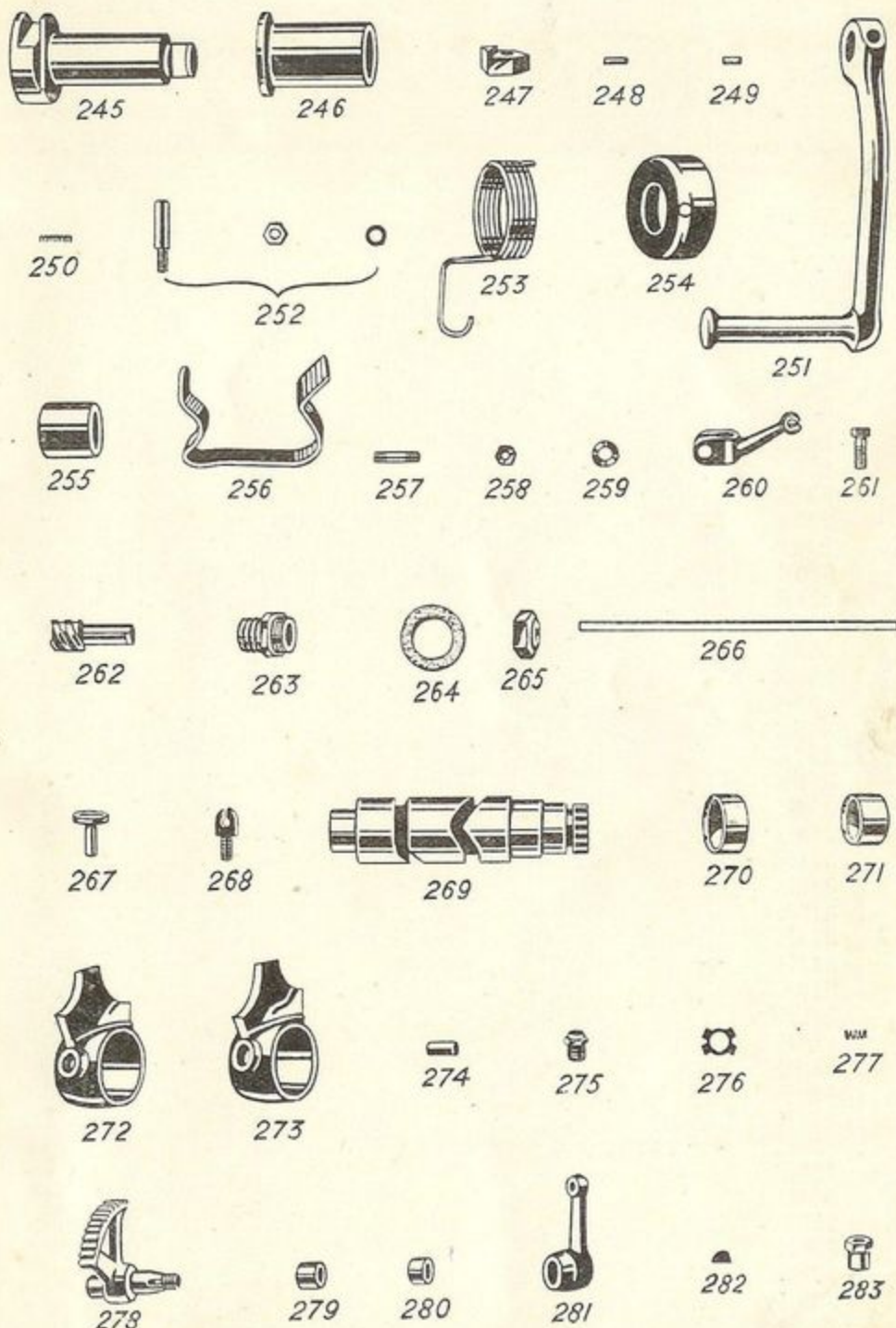

See opposite page for description and price.

Order by number with initial "E" added, as shown opposite.

THE 9.76 H.P. ROYAL ENFIELD MOTOR CYCLE

CLUTCH AND GEAR CONTROL.

Quote this No. and name of part when ordering.	Description.	Price.		
		£	s.	d.
290E	Clutch sprocket with roller race, drum, and Ferodo pads ... ..	1	5	0
291E	" " bearing roller (each) ...	0	0	3
292E	" " ½in. dia. balls (per doz.) ...	0	0	5
293E	" centre ... ..	0	12	6
294E	" back plate ... ..	0	2	6
295E	" " spacing washer ... ..	0	1	0
296E	" plate (thick) ... ..	0	2	6
297E	" " (thin) ... ..	0	2	0
298E	" " complete with Ferodo pads ...	0	5	0
299E	" " " " cork " ...	0	3	0
300E	" " Ferodo pad, large (short) ...	0	0	2
301E	" " " " " (long) ...	0	0	2
302E	" " " " " small (short) ...	0	0	2
303E	" " " " " (long) ...	0	0	2
304E	" " cork pad ... ..	0	0	1
305E	" spring ... ..	0	0	3
306E	" " cup ... ..	0	0	3
307E	" " stud ... ..	0	0	6
308E	" " " nut ... ..	0	0	2
309E	" " adjusting screw ... ..	0	0	2
310E	" " " " washer... ..	0	0	1
311E	" pressure plate ... ..	0	3	0
312E	" nut ... ..	0	0	6
313E	" washer... ..	0	0	1
314E	Gear control lever and bell crank ...	0	3	0
315E	" " " knob ... ..	0	0	9
316E	" " " " ferrule ... ..	0	0	3
317E	" " " " collar ... ..	0	0	1
318E	" " " distance piece ... ..	0	0	3
319E	" " " spindle ... ..	0	0	9
320E	" " " " washer ... ..	0	0	2
321E	" " " " spring washer ...	0	0	2
322E	" " gate ... ..	0	1	6
323E	" " " screw ... ..	0	0	1
324E	" " " " nut... ..	0	0	1
325E	" " " arm ... ..	0	2	6
326E	" " " " screw ... ..	0	0	2
327E	" " rod ... ..	0	0	6
328E	" " " connection (top) ...	0	1	0
329E	" " " " (bottom) ...	0	1	0
330E	" " " " locknut ...	0	0	1
331E	" " " " pin ...	0	0	2
332E	" " " " split pin ...	0	0	1



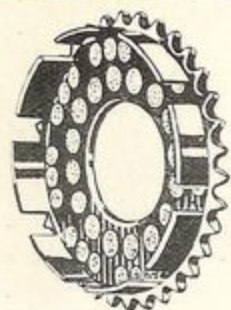

290



293

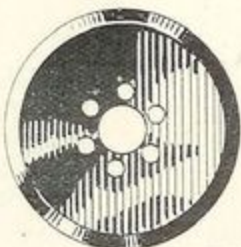

294



295



296

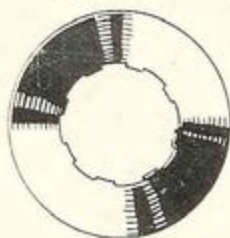

297



298

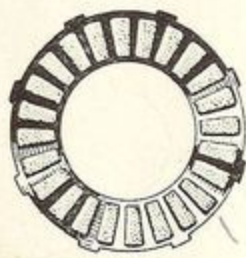

299



305



306



307



308



309



310

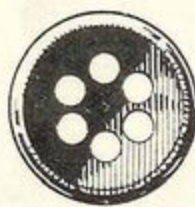

311



312



313



314



315



316



317



318

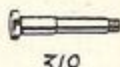

319



320



321



322



323



324



326



327



325



328



329



330



331

See opposite page for description and price.  
Order by number with initial "E" added, as shown opposite.

THE 9.76 H.P. ROYAL ENFIELD MOTOR CYCLE

HANDLEBAR, CONTROLS AND STEERING DAMPER.

Quote this No. and name of part when ordering.	Description.	Price.
		£ s. d.
340E	Handlebar, complete with grips, levers and controls (Touring) ....	2 15 0
341E	" " " " " " " " (Sports) ....	2 15 0
342E	" " only, minus grips (Touring) " " " " ....	0 10 0
343E	" " " " " " (Sports) " " " " ....	0 10 0
344E	" " grips (Touring), per pair " " " " ....	0 2 0
345E	" " (Sports) " " " " " " ....	0 4 0
346E	" " inverted lever " " " " " " ....	0 3 4
347E	" " " " " " pocket " " " " ....	0 0 9
348E	" " " " " " cap " " " " ....	0 0 6
349E	" " " " " " pivot screw " " " " ....	0 0 1
350E	" " " " " " " " nut " " " " ....	0 0 2
351E	" " " " " " roller " " " " ....	0 0 2
352E	" " " " " " lock screw " " " " ....	0 0 1
353E	Clutch lever complete with cable and casing " " " " " " ....	0 12 0
354E	" " " " " " less " " " " " " ....	0 7 6
355E	" " cable " " " " " " " " " " ....	0 0 9
356E	" " casing " " " " " " " " " " ....	0 2 6
357E	" " " " clip " " " " " " " " ....	0 0 3
358E	" " " " nipple " " " " " " " " ....	0 0 1
359E	" " " " return spring " " " " " " " " ....	0 0 3
360E	" " " " ball nipple " " " " " " " " ....	0 0 1
361E	" " " " adjusting screw " " " " " " " " ....	0 0 6
362E	" " " " " " locknut " " " " " " " " ....	0 0 1
363E	Carburettor control complete with cables and casings " " " " " " " " ....	0 12 0
364E	" " " " " " less " " " " " " " " ....	0 6 6
365E	" " " " cable " " " " " " " " " " ....	0 0 6
366E	" " " " casing " " " " " " " " " " ....	0 2 0
367E	" " " " nipple " " " " " " " " " " ....	0 0 1
368E	Magneto " " complete with cable and casing " " " " " " " " ....	0 8 0
369E	" " " " " " less " " " " " " " " ....	0 5 0
370E	" " " " cable " " " " " " " " " " ....	0 0 6
371E	" " " " casing " " " " " " " " " " ....	0 2 0
372E	" " " " nipple (top) " " " " " " " " " " ....	0 0 1
373E	" " " " " (bottom) " " " " " " " " " " ....	0 0 1
374E	" " " " spring " " " " " " " " " " ....	0 0 3
375E	Exhaust lifter cable " " " " " " " " " " " " ....	0 0 9
376E	" " " " casing " " " " " " " " " " ....	0 2 3
377E	" " " " nipple " " " " " " " " " " ....	0 0 1
378E	" " " " screwed nipple " " " " " " " " " " ....	0 0 1
379E	Cable casing ferrule (large) " " " " " " " " " " " " ....	0 0 1
380E	" " " " (small) " " " " " " " " " " " " ....	0 0 1
381E	" " clip, 1½ in. dia. (double) " " " " " " " " " " ....	0 0 2
382E	" " " " 1 in. " (single) " " " " " " " " " " ....	0 0 2
383E	" " " " 1 in. " (double) " " " " " " " " " " ....	0 0 2
384E	Steering damper complete " " " " " " " " " " " " ....	0 15 0
385E	" " " " adjusting knob " " " " " " " " " " ....	0 3 0
386E	" " " " cover " " " " " " " " " " ....	0 0 6
387E	" " " " spring washer " " " " " " " " " " ....	0 0 6
388E	" " " " friction washer " " " " " " " " " " ....	0 1 6
389E	" " " " disc " " " " " " " " " " ....	0 1 0
390E	" " " " anchor plate " " " " " " " " " " ....	0 2 3
391E	" " " " " " pin " " " " " " " " " " ....	0 0 3
392E	" " " " " " washer " " " " " " " " " " ....	0 0 1
393E	" " " " sleeve " " " " " " " " " " ....	0 2 0
394E	" " " " bush " " " " " " " " " " ....	0 0 3
395E	" " " " cone " " " " " " " " " " ....	0 0 6
396E	" " " " spindle " " " " " " " " " " ....	0 1 0
397E	" " " " distance tube " " " " " " " " " " ....	0 0 6



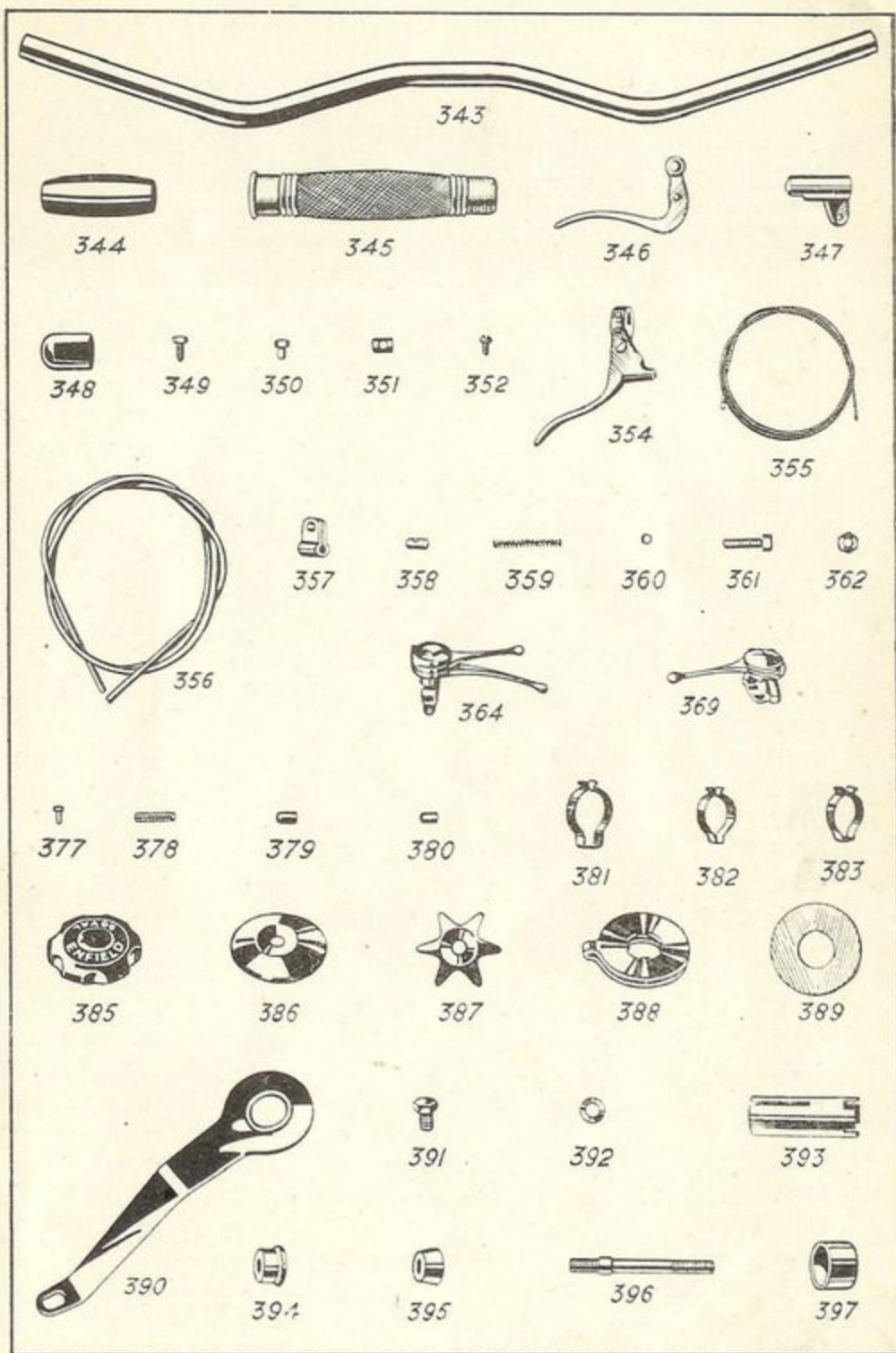

See opposite page for description and price.  
 Order by number with initial "E" added, as shown opposite.

THE 9.76 H.P. ROYAL ENFIELD MOTOR CYCLE.

PETROL TANK AND FITTINGS.

Quote this No. and name of part when ordering.	Description.	Price.
		£ s. d.
405E	Petrol tank assembled complete ... ..	5 10 0
406E	" " only ... ..	4 10 0
407E	" " filler cap (oil) ... ..	0 3 6
408E	" " " " (petrol) ... ..	0 3 6
409E	" " pin ... ..	0 0 2
410E	" " rubber pad ... ..	0 0 2
411E	" " U connection pipe complete ... ..	0 2 0
412E	" " " " " union ... ..	0 0 9
413E	" " " " " fibre washer	0 0 1
414E	" tap ... ..	0 2 6
415E	" " fibre washer (as 413E) ... ..	0 0 1
416E	" filter complete ... ..	0 3 6
417E	" " body ... ..	0 2 0
418E	" " " cap... ..	0 1 0
419E	" " gauze ... ..	0 0 6
420E	" " leather washer (large) ... ..	0 0 2
421E	" " " " (small) ... ..	0 0 2
422E	" pipe complete ... ..	0 2 6
423E	Oil pump plunger ... ..	0 2 0
424E	" " " leather cup washer ... ..	0 0 2
425E	" " " " " nut ... ..	0 0 2
426E	" " " " " washer ... ..	0 0 1
427E	" " " distance tube ... ..	0 0 1
428E	" " " cup ... ..	0 0 2
429E	" " " guide ... ..	0 0 9
430E	" " valve body ... ..	0 1 3
431E	" " " " leather washer ... ..	0 0 1
432E	" " " " steel " ... ..	0 0 1
433E	" " " " disc ... ..	0 0 1
434E	" " tap ... ..	0 2 6
435E	" " " fibre washer (as 413E) ... ..	0 0 1
436E	" pipe to engine complete ... ..	0 2 6
437E	" " mechanical pump complete ... ..	0 2 6
438E	" tap and filter gauze ... ..	0 3 0
439E	" " fibre washer (as 413E) ... ..	0 0 1



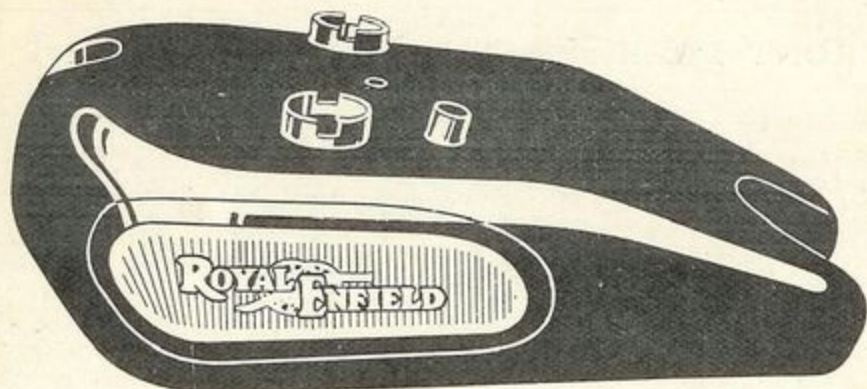

406



407



408



409



410

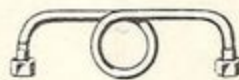

411



412



413



414



416



418

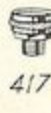

417



423



419



420



421



422



424



425



426



427



428



429

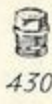

430



431



432



433



434

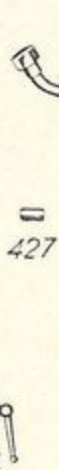

436



437



438

See opposite page for description and price.  
Order by number with initial "E" added, as shown opposite.

THE 9.76 H.P. ROYAL ENFIELD MOTOR CYCLE

FRONT FORK, FRONT STAND AND FRONT MUDGUARD.

Quote this No. and name of part when ordering.	Description.	Price.
445E	Front fork side R.H. (Standard) ....	£ 8. 0.
446E	" " " " (Lighting Set) ....	2 0 0
447E	" " " " L.H. (Standard) ....	2 0 0
448E	" " " " (Lighting Set) ....	2 1 0
449E	" " " " rocker link (long) (Sidecar) ....	0 10 0
450E	" " " " " (Solo)....	0 10 0
451E	" " " " " (short) ....	0 8 0
452E	" " " " stud, bottom (long) ....	0 2 0
453E	" " " " " (short) ....	0 1 6
454E	" " " " " top (long) ....	0 1 6
455E	" " " " " (short) ....	0 1 6
456E	" " " " " nut ....	0 0 3
457E	" " " " " adjusting nut, $\frac{3}{8}$ in. ....	0 0 6
458E	" " " " " " $\frac{1}{2}$ in. ....	0 0 6
459E	" " " " " washer ....	0 0 2
460E	" " " " " spring ....	0 5 0
461E	" " " " " lug (top) ....	0 3 6
462E	" " " " " (bottom) ....	0 2 0
463E	" " " " " steering stem ....	0 11 0
464E	" " " " " ball head clip ....	0 15 0
465E	" " " " " " pin ....	0 0 4
466E	" " " " " " nut ....	0 0 2
467E	" " " " " " washer....	0 0 2
468E	" " " " " ball race ....	0 1 0
469E	" " " " " " top ....	0 1 6
470E	" " " " " $\frac{1}{2}$ in. dia. balls (per doz.) ....	0 0 5
471E	" " " " " dust cover ....	0 0 9
472E	" " " " " locknut ....	0 1 6
473E	" " " " " grease nipple (straight) ....	0 0 6
474E	" " " " " (angled) ....	0 0 6
475E	" " " " " handlebar pin ....	0 0 3
476E	" " " " " " washer ....	0 0 1
477E	" " " " " stand ....	0 12 0
478E	" " " " " bush ....	0 0 3
479E	" " " " " pin ....	0 0 4
480E	" " " " " nut ....	0 0 2
481E	" " " " " mudguard complete with stand clip and number plate clips	1 9 0
482E	" " " " " with stays only ....	1 4 0
483E	" " " " " stay (long) ....	0 0 6
484E	" " " " " (short) ....	0 0 6
485E	" " " " " end (R.H.) ....	0 1 0
486E	" " " " " (L.H.) ....	0 1 0
487E	" " " " " nut ....	0 0 2
488E	" " " " " cap nut ....	0 0 3
489E	" " " " " pin ....	0 0 3
490E	" " " " " spring washer....	0 0 1
491E	" " " " " stand clip complete ....	0 2 3
492E	" " " " " number plate (Sidecar models) ....	0 1 0
493E	" " " " " complete with licence holder (Solo models)	0 2 6
494E	" " " " " only (Solo models) ....	0 1 3
495E	" " " " " clip ....	0 0 6
496E	" " " " " screw ....	0 0 2
497E	" " " " " washer ....	0 0 1
498E	" " " " " licence holder flange ....	0 0 6
499E	" " " " " glass ....	0 0 1
500B	" " " " " back ....	0 0 2
501E	" " " " " rubber washer ....	0 0 1
502E	" " " " " screw (per doz.) ....	0 0 6
503E	" " " " " nut ....	0 0 1



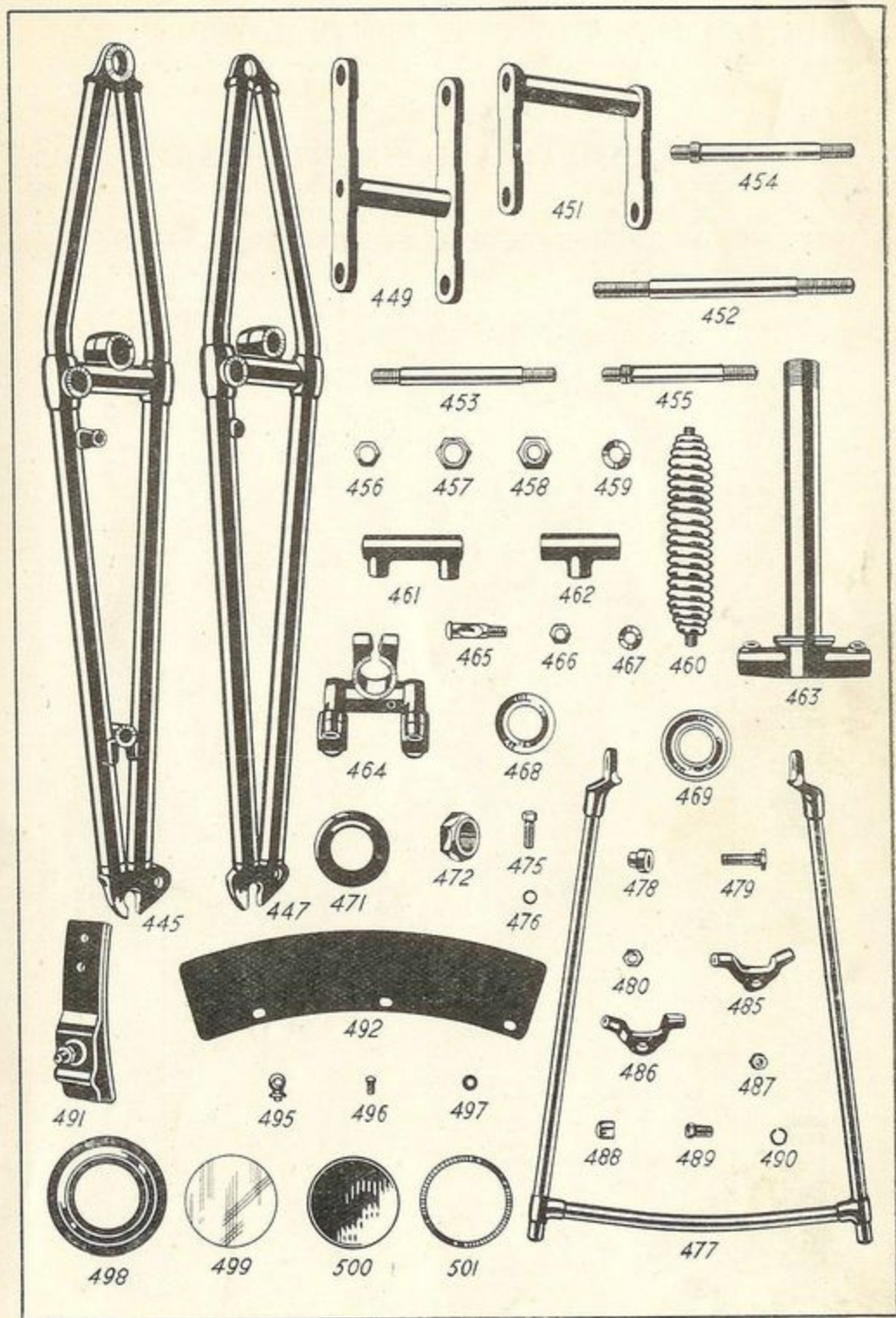

See opposite page for description and price.  
 Order by number with initial "E" added, as shown opposite.

THE 9.76 H.P. ROYAL ENFIELD MOTOR CYCLE

FRONT WHEEL AND FRONT BRAKE.

Quote this No. and name of part when ordering.	Description.	Price.
510E	Front wheel and brake complete, less tyre	£ 4 0 0
511E	" " only	2 5 0
512E	" " rim	0 12 6
513E	" " spokes (7 1/4 in. long) Set of 20	0 1 6
514E	" " " (8 1/8 in. " " " "	0 1 6
515E	" " " nipple (each)	0 0 1
516E	hub with grease nipple	1 0 0
517E	brake drum	0 12 6
518E	hub grease nipple	0 0 6
519E	" " spindle	0 1 0
520E	" " " nut	0 0 9
521E	" " " washer	0 0 1
522E	" " roller bearing (fixed)	0 7 6
523E	" " " (adjusting)	0 7 6
524E	" " " locknut	0 0 4
525E	" " oil retaining felt washer (plain side)	0 0 2
526E	" " " steel " "	0 0 2
527E	" " " felt " (brake side)	0 0 2
528E	" " " steel " "	0 0 2
529E	" " dust excluder	0 0 6
530E	brake shoe with lining and pad	0 7 6
531E	" " " pad	0 0 6
532E	" " " lining	0 2 3
533E	" " " rivet (per doz.)	0 0 6
534E	" " " spring	0 0 6
535E	" " cover plate with shoe pin, cam bush, anchor arm, oil baffle and cable stop	0 10 0
536E	" " cover plate distance piece	0 0 4
537E	" " operating lever and cam	0 2 6
538E	" " " grease nipple	0 0 6
539E	" " " connection	0 1 3
540E	" " " " pin	0 0 3
541E	" " " " split pin	0 0 1
542E	" " cable and nipples	0 0 6
543E	" " casing	0 2 6
544E	" " " ferrule	0 0 1
545E	" " " adjusting screw	0 0 4
546E	" " " " locknut	0 0 1
547E	" " " clip	0 0 1
548E	" " " rubber tube	0 0 2
549E	" " anchor pin	0 0 3
550E	" " " nut	0 0 2
551E	" " " washer	0 0 1
552E	" " foot pedal	0 4 0
553E	" " " grease nipple	0 0 6
554E	" " " spindle	0 2 6
555E	" " " nut, 1/2 in.	0 0 3
556E	" " " washer, 1/2 in.	0 0 1
557E	" " " nut, 3/4 in.	0 0 2
558E	" " " washer, 3/4 in. (as 551E)	0 0 1
559E	" " " cable stop	0 1 0
560E	" " " nut (as 550E)	0 0 2
561E	" " " washer (as 551E)	0 0 1
562E	" " " guide	0 0 2
563E	" " " " "	0 0 2



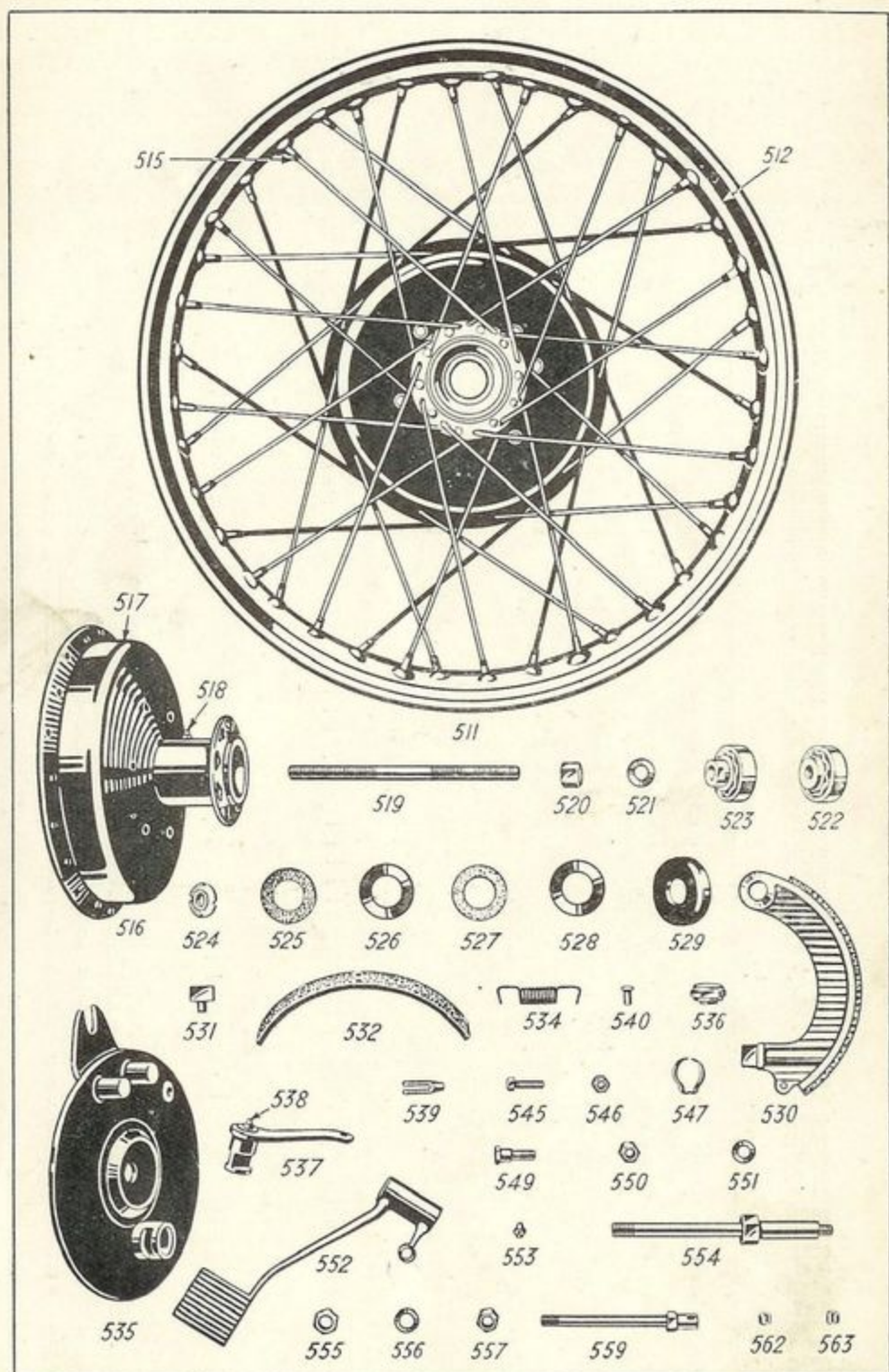

See opposite page for description and price.

Order by number with initial "E" added, as shown opposite

# THE 9.76 H.P. ROYAL ENFIELD MOTOR CYCLE

## REAR WHEEL AND REAR BRAKE.

Quote this No. and name of part when ordering.	Description.	Price.
		£ s. d.
570E	Rear wheel with cush drive and brake, minus tyre	6 0 0
571E	" " only	3 0 0
572E	" " rim	0 12 6
573E	" " spokes (7½ in. long) Set of 10	0 0 9
574E	" " " (8 in. " ) " " "	0 0 9
575E	" " " (8¼ in. " ) " " 20	0 1 6
576E	" " " nipple (each)	0 0 1
577E	" hub with grease nipple	1 0 0
578E	" " brake drum	0 10 0
579E	" " " " " bolt	0 0 2
580E	" " " " " nut	0 0 1
581E	" " " " " washer	0 0 1
582E	" " grease nipple	0 0 6
583E	" " spindle	0 3 6
584E	" " " nut	0 0 10
585E	" " " washer	0 0 2
586E	" " roller bearing (fixed)	0 7 6
587E	" " " " (adjustable)	0 7 6
588E	" " " " locknut	0 0 4
589E	" " oil retaining felt washer (driving side)	0 0 2
590E	" " " " steel " "	0 0 2
591E	" " " " felt " (brake side)	0 0 2
592E	" " " " steel " "	0 0 2
593E	" " dust excluder	0 0 9
594E	" " driving sprocket	0 18 0
595E	" " " " lockring	0 2 0
596E	" " " " stud	0 0 4
597E	" " " " nut	0 0 2
598E	" " " " spring washer	0 0 1
599E	" " " " cush rubber (set of 6)	0 6 0
600E	" brake shoe complete with lining and pad	0 7 6
601E	" " " pad	0 0 6
602E	" " " lining	0 2 3
603E	" " " rivet (per doz.)	0 0 6
604E	" " " spring	0 0 6
605E	" " cover plate with anchor arm, shoe pin, cam bush and oil baffle	0 10 0
606E	" " cover plate distance piece	0 0 6
607E	" " anchor pin	0 0 3
608E	" " " nut	0 0 3
609E	" " " washer	0 0 1
610E	" " operating cam and lever complete with trunnion	0 3 6
611E	" " " grease nipple	0 0 6
612E	" " " rod	0 1 0
613E	" " " washer	0 0 1
614E	" " " split pin	0 0 1
615E	" " " adjusting nut	0 1 0
616E	" " foot pedal	0 6 0
617E	" " " spindle	0 2 6
618E	" " " ½ in. nut	0 0 3
619E	" " " washer	0 0 1
620E	" " " ½ in. nut	0 0 2
621E	" " " washer	0 0 1



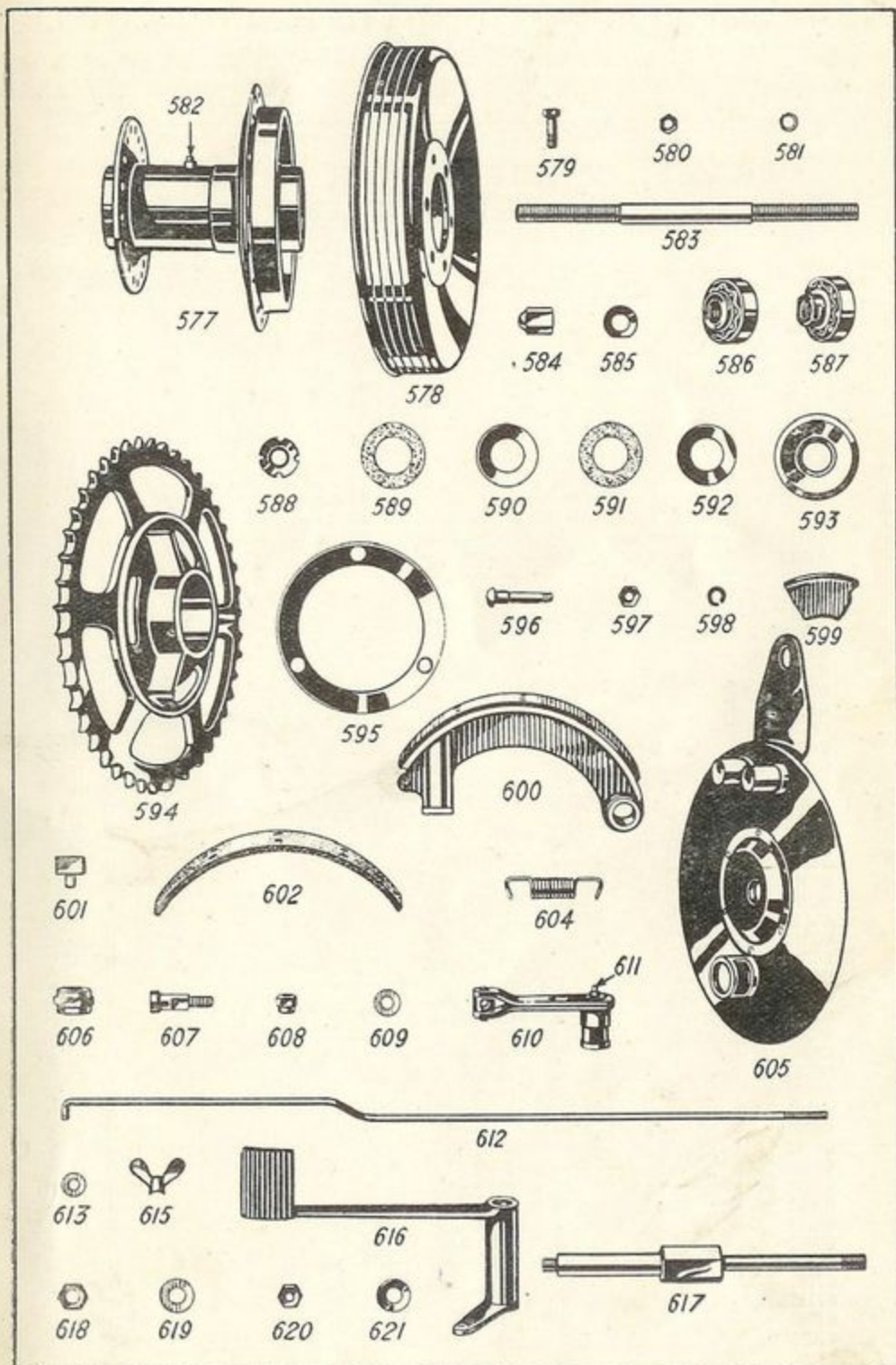

See opposite page for description and price.  
 Order by number with initial "E" added, as shown opposite.

# THE 9.76 H.P. ROYAL ENFIELD MOTOR CYCLE

## FRAME, CARRIER, REAR MUDGUARD AND REAR STAND.

Quote this No. and name of part when ordering.	Description.	Price.
		£ s. d.
625E	Frame .....	9 0 0
626E	rear fork side (R.H.) .....	2 5 0
627E	rear fork side (L.H.) .....	2 5 0
628E	engine plate (each) .....	0 2 6
629E	distance tube .....	0 1 0
630E	chain adjuster screw .....	0 0 4
631E	locknut .....	0 0 3
632E	seat lug stud .....	0 0 6
633E	nut .....	0 0 3
634E	washer (large) .....	0 0 2
635E	washer (small) .....	0 0 1
636E	tube stud (bottom) .....	0 0 6
637E	nut .....	0 0 3
638E	washer .....	0 0 1
639E	chainstay stud .....	0 0 9
640E	nut .....	0 0 6
641E	washer .....	0 0 1
642E	Carrier .....	2 5 0
643E	stud .....	0 0 6
644E	nut .....	0 0 3
645E	locknut .....	0 0 2
646E	spring ring .....	0 0 1
647E	Rear mudguard (fixed half) .....	0 7 6
648E	(detachable half) .....	0 7 6
649E	strap (top) .....	0 2 3
650E	(bottom) .....	0 1 6
651E	clip .....	0 0 6
652E	bolt .....	0 0 2
653E	nut .....	0 0 1
654E	washer .....	0 0 1
655E	clip .....	0 0 4
656E	plate .....	0 0 3
657E	pin .....	0 0 2
658E	nut (as 653E) .....	0 0 1
659E	washer (as 654E) .....	0 0 1
660E	stand clip complete .....	0 2 9
661E	$\frac{1}{8}$ in. pin .....	0 0 2
662E	nut .....	0 0 2
663E	washer .....	0 0 1
664E	number plate (Standard) .....	0 1 6
665E	(Lighting Set) .....	0 2 0
666E	pin .....	0 0 2
667E	nut .....	0 0 1
668E	washer .....	0 0 1
669E	stand .....	0 18 0
670E	pivot bush .....	0 0 2
671E	pin .....	0 0 3
672E	nut .....	0 0 2
673E	spring washer .....	0 0 1



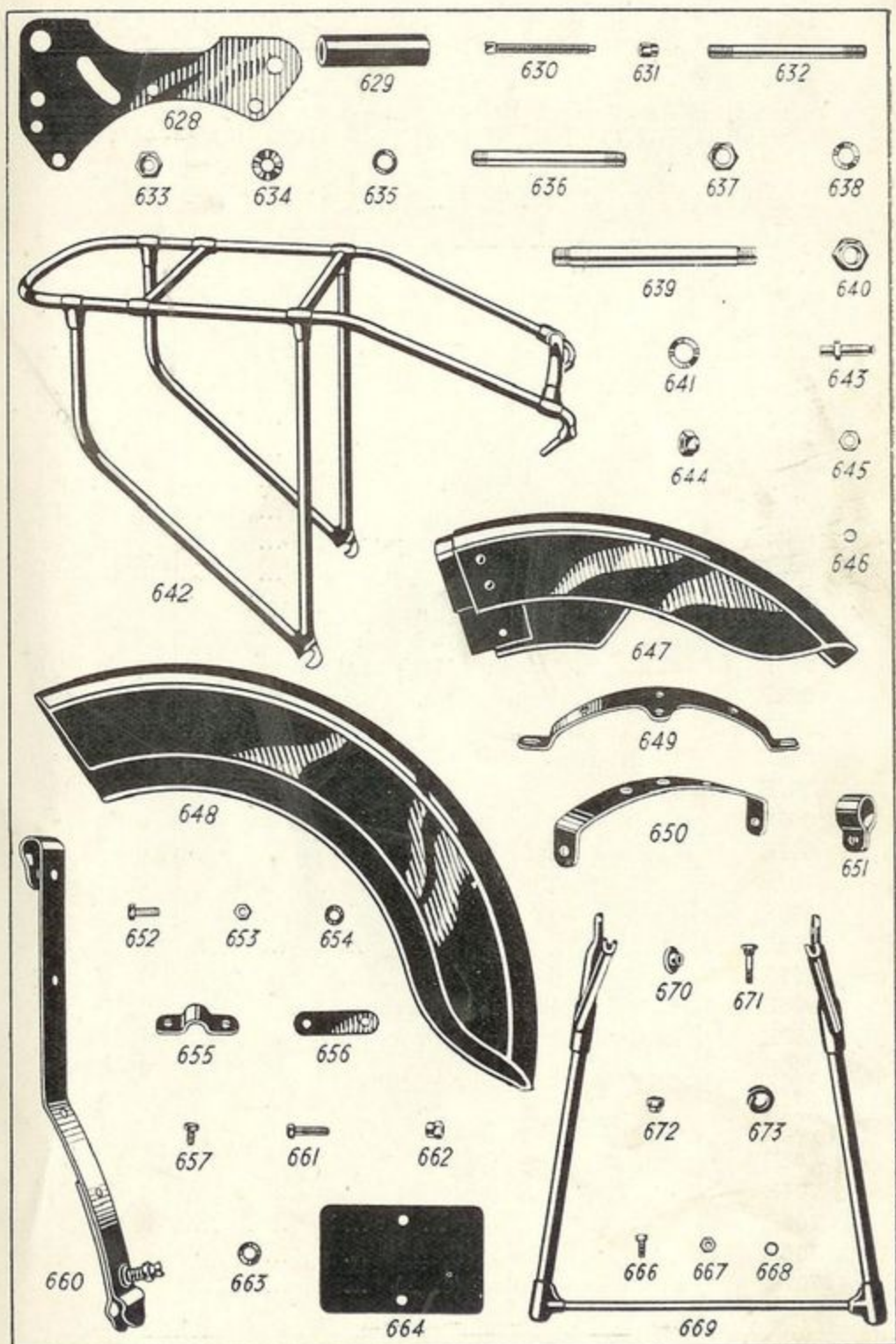

See opposite page for description and price.  
 Order by number with initial "E" added, as shown opposite.

CHAIN COVER, CHAINS AND ENGINE ATTACHMENTS.

Quote this No. and name of part when ordering.	Description.	Price.
		£ s. d.
680E	Chain cover ... ..	1 5 0
681E	" " pin ... ..	0 0 2
682E	" " top clip ... ..	0 0 6
683E	" " " " pin ... ..	0 0 2
684E	" " " " " nut... ..	0 0 1
685E	" " rear attachment pin ... ..	0 0 2
686E	" " " " " spring washer	0 0 1
687E	" " front attachment stud ...	0 0 1
688E	" " " " " nut ...	0 0 2
689E	" " " " " washer... ..	0 0 1
690E	Countershaft chain ... ..	0 10 0
691E	Driving chain... ..	0 18 6
692E	Cranked link unit for chains ... ..	0 1 0
693E	Magneto chain ... ..	0 2 0
694E	" sprocket and centre ... ..	0 3 6
695E	" base plate ... ..	0 2 6
696E	" " " screw ... ..	0 0 3
697E	" screw ... ..	0 0 2
698E	Sparking plug with waterproof cap... ..	0 6 6
699E	Engine and magneto sprocket ... ..	0 7 6
700E	" " " " key ... ..	0 0 5
701E	" " " " nut... ..	0 0 6
702E	Crankcase stud (long) ... ..	0 0 6
703E	" " (short) ... ..	0 0 6
704E	" " (bottom) ... ..	0 0 4
705E	" " nut ... ..	0 0 2
706E	" " washer ... ..	0 0 1
707E	Front engine plate (each) ... ..	0 2 6



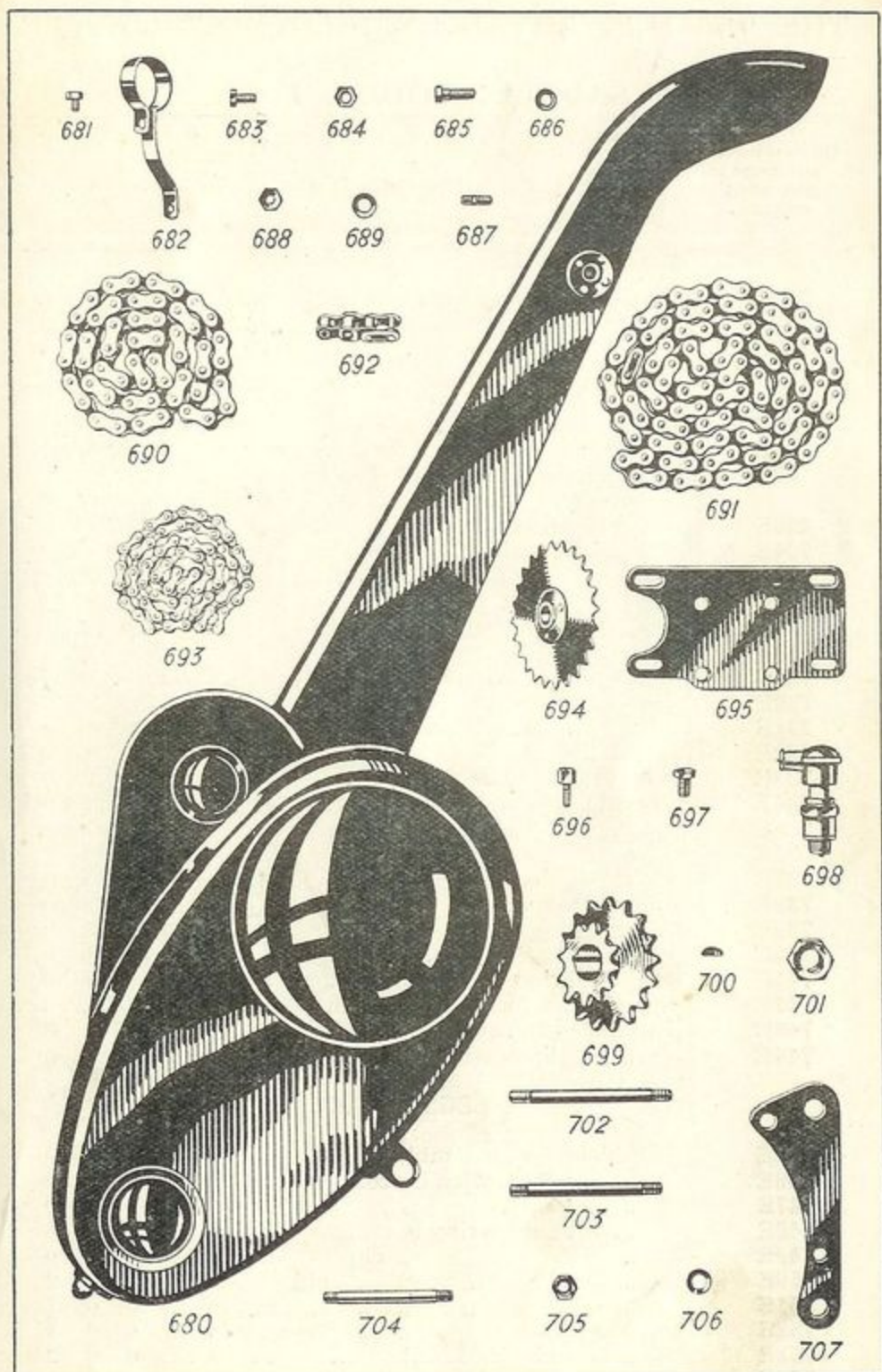

See opposite page for description and price.  
 Order by number with initial "E" added, as shown opposite.

THE 9.76 H.P. ROYAL ENFIELD MOTOR CYCLE

SADDLE, TOOLS, Etc.

Quote this No. and name of part when ordering.	Description.	Price.
		£ s. d.
715E	Saddle complete with springs ... ..	2 5 0
716E	" pivot pin ... ..	0 0 3
717E	" " " nut ... ..	0 0 2
718E	" rear spring ... ..	0 3 0
719E	" " " bolt ... ..	0 0 2
720E	" " " " nut ... ..	0 0 1
721E	" " " " spring washer ... ..	0 0 1
722E	Toolbag complete with clips less } tools ... ..	Fitted 0 7 6
723E	Toolbag clip ... ..	on 0 0 6
724E	" " pin ... ..	Solo 0 0 2
725E	" " " nut ... ..	machines 0 0 1
726E	" " " washer ... ..	only 0 0 1
727E	Tool roll and strap without tools } Tyre lever ... ..	0 2 6
728E	Screw driver ... ..	0 0 6
729E	File ... ..	0 0 7
730E	Pliers ... ..	0 1 6
731E	Pliers ... ..	0 2 0
732E	Valve lifter tool ... ..	0 1 6
733E	Grease gun ... ..	0 6 0
734E	Combination spanner ... ..	0 1 9
735E	Engine " ... ..	0 1 0
736E	Box " ... ..	0 2 4
737E	Double-ended " ... ..	0 1 0
738E	Inlet pipe nut " ... ..	0 2 0
739E	Adjustable " ... ..	0 5 0
740E	Cone " ... ..	0 1 0
741E	" lockring " ... ..	0 1 0
742E	Spanner for fork adjusting nuts ... ..	0 1 0
743E	Inflator ... ..	0 6 3
744E	" clips (per pair) ... ..	0 0 9
<b>LEGSIELDS.</b>		
745E	Legshield set, assembled complete ... ..	0 15 0
746E	" R.H. with bottom clip ... ..	0 5 0
747E	" L.H. " " " ... ..	0 5 0
748E	" supporting bar ... ..	0 1 6
749E	" " " clip ... ..	0 0 6
750E	" " " " pin ... ..	0 0 2
751E	" " " " " nut ... ..	0 0 1
752E	" " " " " washer ... ..	0 0 1
753E	" pin (as 724E) ... ..	0 0 2
754E	" nut (as 725E) ... ..	0 0 1
755E	" spring washer... ..	0 0 1



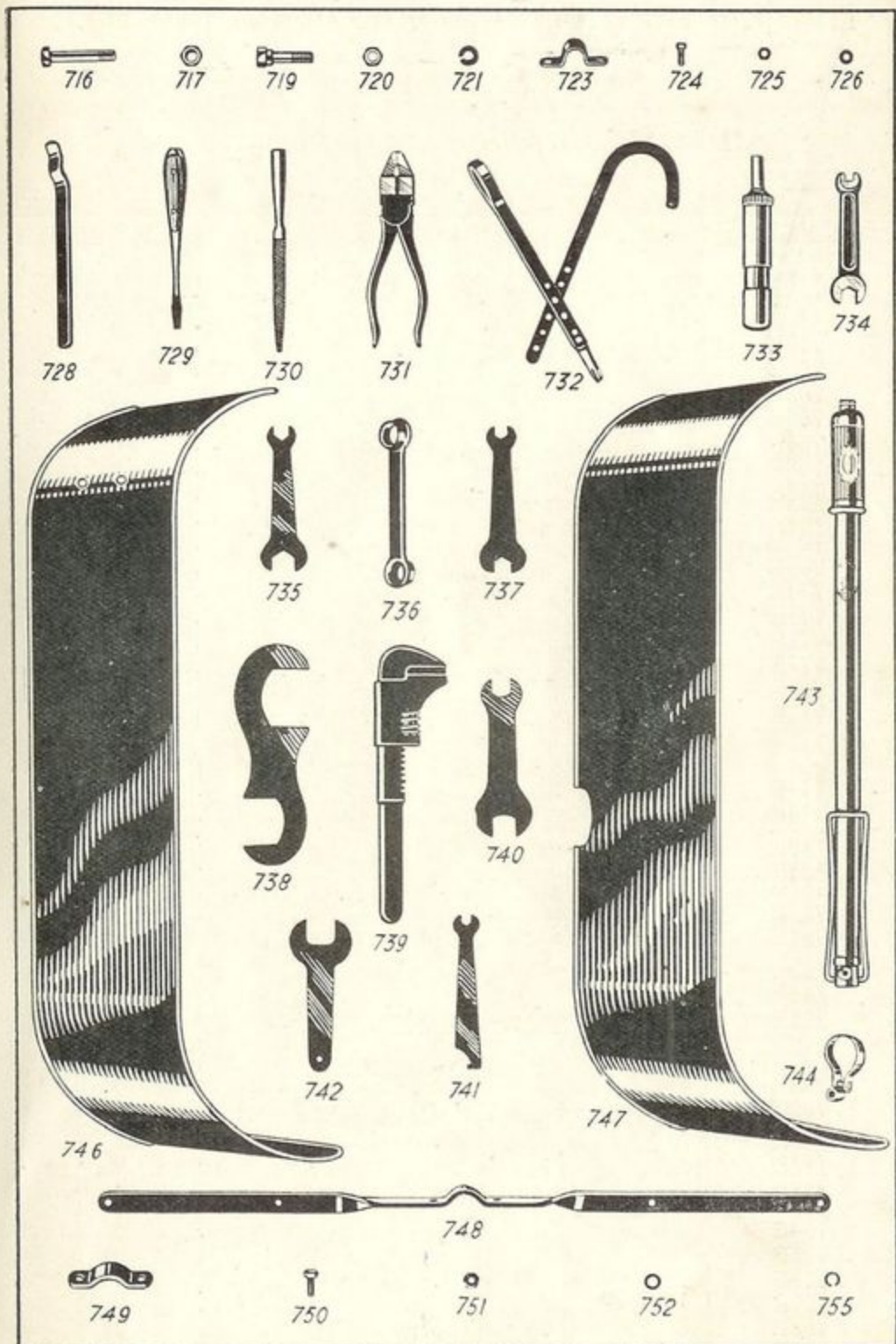

See opposite page for description and price.  
 Order by number with initial "E" added, as shown opposite.

THE 9.76 H.P. ROYAL ENFIELD MOTOR CYCLE

SIDECAR CHASSIS AND FITTINGS.

Quote this No. and name of part when ordering.	Description.	Price.		
		£	s.	d.
760E	Sidecar chassis frame only (Standard)	7	0	0
761E	" " " " (Colonial)	7	0	0
762E	" " stand	0	4	6
763E	" " pin	0	0	4
764E	" " " nut...	0	0	2
765E	" " " washer	0	0	1
766E	" " attachment stud (front)	0	3	6
767E	" " " " (rear)	0	2	9
768E	" " " " nut	0	0	10
769E	" " " " washer	0	0	3
770E	" " tie rod (Standard)	0	9	0
771E	" " " " (Two-seater)	0	9	0
772E	" " " " (Colonial)	0	9	0
773E	" " " " clip	0	3	0
774E	" " " " " bolt (as 763E)	0	0	4
775E	" " " " " " (nut as 764E)	0	0	2
776E	" " " " " " washer (as 765E)	0	0	1
777E	" " " " " pin	0	0	6
778E	" " " " " spring	0	0	1
779E	" " " " " washer	0	0	6
780E	" " " " " eye bolt	0	2	0
781E	" " " " " " nut...	0	0	3
782E	" " " " " " washer	0	0	1
783E	" rear spring, Standard body (3 leaves)	0	15	0
784E	" " " " Two-seater " (4 leaves)	0	18	0
785E	" " " " Sports " (3 leaves)	0	15	0
786E	" " " " clip (Standard)	0	0	9
787E	" " " " " (Two-seater)	0	0	9
788E	" " " " " cap	0	0	9
789E	" " " " " packing piece	0	0	9
790E	" " " " " nut	0	0	2
791E	" " " " " spring washer	0	0	1
792E	" " " " " shackle	0	3	6
793E	" " " " " bolt	0	0	4
794E	" " " " " " nut (as 790E)	0	0	2
795E	" " " " " " washer	0	0	1
796E	" front spring	9	4	6
797E	" " " " plate	0	1	0
798E	" " " " " bolt	0	0	2
799E	" " " " " nut (as 764E)	0	0	2
800E	" " " " " spring washer	0	0	1



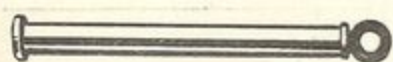

762



763



764



765

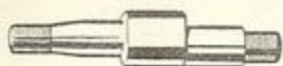

766



767



768



769

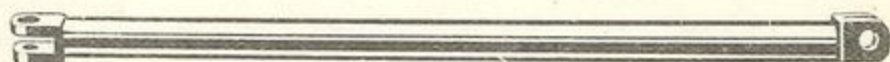

770



773



777



778



779



780



781



782



786



787



788



789

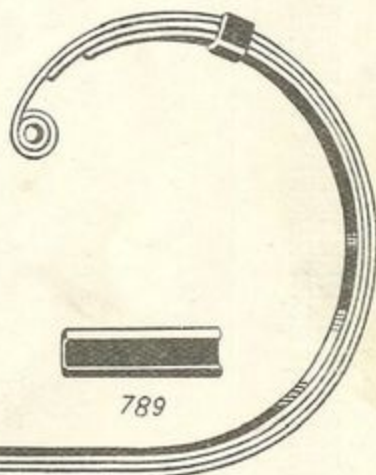

783



790



791

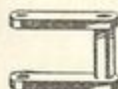

792

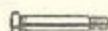

793

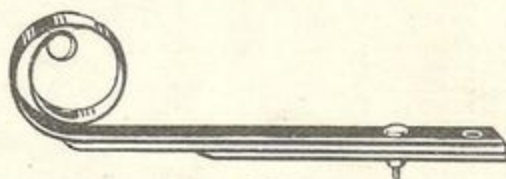

796



797



798



795



800

See opposite page for description and price.  
Order by number with initial "E" added, as shown opposite.

# THE 9.76 H.P. ROYAL ENFIELD MOTOR CYCLE

## SIDECAR SCREENS, MUDGUARD AND ATTACHMENTS.

Quote this No. and name of part when ordering.	Description.	Price.
806E	Sidecar screen complete (Standard) ....	£ 1 10 0
807E	"    "    "    (Sports) ....	1 10 0
808E	"    cushion, Standard and Two-seater....	0 18 6
809E	"    mudguard ....	0 18 0
810E	"    "    stay (front) ....	0 1 0
811E	"    "    "    (middle) ....	0 1 0
812E	"    "    "    (rear) ....	0 1 0
813E	"    "    "    flange (shallow) ....	0 0 3
814E	"    "    "    "    (deep) ....	0 0 3
815E	"    "    distance tube (front) ....	0 1 0
816E	"    "    "    "    (middle) ....	0 1 0
817E	"    "    "    "    (rear) ....	0 1 0
818E	"    "    stay, front and rear ....	0 1 0
819E	"    "    "    (middle) ....	0 1 0
820E	"    "    "    washer ....	0 0 3
821E	"    "    "    flange ....	0 0 3
822E	"    "    distance tube (front) ....	0 1 0
823E	"    "    "    "    (middle) ....	0 1 0
824E	"    "    "    "    (rear) ....	0 1 0
825E	"    "    stay (front) ....	0 1 0
826E	"    "    "    (middle) ....	0 1 0
827E	"    "    "    (rear) ....	0 1 0
828E	"    "    "    flange (as 814E) ....	0 0 3
829E	"    "    "    angle piece (large) ....	0 1 0
830E	"    "    "    "    (small) ....	0 1 0
831E	"    "    distance tube (front) ....	0 1 0
832E	"    "    "    "    (rear) ....	0 1 0
833E	"    "    pin ....	0 0 3
834E	"    "    "    nut ....	0 0 3
835E	"    "    "    washer ....	0 0 1
836E	"    "    stay nut (thick) ....	0 0 3
837E	"    "    "    (thin) ....	0 0 2
838E	"    "    "    washer (as 835E) ....	0 0 1
839E	"    lamp bracket ....	0 3 0
840E	"    "    "    pin ....	0 0 3
841E	"    "    "    nut ....	0 0 1
842E	"    "    "    washer ....	0 0 1
843E	"    body support strut (rear) ....	0 5 0
844E	"    "    "    bolt ....	0 0 4
845E	"    "    "    "    nut ....	0 0 2
846E	"    "    "    "    washer (large) ....	0 0 2
847E	"    "    "    "    spring washer ....	0 0 1
848E	"    "    "    "    packing washer (Standard) ....	0 0 3
849E	"    "    "    "    "    (Two-seater)....	0 0 3
850E	"    "    "    "    nut ....	0 0 2
851E	"    "    "    "    washer ....	0 0 1
852E	"    "    "    "    (front) ....	0 4 0
853E	"    "    "    "    bolt ....	0 0 4
854E	"    "    "    "    nut ....	0 0 2
855E	"    "    "    "    large washer ....	0 0 3
856E	"    "    "    "    spring washer ....	0 0 1



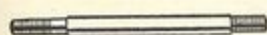

810

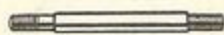

811

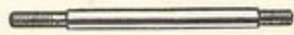

812



813



814

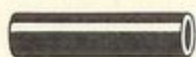

815



816



817

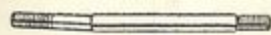

818

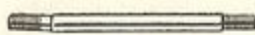

819

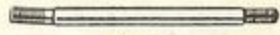

827



820



821

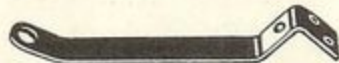

826



830



829



833



834



835



836



837



839



840



841



842

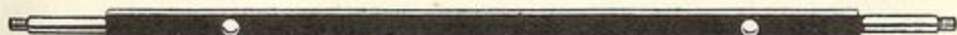

843



844



845



846



847



848



849



850



851

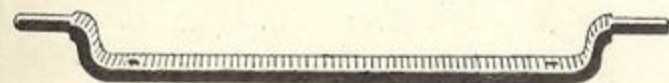

852



853



855



856

See opposite page for description and price.

Order by number with initial "E" added, as shown opposite.





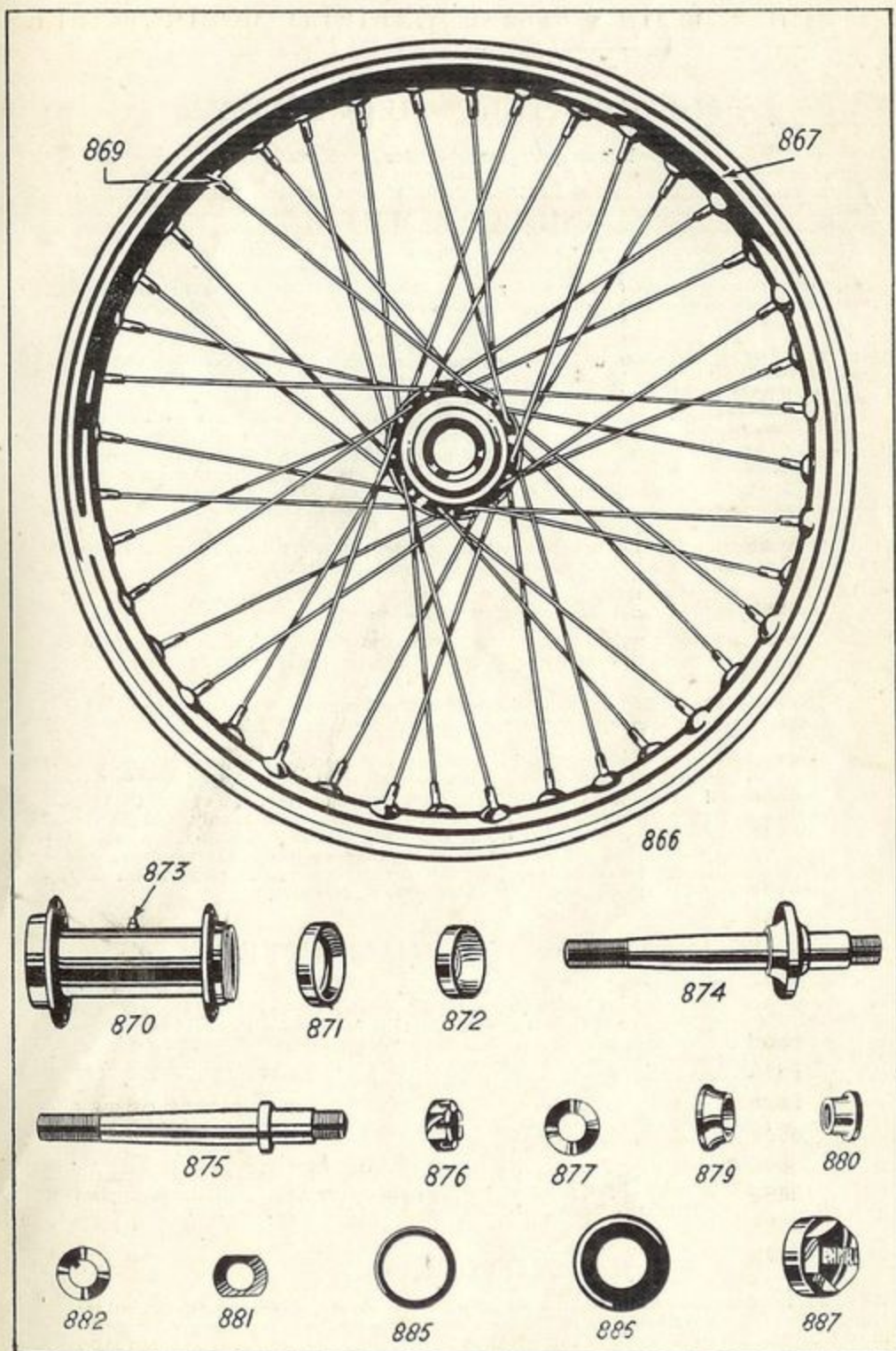

See opposite page for description and price.  
 Order by number with initial "E" added, as shown opposite.



## MOTOR CYCLE GUARANTEE.

Reprinted from our current Motor Cycle Catalogue.

*We give the following guarantee with our Motor Cycles, Motor Cycle Combinations and Sidecars, which is given in place of any implied condition, warranties or liabilities whatsoever, statutory or otherwise, all such implied conditions, warranties and liabilities being in all cases excluded. Any statement, description, condition or representation contained in any catalogue, advertisement, leaflet or other publication shall not be construed as enlarging, varying or overriding this guarantee.*

*In the case of machines which have been used for "hiring-out" purposes, or from which the trade mark name or manufacturing number has been removed, no guarantee of any kind is given or is to be implied.*

**WE GUARANTEE**, subject to the conditions mentioned below, that all precautions which are usual and reasonable have been taken by us to secure excellence of materials and workmanship, but this guarantee is to extend and be in force for six months only from the date of purchase, and damages for which we make ourselves responsible under this guarantee are limited to the free supply of a new part in exchange for the part of the motor cycle, motor cycle combination or sidecar which may have proved defective. We do not undertake to replace or refix, or bear the cost of replacing or refixing, such new part in the motor cycle, motor cycle combination or sidecar. We undertake, subject to the conditions mentioned below, to make good at any time within six months any defects in these respects. As motor cycles, motor cycle combinations and sidecars are easily liable to derangement by neglect or misuse this guarantee does not apply to defects caused by wear and tear, misuse or neglect. The term "misuse" shall include amongst others the following acts:—

1. The attaching of a sidecar to the motor cycle in such a manner as to cause damage or calculated to render the latter unsafe when ridden.
2. The use of a motor cycle or a motor cycle and sidecar combined, when carrying more persons or a greater weight than that for which the machine was designed by the manufacturers.
3. The attaching of a sidecar to a motor cycle by any form of attachment not provided or supplied by the manufacturers or to a motor cycle which is not designed for such use.

Any motor cycle or motor cycle combination or sidecar sent to us to be plated, enamelled, or repaired will be repaired upon the following conditions, *i.e.*, we guarantee that all precautions which are usual and reasonable have been taken by us to secure excellence of materials and workmanship, such guarantee to extend and to be in force for three months only from the time such work shall have been executed or until the expiration of the six months above referred to, and this guarantee is in lieu and in exclusion of any common law or statute warranty or condition, and the damages recoverable are limited to the cost of any further work which may be necessary to amend and make good the work found to be defective.

## CONDITIONS OF GUARANTEE.

If a defective part should be found in our motor cycles, motor cycle combinations or sidecars, or in any part supplied by way of exchange before referred to, it must be sent to us CARRIAGE PAID, and accompanied by an intimation from the owner that he desires to have it repaired or exchanged free of charge under our guarantee, and he must also furnish us at the same time with the number of the machine, the date of the purchase, or the date when the alleged defective part was exchanged as the case may be.

Failing compliance with the above, such articles will lie here AT THE RISK OF THE OWNER, and this guarantee and any implied guarantee, warranty or condition shall not be enforceable.

We do not guarantee specialities such as tyres, saddles, chains, lamps, etc., or any component parts supplied to the order of the purchaser differing from standard specifications supplied with our motor cycles, motor cycle combinations, sidecars or otherwise.

## NOTICE.

We do not appoint agents for the sale on our behalf of our motor cycles or other goods, but we assign to motor cycle Dealers areas in which we supply to such Dealers exclusively for re-sale in such areas. No such Dealer is authorised to transact any business, give any warranty, make any representation or incur any liability on our behalf.



