

# LIST OF SPARE PARTS

FOR

# ROYAL ENFIELD

## MOTOR CYCLES

248 c.c. MODELS B, S and S2, also  
346 c.c. MODEL C.

Issued December 1st, 1936.

PRICE 1/-

Barnstormers Co. Nz

Barnstormers Co. Nz

December 1st, 1936.

A LIST OF  
Spare and Replacement Parts for  
**ROYAL ENFIELD**  
MOTOR CYCLES

248 c.c. MODELS B, S and S2,  
also 346 c.c. MODEL C.

---

*Compiled and Published by*  
**THE ENFIELD CYCLE Co., LTD.**  
**REDDITCH.**

Telegrams—"Cycles, Phone, Redditch." Telephone—Redditch 121 (5 lines).

**LONDON SHOWROOMS:**  
48, HOLBORN VIADUCT, E.C.1.

Telegrams—"Jigger, Cent, London."  
Telephone Nos. 5822 and 5823 Holborn.

**LONDON SERVICE DEPOT:**  
49, FARRINGDON STREET, E.C.4.

Telephone No. 2508 Holborn.

---

*Contractors to H.M. Government, the French and Belgian  
Governments, and the former Russian Imperial  
Military Authorities.*

## ROYAL ENFIELD MOTOR CYCLES.

---

All prices of Spare and Replacement Parts are subject to revision or modification, at our discretion, without notice.

Our terms are STRICTLY NET CASH WITH ORDER, or cash on receipt of PRO-FORMA INVOICE. Repairs and sundries items cannot be booked. Prices do not include cost of carriage or postage.

Any part or complete motor cycle sent for repair should be consigned CARRIAGE PAID and the sender's name and address should be given in full on the address tally. Parts sent to us carriage forward are liable to be refused, and to lie with the carriers at sender's risk and expense.

Full instructions regarding the necessary repairs to be done, with advice as to the mode of despatch of the machine (or part), should be posted the same day.

When forwarding motor cycles for repair it is advisable to remove all accessories and easily detached fittings, such as lamp, horn, toolbags, etc. Besides facilitating the work of repair, it will also prevent any loss during transit.

Order all parts by the name of the article and the NUMBER PRECEDING IT, also state the number of the engine or machine for which they are intended. The engine number will be found stamped on the crank case and the machine number at the top of the front down tube.

### GUARANTEE.

We respectfully refer customers to the terms of our guarantee which appears on page 36 of this list.

When forwarding a complete Motor Cycle, Engine, Carburetter or Magneto with the request that we overhaul the same, we understand by the term "Overhaul" that it is to be entirely dismantled, thoroughly renovated, any worn parts renewed, and put in perfect working order. In case a customer desires only certain parts attended to, full instructions should be given us to that effect, otherwise the cost may be in excess of that anticipated.

### ESTIMATES AND QUOTATIONS.

When customers send complete Motor Cycles or parts thereof to us for repairs, we are always prepared to furnish estimates before proceeding with the necessary work. At the same time, it must be distinctly understood that we can only give approximate quotations. Frequently, when the actual work is in progress, it is found necessary to replace parts other than those specified in the estimate, as we make a practice of including in such estimates only those items and parts which at the time we consider really essential to put the machine (or parts) in a thoroughly satisfactory condition.

If any estimate prepared in this way is not accepted, we reserve the right to make a nominal charge for taking down and re-assembling any parts necessary in preparing it.

We cannot hold ourselves responsible for loss of, or damage to, any parts lying at our works for repairs, unless instructions to proceed with same are given within twenty-one days of our estimate for the said repairs having been rendered.

All acetylene-welded repairs to crank cases and other aluminium parts are carried out with extreme care, but we cannot give any guarantee with, or accept responsibility for, any parts so treated.

# ROYAL ENFIELD MOTOR CYCLES.

## ROYAL ENFIELD ENGINES.

Illustration No.	Quote this No. and name of part when ordering.	Description.	Price.
1	23460	Crankcase (timing side), Model S. ... ..	£ s. d.
	23543	" " " " S.2 ... ..	
	23583	" " " " B. ... ..	
	23544	" " " " C. ... ..	
	23461	(driving side), Models S., S2 and B. ... ..	
	23542	Model C. ... ..	
2	16291	bearing bush (timing side) ... ..	
3	21187	roller race (timing side) ... ..	
4	21189	" cage (timing side) ... ..	
5	23515	" race (driving side) ... ..	
6	23588	" cage (driving side) ... ..	
	SE.342	" (per doz.) ... ..	
7	21191	bearing end washer ... ..	
	21448	" thrust washer... ..	
8	20777	cylinder stud, Models S., S2 and B. ... ..	
	8703	" " Model C. ... ..	
	15582	" " nut ... ..	
9	13918	oil plug and filter ... ..	
	14548	" " washer... ..	
10	13919	" filter stud ... ..	
11	13995	" " gauze ... ..	
	19570	" filler cap ... ..	
	18275	" " collar ... ..	
12	22198	non return valve ... ..	
13	22199	plug spring ... ..	
	<sup>3</sup> / <sub>16</sub> " dia.	" " ball ... ..	
	22213	union for rocker lubricating pipe ... ..	
14	21741	Tappet (inlet) ... ..	} Models S.&S.2
	21742	(exhaust) ... ..	
15	20654	" guide (inlet) ... ..	} Model B.
	20653	" (exhaust) ... ..	
16	21829	body ... ..	} Model C.
17	15542	head ... ..	
	5976	locknut ... ..	} Model S. & S.2
	19195	(inlet) ... ..	
	19196	(exhaust) ... ..	} Model C.
	19193	guide (inlet) ... ..	
	19194	" (exhaust) ... ..	} Models S. & S.2
	14496	body ... ..	
	19486	head ... ..	} Model C.
	14403	locknut ... ..	
18	23489	" (inlet) ... ..	} Models S. & S.2
	23481	(exhaust) ... ..	
	22614	guide (inlet) ... ..	} Model C.
	22515	" (exhaust) ... ..	
19	20024	Inlet cam with bushes ... ..	} Model S. & S.2
	20025	Exhaust cam with bushes ... ..	
20	19835	Cam bush (long) ... ..	} Model C.
	19836	" (short) ... ..	
21	23505	" spindle ... ..	} Model S. & S.2
22	23479	Timing gear cover ... ..	
	22605	" " joint washer ... ..	} Model C.
23	19555	" " screw (long) ... ..	
	19328	" " (short) ... ..	} Model S. & S.2
24	13754	pinion ... ..	
25	9410	" key ... ..	

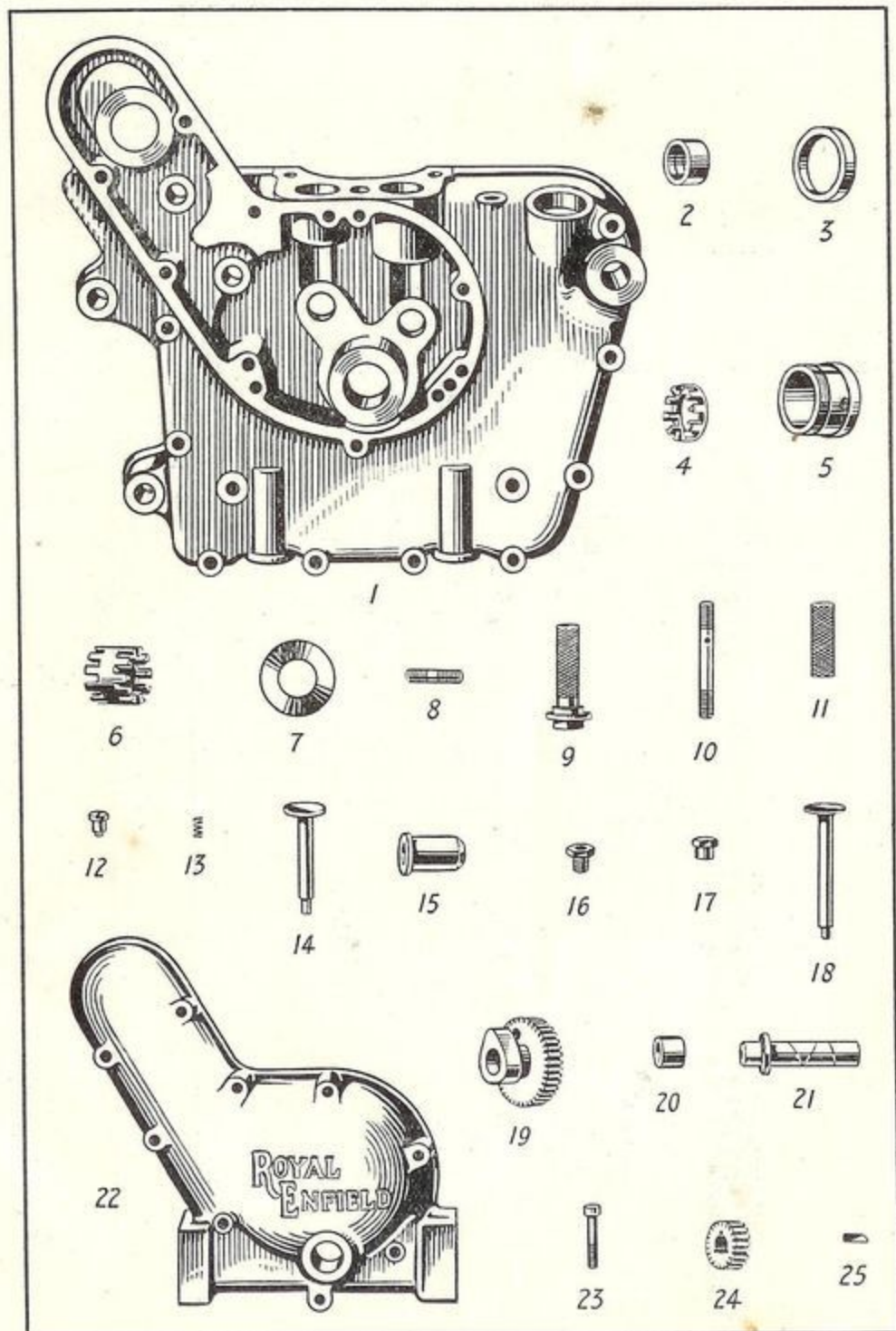

See opposite page for description and price.

Barnstormers Co. Nz

ROYAL ENFIELD MOTOR CYCLES.

ENGINES—*continued.*

Illustration No.	Quote this No. and name of part when ordering.	Description.	Price.		
			£ s. d.		
1	22617	Dynamo drive idler pinion with bush ... ..			
2	21295	" " " " bush ... ..			
3	23506	" " " " spindle ... ..			
	19552	" " " " thrust washer ... ..			
4	20649	" pinion ... ..			
5	22480	" nut... ..	} Models S. & B.		
6	22868	" oil flinger washer... ..			
7	18575	" " " " " " ... ..	} For Magdyno Models S.2 & C.		
8	14538	" nut... ..			
	21423	" felt washer ... ..			
9	18993	" " " retainer ... ..			
10	19352	" " " corrugated washer ... ..			
11	23514	" cradle ... ..			
	19065	" and magdyno dowel ... ..			
12	22651	" strap ... ..			
	22899	" " (for magdyno Models S.2 and C.) ... ..			
13	19068	" trunnion (plain) ... ..			
	19069	" " (tapped) ... ..			
14	19202	" " " stud ... ..			
	12881	" " " nut... ..			
15	23584	" anchor stud (crankcase) ... ..			
	23540	Cylinder barrel with valve guides ... ..	} Model B.		
16	23507	" joint washer ... ..			
	22950	" head ... ..			
17	22225	" joint washer ... ..			
	16278	" stud ... ..			
	19426	" nut $1\frac{1}{2}$ " long ... ..			
	16748	" " $1\frac{1}{4}$ " " ... ..			
	16749	" " 1" " ... ..			
	16714	" plug ... ..			
	16715	" washer ... ..			
18	23535	Cylinder barrel with valve guides ... ..		} Model C.	
	23508	" joint washer ... ..			
	14963	" head ... ..			
	15475	" joint washer ... ..			
	15600	" stud $2\frac{1}{8}$ " long ... ..			
	15601	" " $2\frac{1}{4}$ " " ... ..			
	16748	" nut $1\frac{1}{4}$ " long ... ..			
	16749	" " 1" " ... ..			
	7216	" " $\frac{1}{2}$ " " ... ..			
	23459	" barrel ... ..			
19	23507	" joint washer (paper) ... ..			
	23841	" cover for valve lifter ... ..			
	21869	" joint washer ... ..			
	23839	" stud ... ..			
	17385	" " nut ... ..			
	22217	" " leather washer ... ..			
	23458	" head ... ..			
	21555	" joint washer ... ..	} Models S. & S2		
20	23518	" stud ... ..			
21	23842	" nut ... ..			
	3252	" washer ... ..			
22	21051	" cover ... ..			
23	21664	" joint washer ... ..			
	21468	" stud ... ..			
	22057	" nut ... ..			
	4501	" plain washer ... ..			
	14613	" spring ... ..			





1



2



3



4



5



6



7



8



9



10



11



12



13



14

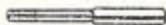

15



16

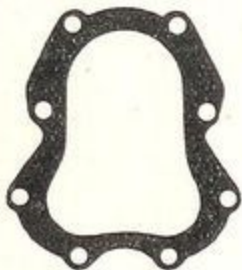

17

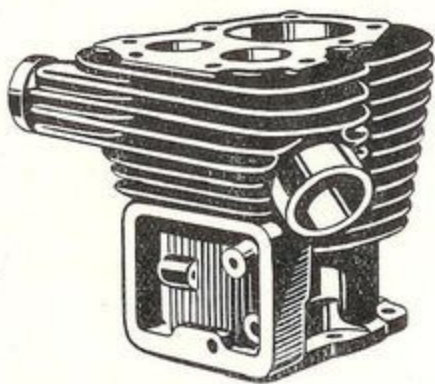

18



19



20



21



22

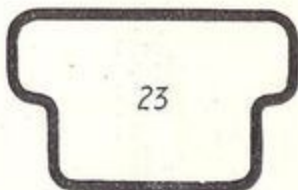

23

See opposite page for description and price.

Barnstormers Co. Nz

# ROYAL ENFIELD MOTOR CYCLES.

## ENGINES—continued.

Illustration No.	Quote this No. and name of part when ordering.	Description.	Price.
			£ s. d.
1	23444	Valve ... ..	...
2	19388	" guide ... ..	...
3	11777	" spring ... ..	...
4	11011	" " collar (top) ... ..	...
5	23703	" " " (bottom) ... ..	...
6	20665	" split collar ... ..	...
7	21737	" spring cover ... ..	...
	21738	" " " joint washer ... ..	...
	21739	" " " stud ... ..	...
	17385	" " " " nut ... ..	...
	22217	" " " " leather washer ... ..	...
	16566	" (inlet) ... ..	...
	15488	" (exhaust) ... ..	...
	13321	" guide ... ..	...
	150097	" spring ... ..	...
	8724	" " collar (top) ... ..	...
	13324	" " " (bottom) ... ..	...
	15489	" split collar ... ..	...
	21832	" spring cover ... ..	...
	21834	" " " joint washer ... ..	...
	21833	" " " stud ... ..	...
	17385	" " " " nut ... ..	...
	22217	" " " " leather washer ... ..	...
8	21835	" lifter ... ..	...
9	21836	" spindle ... ..	...
10	12679	" spring ... ..	...
	21800	" cable nipple ... ..	...
11	22786	" " cover thimble ... ..	...
	21063	" (inlet) ... ..	...
	21064	" (exhaust) ... ..	...
12	21322	" guide ... ..	...
13	21602	" spring (inner) ... ..	...
14	22044	" " (outer) ... ..	...
15	12105	" collar ... ..	...
	11099	" split collar ... ..	...
16	10672	" stem cap ... ..	...
17	23482	" push rod with ends (inlet) ... ..	...
	23483	" " " " (exhaust) ... ..	...
18	23484	" " " " only ... ..	...
19	15916	" " " " end (top) ... ..	...
20	21863	" " " " (bottom, inlet) ... ..	...
21	21864	" " " " (bottom, exhaust) ... ..	...
22	21865	" " " " cup ... ..	...
	"U" Patt.	" " " " locknut ... ..	...
23	23486	Rocker (inlet) ... ..	...
	23487	" (exhaust) ... ..	...
24	23759	" bearing (bottom) ... ..	...
25	21693	" " cap (inlet) ... ..	...
	21694	" " " (exhaust) ... ..	...
	10772	" " " stud ... ..	...
	"T" Patt.	" " " " nut ... ..	...
	9908	" " " " washer ... ..	...
	23984	" lubricating pipe complete ... ..	...
	22213	" " " " union ... ..	...
	5566	" " " " fibre washer ... ..	...
26	21867	Exhaust valve lifter ... ..	...
	21169	" " " spindle ... ..	...
	21800	" " " nipple ... ..	...
	21872	" " " adjuster screw ... ..	...
	3257	" " " " locknut ... ..	...
	21815	" " " " screw return spring ... ..	...

Model B.

Model C.

Models S. & S.2

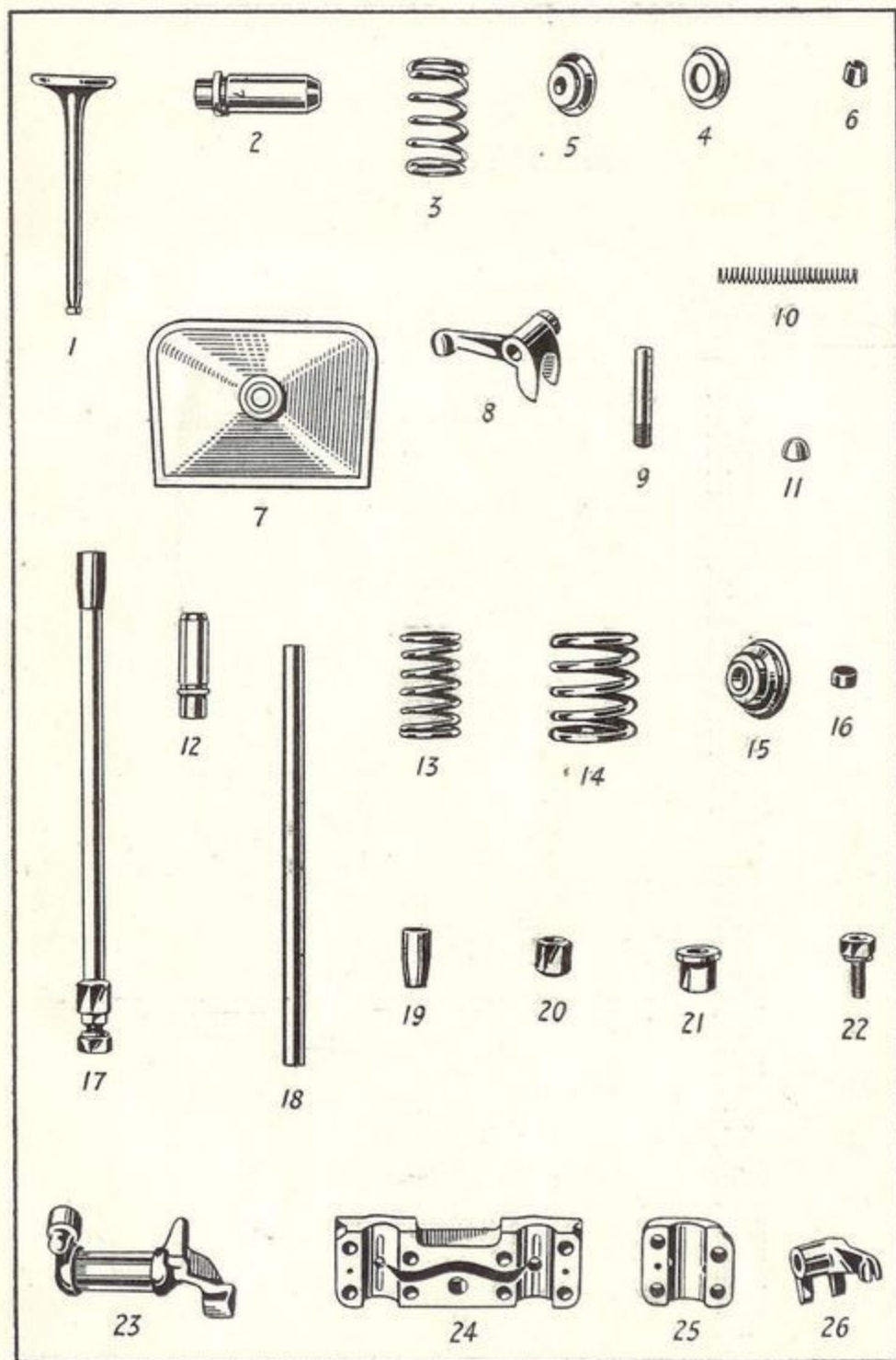

See opposite page for description and price.

# ROYAL ENFIELD MOTOR CYCLES.

## ENGINES—continued.

Illustration No.	Quote this No. and name of part when ordering.	Description.	Price.
			£ s. d.
1	22990	Piston, Model B. (complete with rings and gudgeon pin) ...	
	21575	" Models S. & S.2 (complete with rings and gudgeon pin)	
2	12893	" ring ... ..	
	23858	" (scraper) ... ..	
3	22865	Gudgeon pin ... ..	
4	20363	" keeper ring ... ..	
	13476	Piston (complete with rings and gudgeon pin) ...	
	12375	" ring ... ..	
	23859	" scraper ... ..	
	8663	Gudgeon pin ... ..	
5	13236	" pad ... ..	
6	21346	Connecting rod with bushes	
7	21249	" " small end bush ... ..	
	21347	" " large end bush ... ..	
	16913	" " with bushes	
	11710	" " small end bush ... ..	
8	16910	" " large end bush ... ..	
	S.E.342	" bearing roller, per doz. ... ..	
9	16909	Crank pin ... ..	
	141545	" nut ... ..	
10	23587	Driving shaft ... ..	
	141545	" nut ... ..	
11	145633	" key ... ..	
12	21344	Flywheel (timing side), Models B., S. & S.2	
	23536	" Model C.	
	21343	" (driving side), Models B., S. & S.2	
	23537	" Model C.	
13	21454	Timing shaft ... ..	
	141545	" nut ... ..	
	8718	Keeper screw for shaft nuts	
14	13917	Oil pump worm ... ..	
15	22619	" spindle ... ..	
16	22135	" disc (feed) ... ..	
	14462	" (return) ... ..	
17	7326	" spring ... ..	
	22134	" plunger (feed) ... ..	
	14461	" (return) ... ..	
18	14456	" cover ... ..	
	14786	" washer ... ..	
	8189	" screw ... ..	
19	13958	" feed plug ... ..	
	12581	" washer ... ..	
	16704	" cork washer ... ..	
20	21438	Engine sprocket 16T, Model B.	
	21439	" 17T, Models S. & S.2	
	21440	" 18T, Model C.	
	23202	" nut ... ..	
	145633	" key ... ..	
21	23569	Induction pipe, Models B., S. & S.2	
	23868	" Model C.	
	8701	" locknut ... ..	

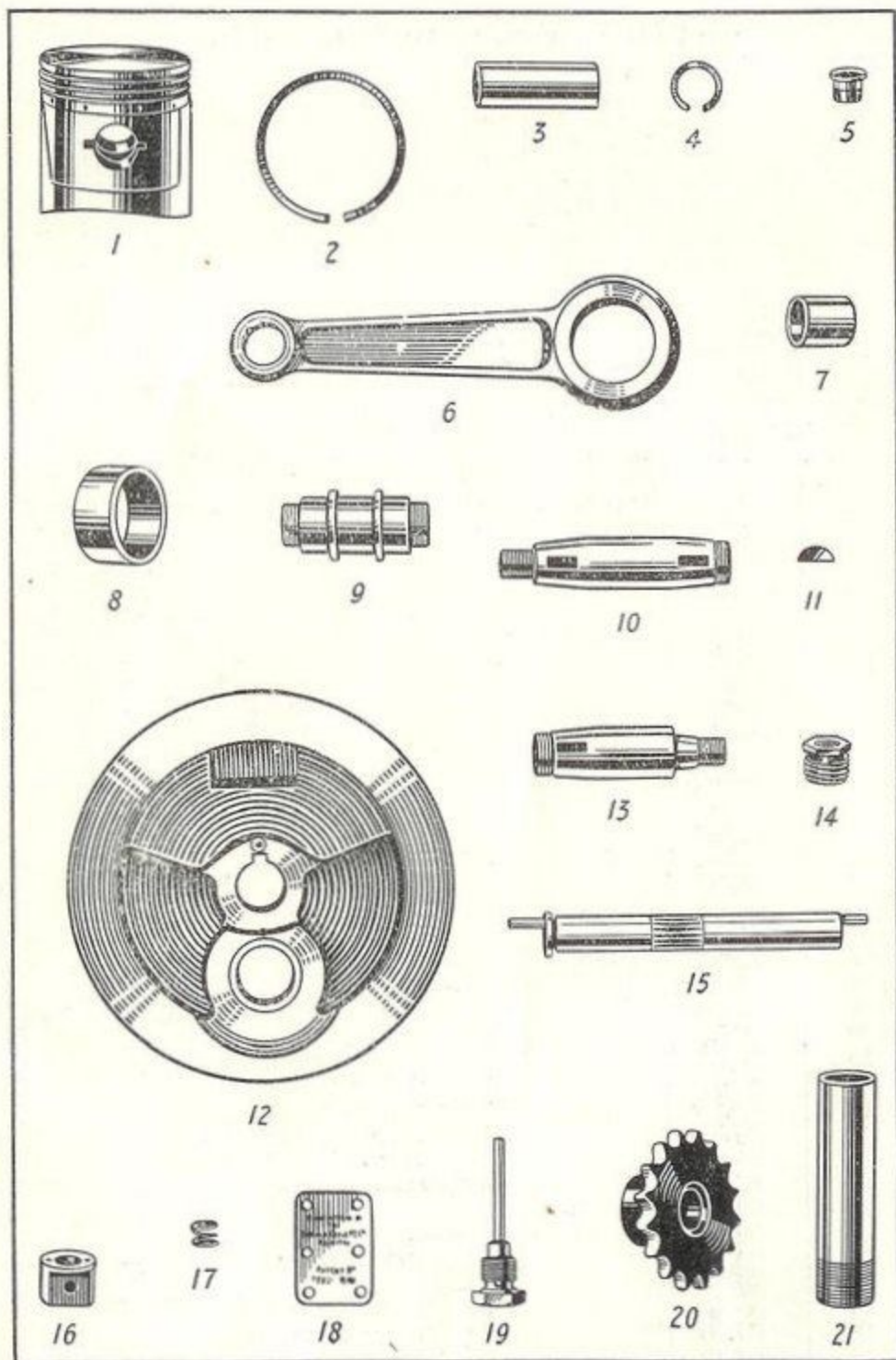

See opposite page for description and price.

ROYAL ENFIELD MOTOR CYCLES.

FOUR-SPEED GEARBOX.

Illustration No.	Quote this No. and name of part when ordering.	Description.	Price.
			£ s. d.
1	23985	Gearbox cover	
	HJ.54A	" " bolt (long)	
	HJ.54B	" " " (short)	
2	23986	" case	
	F.13	" felt washer	
3	F.14	" dished washer	
	9959	" attachment stud (top)	
	7598	" " " nut	
	15511	" " " locking collar	
	16283	" " " (bottom) Models S. and B.	
	22698	" " " (bottom) Models S.2 and C.	
	8350	" " " nut	
	8351	" " " washer	
4	22692	" adjusting pin	
5	22691	" " " trunnion	
	"D" Patt.	" " " locknut	
6	23987	Mainshaft	
7	F.15	" ball race $2\frac{1}{4}'' \times 1'' \times \frac{5}{8}''$	
8	F.16	" " " $35 \times 15 \times 11\text{m/m}$	
9	HJ.8	" sleeve	
10	HJ.9	" 15T high gear pinion	
11	HJ.11	" 21T $\times$ 18T sliding gear	
12	HJ.12	" 26T low gear pinion	
	HJ.55	" nut (R.H. thread)	
	HJ.56	" " (L.H. thread)	
	HJ.57	" spring washer	
13	HJ.13	Layshaft	
14	HJ.14	" bush (case end)	
15	HJ.15	" " (footstart end)	
	HJ.15A	" washer	
16	HJ.17	" 16T low gear pinion	
17	HJ.18	" 21T second gear pinion	
18	HJ.19	" 24T third gear pinion	
19	HJ.20	" 27T high gear and footstart wheel	

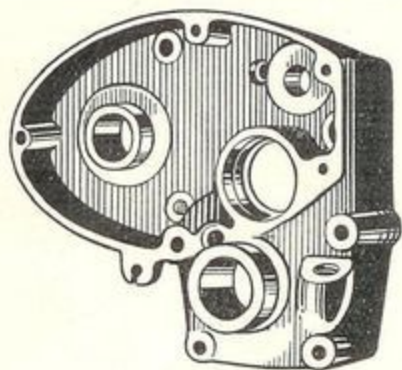

1

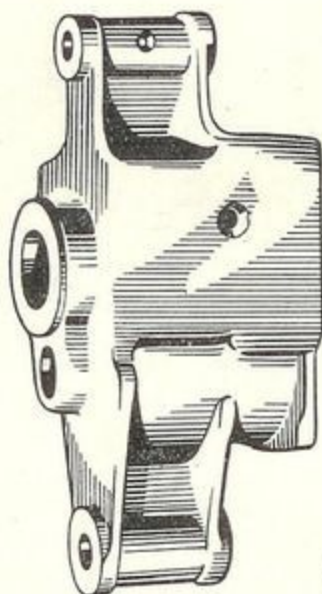

2



3



4



5



7



8



9



6



10



11



12

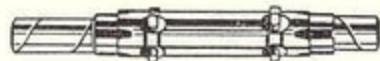

13



14



15

16



17



18



19



See opposite page for description and price.

Barnstormers Co. Nz

# ROYAL ENFIELD MOTOR CYCLES.

## FOUR-SPEED GEARBOX—*continued.*

Illustration No.	Quote this No. and name of part when ordering.	Description.	Price.
			£ s. d.
1	HJ.21	Footstarter sleeve	
2	HJ.22	"    pawl	
3	HJ.22A	"    "    plunger	
4	HJ.23	"    "    "    spring	
5	HJ.25	"    "    stop plate	
6	HJ.26	"    "    "    locating pin	
7	HJ.27	"    shaft bush	
8	E.137	"    return spring	
9	E.138	"    "    cover	
	G.42	"    crank	
10	G.43	"    "    cotter pin nut and washer	
11	HJ.33	Operator (inside)	
12	HJ.34	"    fork	
13	HJ.36	"    anchor pin	
14	H.62	"    locating plunger	
15	H.63	"    "    "    spring	
16	HJ.61	"    "    "    "    box	
17	HJ.59	Cover plate	
	H.60	"    "    pins, each	
18	E.1/33	Final drive sprocket, 16T	
19	F.146	"    "    nut	
20	H.1A/35	Control cover	
21	FC.1/35	"    ratchet (male)	
22	FC.4/34	"    "    (female)	
23	FC.44	"    "    operating pin	
24	FC.55	"    "    "    bush	
25	FC.51	"    "    spring	
26	FC.41	"    adjuster plate	
	FC.43	"    "    "    pin	
	FC.58	"    "    "    nut	
27	FC.45	"    "    spring stop	
28	FC.53	"    plate	
29	FC.46	"    "    spring stop	
30	FC.54	"    "    "    bush	
31	FC.42	"    stop plate and spring retainer	
32	FC.47	"    operator shaft with lever	
33	FC.6	"    "    "    bush	
34	FC.50	"    "    "    "    (outer)	
35	FC.24	"    "    "    securing pin	
36	FC.56	"    gear indicator	
37	FC.48	"    lever (short, inside)	
38	FC.52	"    "    return spring	
	FC.30	"    foot lever	
	FC.30A	"    "    clip bolt	
39	FC.49	"    "    fulcrum pin	



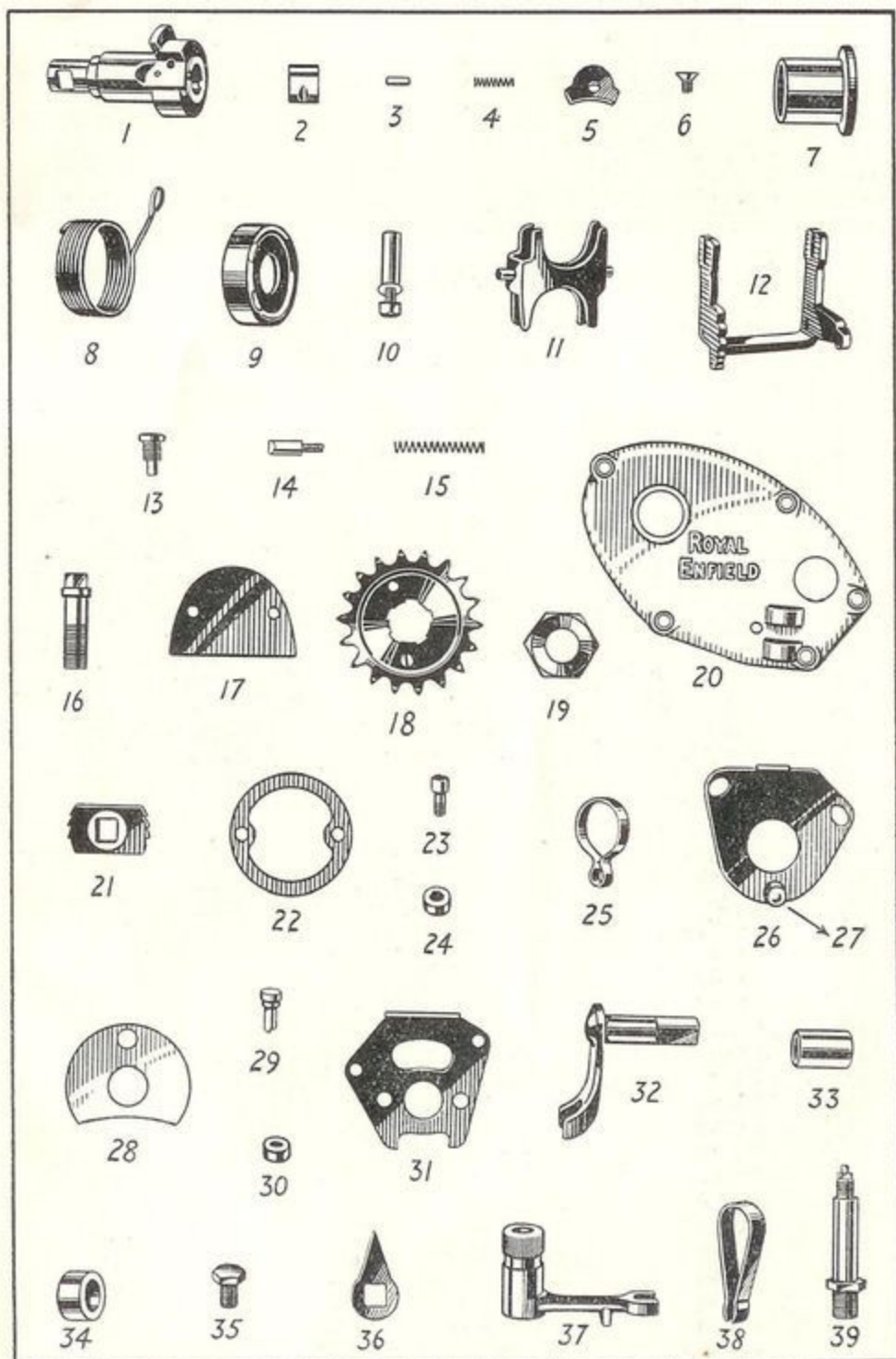

See opposite page for descriptions **Barristormers Co. Nz**

# ROYAL ENFIELD MOTOR CYCLES.

## CLUTCH.

Illustration No.	Quote this No. and name of part when ordering.	Description.	Price.
1	E.153	Clutch sprocket complete	£ s. d.
2	F.168	back plate	
2	F.159	centre drum	} complete
2	F.168bd	stud	
3	E.154	ball retaining washer and rivets	
3	E.158	balls, set	
4	E.157	stud distance pieces (set of 3)	
4	F.183	corks, set	
5	F.169	centre	
6	F.177	front plate	
7	F.178	spring, each	
8	F.180	" screw	
9	E.159	cork insert plate	
10	F.175	intermediate plate	
11	F.179	cap	
12	F.179A	" plate	
12	F.179D	" " pin	
13	H.J.66	operating rod and pad	
14	E.141	" lever	
15	E.142	" " adjusting screw & nut	
15	E.143	" " " " cotter	
16	F.1/70	rubber segments (set)	

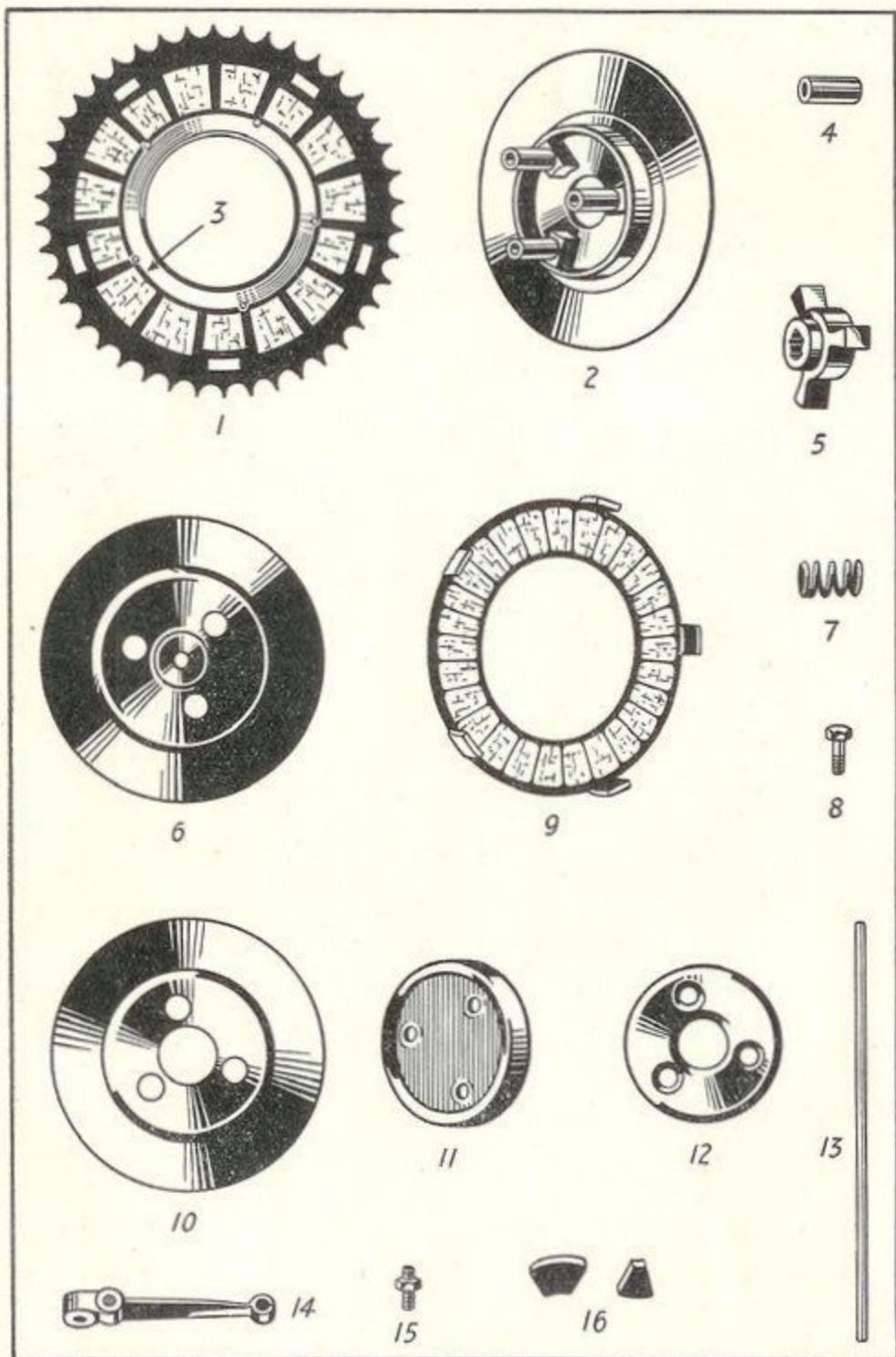

See opposite page for description and price.

Barnstormers Co. Nz

# ROYAL ENFIELD MOTOR CYCLES.

## HANDLEBAR AND PETROL TANK.

Illustration No.	Quote this No. and name of part when ordering.	Description.	Price.
			£ s. d.
	22237	Handlebar only (enamelled black) ....	
	22238	" " (chromium plated) ....	
	22239	" rubber grips (per pair) ....	
1	22240	" twist grip only ....	
2	22348	" " " cable stop ....	
3	23966	" attachment clip ....	
4	18250	" " " bolt ....	
	"D" Patt.	" " " nut	Models S. & B.
	14611	" " " washer	
5	12240	" " " stud	
	11509	" " " nut	
	13886	" " " washer	
6	14981	Front brake cable adjusting screw ....	
7	14980	" " " nut ....	
	10212	" " " nipple (brake end) ....	
8	9283	Clutch cable adjusting screw ....	
	"U" Patt.	" " " locknut	
	23807	Petrol tank only, black ....	
	23807	" " plated ....	
	15941	" " filler cap ....	
9	11282	" " attachment pin ....	
	* 5025	" " " washer	
	14785	" " rubber buffer ....	
10	20292	" tap and filter complete ....	
	5662	" fibre washer ....	
	23988	" pipe complete ( <i>state Model required</i> ) ....	
11	23989	" tank "U" connection pipe ....	
12	7605	" " " " union ....	
	5662	" " " " fibre washer	
13	24217	Knee grip (R.H.) with plate ....	
	24218	" " (L.H.) " " ....	
14	24145	" " pin ....	

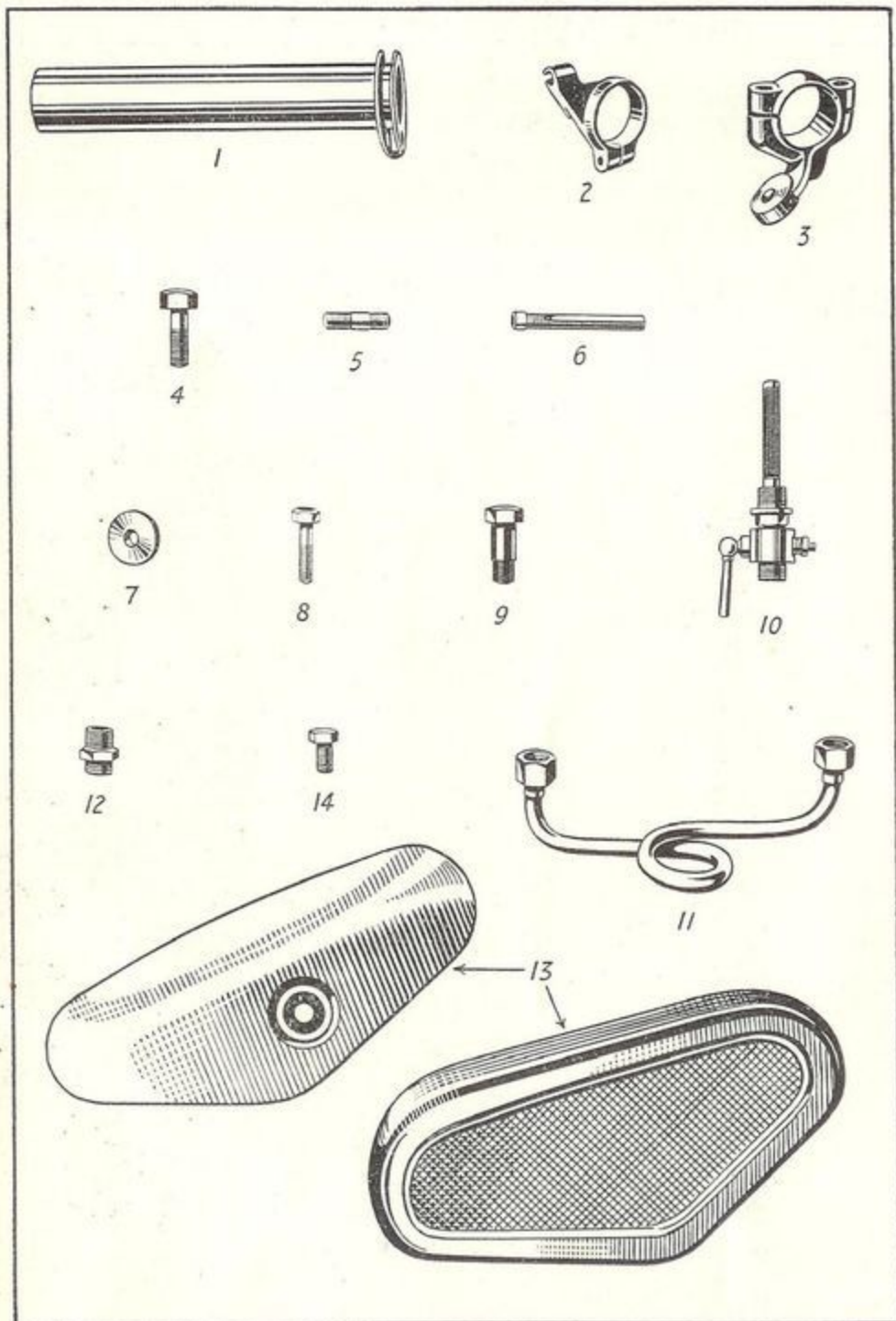

See opposite page for description **Barnstormers Co. Nz**

# ROYAL ENFIELD MOTOR CYCLES.

## FRONT FORK AND FRONT MUDGUARD (Models S. and B.).

Illus- tration No.	Quote this No. and name of part when ordering.	Description.	Price.
			£ s. d.
	18063	Front fork side (R.H.) ... ..	
	18064	" " " (L.H.) ... ..	
	20745	Spring ... ..	
1	15292	" pin ... ..	
	"A" Patt.	" nut ... ..	
	14612	" washer ... ..	
2	20357	Top link ... ..	
3	20336	" swivel pin ... ..	
4	17420	" " " adjusting nut ... ..	
	17421	" " " locknut ... ..	
5	17391	Ball head clip (top) ... ..	
	18041	" " " swivel pin ... ..	
	8712	" " " nut ... ..	
6	17392	" " " (bottom) ... ..	
	7821	" ball race ... ..	
7	$\frac{3}{16}$ " dia.	" balls (per doz.) ... ..	
	10201	" locknut ... ..	
8	13459	Bottom link (R.H. thread) ... ..	
	13460	" " (L.H. " ) ... ..	
	20337	" swivel pin ... ..	
9	18067	Shock absorber fixed disc ... ..	
	18257	" " " " pin ... ..	
	"T" Patt.	" " " " nut ... ..	
	18294	" friction disc ... ..	
10	13414	" spring ... ..	
	14279	" nut (R.H. thread) ... ..	
	14280	" (L.H. thread) ... ..	
11	18293	" anchor plate ... ..	
12	20268	Centre barrel ... ..	
13	20271	Steering stem and crown ... ..	
14	7820	" ball race ... ..	
	7821	" " " top ... ..	
	20338	Crown swivel pin ... ..	
	7732	" nut (R.H. thread) ... ..	
	7733	" (L.H. " ) ... ..	
	14464	" distance washer ... ..	
	20632	" rubber buffer ... ..	
	P.Z.6	Grease nipple (straight) ... ..	
	P.Z.65	" (angled) ... ..	
15	17796	Lamp bracket (R.H.) ... ..	
	17797	" (L.H.) ... ..	
	20606	" strut ... ..	
	251	" pin ... ..	
	"F" Patt.	" nut ... ..	
	14610	" washer ... ..	
	21814	Front mudguard ... ..	
	F.264	" attachment pin ... ..	
	"U" Patt.	" nut ... ..	
	14610	" washer ... ..	
	20811	" number plate ... ..	
	5170	" clip ... ..	
	5171	" screw ... ..	
	351	" washer ... ..	

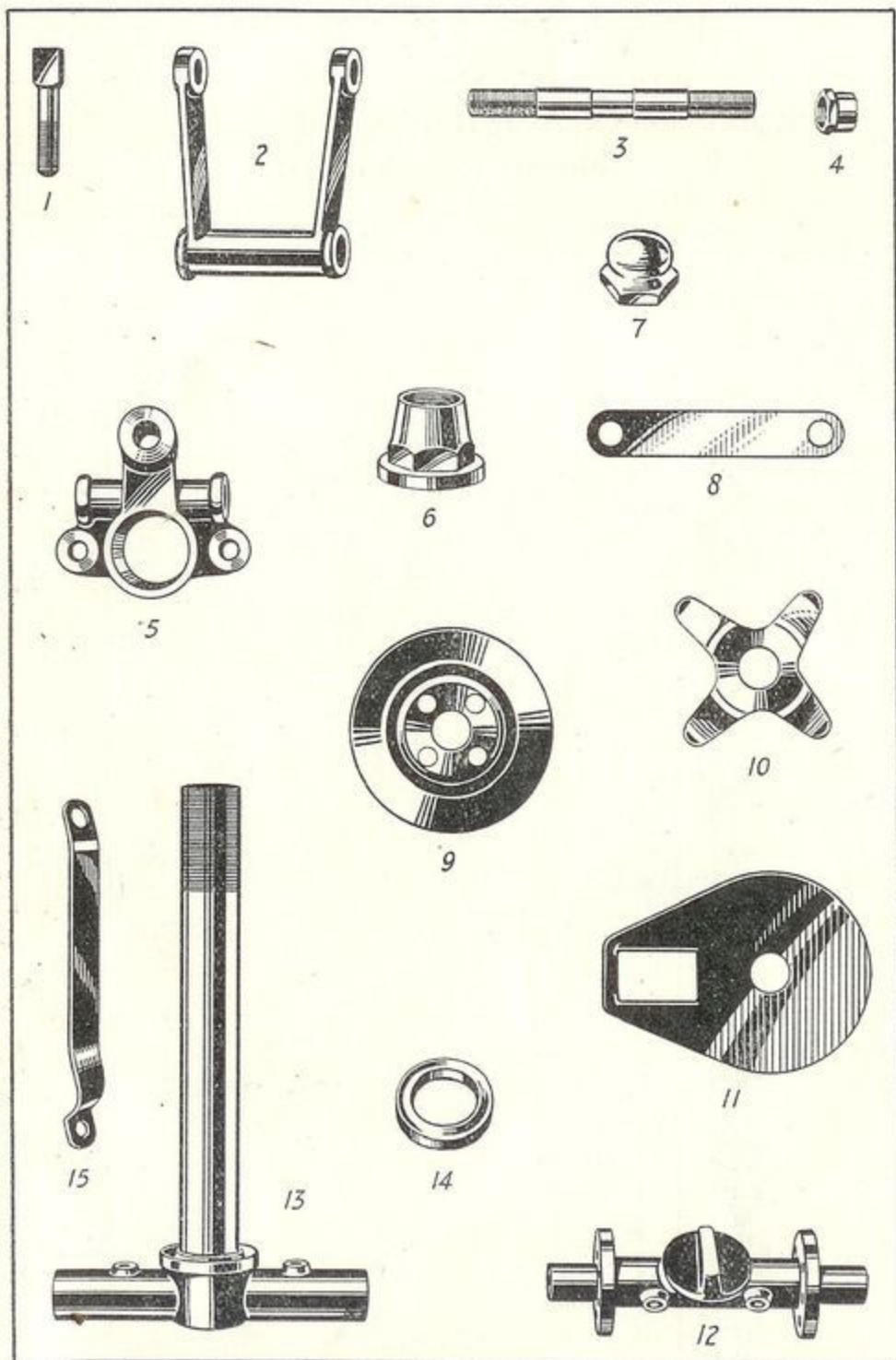

See opposite page for descriptions and prices. **Barnstormers Co. Nz**

# ROYAL ENFIELD MOTOR CYCLES.

## FRONT FORK AND FRONT MUDGUARD (Models S.2 and C.).

Illus- tration No.	Quote this No. and name of part when ordering.	Description.	Price.
			£ s. d.
1	20237	Front fork ... ..	
2	20646	Spring ... ..	
	15292	" pin ... ..	
	"A" Patt.	" nut ... ..	
	14612	" washer ... ..	
3	11848	Top link (R.H. thread) ... ..	
	11849	" (L.H. thread) ... ..	
	19120	Bottom link (R.H. thread) ... ..	
	19121	" (L.H. thread) ... ..	
4	11855	Swivel pin (top) ... ..	
	15733	" (bottom) ... ..	
	15732	" (crown) ... ..	
5	7732	" nut (R.H. thread) ... ..	
	7733	" (L.H. thread) ... ..	
	13239	Shock absorber friction disc ... ..	
6	13414	" spring ... ..	
7	14414	" anchor plate ... ..	
	14279	" nut (R.H. thread) ... ..	
	14280	" (L.H. thread) ... ..	
8	13436	" fixed disc ... ..	
	10188	" screw ... ..	
9	22242	Steering stem and crown ... ..	
10	7820	" ball race ... ..	
	19122	Crown distance washer ... ..	
	20632	" rubber buffer ... ..	
11	15700	Pall head clip (top) ... ..	
12	7822	" (bottom) ... ..	
	9655	" bolt ... ..	
	"A" Patt.	" nut ... ..	
	8134	" washer ... ..	
	7821	" ball race ... ..	
	$\frac{3}{16}$ " dia.	" balls, per doz. ... ..	
	10201	" locknut ... ..	
	P.Z.6	Grease nipple (straight) ... ..	
	P.Z.63	" (angled) ... ..	
13	15219	Handlebar lug ... ..	
	15253	" pin (long) ... ..	
	11509	" nut ... ..	
	5973	" washer ... ..	
	15632	" (short) ... ..	
	14611	" spring washer ... ..	
14	16225	Lamp stay (top) ... ..	
	16226	" (bottom) ... ..	
	10218	" pin ... ..	
	"U" Patt.	" nut ... ..	
	21833	Front mudguard complete ... ..	
	7201	" pin (long) ... ..	
	251	" (short) ... ..	
	"F" Patt.	" nut ... ..	
	14610	" washer ... ..	
	12405	" packing collar ... ..	
	20811	" number plate ... ..	
15	14904	" clip ... ..	
16	14906	" nut ... ..	
	14905	" packing piece ... ..	
	5171	" screw ... ..	



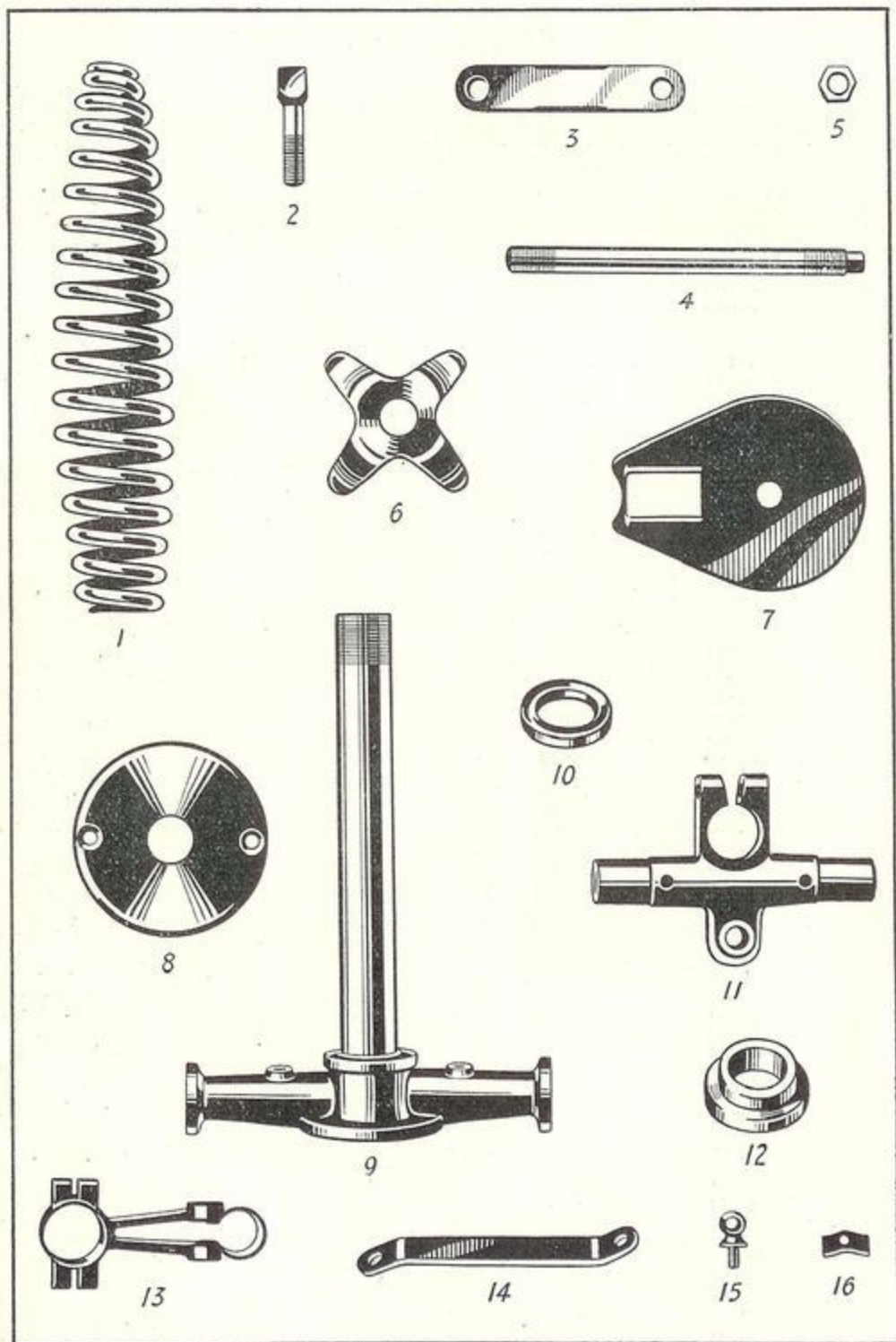

See opposite page for description and price.

Barnstormers Co. Nz

# ROYAL ENFIELD MOTOR CYCLES.

## FRONT WHEEL, FRONT BRAKE AND FRONT STAND.

Illustration No.	Quote this No. and name of part when ordering.	Description.	Price.
			£ s. d.
	21282	Front wheel with hub brake, less tyre (standard), Models S. & B.	
	22243	" " " " " " " " (for speedo drive), Models S. & B.	
	19805	" " " " " " " " (standard), Models S.2 & C.	
	19806	" " " " " " " " (for speedo drive), Models S.2 & C.	
	21283	" " only ... ..	
	16553	" " rim ... ..	
	21284	" " spokes 7 <sup>1</sup> / <sub>8</sub> " long (set of 20) ... ..	
	21091	" " " 8 <sup>1</sup> / <sub>8</sub> " long (set of 20) ... ..	
	16529	" " " nipples (set of 40) ... ..	
1	21285	" hub with grease nipple ... ..	
	19734	" brake drum ... ..	
2	20981	" spindle ... ..	
	17840	" " nut ... ..	} Models S. & B.
	17841	" " washer ... ..	
	11940	" " " ... ..	} Models S.2 & C.
	9942	" " nut ... ..	
	1846	" " washer ... ..	
3	16562	" " journal bearing ... ..	
	11936	" " " distance washer ... ..	
4	20979	" " " retaining nut, Models S. & B. ... ..	
	11937	" " " " " Models S.2 & C. ... ..	
	9838	" " oil retainer ... ..	
5	6062	" dust excluder ... ..	
6	17617	" brake shoe with lining (each) ... ..	
	11941	" " lining (each)* ... ..	
	9526	" " " rivet (per doz.) ... ..	
7	18044	" " " spring ... ..	
	18045	" " " (cam side) ... ..	
8	21286	" " cover plate (standard) ... ..	} Models S. & B.
	22244	" " " (with speedo sheath) ... ..	
9	20978	" " " distance piece ... ..	} Models S.2 & C.
	19686	" " " (standard) ... ..	
	19810	" " " (with speedo sheath) ... ..	
	11938	" " " distance piece ... ..	
10	17507	" " anchor pin ... ..	} Models S. & B.
	"V" Patt.	" " " nut ... ..	
	14611	" " " washer ... ..	} Models S.2 & C.
	15189	" " " distance washer ... ..	
	11953	" " " nut ... ..	
	1984	" " " nut ... ..	
11	21287	" " operating lever and cam (Models S. & B.) ... ..	
	16802	" " " (Models S.2 & C.) ... ..	
	10211	" " " connection pin ... ..	
	<sup>1</sup> / <sub>2</sub> " x <sup>1</sup> / <sub>8</sub> "	" " " split pin ... ..	
12	11977	" " " knuckle ... ..	
		<b>FRONT STAND, MODELS S.2 &amp; C.</b>	
	21896	Front stand complete ... ..	
13	20192	" " pivot pin ... ..	
	15771	" " " nut ... ..	
	15641	" " " washer ... ..	
14	21914	" " clip stud ... ..	
15	6148	" " " nut ... ..	
	"V" Patt.	" " " locknut ... ..	
	6198	" " " spring ring ... ..	
	14611	" " " washer ... ..	

\*It is advised that when new linings are required the brake shoes be forwarded so that the linings can be fitted at the Works and accurately ground.

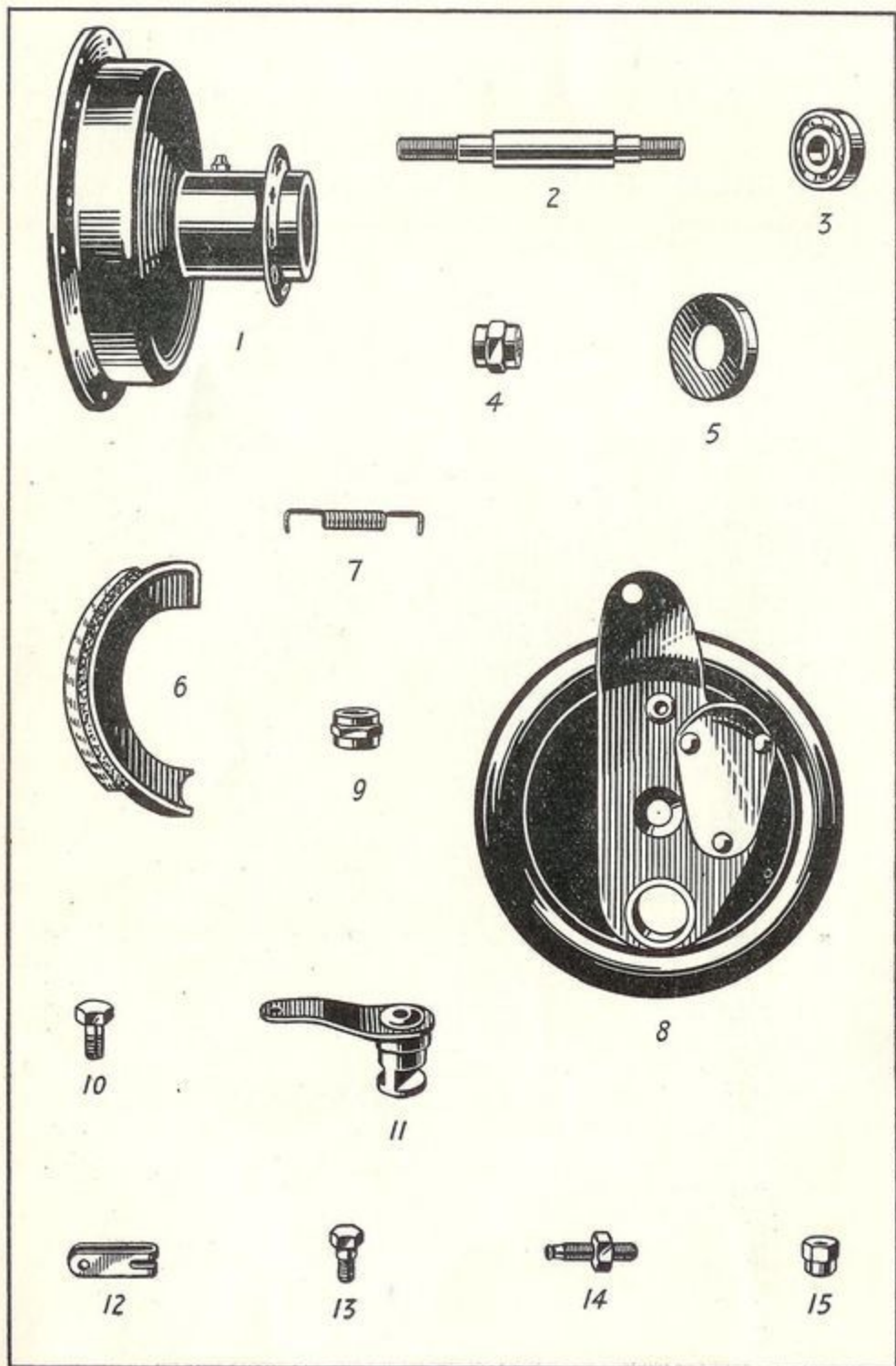

See opposite page for description and price.

Barnstormers Co. Nz

# ROYAL ENFIELD MOTOR CYCLES.

## REAR WHEEL AND REAR BRAKE.

Illustration No.	Quote this No. and name of part when ordering.	Description.	Price.
			£ s. d.
	23990	Rear wheel with cush drive and brake (less tyre) ...	...
	19690	" " only ...	...
	16553	" " rim ...	...
	16556	" " spokes, 8½" long (set of 40) ...	...
	16021	" " nipples (set of 40) ...	...
	19325	" hub brake drum ...	...
1	19691	" " with grease nipple ...	...
2	11939	" " spindle ...	...
	10512	" " nut ...	...
	5025	" " washer ...	...
3	16562	" " journal bearing ...	...
	11936	" " distance washer ...	...
4	11937	" " retaining nut ...	...
	9838	" " oil retainer ...	...
5	21930	" " dust excluder ...	...
	12302	" " driving sprocket ...	...
	10099	" " lockring ...	...
6	10098	" " pin ...	...
	"F" Patt.	" " nut ...	...
	4395	" " locknut ...	...
	¾" dia.	" " spring washer ...	...
	10464	" " cush rubber (set of 6) ...	...
7	16414	" brake shoe with lining (each) ...	...
	16397	" " lining (each)* ...	...
	9526	" " rivet (per doz.) ...	...
8	13509	" " spring ...	...
9	19692	" " cover plate complete (less shoes) ...	...
10	11938	" " distance piece ...	...
11	20341	" " anchor strip ...	...
	15786	" " pin (hub end) ...	...
12	10745	" " (lug end) ...	...
	15785	" " packing piece ...	...
	"B" Patt.	" " nut ...	...
	14612	" " washer ...	...
13	22245	Front brake operating cam and lever ...	...
	22872	Rear " cable and casing complete with nipples ...	...
14	23867	" " stop (front) ...	...
	21683	" " roller ...	...
15	23615	" " stop (rear) ...	...
	"U" Patt.	" " nut ...	...
	7674	" " washer ...	...
	½" x ⅛"	" " split pin ...	...
16	14980	" " adjusting nut ...	...
	21680	" " pedal ...	...
	21696	" " bearing tube ...	...
	PZ.6	" " grease nipple ...	...

\*It is advised when new linings are required the brake shoes be forwarded so that the linings can be fitted at the Works and accurately ground.

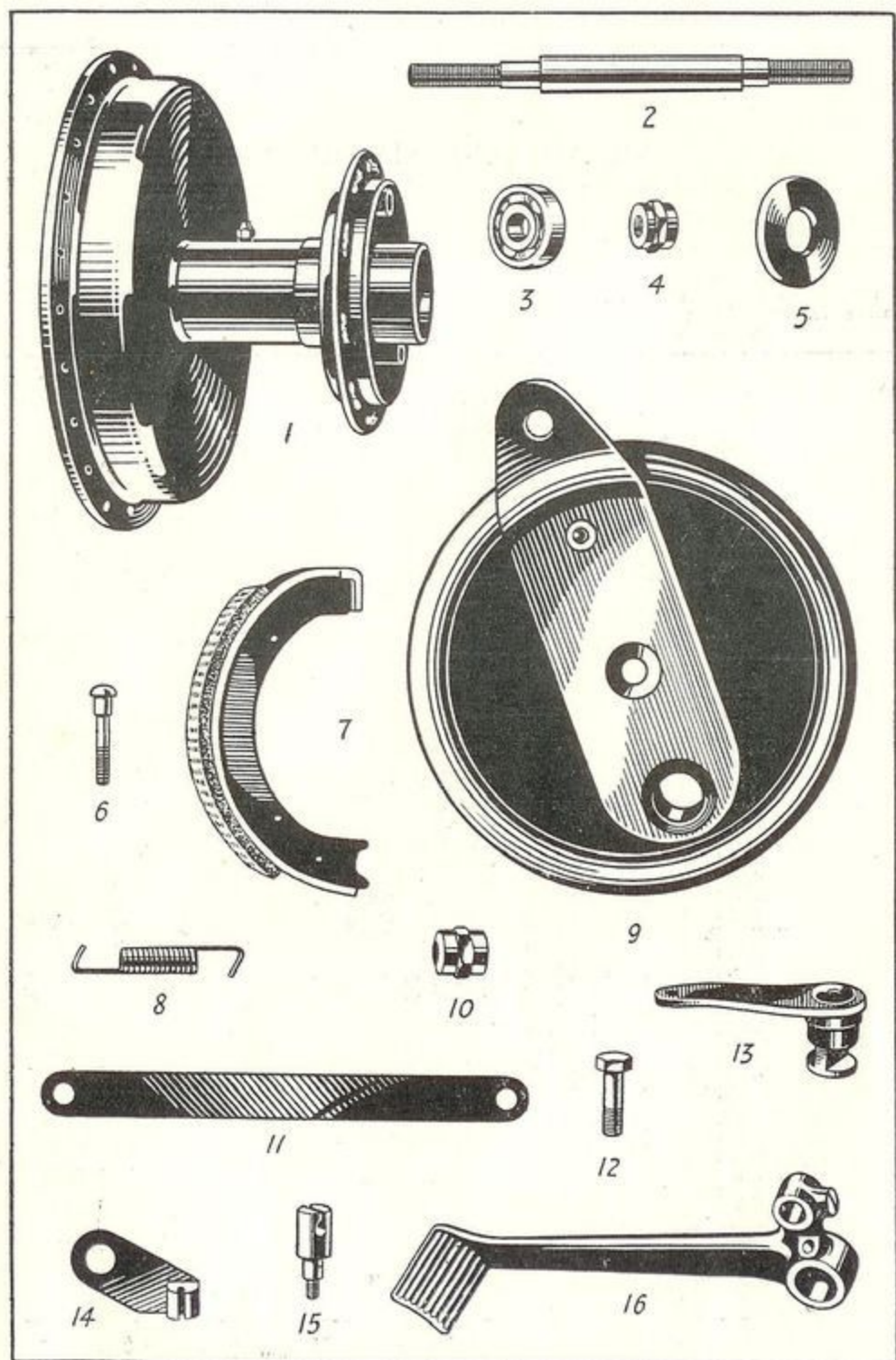

See opposite page for description and price.

**Barnstormers Co. Nz**

# ROYAL ENFIELD MOTOR CYCLES.

## FRAME AND CARRIER.

Illus- tration No.	Quote this No. and name of part when ordering.	Description.	Price.
			£ s. d.
1	23509	Frame complete ... ..	
	23991	" backstay (R.H.) ... ..	
	23992	" " (L.H.) ... ..	
	9429	" " stud (top) ... ..	
	1898	" " " nut ... ..	
	1846	" " " washer ... ..	
	9991	" " " (bottom) ... ..	
	"A" Patt.	" " " nut ... ..	
	7345	" " " locknut ... ..	
	14612	" " " washer ... ..	
	23993	" chainstay (R.H.) ... ..	
	23994	" " (L.H.) ... ..	
	17310	" " stud ... ..	
	402	" " " nut ... ..	
	7914	" " " washer ... ..	
	23642	" " " distance piece ... ..	
	23641	" " " tube, 2½" long ... ..	
	23520	" cradle tube (R.H.) ... ..	
	23521	" " (L.H.) ... ..	
	22686	" " stud (front, ½" dia.) ... ..	
	402	" " " nut ... ..	
	7914	" " " washer ... ..	
2	23635	" engine plate (R.H.) ... ..	
	23636	" " (L.H.) ... ..	
	23899	" " attachment stud (front) ... ..	
	20198	" " " nut ... ..	
	8426	" " " washer ... ..	
	23900	" " " packing collar ... ..	
	20690	" " " (rear) ... ..	
	"A" Patt.	" " " nut ... ..	
	14612	" " " washer ... ..	
	16283	" stud (rear top, ⅝" dia.), Models S. & B. ... ..	
	13620	" " (rear top, ⅝" dia.), Models S.2 & C. ... ..	
	8350	" " nut ... ..	
	8351	" " washer ... ..	
3	20121	" hanger for battery and toolbox ... ..	
	10264	" " and backstay bridge stud ... ..	
	"A" Patt.	" " " nut ... ..	
	14612	" " " washer ... ..	
	7819	" chain adjuster screw ... ..	
	7815	" " locknut ... ..	
4	15762	" Carrier top ... ..	
5	20800	" leg ... ..	
	14445	" " pin (top) ... ..	
	"V" Patt.	" " nut ... ..	
	14611	" " washer ... ..	
	251	" ¼" pin ... ..	
	"F" Patt.	" " nut ... ..	
	14610	" " washer ... ..	

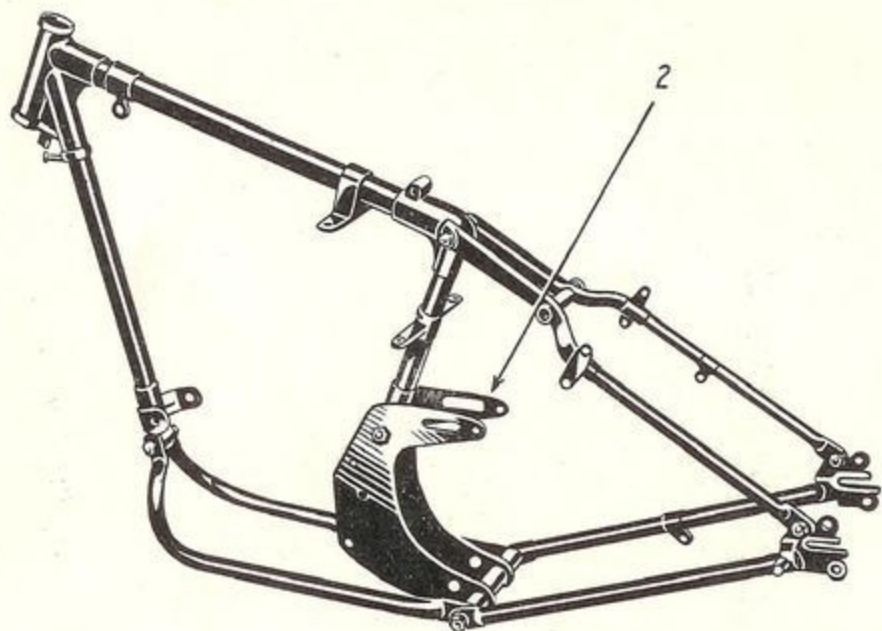

1

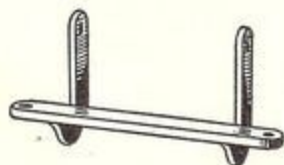

3



5

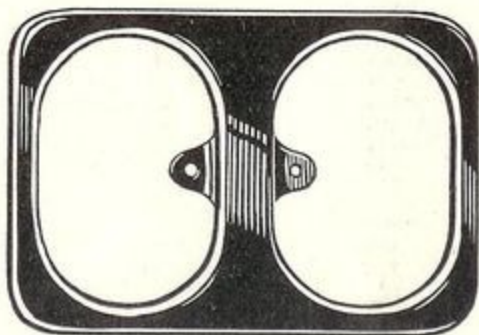

4

*See opposite page for description and price*

**Barnstormers Co. Nz**

# ROYAL ENFIELD MOTOR CYCLES.

## REAR MUDGUARD AND REAR STAND.

Illus- tration No.	Quote this No. and name of part when ordering.	Description.	Price.
			£ s. d.
1	23649	Rear mudguard (fixed half) ... ..	
	23650	" " (detachable half) ... ..	
	20796	" " handlestay ... ..	
	251	" " " 1/4" pin ... ..	
	"F" Patt.	" " " nut ... ..	
2	14610	" " " washer ... ..	
	20799	" " lifting handle ... ..	
	20943	" " " 5/16" pin ... ..	
	"D" Patt.	" " " nut ... ..	
3	14611	" " " washer ... ..	
	21314	" " bottom stay (R.H.) ... ..	
	21316	" " " (L.H.) ... ..	
	251	" " " 1/4" pin ... ..	
	"F" Patt.	" " " nut ... ..	
4	14610	" " " washer ... ..	
	11316	" " strap chainstay clip ... ..	
	7201	" " " pin ... ..	
	"F" Patt.	" " " nut ... ..	
	14610	" " " washer ... ..	
5	20045	" " backstay stud (top) ... ..	
6	20971	" " " nut ... ..	
7	15771	" " " locknut ... ..	
8	6198	" " " spring ring ... ..	
	15768	" " " (bottom) ... ..	
	6148	" " " nut ... ..	
	7345	" " " locknut ... ..	
	6198	" " " spring ring ... ..	
	10018	" " strap pin (fixed half) ... ..	
	"V" Patt.	" " " nut ... ..	
	F.193	" " " washer ... ..	
	23569	" " " distance washer ... ..	
9	21096	" " stand complete ... ..	
10	9966	" " pivot bush ... ..	
11	16092	" " pin ... ..	
	"D" Patt.	" " " nut ... ..	
	14611	" " " spring washer ... ..	
	14809	" " return spring ... ..	
	6198	" " " post spring ring ... ..	
12	16154	" " clip complete ... ..	
	251	" " " 1/4" pin ... ..	
	"F" Patt.	" " " nut ... ..	
	14610	" " " washer ... ..	
13	17490	" " number plate ... ..	
	16183	" " support strap ... ..	
	251	" " " 1/4" pin ... ..	
	"F" Patt.	" " " nut ... ..	
	14610	" " " washer ... ..	
	253	" " " 3/16" pin ... ..	
	"S" Patt.	" " " nut ... ..	
	14609	" " " washer ... ..	



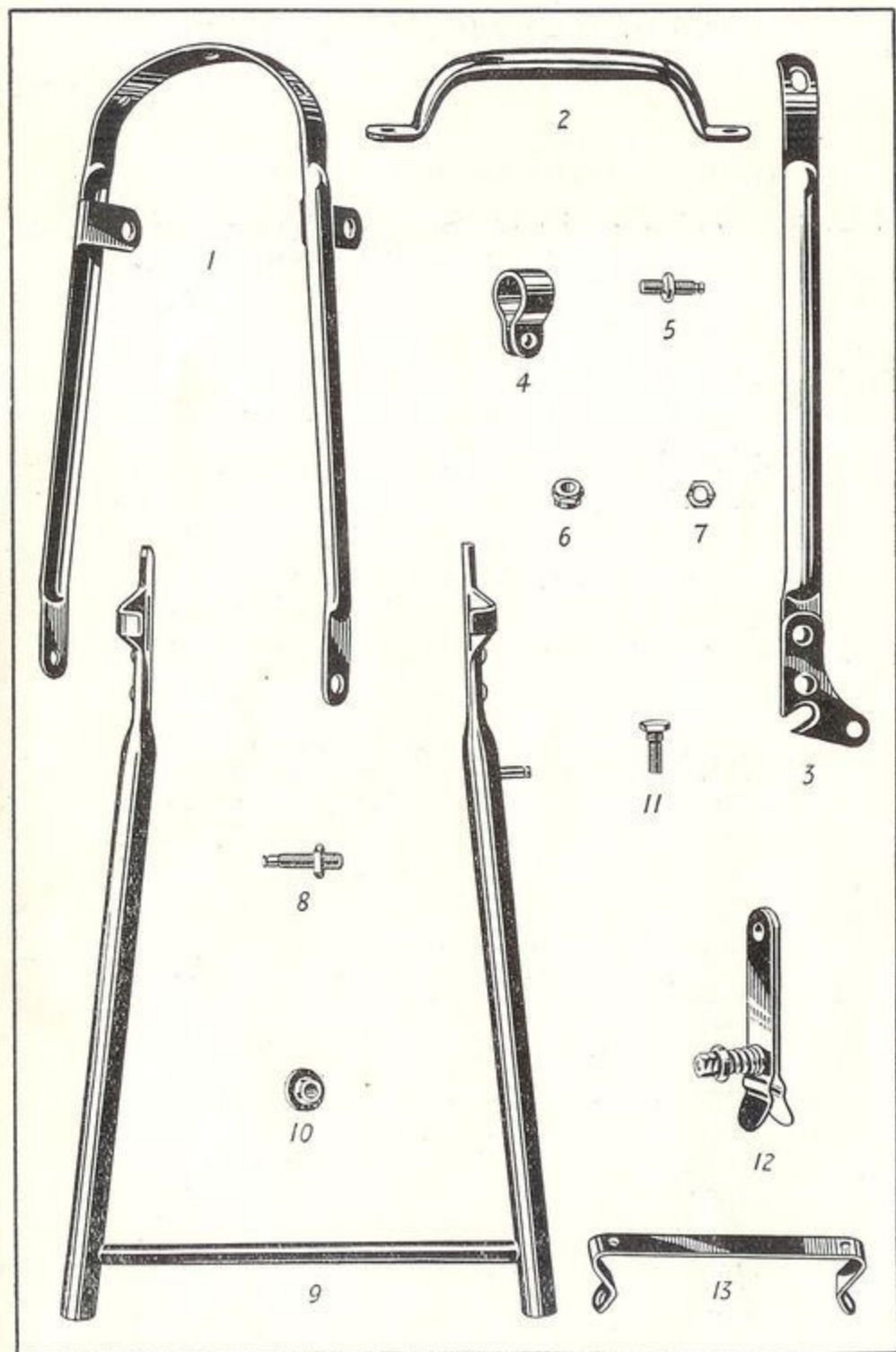

See opposite page for description and price. **Barnstormers Co. Nz**

# ROYAL ENFIELD MOTOR CYCLES.

## CHAIN COVERS, CHAINS, ENGINE ATTACHMENT STUDS, ETC.

Illustration No.	Quote this No. and name of part when ordering.	Description.	Price.
1	23612	Chain cover	} Models S. & B.
	23614	" " $\frac{5}{16}$ " attachment stud	
	"C" Patt.	" " " " " nut	
	14611	" " " " " washer	
	23613	" " " " " distance piece	
2	23632	" case	} Models S.2 & C.
	22709	" " main joint washer (rubber)	
3	22707	" " spigot washer (rubber)	
4	22708	" " inspection cover washer (rubber)	
5	22992	" " felt washer	} Models S.2 & C.
	12659	" " attachment pin	
	22937	" " " " plain washer	
	22938	" " " " leather "	
6	23551	Driving chain cover	
7	11317	Chain cover backstay clip	
	2545	" " " " pin	
	14611	" " " " " spring washer	
	3252	" " " " " distance "	
	23995	Front chain	
	23996	Rear chain	
	17476	Crankcase stud $\frac{5}{16}$ " dia., $5\frac{1}{2}$ " long	
	13413	" " " " $3\frac{7}{16}$ " "	
	23517	" " " " $2\frac{3}{16}$ " "	
	"C" Patt.	" " " " nut	
	8634	" " " " washer	
	22681	" " $\frac{1}{4}$ " dia., $5\frac{1}{2}$ " long	
	23516	" " " " $4\frac{15}{16}$ " "	
	"F" Patt.	" " " " nut	
	82	" " " " washer	

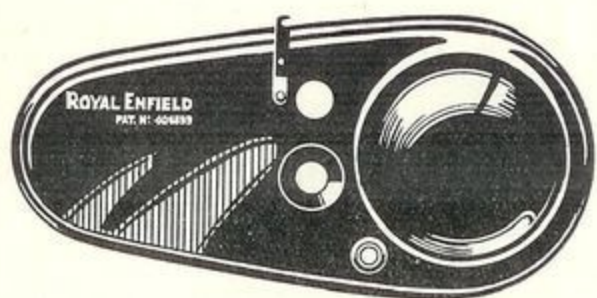

2

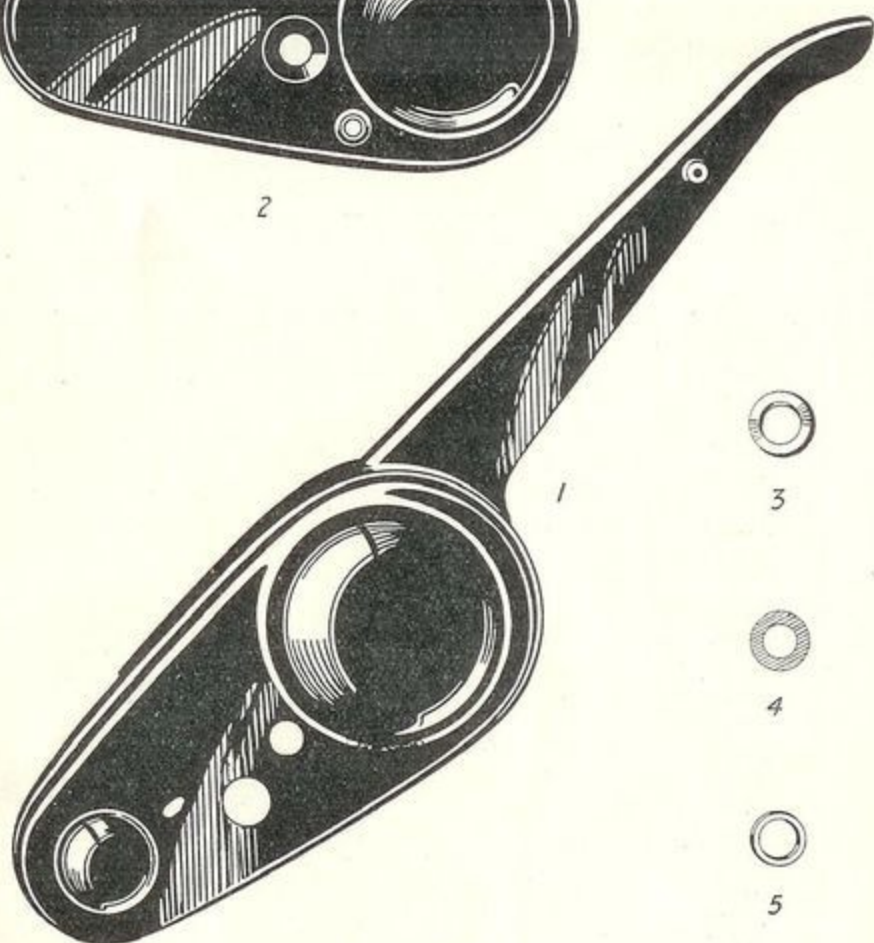

1



3



4



5



7

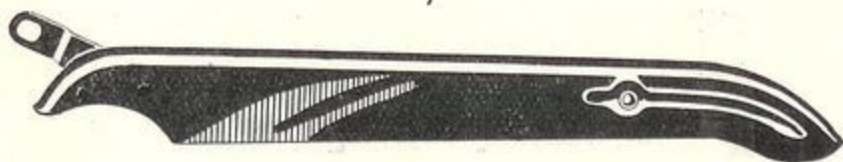

6

See opposite page for description and price  
Barnstormers Co. Nz

# ROYAL ENFIELD MOTOR CYCLES.

## SILENCER, FOOTRESTS AND TOOLS.

Illustration No.	Quote this No. and name of part when ordering.	Description.	Price.
			£ s. d.
1	23997	Silencer body ... ..	
2	22557	" tail pipe ... ..	
3	12882	" clip ... ..	
	4860	" pin ... ..	
	12881	" nut ... ..	
4	16320	" attachment pin ... ..	
	14612	" spring washer ... ..	
	23998	Exhaust pipe, Model S. ... ..	
	23999	" Model B. ... ..	
	24000	" Model C. ... ..	
5	23957	" clip (top) ... ..	
	22550	" stud ... ..	
	1984	" nut ... ..	
	$\frac{5}{16}$ " dia.	" spring washer ... ..	
6	23617	Footrest support bar ... ..	} Models S. & B. Models S.2&C.
	15750	" distance tube, $3\frac{1}{4}$ " long ... ..	
	20364	" bar ... ..	
	23334	" distance tube, $3\frac{1}{2}$ " long ... ..	
	10315	" bar nut... ..	
	6740	" washer ... ..	
	23644	" distance tube, $3\frac{5}{16}$ " long ... ..	
	15749	" distance tube, $2\frac{1}{2}$ " long ... ..	
7	22873	" arm ... ..	
8	16368	" rubber ... ..	
	22697	" distance washer (large) ... ..	
	22684	" (small) ... ..	
9	20373	Toolbox complete, less tools and roll ... ..	
	10142	" attachment pin ... ..	
	"V" Patt.	" nut ... ..	
	14611	" washer... ..	
	16007	Toolroll and strap, less tools ... ..	
	4272	Tyre lever ... ..	
	3481	File ... ..	
	3482	Screwdriver ... ..	
10	6406	Combination spanner ... ..	
11	4488	Box spanner... ..	
12	16008	Magneto spanner ... ..	
13	9452	Double ended spanner (.437" and .601" hex.) ... ..	
	5921	(.525" and .820" hex.) ... ..	
14	13129	Spanner for .343" hex. ... ..	
15	21166	Sparking plug spanner and tommy bar, Models S. & S.2 ... ..	
	16549	Models, B. & C. ... ..	
	23890	Spanner for cylinder head nuts, Models S. & S.2 ... ..	
16	14835	Extractor nut for dynamo pinion ... ..	

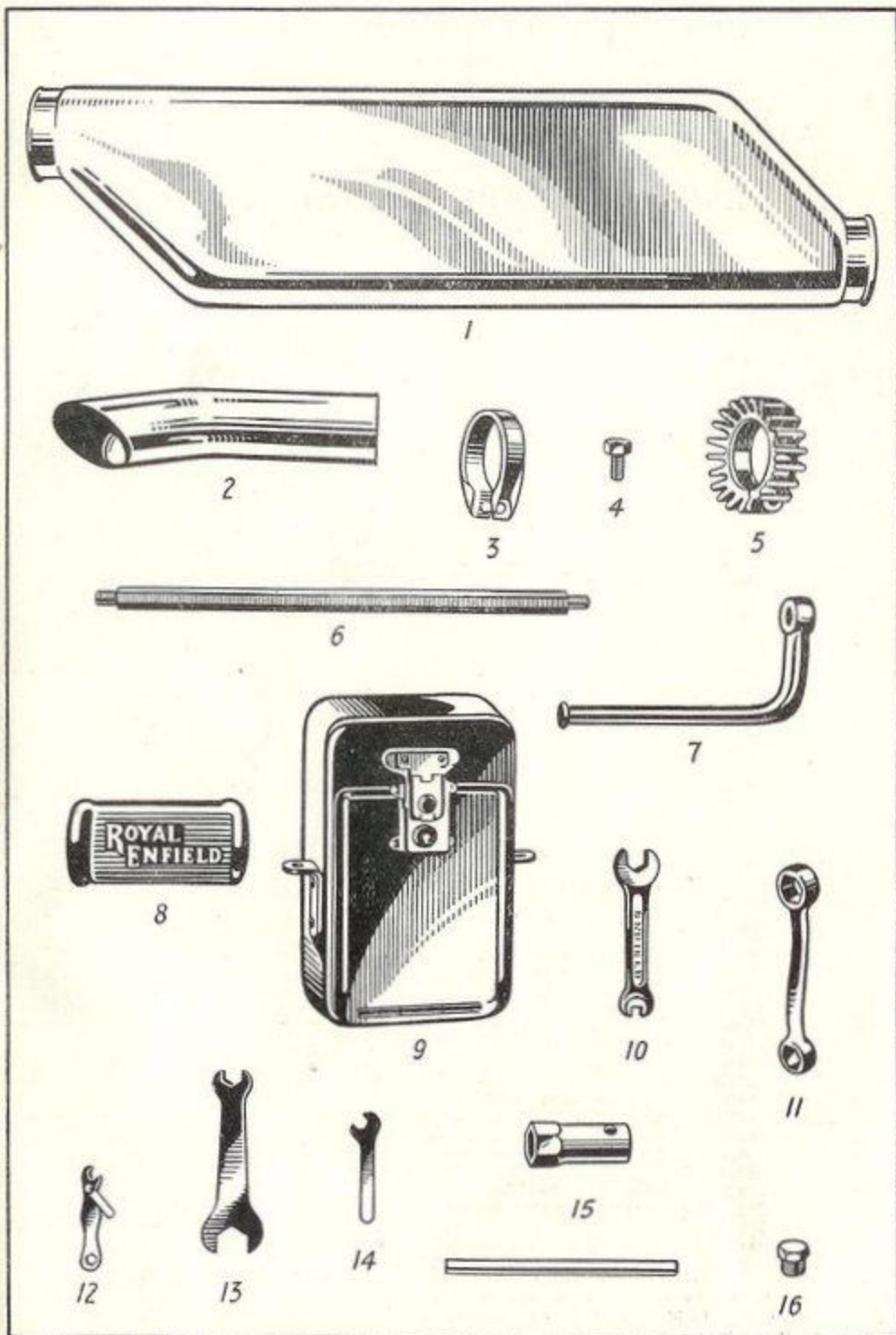

See opposite page for description and price

Barnes Formers Co. Nz

# ROYAL ENFIELD MOTOR CYCLES.

## MOTOR CYCLE CONDITIONS OF SALE AND GUARANTEE.

Reprinted from our current Motor Cycle Catalogue.

*We give the following Guarantee with our Motor Cycles, Motor Cycle Combinations and Sidecars, which is given in place of any implied conditions, warranties or liabilities whatsoever, statutory or otherwise, all such implied conditions, warranties and liabilities being in all cases excluded. Any statement, description, condition, or representation contained in any catalogue, advertisement, leaflet or other publication shall not be construed as enlarging, varying or over-riding this guarantee.*

In the case of machines (a) which have been used for " hiring out " purposes or (b) any motor cycle and/or sidecar used for any dirt track, cinder track, or grass track racing or competitions or any competition of any kind within an enclosure for which a charge is made for admission to take part in or view the competition or (c) machines from which the trade mark, name or manufacturing number has been removed, no guarantee of any kind is given or is to be implied.

**WE GUARANTEE**, subject to the conditions mentioned below, that all precautions which are usual and reasonable have been taken by us to secure excellence of materials and workmanship, but this guarantee is to extend and be in force for six months only from the date of purchase, and damages for which we make ourselves responsible under this guarantee are limited to the free supply of a new part in exchange for the part of the motor cycle, motor cycle combination or sidecar which may have proved defective. We do not undertake to replace or refix, or bear the cost of replacing or refixing, such new part in the motor cycle, motor cycle combination or sidecar. We undertake, subject to the conditions mentioned below, to make good at any time within six months any defects in these respects. As motor cycles, motor cycle combinations and sidecars are easily liable to derangement by neglect or misuse this guarantee does not apply to defects caused by wear and tear, misuse or neglect. The term " misuse " shall include amongst others the following acts :—

1. The attaching of a sidecar to the motor cycle in such a manner as to cause damage or calculated to render the latter unsafe when ridden.
2. The use of a motor cycle or of a motor cycle and sidecar combined, when carrying more persons or a greater weight than that for which the machine was designed by the manufacturers.
3. The attaching of a sidecar to a motor cycle by any form of attachment not provided or supplied by the manufacturers or to a motor cycle which is not designed for such use.

Any motor cycle or motor cycle combination or sidecar sent to us to be plated, enamelled or repaired will be repaired upon the following conditions, *i.e.*, we guarantee that all precautions which are usual and reasonable have been taken by us to secure excellence of materials and workmanship, such guarantee to extend and be in force for three months only from the time such work shall have been executed or until the expiration of the six months above referred to, and this guarantee is in lieu and in exclusion of any common law or statute warranty or condition, and the damages recoverable are limited to the cost of any further work which may be necessary to amend and make good the work found to be defective.

Models B, S and S2 are sold subject to the condition that they are not used with a sidecar.

## CONDITIONS OF GUARANTEE.

If a defective part should be found in our motor cycles, motor cycle combinations or sidecars, or in any part supplied by way of exchange before referred to, it must be sent to us CARRIAGE PAID, and accompanied by an intimation from the owner that he desires to have it repaired or exchanged free of charge under our guarantee, and he must also furnish us at the same time with the number of the machine, the date of the purchase, or the date when the alleged defective part was exchanged as the case may be.

Failing compliance with the above, such articles will lie here AT THE RISK OF THE OWNER, and this guarantee and any implied guarantee, warranty or condition shall not be enforceable.

We do not guarantee specialities such as tyres, saddles, chains, lamps, etc., or any component parts supplied to the order of the purchaser differing from standard specifications supplied with our motor cycles, motor cycle combinations, sidecars or otherwise.

## NOTICE.

We do not appoint agents for the sale on our behalf of our motor cycles or other goods, but we assign to motor cycle Dealers, areas in which we supply to such Dealers exclusively for re-sale in such areas. No such Dealer is authorised to transact any business, give any warranty, make any representation or incur any liability on our behalf.